

UNITED STATES
DEPARTMENT OF THE INTERIOR
GEOLOGICAL SURVEY

APPLICATION FOR PERMIT TO DRILL, DEEPEN, OR PLUG BACK

1a. TYPE OF WORK

DRILL ☒DEEPEN ☐PLUG BACK ☐

b. TYPE OF WELL

OIL
WELL ☒GAS
WELL ☐

OTHER

SINGLE
ZONE ☒MULTIPLE
ZONE ☐

2. NAME OF OPERATOR

Continental Oil Company

3. ADDRESS OF OPERATOR

Box 460 Hobbs New Mexico

4. LOCATION OF WELL (Report location clearly and in accordance with any State requirements.*)

At surface

1245' FNL and 160' FEL of Sec 27

At proposed prod. zone

14. DISTANCE IN MILES AND DIRECTION FROM NEAREST TOWN OR POST OFFICE*

15. DISTANCE FROM PROPOSED*

LOCATION TO NEAREST
PROPERTY OR LEASE LINE, FT.
(Also to nearest drlg. unit line, if any)18. DISTANCE FROM PROPOSED LOCATION*
TO NEAREST WELL, DRILLING, COMPLETED,
OR APPLIED FOR, ON THIS LEASE, FT.

21. ELEVATIONS (Show whether DF, RT, GR, etc.)

3967' est gr.

16. NO. OF ACRES IN LEASE

7853

19. PROPOSED DEPTH

4175'

17. NO. OF ACRES ASSIGNED
TO THIS WELL

40

20. ROTARY OR CABLE TOOLS

rotary

22. APPROX. DATE WORK WILL START*

9-5-73

23.

PROPOSED CASING AND CEMENTING PROGRAM

SIZE OF HOLE	SIZE OF CASING	WEIGHT PER FOOT	SETTING DEPTH	QUANTITY OF CEMENT
12 1/4"	8 5/8", H-40	20#	950'	Circ - 425 sacks
7 7/8"	5 1/2", K-55	14#	4175'	325 sacks

It is proposed to drill a straight hole to a TD of 4175' and complete as a Grayburg San Andres oilwell. Mud program - 0-950' (8.5-9.5 Spud mud) and 950'-4175' salt gel). Blowout preventer schematic is attached.

IN ABOVE SPACE DESCRIBE PROPOSED PROGRAM: If proposal is to deepen or plug back, give data on present productive zone and proposed new productive zone. If proposal is to drill or deepen directionally, give pertinent data on subsurface locations and measured and true vertical depths. Give blowout preventer program, if any.

24.

SIGNED

(This space for Federal or State office use)

TITLE

Sr. Analyst

DATE

8-21-73

PERMIT NO.

APPROVAL DATE

APPROVED BY

TITLE

CONDITIONS OF APPROVAL, IF ANY:

APPROVED

AUG 29 1973

ARTHUR R. BROWN
DISTRICT ENGINEER

*See Instructions On Reverse Side

USGS-6 MCA-3 File

NEW MEXICO OIL CONSERVATION COMMISSION
WELL LOCATION AND ACREAGE DEDICATION PLAT

Form C-102
Supersedes C-128
Effective 1-1-65

All distances must be from the outer boundaries of the Section

Operator CONTINENTAL OIL COMPANY			Lease M C A		Well No. 347
Unit Letter A	Section 27	Township 17 SOUTH	Range 32 EAST	County LEA	

Actual Footage Location of Well:

1245 feet from the **NORTH** line and **160** feet from the **EAST** line

Ground Level Elev.	Producing Formation <i>Grayburg San Andres</i>	Pool <i>Malj G-SA Repress</i>	Dedicated Acreage 40	Acres
--------------------	---	----------------------------------	--------------------------------	-------

- Outline the acreage dedicated to the subject well by colored pencil or hatchure marks on the plat below.
- If more than one lease is dedicated to the well, outline each and identify the ownership thereof (both as to working interest and royalty).
- If more than one lease of different ownership is dedicated to the well, have the interests of all owners been consolidated by communitization, unitization, force-pooling, etc?

☐ Yes ☐ No If answer is "yes," type of consolidation _____

If answer is "no," list the owners and tract descriptions which have actually been consolidated. (Use reverse side of this form if necessary.) _____

No allowable will be assigned to the well until all interests have been consolidated (by communitization, unitization, forced-pooling, or otherwise) or until a non-standard unit, eliminating such interests, has been approved by the Commission.

NOTE: LOCATION IS 3.6 FEET LOWER THAN CONTINENTAL OIL COMPANY MCA # 322

CERTIFICATION

I hereby certify that the information contained herein is true and complete to the best of my knowledge and belief

John W. West
Admin. Supervisor
Continental Oil Co.
August 21, 1973

I hereby certify that the well location shown on this plat was plotted from field notes of actual surveys made by me or under my supervision, and that the same is true and correct to the best of my knowledge and belief.

Date Surveyed
JUNE 8, 1973

Registered Professional Engineer and/or Land Surveyor

John W. West
Certificate No. **676**

0 330 660 990 1320 1650 1980 2310 2640 2970 3300 3630 3960 4290 4620 4950 5280 5610 5940 6270 6600 6930 7260 7590 7920 8250 8580 8910 9240 9570 9900

Development Plan For Surface Use — MCA Unit No. 347

1. Existing roads including location of the exit from the main highway

See Attached Map

2. Planned access roads

See Below and Attached Map

a. Length and width of new road — 12' X 725'

b. Roads will be ~~compacted or~~ surfaced

3. Location of existing wells

See Attached Map

4. Lateral roads to well location

See Attached Map

5. Location of tank batteries and flowlines

See Attached Map

6. Location and type of water supply

() Water will be hauled to location

(✓) See attached map for location of proposed water lines

7. Methods for handling waste disposal

Litter, such as paper, scrap iron, etc., will be picked up and disposed of. Salt water and other undesirable liquids will be disposed of by approved methods. Drilling fluids, drill cuttings, and other inert material will be disposed of by burying in the reserve pit when it is abandoned and the surface restored to level condition.

8. and 9. Location of camps and airstrips

There are no camps or airstrips contemplated to serve this lease.

10. Location of layout to include position of the rig, mud tanks, reserve pits, burn pits, pipe racks, etc.

See Below and Attached plat

a. Size of drilling pad — 180' X 130'

b. Drilling pad — ~~compacted or~~ surfaced

11. Plans for restoration of the surface

Surface will be levelled and properly conditioned.

12. Other information that may be used in evaluating the impact on environment

The terrain in this area is generally flat with very little vegetation. No streams or other major water sheds are located in this area.

CONTINENTAL OIL COMPANY
Blow-out Preventer Specifications

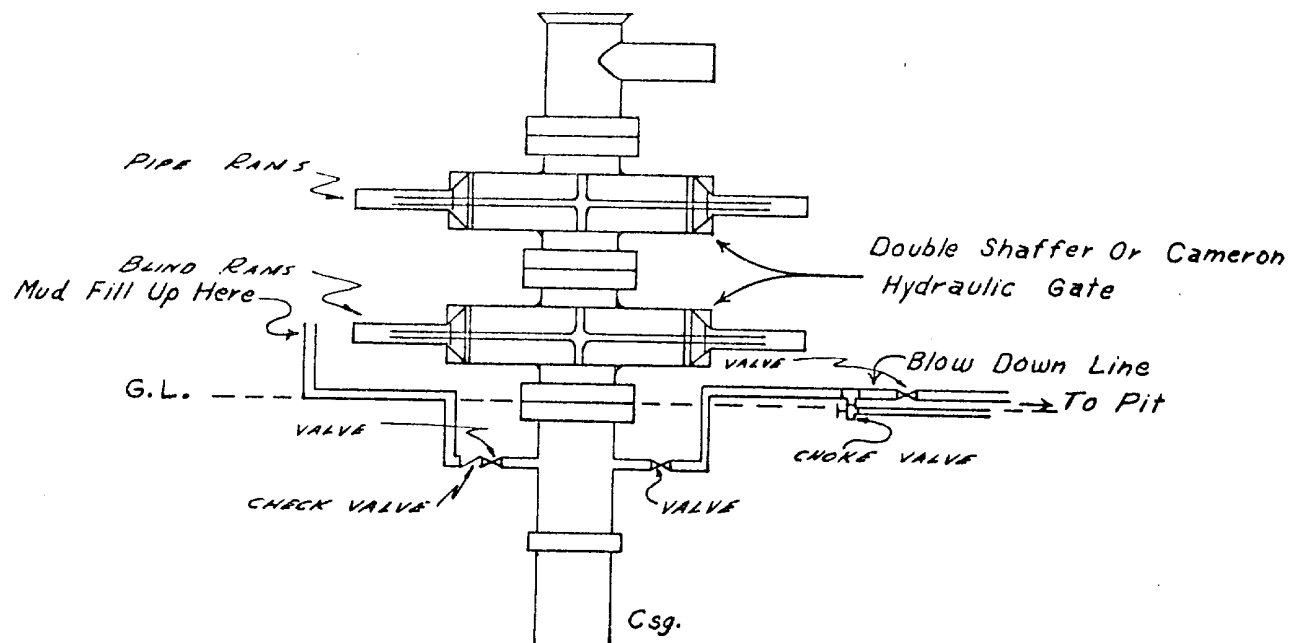

NOTE:

Manual and hydraulic controls with closing unit no less than 75' from well head.

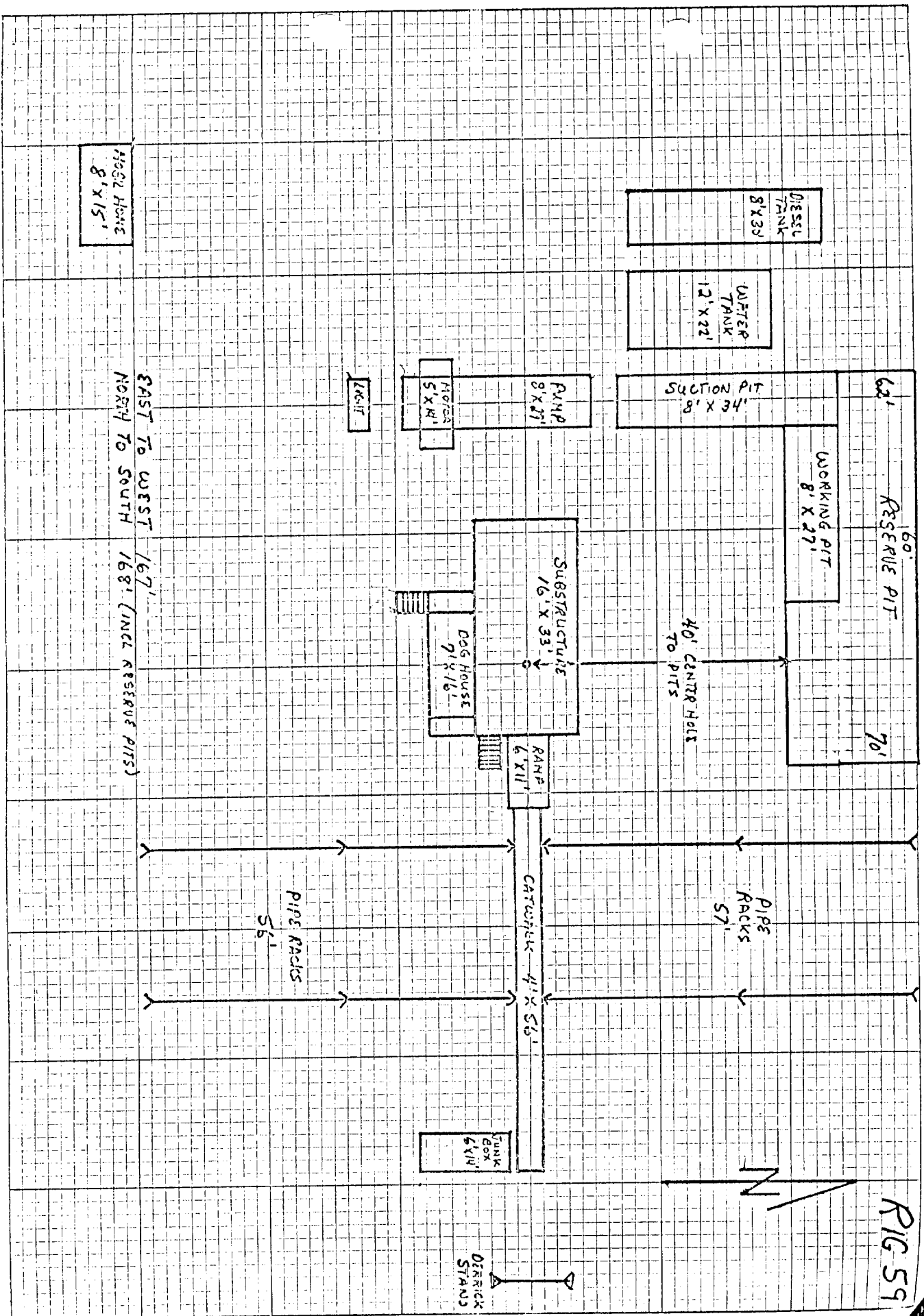

R-32-E

