

NEW MEXICO OIL CONSERVATION COMMISSION
WELL LOCATION AND ACREAGE DEDICATION PLAT

Form C-102
 Supersedes C-128
 Effective 1-4-65

All distances must be from the outer boundaries of the Section.

Operator MESA PETROLEUM COMPANY			Lease GILMORE			Well No. 1		
Unit Letter N	Section 7	Township 16 S		Range 36 E	County LEA			
Actual Footage Location of Well: 1980 feet from the WEST line and 660 feet from the SOUTH line								
Ground Level Elev. 3950.6'	Producing Formation MORROW			Pool			Dedicated Acreage: 5 1/2 312.97 Acres	

1. Outline the acreage dedicated to the subject well by colored pencil or hachure marks on the plat below.
2. If more than one lease is dedicated to the well, outline each and identify the ownership thereof (both as to working interest and royalty).
3. If more than one lease of different ownership is dedicated to the well, have the interests of all owners been consolidated by communitization, unitization, force-pooling, etc?

☒ Yes ☐ No If answer is "yes," type of consolidation communitization

If answer is "no," list the owners and tract descriptions which have actually been consolidated. (Use reverse side of this form if necessary.) _____

No allowable will be assigned to the well until all interests have been consolidated (by communitization, unitization, forced-pooling, or otherwise) or until a non-standard unit, eliminating such interests, has been approved by the Commission.

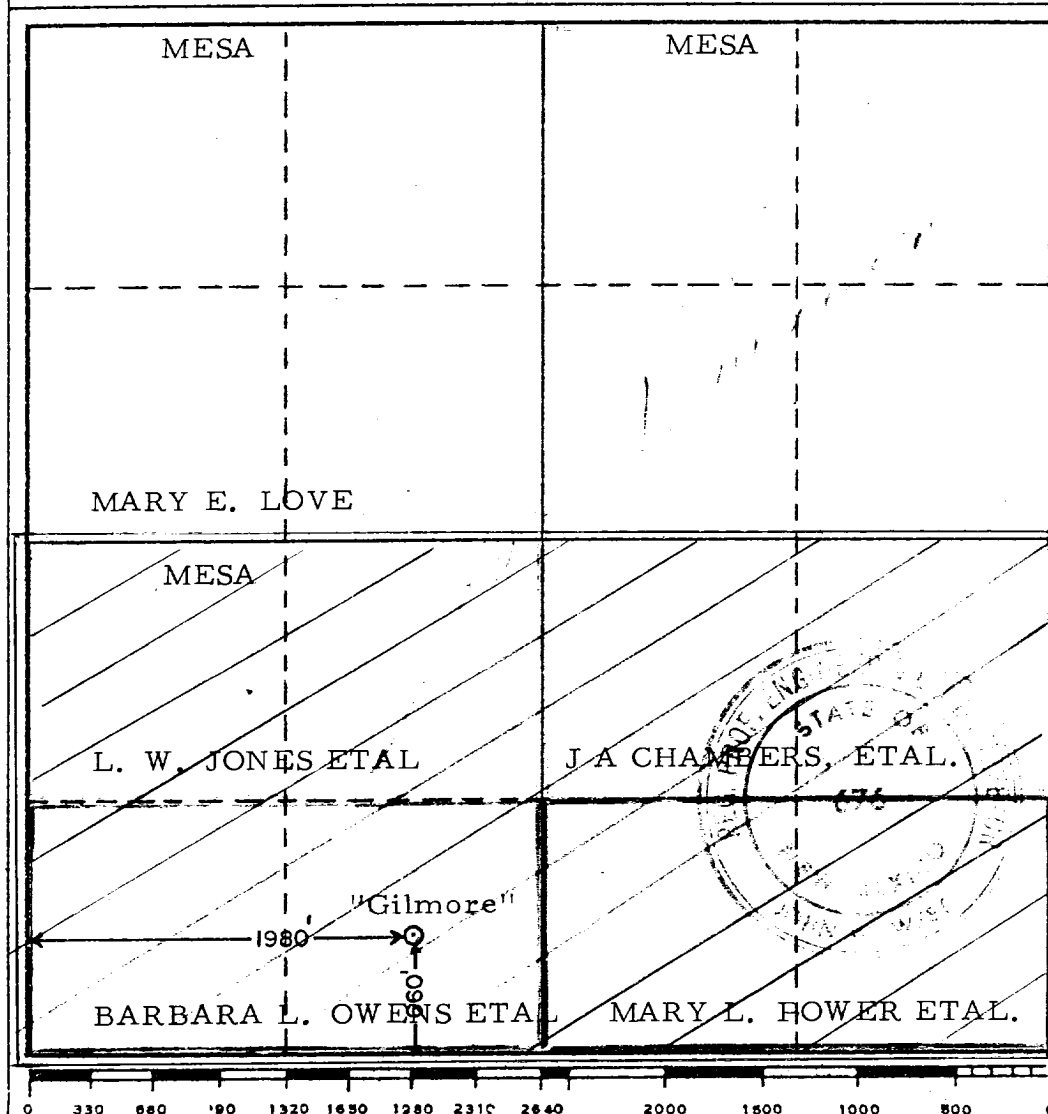

CERTIFICATION

I hereby certify that the information contained herein is true and complete to the best of my knowledge and belief.

Michael P. Houston

Name
Michael P. Houston
 Position
Production Engineer
 Company
Mesa Petroleum Co.

Date
October 22, 1973

I hereby certify that the well location shown on this plat was plotted from field notes of actual surveys made by me or under my supervision, and that the same is true and correct to the best of my knowledge and belief.

Date Surveyed
OCTOBER 10, 1973

Registered Professional Engineer and/or Land Surveyor

John W. West
 Certificate No. **676**