

NO. OF COPIES RECEIVED		
DISTRIBUTION		
SANTA FE		
FILE		
U.S.G.S.		
LAND OFFICE		
OPERATOR		

# NEW MEXICO OIL CONSERVATION COMMISSION

Form C-101  
Revised 1-1-65

5A. Indicate Type of Lease STATE <input checked="" type="checkbox"/> FEE <input type="checkbox"/>
5. State Oil & Gas Lease No. K-5275
7. Unit Agreement Name
8. Farm or Lease Name Pennzoil State
9. Well No. 1
10. Field and Pool, or Wildcat Vacuum Abo North
12. County Lea
19. Proposed Depth 9100'
19A. Formation Abo
20. Rotary or C.T. Rotary
21. Elevations (Show whether DF, RT, etc.) 4039 GR
21A. Kind & Status Plug. Bond Blanket on File
21B. Drilling Contractor Unknown
22. Approx. Date Work will start 11-25-73

APPLICATION FOR PERMIT TO DRILL, DEEPEN, OR PLUG BACK	
1a. Type of Work b. Type of Well OIL WELL <input checked="" type="checkbox"/> GAS WELL <input type="checkbox"/> OTHER <input type="checkbox"/> 2. Name of Operator Amini Oil Company 3. Address of Operator 405 Wall Towers East - Midland, Tx. 79701 4. Location of Well UNIT LETTER N LOCATED 460 FEET FROM THE South LINE AND 1980 FEET FROM THE West LINE OF SEC. 36 TWP. 16S RGE. 34E NMPM	5. Indicate Type of Lease STATE <input checked="" type="checkbox"/> FEE <input type="checkbox"/> 6. State Oil & Gas Lease No. K-5275 7. Unit Agreement Name 8. Farm or Lease Name Pennzoil State 9. Well No. 1 10. Field and Pool, or Wildcat Vacuum Abo North 12. County Lea 19. Proposed Depth 9100' 19A. Formation Abo 20. Rotary or C.T. Rotary 21. Elevations (Show whether DF, RT, etc.) 4039 GR 21A. Kind & Status Plug. Bond Blanket on File 21B. Drilling Contractor Unknown 22. Approx. Date Work will start 11-25-73

## PROPOSED CASING AND CEMENT PROGRAM

SIZE OF HOLE	SIZE OF CASING	WEIGHT PER FOOT	SETTING DEPTH	SACKS OF CEMENT	EST. TOP
17 1/2"	12-3/4"	48#	370'	500	Surface
11"	8-5/8"	24# & 32#	3000'	200	2600'
7-7/8"	4 1/2"	11.6#	TD	300	7500'

APPROVAL VALID  
FOR 90 DAYS UNLESS  
DRILLING COMMENCED,

EXPIRES

2-26-74

ABOVE SPACE DESCRIBE PROPOSED PROGRAM: IF PROPOSAL IS TO DEEPEN OR PLUG BACK, GIVE DATA ON PRESENT PRODUCTIVE ZONE AND PROPOSED NEW PRODUCTIVE ZONE. GIVE BLOWOUT PREVENTER PROGRAM, IF ANY.

I hereby certify that the information above is true and complete to the best of my knowledge and belief.

Signature: Karin Godwin Title: Agent Date: Nov. 20, 1973

(This space for State Use)

PROVED BY: [Signature] TITLE:  DATE:

CONDITIONS OF APPROVAL, IF ANY:

**NEW MEXICO OIL CONSERVATION COMMISSION  
WELL LOCATION AND ACREAGE DEDICATION PLAT**

Form C-102  
Supersedes C-128  
Effective 1-1-65

All distances must be from the outer boundaries of the Section

Lessor <b>AMINI OIL COMPANY</b>			Lease <b>PENNZOIL STATE</b>		Well No. <b>1</b>
Tract Letter <b>N</b>	Section <b>36</b>	Township <b>16 SOUTH</b>	Range <b>34 EAST</b>	County <b>LEA</b>	
Actual Footage Location of Well: <div style="display: flex; justify-content: space-between;"> <span>460 feet from the <b>SOUTH</b> line and</span> <span>1980 feet from the <b>WEST</b> line</span> </div>					
Ground Level Elev. <b>4038.8</b>	Producing Formation <b>Abo</b>	Pool <b>Vacuum Abo North</b>		Dedicated Acreage: <b>80</b> Acres	

1. Outline the acreage dedicated to the subject well by colored pencil or hachure marks on the plat below.
2. If more than one lease is dedicated to the well, outline each and identify the ownership thereof (both as to working interest and royalty).
3. If more than one lease of different ownership is dedicated to the well, have the interests of all owners been consolidated by communitization, unitization, or pooling, etc?

☐ Yes ☒ No If answer is "Yes," type of consolidation \_\_\_\_\_

If answer is "no," list the owners and tract descriptions which have actually been consolidated. (Use reverse side of this form if necessary) \_\_\_\_\_

No allowable will be assigned to the well until all interests have been consolidated (by communitization, unitization, forced-pooling, or otherwise) or until a non-standard unit, eliminating such interests, has been approved by the Commission.

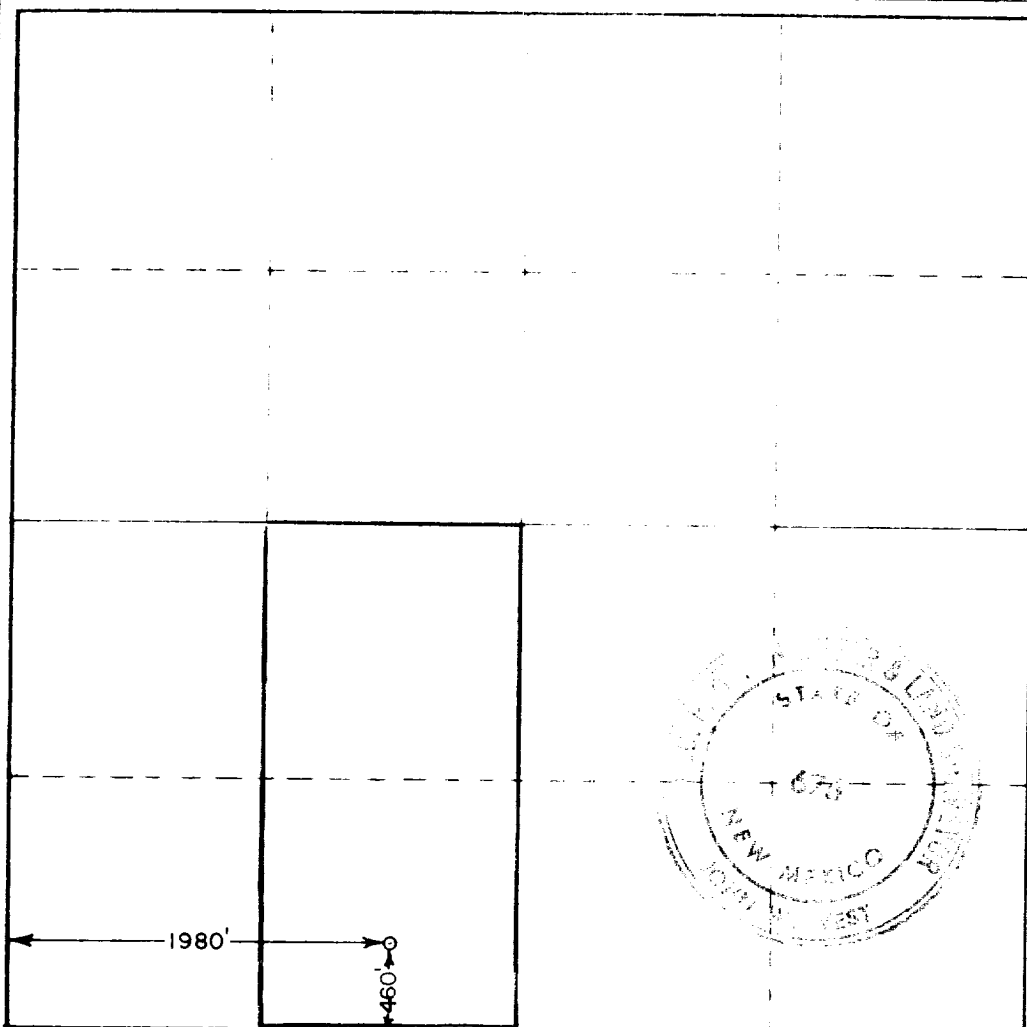

**CERTIFICATION**

I hereby certify that the information contained herein is true and complete to the best of my knowledge and belief

Name: *Kevin Godwin*  
Position: **Agent**

Company: **Amini Oil Company**

Date: **November 20, 1973**

I hereby certify that the well location shown on this plat was plotted from field notes of actual surveys made by me or under my supervision, and that the same is true and correct to the best of my knowledge and belief

Date Surveyed

**NOVEMBER 17, 1973**

Registered Professional Engineer and/or Land Surveyor

*John W. West*  
Certificate No. **676**

