

NEW MEXICO OIL CONSERVATION COMMISSION
WELL LOCATION AND ACREAGE DEDICATION PLAT

Form C-102
Supersedes C-128
Effective 1-1-65

All distances must be from the outer boundaries of the Section.

Operator SAMEDAN OIL CORPORATION			Lease SUPERIOR-OWENS		Well No. 1
Unit Letter D	Section 3	Township 15 SOUTH	Range 35 EAST	County LEA	
Actual Footage Location of Well: 990 feet from the NORTH line and 330 feet from the WEST line					
Ground Level Elev. 4001.1	Producing Formation Wolfcamp		Pool Morton Wolfcamp, East		Dedicated Acreage 80 81.50

1. Outline the acreage dedicated to the subject well by colored pencil or hatchure marks on the plat below.
2. If more than one lease is dedicated to the well, outline each and identify the ownership thereof (both as to working interest and royalty).
3. If more than one lease of different ownership is dedicated to the well, have the interests of all owners been consolidated by communitization, unitization, force-pooling, etc?

☐ Yes ☐ No If answer is "yes," type of consolidation _____

If answer is "no," list the owners and tract descriptions which have actually been consolidated. (Use reverse side of this form if necessary.) _____

No allowable will be assigned to the well until all interests have been consolidated (by communitization, unitization, forced-pooling, or otherwise) or until a non-standard unit, eliminating such interests, has been approved by the Commission.

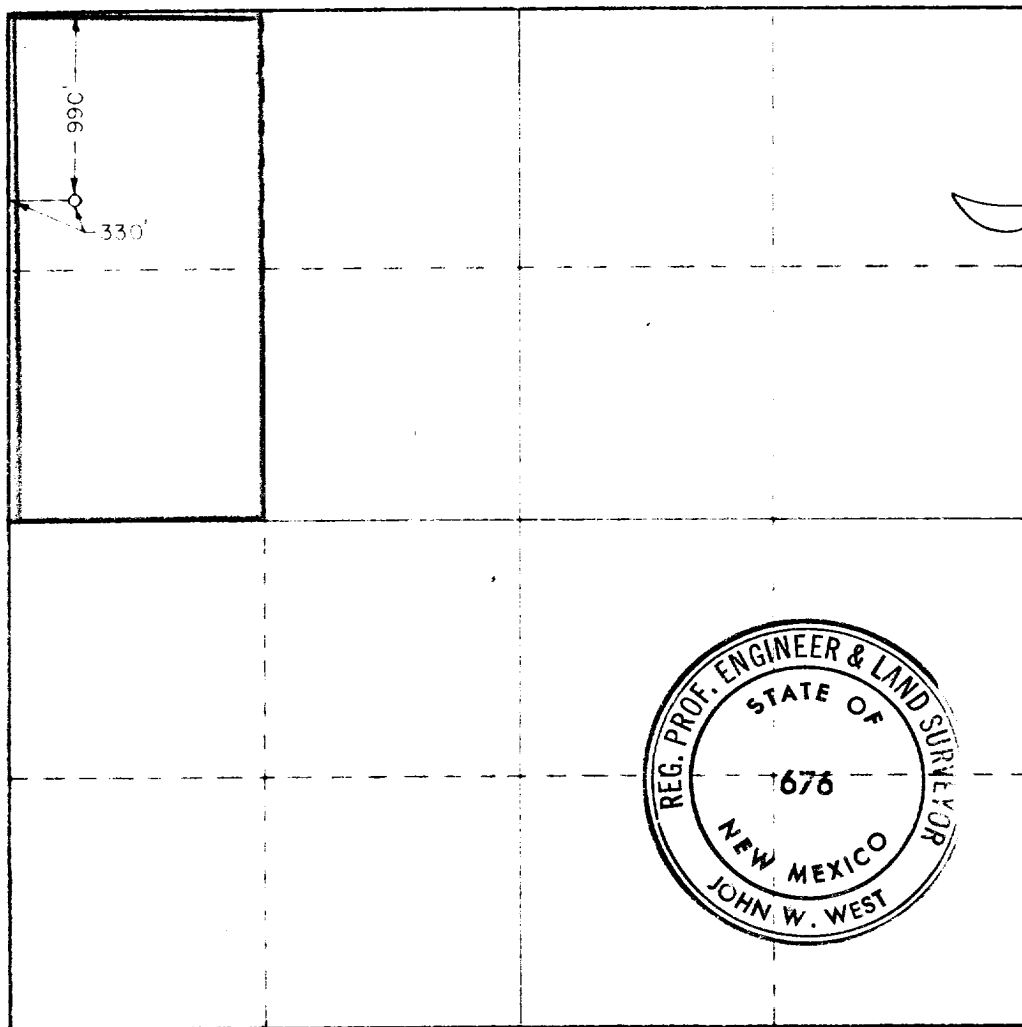

CERTIFICATION

I hereby certify that the information contained herein is true and complete to the best of my knowledge and belief.

William S. McCuen

Name

William S. McCuen

Position

Production Superintendent

Company

Samedan Oil Corporation

Date

January 3, 1974

I hereby certify that the well location shown on this plat was plotted from the notes of actual surveys made by me under my supervision, and that the same is true and correct to the best of my knowledge and belief.

Date Surveyed

December 29, 1973

Registered Professional Engineer and/or Land Surveyor

John W. West

Certificate No.

676

330 660 990 1320 1650 1980 2310 2640 2970 3300 3630 3960 4290 4620 4950 5280 5610 5940 6270 6600

173

173

RECEIVED

MAY 1972

U. S. CONSERVATION COMMISSION

WASHINGTON, D. C.