

NO. OF COPIES RECEIVED	
DISTRIBUTION	
SANTA FE	
FILE	
U.S.G.S.	
LAND OFFICE	
OPERATOR	

NEW MEXICO OIL CONSERVATION COMMISSION

Form C-101
Revised 1-1-65

5A. Indicate Type of Lease
STATE ☒ FEE ☐

5. State Oil & Gas Lease No.
B-2229

APPLICATION FOR PERMIT TO DRILL, DEEPEN, OR PLUG BACK

1a. Type of Work DRILL <input checked="" type="checkbox"/> DEEPEN <input type="checkbox"/> PLUG BACK <input type="checkbox"/>		7. Unit Agreement Name
b. Type of Well OIL <input checked="" type="checkbox"/> GAS <input type="checkbox"/> OTHER <input type="checkbox"/> WELL <input checked="" type="checkbox"/> SINGLE ZONE <input checked="" type="checkbox"/> MULTIPLE ZONE <input type="checkbox"/>		8. Farm or Lease Name Phillips E State
2. Name of Operator Phillips Petroleum Company		9. Well No. 21
3. Address of Operator Room 711, Phillips Bldg., Odessa, Texas 79761		10. Field and Pooling Unit Maljamar Gb/San Andres
4. Location of Well UNIT LETTER D LOCATED 360 FEET FROM THE north LINE AND 360 FEET FROM THE west LINE OF SEC. 14 TWP. 17-S. RGE. 33-E NMPM		12. County Lea
18. Proposed Depth 4,600		19A. Formation Grayburg
20. Rotary or C.T. Rotary		
17. Elevations (Show whether D.R., etc.) Later	21A. Kind & Status Plug. Bond blanket	21B. Drilling Contractor Cactus Drlg Company
22. Approx. Date Work will start upon approval		

PROPOSED CASING AND CEMENT PROGRAM

SIZE OF HOLE	SIZE OF CASING	WEIGHT PER FOOT	SETTING DEPTH	SACKS OF CEMENT	EST. TOP
12-1/4	8-5/8	28.5	400	300	Circ.
7-7/8	4-1/2	11.6	4,600	300	2,700

BLOWOUT PREVENTER REQUIREMENT: Series 900 BOP. Minimum Requirements As Shown In P.P. Co. Blowout Manual Figure 7.

APPROVAL VALID
FOR 90 DAYS UNLESS
DRILLING COMMENCED,
EXPIRES **6-10-75**

IN ABOVE SPACE DESCRIBE PROPOSED PROGRAM: IF PROPOSAL IS TO DEEPEN OR PLUG BACK, GIVE DATA ON PRESENT PRODUCTIVE ZONE AND PROPOSED NEW PRODUCTION ZONE. GIVE BLOWOUT PREVENTER PROGRAM, IF ANY.

I hereby certify that the information above is true and complete to the best of my knowledge and belief.

Signature **W.J. Mueller** Title **Senior Reservoir Engineer** Date **3-5-75**

(This space for State Use)

APPROVED BY **[Signature]** TITLE **SUPERVISOR DISTRICT I** DATE _____
CONDITIONS OF APPROVAL, IF ANY:

**NEW MEXICO OIL CONSERVATION COMMISSION
WELL LOCATION AND ACREAGE DEDICATION PL**

Form C-102
Supersedes C-128
Effective 1-1-65

All distances must be from the outer boundaries of the Section.

Operator Phillips Petroleum Company			Lease Phillips State "E"		Well No. 21
Unit Letter D	Section 14	Township 17 South	Range 33 East	County Lea	
Actual Well Location of Well:					
360	feet from the	North	line and	360	feet from the West line
Ground Level Elev. 4135.6	Producing Formation Grayburg		Pool Maljamar Gb/San Andres		Dedicated Acreage: 40 Acres

1. Outline the acreage dedicated to the subject well by colored pencil or hachure marks on the plat below.
2. If more than one lease is dedicated to the well, outline each and identify the ownership thereof (both as to working interest and royalty).
3. If more than one lease of different ownership is dedicated to the well, have the interests of all owners been consolidated by communitization, unitization, force-pooling, etc?

☐ Yes ☐ No If answer is "yes," type of consolidation _____

If answer is "no," list the owners and tract descriptions which have actually been consolidated. (Use reverse side of this form if necessary.) _____

No allowable will be assigned to the well until all interests have been consolidated (by communitization, unitization, forced-pooling, or otherwise) or until a non-standard unit, eliminating such interests, has been approved by the Commission.

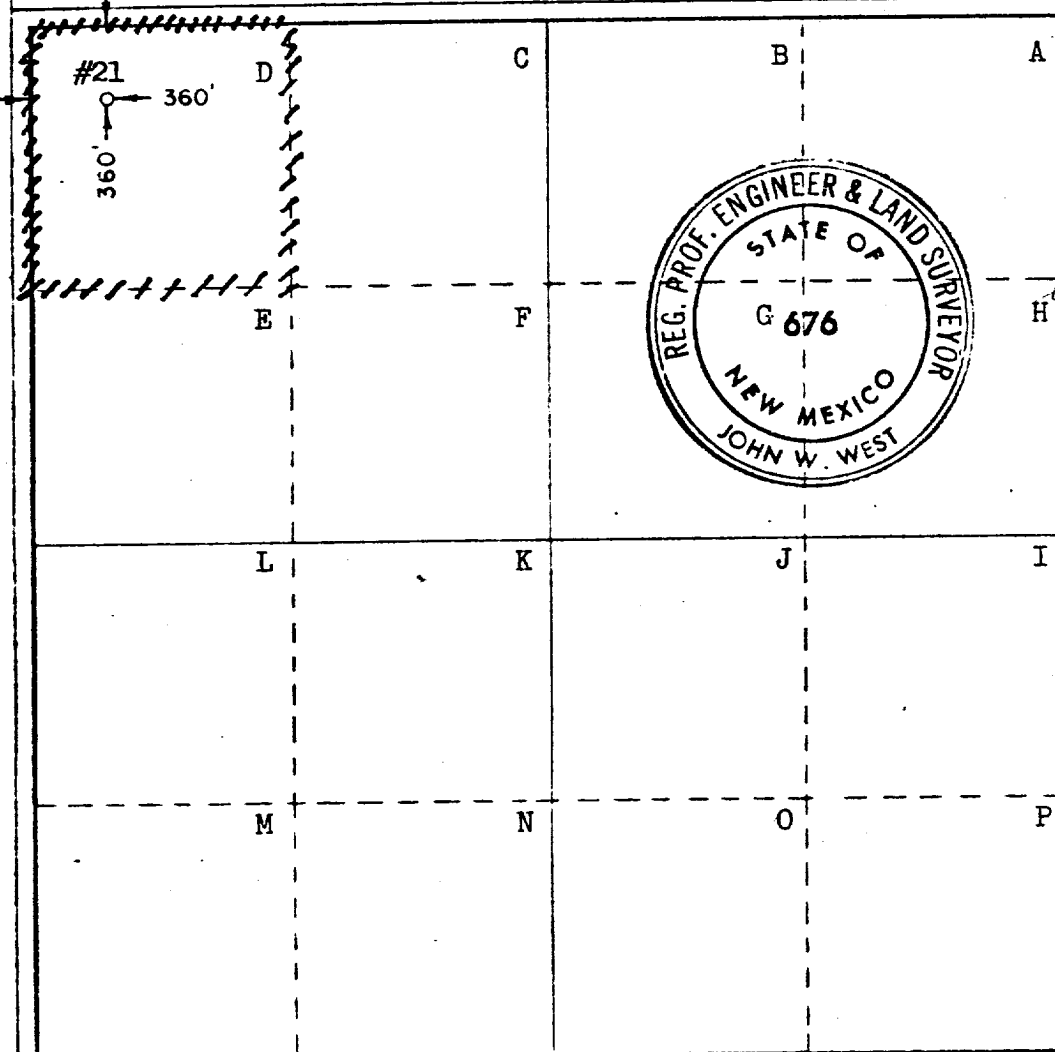

CERTIFICATION

I hereby certify that the information contained herein is true and complete to the best of my knowledge and belief.

W.J. Mueller
W.J. Mueller

Senior Reservoir Engineer
Position
Phillips Petroleum Company
Company

Date
March 5, 1975

I hereby certify that the well location shown on this plat was plotted from field notes of actual surveys made by me or under my supervision, and that the same is true and correct to the best of my knowledge and belief.

Date Surveyed
February 28, 1975

Registered Professional Engineer
and/or Land Surveyor

John W West

Certificate No. **676**

0 360 720 1080 1440 1800 2160 2520 2880 3240 3600

173

100-100000
100-100000
100-100000
100-100000

DOUBLE PREVENTER OPTION

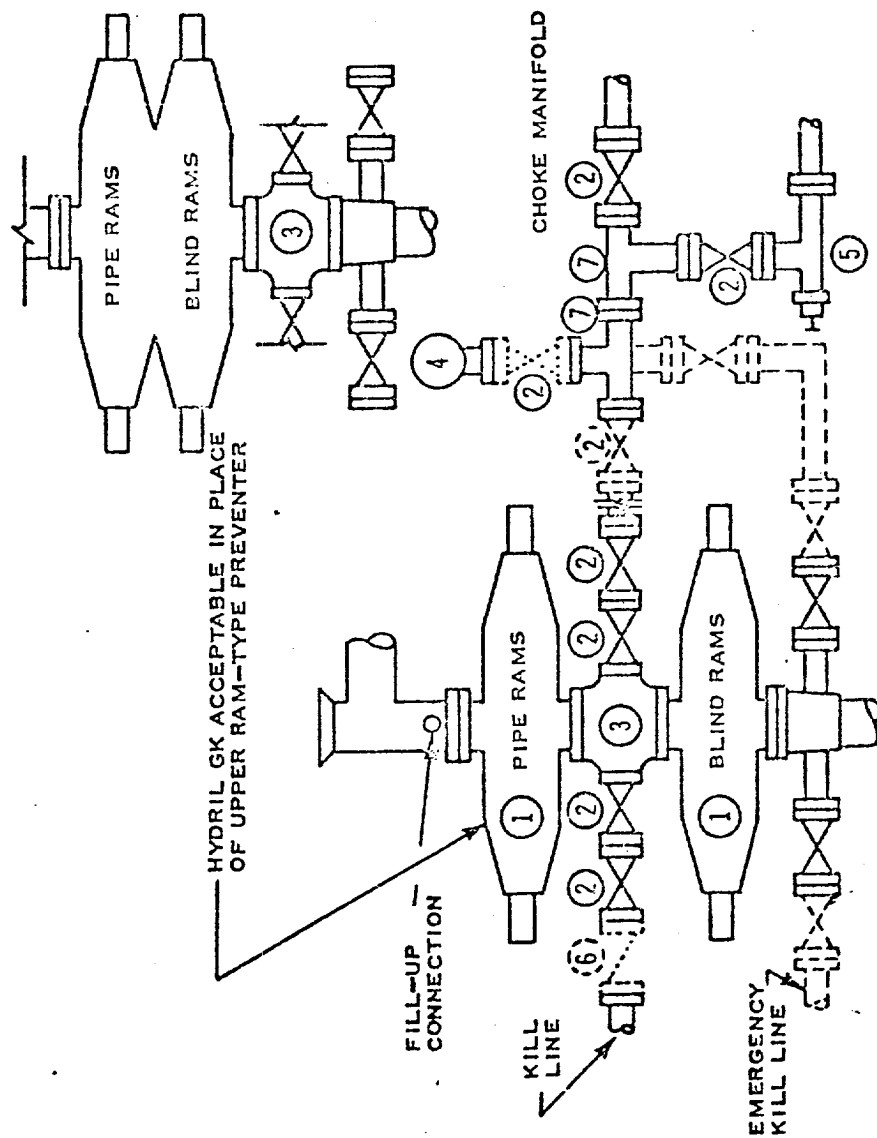

- ① SERIES 900 RAM-TYPE BOP
- ② 2" SERIES 900 VALVE
- ③ SERIES 900 DRILLING SPOOL
- ④ 2" MUD PRESSURE GAUGE
- ⑤ 2" SERIES 900 CHOKE
- ⑥ 2" SERIES 900 CHECK VALVE
- ⑦ 2" SERIES 900 STEEL TEE

NOTES:

1. 3000 PSI WP CLAMP HUBS MAY BE SUBSTITUTED FOR FLANGES

2. VALVES MAY BE EITHER HAND OR POWER OPERATED BUT, IF POWER OPERATED, THE VALVES FLANGED TO THE BOP RUN MUST BE CAPABLE OF BEING OPENED AND CLOSED MANUALLY OR CLOSE ON POWER FAILURE AND BE CAPABLE OF BEING OPENED MANUALLY

..... OPTIONAL EQUIPMENT

PHILLIPS PETROLEUM COMPANY

3000 PSI WORKING PRESSURE
BLOWOUT PREVENTER HOOK-UP
(SERIES 900 FLANGES OR BETTER)