

NO. OF COPIES RECEIVED	
DISTRIBUTION	
SANTA FE	
FILE	
U.S.G.S.	
LAND OFFICE	
OPERATOR	

# NEW MEXICO OIL CONSERVATION COMMISSION

Form C-101  
Revised 1-1-65

5A. Indicate Type of Lease

STATE ☐

FEE ☒

5. State Oil & Gas Lease No.

## APPLICATION FOR PERMIT TO DRILL, DEEPEN, OR PLUG BACK

1a. Type of Work

DRILL ☐

DEEPEN ☐

PLUG BACK ☐

b. Type of Well

OIL WELL ☒

GAS WELL ☐

OTHER

SINGLE ZONE ☐

MULTIPLE ZONE ☐

2. Name of Operator

C&K Petroleum, Inc.

3. Address of Operator

607 Midland National Bank Bldg., Midland, Texas 79701

4. Location of Well

UNIT LETTER F LOCATED 2086 FEET FROM THE West LINE

AND 2086 FEET FROM THE North LINE OF SEC. 34 TWP. 16S RSE. 37E NMPM

7. Unit Agreement Name

8. Farm or Lease Name

Shipp "34" A

9. Well No.

2

10. Field and Pool, or Wildcat

Undesig. - Drinkard

12. County

Lea

19. Proposed Depth

8800'

19A. Formation

Drinkard

20. Rotary or C.T.

Rotary

21. Elevations (Show whether DF, RT, etc.)

3774.6 Gr

21A. Kind & Status Plug. Bond

Blanket-Active

21B. Drilling Contractor

Warton Drilling Co.

22. Approx. Date Work will start

Upon Approval

## PROPOSED CASING AND CEMENT PROGRAM

SIZE OF HOLE	SIZE OF CASING	WEIGHT PER FOOT	SETTING DEPTH	SACKS OF CEMENT	EST. TOP
17-1/2	13-3/8	48#	350'	350	circ.
11	8-5/8	32# & 28#	4200'	600	2500'
7-7/8	4-1/2	11.6 & 10.5	8800'	750	5200

## Blowout Preventer Program:

Hydrill 12" 900 GK Hydraulic stripper type Blowout Preventer with shatter 12" 900 type "E" Hydraulic Double Ram Type.

APPROVAL VALID  
FOR 90 DAYS UNLESS  
DRILLING COMMENCED,

EXPIRES

Oct 23/1975

IN ABOVE SPACE DESCRIBE PROPOSED PROGRAM; IF PROPOSAL IS TO DEEPEN OR PLUG BACK, GIVE DATA ON PRESENT PRODUCTIVE ZONE AND PROPOSED NEW PRODUCTIVE ZONE. GIVE BLOWOUT PREVENTER PROGRAM, IF ANY.

I hereby certify that the information above is true and complete to the best of my knowledge and belief.

Signed [Signature] Title Adm. Supervisor Date July 16, 1975

(This space for State Use)

APPROVED BY [Signature] TITLE Geologist DATE JUL 20 1975

CONDITIONS OF APPROVAL, IF ANY:

JUL 21 1975

C & K PETROLEUM, INC.  
Midland, TexasNEW MEXICO OIL CONSERVATION COMMISSION  
WELL LOCATION AND ACREAGE DEDICATION PLForm C-102  
Supersedes C-128  
Effective 1-1-65

All distances must be from the outer boundaries of the Section

Operator <b>C &amp; K Petroleum, Incorporated</b>			Lease <b>Shipp 34 A</b>		Well No. <b>2</b>
Section <b>F</b>	Section <b>34</b>	Township <b>16 South</b>	Range <b>37 East</b>	County <b>Lea</b>	
A true well location of well.					
<b>2086</b> feet from the <b>North</b> line and		<b>2086</b> feet from the <b>West</b> line			
Ground Level Elev. <b>3773</b>	Producing Formation <b>Drinkard</b>	Pool <b>Undesignated</b>		Dedicated Acreage: <b>80</b> Acres	

1. Outline the acreage dedicated to the subject well by colored pencil or hatchure marks on the plat below.
2. If more than one lease is dedicated to the well, outline each and identify the ownership thereof (both as to working interest and royalty).
3. If more than one lease of different ownership is dedicated to the well, have the interests of all owners been consolidated by communitization, unitization, force-pooling, etc?

☐ Yes ☐ No If answer is "yes," type of consolidation \_\_\_\_\_

If answer is "no," list the owners and tract descriptions which have actually been consolidated. (Use reverse side of this form if necessary.) \_\_\_\_\_

No allowable will be assigned to the well until all interests have been consolidated (by communitization, unitization, forced-pooling, or otherwise) or until a non-standard unit, eliminating such interests, has been approved by the Commission.

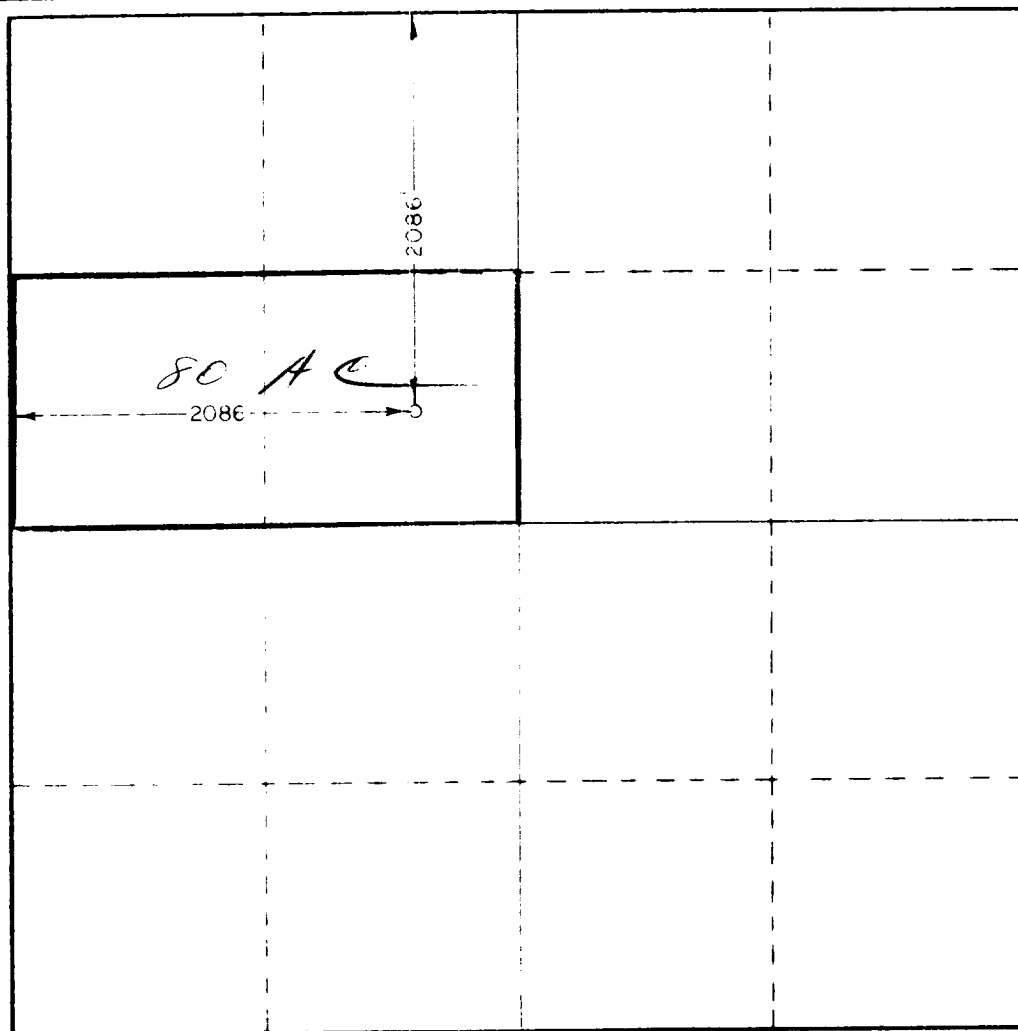

## CERTIFICATION

I hereby certify that the information contained herein is true and complete to the best of my knowledge and belief.

Name *R. E. Cope*  
Position

Adm. Supervisor

Company  
**C&K PETROLEUM, INC.**

Date  
**July 16, 1975**

I hereby certify that the well location shown on this plat was plotted from field notes of actual surveys made by me or under my supervision, and that the same is true and correct to the best of my knowledge and belief.

Date of Survey  
**July 16, 1975**  
Registered Professional Engineer and Land Surveyor  
**676**

Certificate No. **676**  
**JOHN W. WEST**

0 330 660 990 1320 1650 1980 2310 2640 2000 1800 1000 800 0