

NO. OF COPIES RECEIVED	
DISTRIBUTION	
SANTA FE	
FILE	
U.S.G.S.	
LAND OFFICE	
OPERATOR	

# NEW MEXICO OIL CONSERVATION COMMISSION

30-025-25177  
Form C-101  
Revised 1-1-65

5A. Indicate Type of Lease STATE <input checked="" type="checkbox"/> FEE <input type="checkbox"/>
5. State Oil & Gas Lease No. LG 2686
7. Unit Agreement Name
8. Farm or Lease Name PATTY LOU - STATE
9. Well No. 1
10. Field and Pool, or Wildcat Wildcat
12. County Lea
19. Proposed Depth 12,000
19A. Formation Lower Strawn
20. Rotary or C.T. Rotary
21. Elevations (Show whether DF, RT, etc.) 3930.3 GL
21A. Kind & Status Plug Bond Blanket \$10,000
21B. Drilling Contractor TRG Drilling Corp.
22. Approx. Date Work will start on Approval

APPLICATION FOR PERMIT TO DRILL, DEEPEN, OR PLUG BACK	
1a. Type of Work b. Type of Well OIL WELL <input checked="" type="checkbox"/> GAS WELL <input type="checkbox"/> OTHER <input type="checkbox"/> DRILL <input checked="" type="checkbox"/> DEEPEN <input type="checkbox"/> PLUG BACK <input type="checkbox"/> SINGLE ZONE <input checked="" type="checkbox"/> MULTIPLE ZONE <input type="checkbox"/>	
2. Name of Operator Roger C. Hanks	
3. Address of Operator P. O. Box 3148, Midland, TX 79701	
4. Location of Well UNIT LETTER A LOCATED 554 FEET FROM THE North LINE AND 554 FEET FROM THE East LINE OF SEC. 30 TWP. 16S RGE. 36E NMPM	
23. PROPOSED CASING AND CEMENT PROGRAM	

SIZE OF HOLE	SIZE OF CASING	WEIGHT PER FOOT	SETTING DEPTH	SACKS OF CEMENT	EST. TOP
15"	13 3/8"	54 1/2#	420'	Circ.	Surface
11"	8 5/8"	24# & 32#	4300'	400	2500'
7 7/8"	4 1/2"	11.60# N-80 & K-55	11,500'	300	10,000'

Operator plans to drill a twin to a plugged and abandoned well (State "L" #1) drilled 10-14-52 by Lawton Oil Corp. and plugged by them on 3/5/53.  
Operator anticipates Wolfcamp at 10,500' and will test by open hole DST or log.  
Operator also anticipates Lower Strawn at 11,400'  
If either zone proves productive, 4 1/2" production string will be run.  
If dry hole, plugging will be done according to Oil Conservation Commission regulations.

IN ABOVE SPACE DESCRIBE PROPOSED PROGRAM: IF PROPOSAL IS TO DEEPEN OR PLUG BACK, GIVE DATA ON PRESENT PRODUCTIVE ZONE AND PROPOSED NEW PRODUCTIVE ZONE. GIVE BLOWOUT PREVENTER PROGRAM, IF ANY.

I hereby certify that the information above is true and complete to the best of my knowledge and belief.

Signed Roger C. Hanks Title Operator Date November 24, 1975

(This space for State Use)

APPROVED BY Jerry L. Linton TITLE  DATE

CONDITIONS OF APPROVAL, IF ANY:

RECEIVED

11/11/75

U.S. GOVERNMENT COMM  
COMM

**NEW MEXICO OIL CONSERVATION COMMISSION  
WELL LOCATION AND ACREAGE DEDICATION PLAN**

Form C-102  
Supersedes C-128  
Effective 1-1-65

All distances must be from the outer boundaries of the Section

Operator <b>Roger C. Hanks</b>			Lease <b>Patty Lou State</b>		Well No. <b>1</b>
Tract Letter <b>A</b>	Section <b>30</b>	Township <b>16 South</b>	Range <b>36 East</b>	County <b>Lea</b>	
Actual Footage Location of Well:					
<b>554</b>	feet from the	<b>North</b>	line and	<b>554</b>	feet from the
				<b>East</b>	
Ground Level Elev. <b>3930.3</b>	Producing Formation		Pool	Feet from Acreage <b>80</b>	

1. Outline the acreage dedicated to the subject well by colored pencil or hatchure marks on the plat below.
2. If more than one lease is dedicated to the well, outline each and identify the ownership thereof (both as to working interest and royalty).
3. If more than one lease of different ownership is dedicated to the well, have the interests of all owners been consolidated by communitization, unitization, force-pooling, etc?

☐ Yes    ☐ No    If answer is "yes," type of consolidation \_\_\_\_\_

If answer is "no," list the owners and tract descriptions which have actually been consolidated (on reverse side of this form if necessary.) \_\_\_\_\_

No allowable will be assigned to the well until all interests have been consolidated (by communitization, unitization, forced-pooling, or otherwise) or until a non-standard unit, eliminating such interests, has been approved by the Commission.

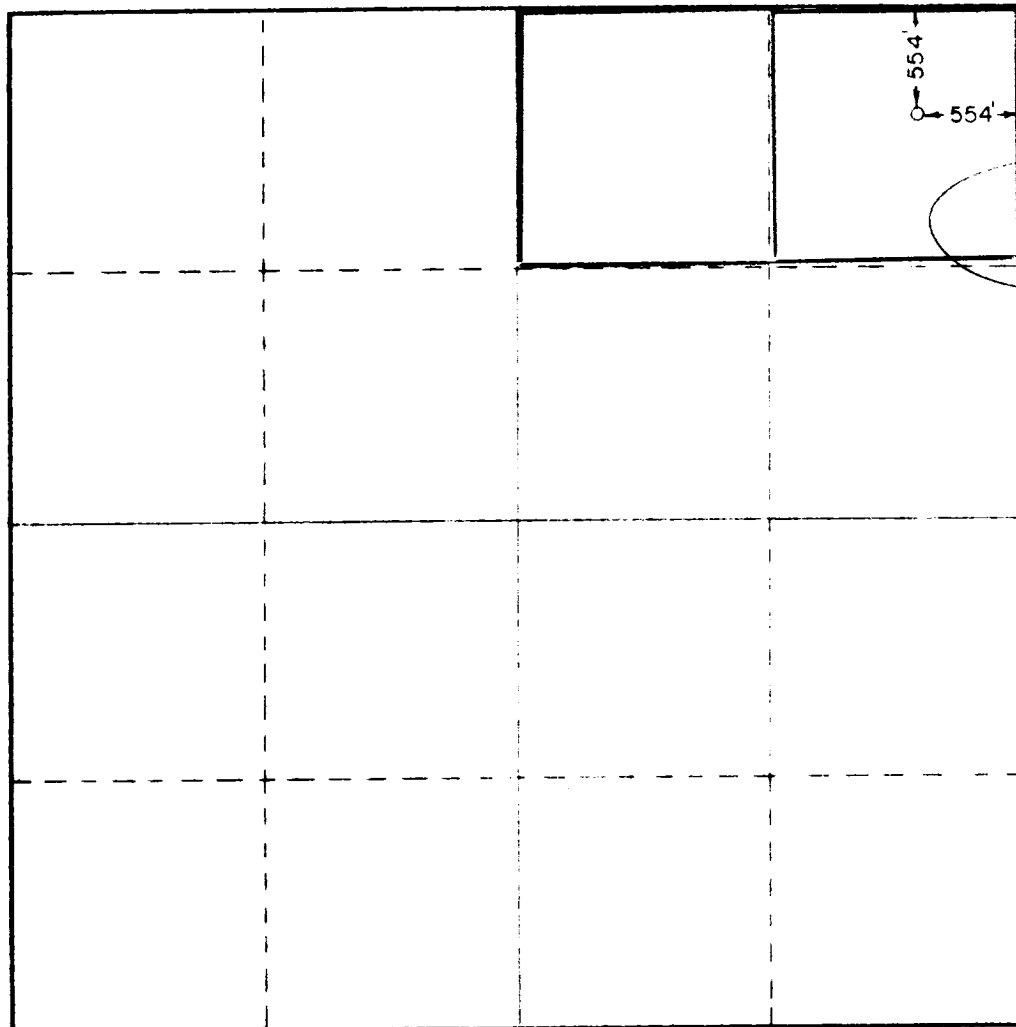

**CERTIFICATION**

I hereby certify that the information contained herein is true and complete to the best of my knowledge and belief.

By: *Roger C. Hanks*  
Operator

Company  
**Roger C. Hanks**

Date  
**November 24, 1975**

I hereby certify that the well location shown on this plat was plotted from field notes of actual surveys made by me or under my supervision, and that the same is true and correct to the best of my knowledge and belief.

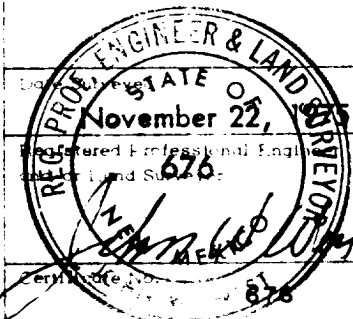

0 330 660 990 1320 1650 1980 2310 2640 2970 3300

RECEIVED

NOV 24 1975

OIL CONSERVATION BOARD  
HONOLULU, HAWAII

NO. OF COPIES RECEIVED	
DISTRIBUTION	
SANTA FE	
FILE	
U.S.G.S.	
LAND OFFICE	
OPERATOR	

# NEW MEXICO OIL CONSERVATION COMMISSION

Form C-103  
Supersedes Old  
C-102 and C-103  
Effective 1-1-65

5a. Indicate Type of Lease	
State <input checked="" type="checkbox"/>	Fee <input type="checkbox"/>
5. State Oil & Gas Lease No. LG-2686	

## SUNDRY NOTICES AND REPORTS ON WELLS

(DO NOT USE THIS FORM FOR PROPOSALS TO DRILL OR TO DEEPEN OR PLUG BACK TO A DIFFERENT RESERVOIR. USE "APPLICATION FOR PERMIT -" (FORM C-101) FOR SUCH PROPOSALS.)

1. OIL WELL <input checked="" type="checkbox"/> GAS WELL <input type="checkbox"/> OTHER <input type="checkbox"/>		7. Unit Agreement Name
2. Name of Operator Roger C. Hanks		8. Farm or Lease Name PATTY LOU - STATE
3. Address of Operator Box 3148, Midland, TX 79701		9. Well No. 1
4. Location of Well UNIT LETTER <u>A</u> , <u>554</u> FEET FROM THE <u>North</u> LINE AND <u>554</u> FEET FROM THE <u>East</u> LINE, SECTION <u>30</u> TOWNSHIP <u>16S</u> RANGE <u>36E</u> NMPM.		10. Field and Pool, or Wildcat Undesignated
15. Elevation (Show whether DF, RT, GR, etc.) 3930.3 GL		12. County Lea

### Check Appropriate Box To Indicate Nature of Notice, Report or Other Data

NOTICE OF INTENTION TO: SUBSEQUENT REPORT OF:

PERFORM REMEDIAL WORK <input type="checkbox"/>	PLUG AND ABANDON <input type="checkbox"/>	REMEDIAL WORK <input type="checkbox"/>	ALTERING CASING <input type="checkbox"/>
TEMPORARILY ABANDON <input type="checkbox"/>	CHANGE PLANS <input type="checkbox"/>	COMMENCE DRILLING OPNS. <input checked="" type="checkbox"/>	PLUG AND ABANDONMENT <input type="checkbox"/>
PULL OR ALTER CASING <input type="checkbox"/>	OTHER <input type="checkbox"/>	CASING TEST AND CEMENT JOBS <input type="checkbox"/>	OTHER <input type="checkbox"/>

17. Describe Proposed or Completed Operations (Clearly state all pertinent details, and give pertinent dates, including estimated date of starting any proposed work) SEE RULE 1103.

### Blowout Preventor Program:

Two Shafer Hydraulic Preventors and one GK High Drill Preventor with 3000-lb. working pressure ratings. (See attached sheet.)

18. I hereby certify that the information above is true and complete to the best of my knowledge and belief.

SIGNED <u>Roger C. Hanks</u>	TITLE <u>Operator</u>	DATE <u>November 26, 1975</u>
APPROVED BY <u>Jerry Lester</u>	TITLE <u></u>	DATE <u></u>
CONDITIONS OF APPROVAL, IF ANY:		



# MINIMUM BLOWOUT PREVENTER EQUIPMENT FOR HAZARDOUS INTERMEDIATE PRESSURE SERVICE

Class II (3000 psi WP - Series 900)

Note: For Air Drilling, Add Rotating Head above Hydrill Minimum 7" Flow Line, and Increase Size of Choke Line to 4".

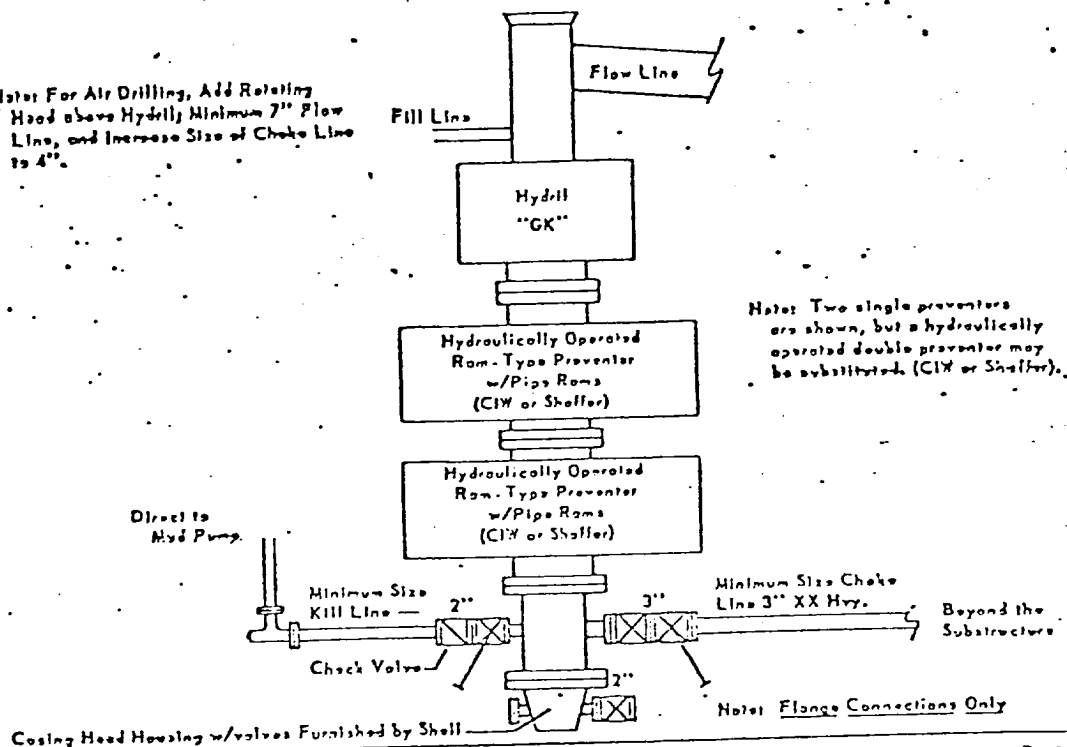

Note: Two single preventers are shown, but a hydraulically operated double preventer may be substituted (CIW or Shaffer).

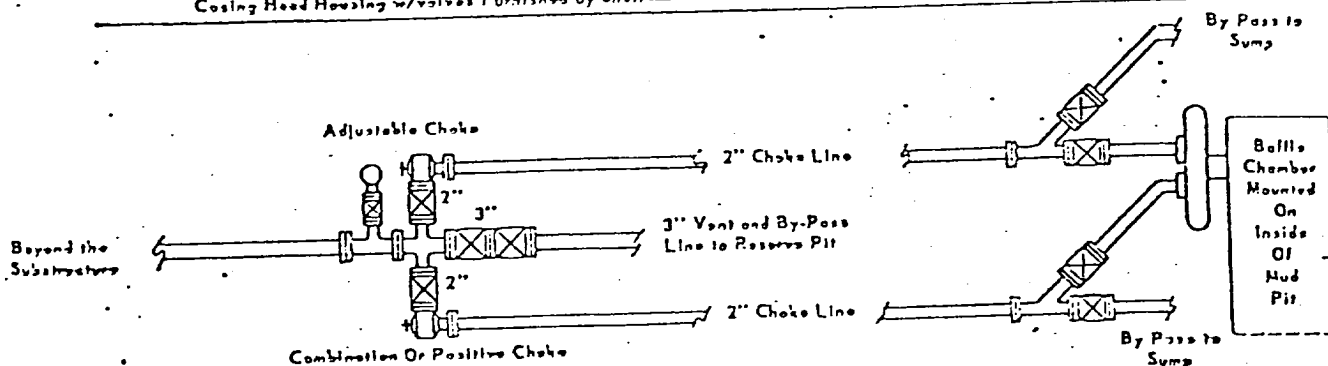

## MINIMUM REQUIREMENTS

1. All BOP's, valves, fittings and lines shall have 3000 psi WP (Series 900) ratings.
2. All equipment from the top preventer to the outermost valve or choke shall be pressure tested to 3000 psi.
3. All valves employed must be gate type suitable for high pressure mud service.
4. Outside valves on spool that are 4" or larger shall be hydraulically operated.
5. The Cameron steel ring and a rubber "O" ring shall be required on all BOP Flange connections.
6. Replacement parts for chokes shall be available at rig.
7. All lines shall be securely anchored.
8. Casing wear ring shall be required when the BOP is larger than the nominal casing size.
9. An 80 gallon hydraulic accumulator with an operating pressure of 1500 psi shall be required.
10. Two control points (a master control manifold and a remote control manifold including Hydrill) shall be properly equipped and connected to BOP's with steel lines.
11. Inside BOP and Kelly cock shall be provided.
12. BOP's shall have extensions for locking rams.
13. Outside valve on choke line and inside valve on kill line shall have extensions for operating with.
14. Valve on casing head housing shall be used only in an extreme emergency.
15. Choke and vent line shall be streamlined with no abrupt turns or bends.

111 111