

UNITED STATES  
DEPARTMENT OF THE INTERIOR  
GEOLOGICAL SURVEY

## APPLICATION FOR PERMIT TO DRILL, DEEPEN, OR PLUG BACK

## 1a. TYPE OF WORK

DRILL ☒DEEPEN ☐PLUG BACK ☐

## b. TYPE OF WELL

OIL  
WELL ☒GAS  
WELL ☐OTHER ☐

## 2. NAME OF OPERATOR

AMOCO PRODUCTION COMPANY SEP 03 1976

## 3. ADDRESS OF OPERATOR

P.O. DRAWER A, LEVELLAND, TEXAS 79336

## 4. LOCATION OF WELL (Report location clearly and in accordance with any State requirements.)

At surface

2310' FWL ; 380' FSL  
At proposed prod. zone

SEC. 25 (UNIT N 5E14 SW1/4)

## 14. DISTANCE IN MILES AND DIRECTION FROM NEAREST TOWN OR POST OFFICE\*

8 MILES SOUTHEAST OF MALAMAR, N.M.

## 15. DISTANCE FROM PROPOSED\*

LOCATION TO NEAREST  
PROPERTY OR LEASE LINE, FT.  
(Also to nearest drlg. unit line, if any)

## 16. NO. OF ACRES IN LEASE

968.56

17. NO. OF ACRES ASSIGNED  
TO THIS WELL

40

18. DISTANCE FROM PROPOSED LOCATION\*  
TO NEAREST WELL, DRILLING, COMPLETED,  
OR APPLIED FOR, ON THIS LEASE, FT.

## 19. PROPOSED DEPTH

8800'

## 20. ROTARY OR CABLE TOOLS

ROTARY

## 21. ELEVATIONS (Show whether DF, RT, GR, etc.)

3976.8 GL

## 22. APPROX. DATE WORK WILL START\*

9-27-76

## 23.

## PROPOSED CASING AND CEMENTING PROGRAM

SIZE OF HOLE	SIZE OF CASING	WEIGHT PER FOOT	SETTING DEPTH	QUANTITY OF CEMENT
17 1/2"	13 3/8"	48#	400'	CIRC
12 1/4"	9 5/8"	36#	3000'	Sufficient to fill to base of salt
8 3/4"	7"	23-26#	8800'	Sufficient to fill 1000' above top of Reef.

After drilling well, logs will be run and evaluations made, perforating and/or stimulating as necessary in attempting commercial production.

Mud Program - Suor to SCP - Native mud & water  
SCP to ICP - Native mud & water becoming salt saturated  
ICP to TD - Water and minimum quality gel for safe  
operating conditions.

BOP PROGRAM ATTACHED.

IN ABOVE SPACE DESCRIBE PROPOSED PROGRAM: If proposal is to deepen or plug back, give data on present productive zone and proposed new productive zone. If proposal is to drill or deepen directionally, give pertinent data on subsurface locations and measured and true vertical depths. Give blowout preventer program, if any.

## 24.

SIGNED

Ray W. Cox

TITLE

Administrative Assistant

DATE

8/31/76

(This space for Federal or State office use)

PERMIT NO.

APPROVAL DATE

APPROVED BY

CONDITIONS OF APPROVAL, IF ANY:

Unless Drilling Operations have  
Commenced, this drilling approval  
Expires 12-30-76

\*See Instructions On Reverse Side

APPROVED  
AS AMENDED

SEP 30 1976

BERNARD MOROZ  
ACTING DISTRICT ENGINEER

015-45GS-ART

1- DIV.  
1- SUSP  
1- RC

NEW MEXICO OIL CONSERVATION COMMISSION  
WELL LOCATION AND ACREAGE DEDICATION PLAT

Form C-102  
Supersedes C-128  
Effective 1-1-65

RECEIVED  
SEP 03 1976

All distances must be from the outer boundaries of the Section

U.S. GEOLOGICAL SURVEY  
ARTESIA, NEW MEXICO

1

Operator <b>AMOCO PRODUCTION COMPANY</b>			Lease <b>Miller B-Federal</b>		
Unit Letter <b>N</b>	Section <b>25</b>	Township <b>17South</b>	Range <b>32 East</b>	County <b>Lea</b>	
Actual Footage Location of Well: <b>2310</b> feet from the <b>west</b> line and <b>380</b> feet from the <b>south</b> line					
Ground Level Elev. <b>3976.8</b>	Producing Formation <b>ABO</b>		Pool <b>UNDESIGNATED CORBIN ABO</b>	Dedicated Acreage: <b>40</b> Acres	

1. Outline the acreage dedicated to the subject well by colored pencil or hatchure marks on the plat below.
2. If more than one lease is dedicated to the well, outline each and identify the ownership thereof (both as to working interest and royalty).
3. If more than one lease of different ownership is dedicated to the well, have the interests of all owners been consolidated by communitization, unitization, force-pooling, etc?

☐ Yes ☐ No If answer is "yes," type of consolidation \_\_\_\_\_

If answer is "no," list the owners and tract descriptions which have actually been consolidated. (Use reverse side of this form if necessary.) \_\_\_\_\_

No allowable will be assigned to the well until all interests have been consolidated (by communitization, unitization, forced-pooling, or otherwise) or until a non-standard unit, eliminating such interests, has been approved by the Commission.

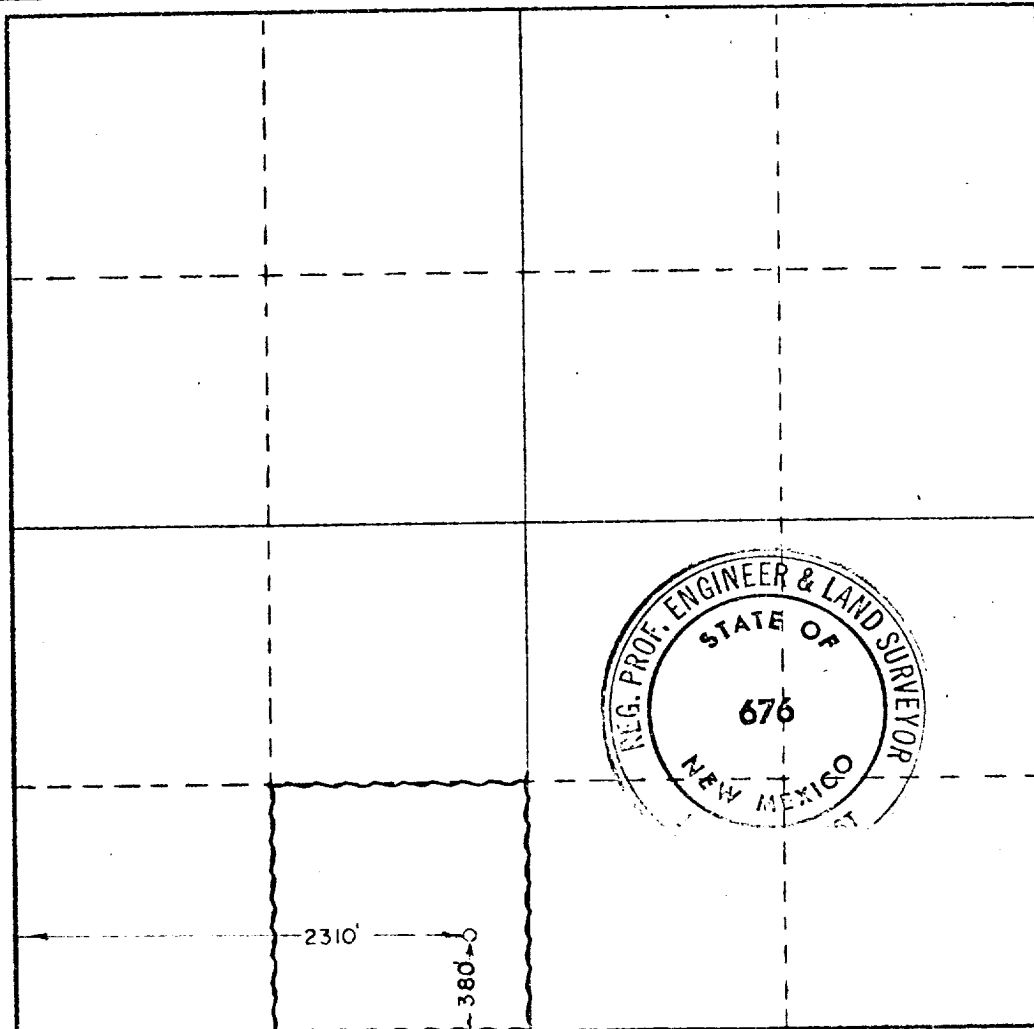

CERTIFICATION

I hereby certify that the information contained herein is true and complete to the best of my knowledge and belief.

Name *Ray W. Cox*  
Position **Administrative Assistant**  
Company **AMOCO PRODUCTION COMPANY**

Date **8/31/76**

I hereby certify that the well location shown on this plat was plotted from field notes of actual surveys made by me or under my supervision, and that the same is true and correct to the best of my knowledge and belief

Date Surveyed  
**August 20, 1976**

Registered Professional Engineer and/or Land Surveyor

*John W. West*  
Certificate No. **676**

0 320 640 960 1280 1600 1920 2240 2560 2880 3200 3520 3840 4160 4480 4800 5120 5440 5760 6080 6400

Attachment to "Application for Permit to Drill" Form 9-331 C

Miller "B" Federal Well No. 1

Unit N, Sec. 25, T-17-S, R-32-E

1. Location (See Attached Form C-102)
2. Elevation (See Attached Form C-102)
3. Geologic name of surface formation  
Mescalero Sand
4. Type of drilling tools and associated equipment to be utilized.  
(See Form 9-331 C)
5. Proposed drilling depth. (See Form 9-331 C)
6. Estimated tops of important geologic markers.  
Top of Anhydrite - 1620'  
Top of Yates - 3200'  
Top of Abo Reef - 8400'
7. Estimated depths at which anticipated water, oil, gas or other mineral bearing formations are expected to be encountered.  
Abo - 8400' to 8800'
8. Proposed casing program including size, grade, and weight of each string and whether it is new or used. (See Form 9-331 C)
9. Proposed setting depth of each casing string and the amount and type of cement (including additives) to be used. (See Form 9-331 C)

10. Operator's minimum specifications for pressure control equipment which is to be used, a schematic diagram thereof showing sizes, pressure ratings (or API series) and the testing procedures and testing frequency. (See Attached BOP Program)

---

---

---

---

11. Type and characteristics of the proposed circulating medium or mediums to be employed for rotary drilling and the quantities and types of mud and weighting material to be maintained.

(See Form 9-331 C)

---

---

---

---

---

---

12. Testing, logging and coring programs to be followed with provisions made for required flexibility.

See Form 9-331 C

---

---

---

---

---

---

13. Any anticipated abnormal pressures or temperatures expected to be encountered or potential hazards such as hydrogen sulfide gas, along with plans for mitigating such hazards.

None anticipated

---

---

---

---

---

---

14. Anticipated starting date and duration of operation.

September 27 to October 15

---

---

15. Other facets of the proposed operation, operator wishes to point out for the Geological Survey's consideration of the application.

# BLOWOUT PREVENTER HOOK-UP FOR DRILLING BELOW INTERMEDIATE CASING

1. BLOWOUT PREVENTERS AND MASTER VALVE TO BE FLUID OPERATED AND ALL FITTINGS MUST BE IN GOOD CONDITION (MINIMUM: WP - 3000 PSI, TEST - 6000 PSI).
2. EQUIPMENT THROUGH WHICH BIT MUST PASS SHALL BE AS LARGE AS THE INSIDE DIAMETER OF CASING THAT IS BEING DRILLED THROUGH.
3. KELLY COCK REQUIRED (MINIMUM: 3000 PSI WP, 6000 PSI TEST)
4. OMSCO OR COMPARABLE SAFETY VALVE MUST BE AVAILABLE ON RIG FLOOR AT ALL TIMES WITH PROPER CONNECTION OR SUB. (MINIMUM: 3000 PSI WP, 6000 PSI TEST)

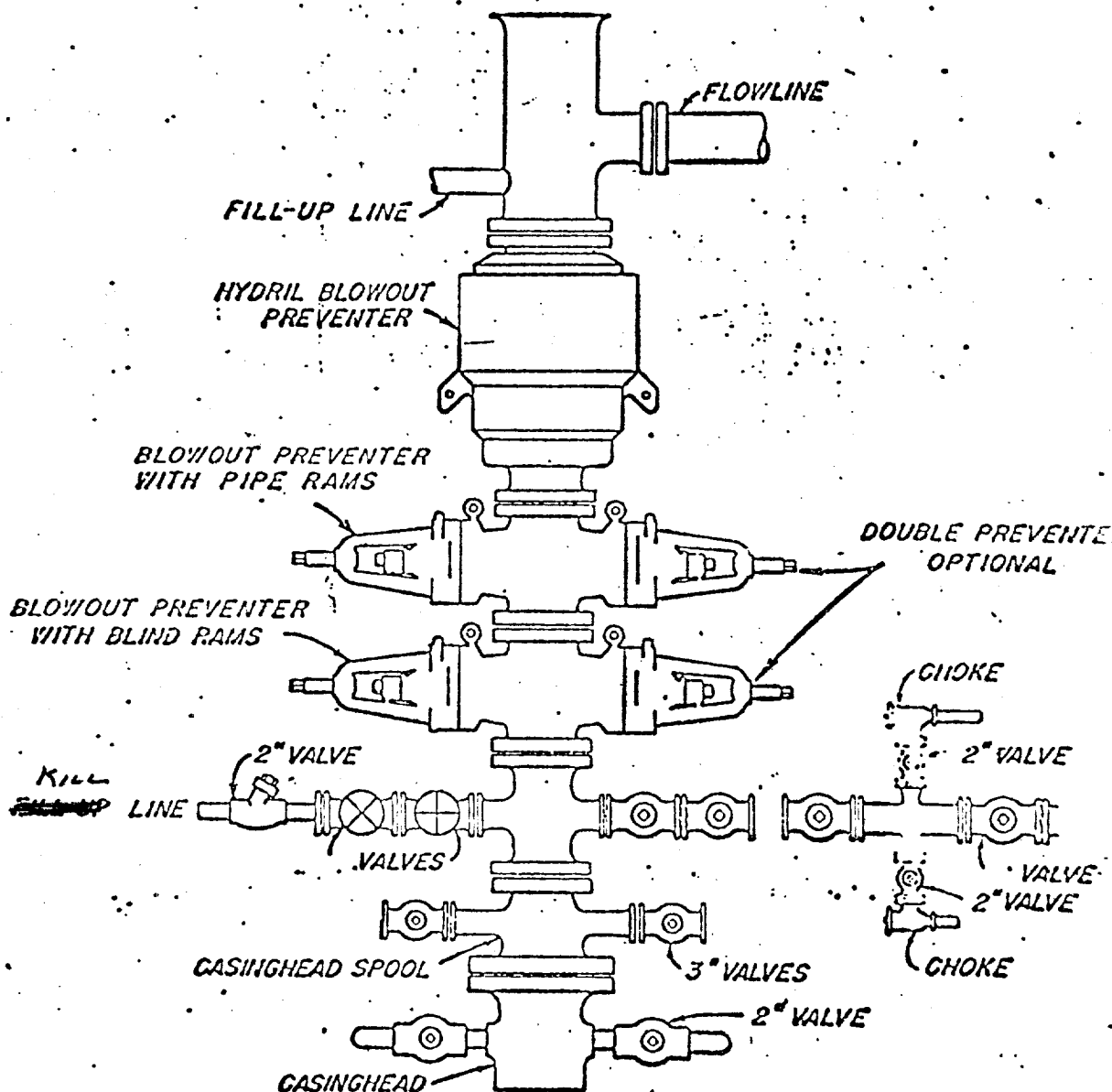

## Proposed Development Plan for Surface Use

Amoco Production Company's Miller "B" Federal Well No. 1

Unit N, Sec 25, T-17-S, R-32-E, Lea County, NM

Lease LC-058697-B

This plan is an attachment to "Application for Permit to Drill" and is a discussion of the possible effects the drilling of this well/wells might have on the environment. A copy will be posted on the derrick floor so that all contractors and sub-contractors will be aware of all items of this plan.

1. Existing roads including location of exit from main highway. (See Attached Map)  
Exhibit A shows the well as staked. 4.8 miles south of Maljamar on State Hwy 30 and 1.8 miles east on State Hwy 529, a lease road goes north approx. 6 miles, then east approx. 6 miles to Franklin Aston Fair Aztec State #1Y.
2. Planned access roads. (Width, maximum grade, turnout, drainage design, location and size of culverts and surfacing material, where fences will be cut and where gates or cattleguard will be used) (See Attached Map) Exhibit B - Construct approx. 1000 ft of new road to be 12 ft wide X 6" thick watered & compacted caliche. Road to be constructed north from Franklin Aztec #1Y to proposed well site. The center line of the proposed new road from the beginning to the well site has been staked and flagged with the stakes being visible from any one to the next.
3. Location of existing wells. (See Attached Map)  
(2-Mile radius for exploratory wells; 1-Mile radius for development wells)  
Exhibit "C"
4. Location of tank batteries and flow lines. (See Attached Map)  
If well is a producer, tank battery will be built on well site.
5. Location and type of water supply. (See Attached Map)  
X Water to be hauled water to piped  
Fresh water to be hauled from Caprock Water Company in Maljamar. Brine water to be hauled from Potash Company of America Mine northeast of Carlsbad, NM.
6. Source of construction materials. (See Attached Map)  
Caliche pit is located in SE/4 SE/4 Sec 26, T-17-S, R-32-E, approx .8 miles from Franklin Aztec #1Y. If pit has to be enlarged, it will be enlarged on the west end approx. 30' X 100'.

7. Methods for handling waste disposal. (See Attached Map)  
Well cuttings will be disposed in reserve pit. Suitable trash pits or containers will be provided at location for containment. If well is productive, maintenance waste will be placed in special trash cans and hauled away periodically.
- 
- 

8. Ancillary facilities. (Location of camps and airstrips to be installed)  
X None See Attached Map.

9. Well site layout. (See Attached Rig Layout)

- (a) Size of Drilling Pad 190' X 190'  
(b) Compacted 6" Thick  
(c) Surfaced

10. Plans for restoration of surface.

- X Producing Well - all pits will be cut, filled, and levelled as soon practical to original condition with rehabilitation to commence following removal of drilling and completion equipment. Rehabilitation to be completed in 90 days if possible.  
X Dry Hole - same as above with dry hole marker to be installed and surface reseeded if required.

11. Other information that may be used in evaluating the impact on the environment.

- (a) Terrain Relatively flat w/small sand dunes  
(b) Soil Sandy and shallow  
(c) Vegetation Mesquite, shinnery oak  
(d) Surface Use Grazing  
(e) Ponds and Streams None  
(f) Water Wells None  
(g) Residences and Buildings None  
(h) Arroyos, Canyons, etc. Mescalero Ridge 3 miles east of loc.  
(i) Well sign will be posted on location  
(j) Open pits will be fenced  
(k) Archaeological Resources None observed
- 
- 
- 
- 
- 

12. Operators Representative.

Field personnel responsible for compliance of development plan for surface use.

O. R. Williams

Area Foreman

P. O. Box 68

Hobbs, NM 88240

(505) 393-2167

LEASE & WELL NUMBER \_\_\_\_\_

LOCATION \_\_\_\_\_

ATTACHMENT TO PROPOSED DEVELOPMENT PLAN FOR SURFACE USE, AND FORM 9-331C

13. Certification: The following statement is to be incorporated in the plan and must be signed by the lessee's or operator's field representative who is identified in Item No. 12 of the plan.

I hereby certify that I, or persons under my direct supervision have inspected the proposed drillsite and access route; that I am familiar with the conditions which presently exist; that the statements made in this plan are, to the best of my knowledge, true and correct; and, that the work associated with the operations proposed herein will be performed by: AMOCO PRODUCTION COMPANY and its contractors and subcontractors in conformity with this plan and the terms and conditions under which it is approved.

9/2/76  
DATE

Orville J. Allen Allen  
NAME AND TITLE



ATTACHMENT TO FORM 9-331C

APPLICATION FOR PERMIT TO DRILL

LEASE Miller "B" Federal WELL NO. 1  
LOCATION Unit N, Sec 25, T-17-S, R-32-E  
POOL Corbin Abo  
COUNTY Lea County, NM

The undersigned hereby states that Amoco's representative, Mr. D. C. Peurifoy, personally contacted Mr. Roy Warren, the owner/lessee of the surface land where the proposed work is to be conducted and advised him of the proposed work, the construction site and pertinent roads included in the project. It is further stated that, upon being fully advised of the extent of the work and the effect upon the surface, said owner has consented to the said work and that agreement as to the compensation for damages to the surface estate has been reached. Mr. Warren does not require any additional surface restoration beyond normal operations as outlined in section 10 of attached Surface Use Plan.

Ray W. Cox  
Ray W. Cox  
Administrative Assistant

9/2/76  
DATE

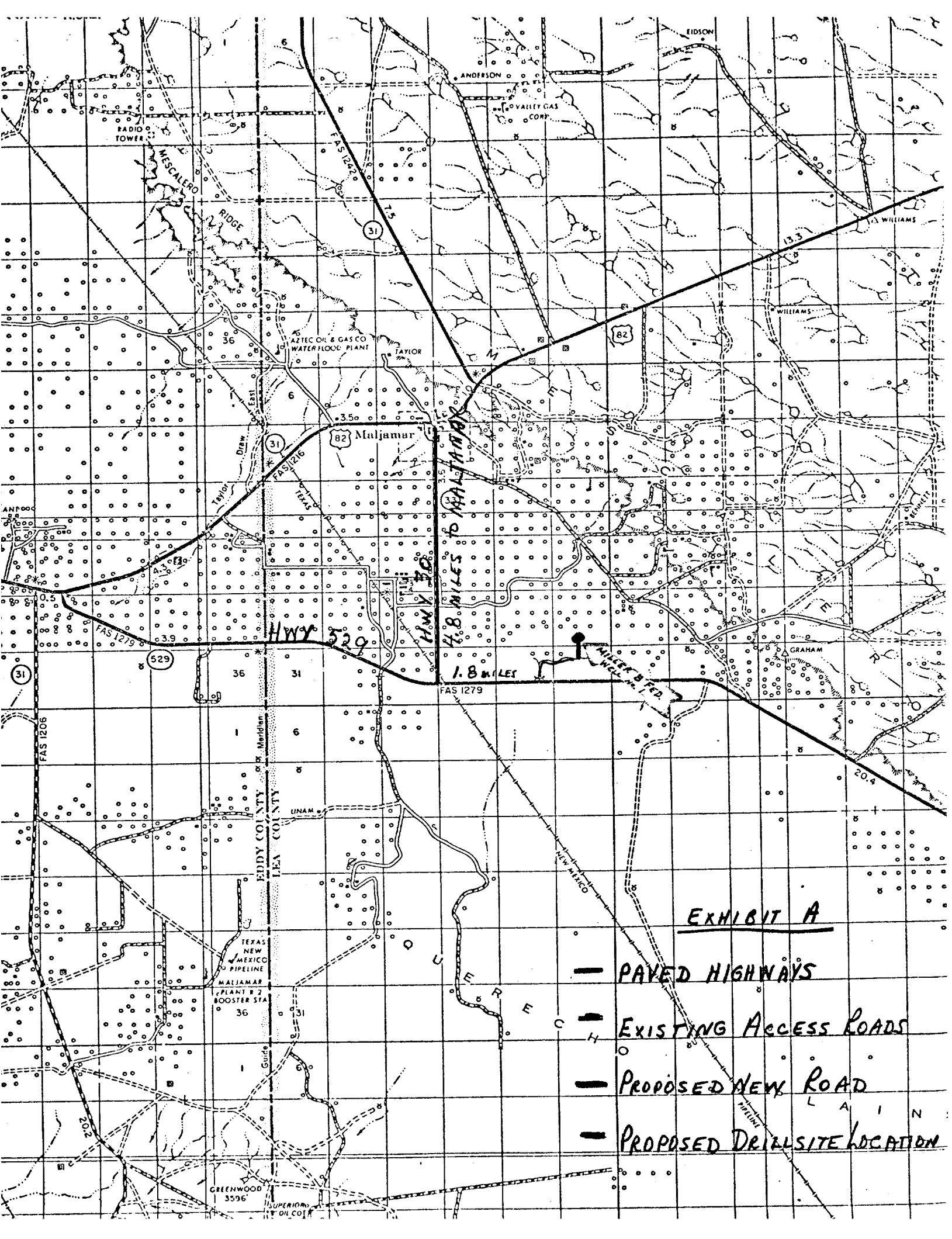

EXHIBIT A

- PAVED HIGHWAYS
- EXISTING ACCESS ROADS
- PROPOSED NEW ROAD
- PROPOSED DRILLSITE LOCATION



# Amoco Production Company

ENGINEERING CHART

SHEET NO. \_\_\_\_\_ OF \_\_\_\_\_

FILE \_\_\_\_\_

APPN \_\_\_\_\_

DATE \_\_\_\_\_

BY \_\_\_\_\_

SUBJECT MILLER "B" FEDERAL WELL No. 1

SEC. 25, T-17-S, R-32-E, LEA Co., N.M.

R-32-E

MALJAMAR

NORTH

15

14

13

22

23

24

27

26

25

34

35

36

CALICHE PIT

MILLER "B" FEDERAL #1

FRANKLIN, ASTON FAIR AZTEC #1 Y

.6 mi

.6 mi

1.8 MILES

HWY 529

TO

CARLSBAD

TO

HOBBS

## LEGEND

- EXISTING ROADS
- PROPOSED NEW ROAD
- NEW WELL
- EXISTING WELL
- TOWN BETWEEN

EXHIBIT B

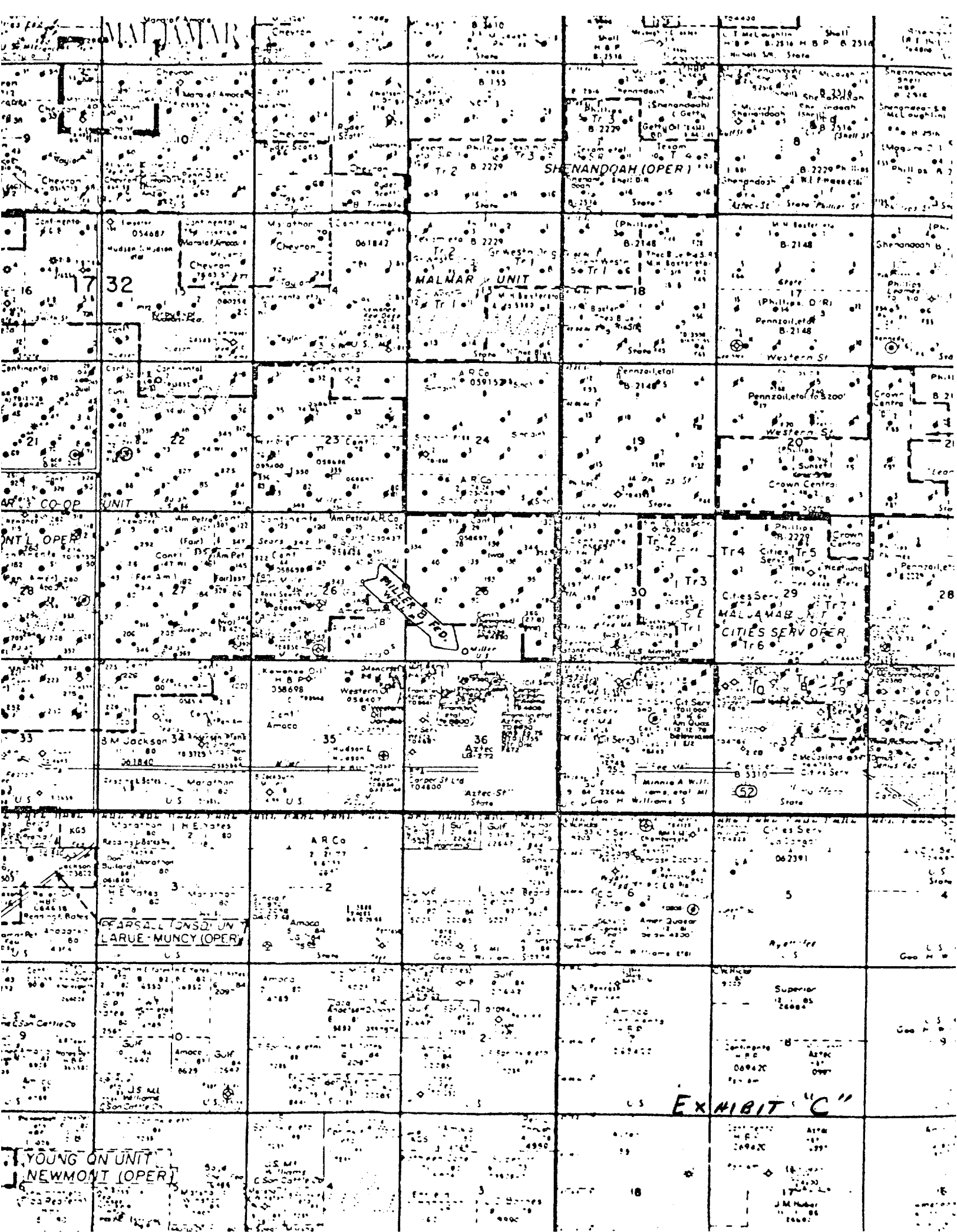

# DRILL SITE DIMENSIONS

MEDIUM DEEP WELL (8000'-14000')\*

TRASH PIT  
8' x 20' x 6'

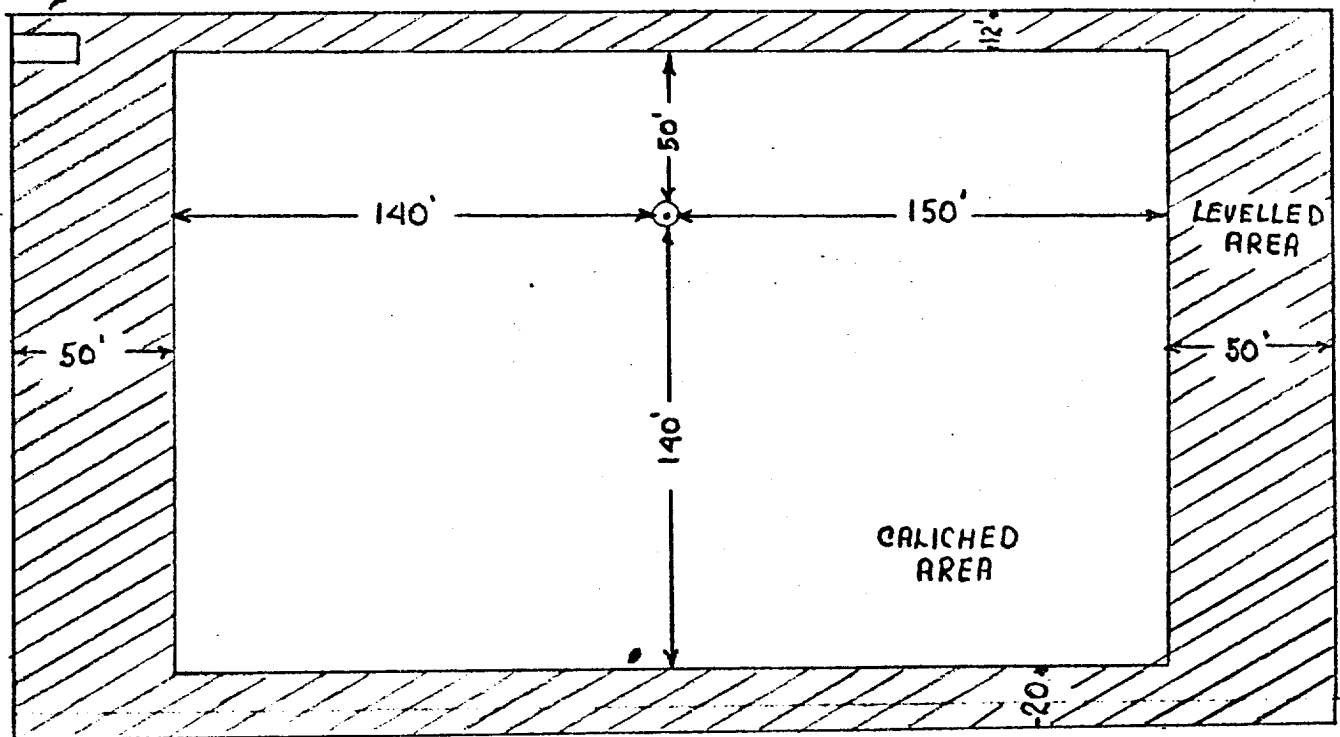

## CELLAR SIZES:

5' x 5' x 4' - 2 CASING STRINGS (0-6000')  
 7' x 7' x 6' - 3 " "  
 8' x 8' x 8' - 4 " "

\*-SITE SIZE FOR PRACTICALLY ALL MORROW WELLS.

-WELLS DEEPER THAN 14,000' WILL REQUIRE SPECIAL HANDLING  
 ON SIZING DRILL SITE

Amoco Production Company

SCALE: 1" = 60'

MILLER "B" FEDERAL WELL No. 1

UNIT N, SEC. 25, T-17-S, R-32-E, LEA Co., N.M.

DRG.  
NO.

174

174

DEFERRED

NO. 1476  
1-10-1976  
1-10-1976

FUEL TANKS  
8'x27'

WATER  
TANK  
12'x21'

MUD  
PMP

LIGHT  
PLANT

60'  
RESERVE  
PIT  
60'  
WORKING PIT  
8'-18'

SUBSTRUCTURE  
10'x34' 6-HOLE  
DOG HOUSE  
STEP

200  
CLOSING  
UNIT  
25' TO HOSE

V-DOOR  
STEP

CATWALK + V-DOOR 63'

PIPE RACKS 54'

PIPE & CASING RACK 63'

26'  
Derrick  
STUBS



Amoco Production Company		SCALE:
MILLER B FEDERAL #1		
GENERAL RIG LAYOUT UNIT N, SEC 25, T-17-S, R-32-E		DRG. NO.

RECEIVED

NOV 6 1976  
OIL CONSERVATION COMM.  
DENVER, CO.

11