

**NEW MEXICO OIL CONSERVATION COMMISSION
WELL LOCATION AND ACREAGE DEDICATION PLAT**

Revised E. C-102
Supersedes C-12
Effective 1-1-65

All distances must be from the outer boundaries of the Section.

Operator W. A. Moncrief, Jr.			Lease State		Well No. 1
Unit Letter E	Section 26	Township 16S	Range 33E	County Lea	
Actual Footage Location of Well:					
1980 feet from the North line and		661 feet from the West line			
Ground Level Elev. 4186	Producing Formation Wolfcamp		Pool Kemnitz Lower Wolfcamp		Dedicated Acreage: 80 Acres

1. Outline the acreage dedicated to the subject well by colored pencil or hachure marks on the plat below.
2. If more than one lease is dedicated to the well, outline each and identify the ownership thereof (both as to working interest and royalty).
3. If more than one lease of different ownership is dedicated to the well, have the interests of all owners been consolidated by communitization, unitization, force-pooling, etc?

☐ Yes ☐ No If answer is "yes," type of consolidation _____

If answer is "no," list the owners and tract descriptions which have actually been consolidated. (Use reverse side of this form if necessary.) _____

No allowable will be assigned to the well until all interests have been consolidated (by communitization, unitization, forced-pooling, or otherwise) or until a non-standard unit, eliminating such interests, has been approved by the Commission.

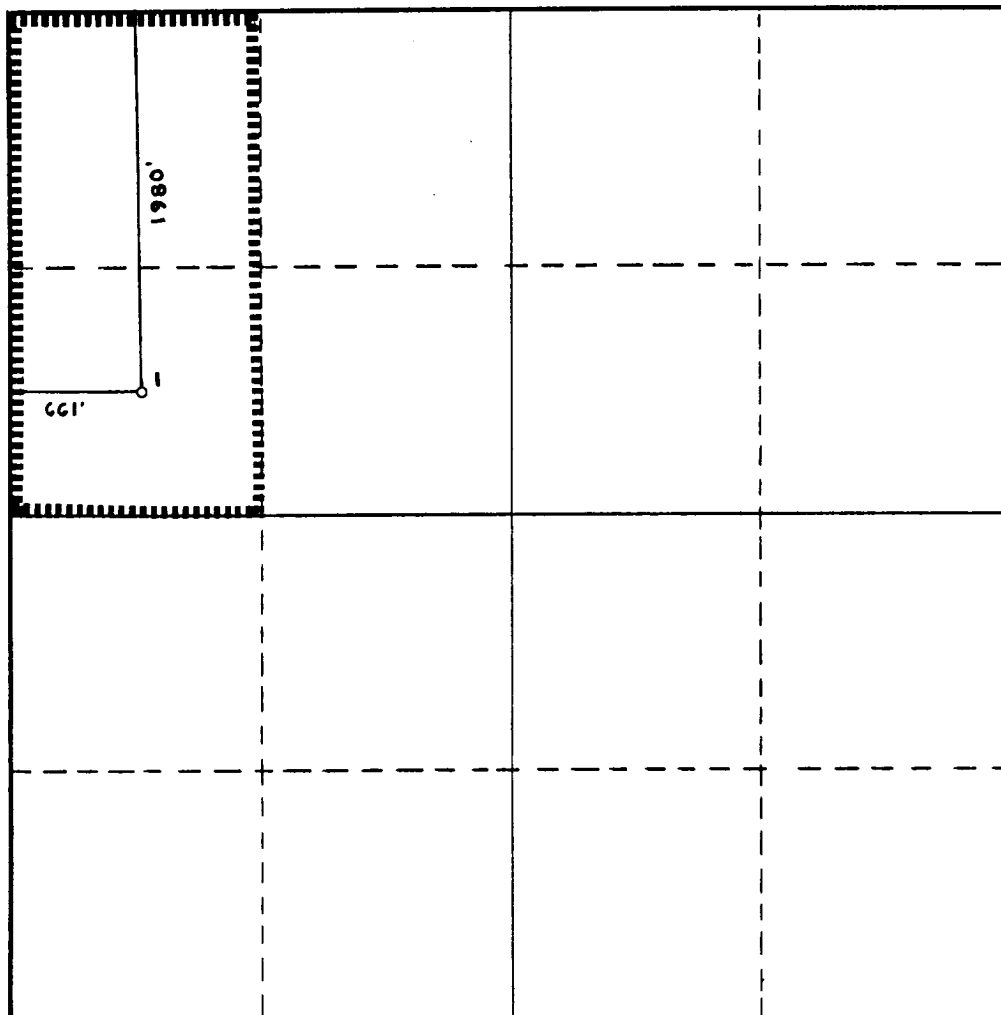

CERTIFICATION

I hereby certify that the information contained herein is true and complete to the best of my knowledge and belief.

Dewey E. Thornton

Name

DEWEY E. THORNTON

Position

EXPLORATION MANAGER

Company

W. A. MONCRIEF, JR.

Date

SEPTEMBER 16, 1977

I hereby certify that the well location shown on this plat was plotted from field notes of actual surveys made by me or under my supervision, and that the same is true and correct to the best of my knowledge and belief.

Date Surveyed

Registered Professional Engineer
and/or Land Surveyor

Certificate No.

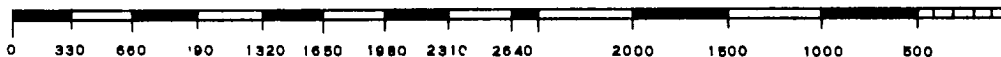

RESERVED

OCT 11 1977

OIL CONSERVATION COMMISSION
HOBBS, N. M.

**NEW MEXICO OIL CONSERVATION COMMISSION
WELL LOCATION AND ACREAGE DEDICATION PLAT**

Form C-102
Supersedes C-128
Effective 1-1-65

All distances must be from the outer boundaries of the Section.

Operator W. A. MONCRIEF, JR.			Lease STATE		Well No. 1
Unit Letter E	Section 26	Township 16S	Range 33E	County Lea	
Actual Footage Location of Well:					
1980 feet from the North line and		661 feet from the West line			
Ground Level Elev. 4186	Producing Formation Morrow	Pool Undesignated		Dedicated Acreage: 320 Acres	

1. Outline the acreage dedicated to the subject well by colored pencil or hachure marks on the plat below.
2. If more than one lease is dedicated to the well, outline each and identify the ownership thereof (both as to working interest and royalty).
3. If more than one lease of different ownership is dedicated to the well, have the interests of all owners been consolidated by communitization, unitization, force-pooling, etc?

☐ Yes ☐ No If answer is "yes," type of consolidation _____

If answer is "no," list the owners and tract descriptions which have actually been consolidated. (Use reverse side of this form if necessary.) _____

No allowable will be assigned to the well until all interests have been consolidated (by communitization, unitization, forced-pooling, or otherwise) or until a non-standard unit, eliminating such interests, has been approved by the Commission.

R 33 E

T
1
6
S

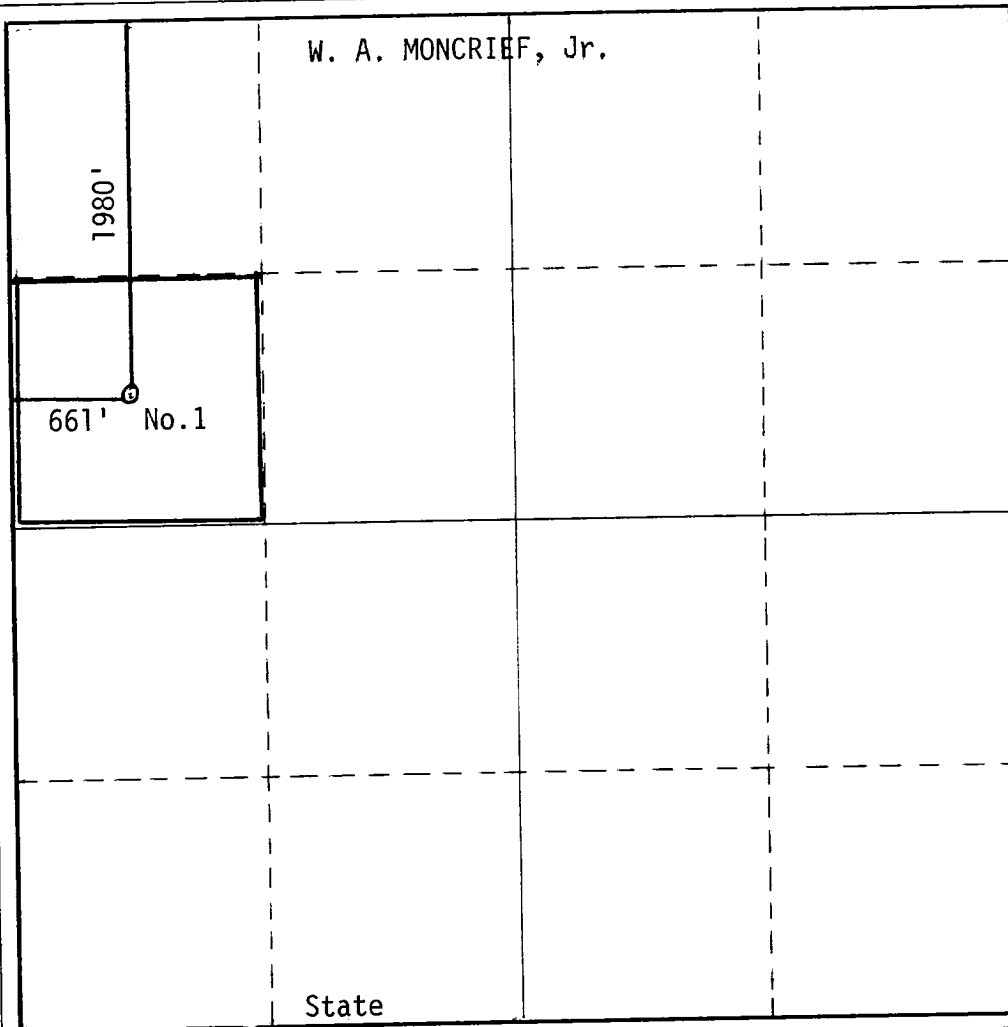

CERTIFICATION

I hereby certify that the information contained herein is true and complete to the best of my knowledge and belief.

[Signature]

Name

F. W. Rabalais

Position

Petroleum Engineer

Company

W. A. Moncrief, Jr.

Date

August 31, 1977

I hereby certify that the well location shown on this plat was plotted from field notes of actual surveys made by me or under my supervision, and that the same is true and correct to the best of my knowledge and belief.

Date Surveyed

Registered Professional Engineer
and/or Land Surveyor

Certificate No.

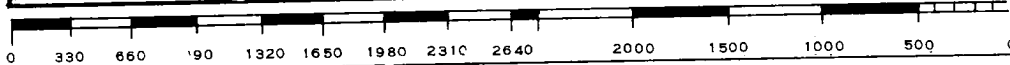



2 197
GIL CO. COMM.
HOBBS, N. M.

EA.
MONCRIEF, W. A., JR.

Wildcat
1 State
Sec 26, T16S, R33E

NM
Page #2

1-18-77

Continued

@ 250#), 1 hr ISIP 2450#, FP 254-410#, 1 hr
FSIP 4265#, HP 5910-5884#, BHT 156 deg
DST (Seaman) 11,594-616', open 1 hr 45 mins,
GTS in 7 mins, OTS in 1 hr, flwd 2000 MOFGPD
+ 40 BOPH thru 1/2" chk, rev out 86.8 BO,
rec 120' wtr, 1 hr 30 min ISIP 4219#, FP 1006-
2186#, 3 hr FSIP 3268#, HP 6029-5943#, BHT
162 deg

1-25-77

Drlg 12,500' lm & sh
DST (Canyon Lime) 11,926-12,054', open 2 hrs
45 mins, rec 1855' GIDP + 210' sli G&OCM
(Sampler rec 1200 cc's DM @ 50#), 1 hr 45 mins

4-3-14 NM

1-25-77

Continued

2-1-77

3484#, FP 130-107#, 3 hr FSIP 3921#

2-7-77

TD 12,975'; Rng DST
Drlg 13,469' lm, sh & sd
DST (Atoka) 12,900-975', open 1 hr 15 mins,
rec 1475' WC + 94' DM (Sampler rec 2800 cc's
DM), 90 min ISIP 5694#, FP 739-739#, 2 hr
FSIP 4895#, HP 6899-6899#, BHT 172 deg

2-14-77

Drlg 13,948'
DST (Morrow) 13,291-575', open 1 hr 15 mins
rec 1970' WC + 60' DM (Sampler rec 2800 cc's
DM), 1 hr ISIP 1531#, FP 1094-1094#, 2 hr
FSIP 1444#, HP 7055-7055#, BHT 258 deg

2-21-77

Drlg 14,425' lm & cht
DST (Mississippian) 14,040-123', open 1 hr 15
mins, rec 2674' WC + 5' DM, (Sampler rec 2800

4-3-14 NM

LEA
MONCRIEF, W. A., JR.

Wildcat
1 State
Sec 26, T16S, R33E

NM
Page #3

2-21-77

Continued

2-28-77

3-7-77

3-15-77

3-22-77

3-28-77

gc's DM), 1 hr ISIP 1619#, FP 1225-1225#, 2 hr
FSIP 1750#, HP 7141-7141#, BHT 188 deg
Drlg 14,898' lm & dolo
TD 15,010'; Rng Csg
DST (Devonian) 14,830-15,000', open 1 hr 15 mins,
rec 3080' WB + 470' sulf wtr CM + 2250' sulf wtr,
1 hr ISIP 5943#, FP 1838-2748#, 2 hr FSIP 5943#,
HP 7482-7482#, BHT 218 deg
TD 15,010'; WOCU
TD 15,010'; WOCU
TD 15,010'; PBD 11,988'; Rng Tbg
Perf (Seaman) 11,602-625', 11,642-656' w/2 SPF

4-3-14 NM

4-4-77

TD 15,010'; PBD 11,988'; WOSP
Flwd 504 BO in 24 hrs thru 28/64" chk; GOR
2000; gty 40; CP Pkr; TP 360# (11,602-656')
Natural

4-11-77

Seaman Discovery: No Suggested Field Name
TD 15,010'; PBD 11,988'; Complete
LOG TOPS: Salt 1590', Base Salt 2600', Queen
3684', Grayburg 4093', San Andres 4440', Glorieta
5922', Tubb 7168', Abo Lime 7980', Wolfcamp
9692', Bursum 10,495', Kemnitz 10,754', Lower
Seaman 11,600', Canyon 11,960', Strawn 12,290',
Atoka 12,408', Mississippian 14,069', Devonian
14,860'

4-16-77

COMPLETION ISSUED

4-3-14 NM

IC 30-025-70239-76