

Submit to Appropriate  
District Office  
State Lease -- 6 copies  
Fee Lease -- 5 copies

State of New Mexico  
Energy, Minerals and Natural Resources Department

Form C-101  
Revised 1-1-89

OIL CONSERVATION DIVISION

P.O. Box 2088  
Santa Fe, New Mexico 87504-2088

DISTRICT I  
P.O. Box 1980, Hobbs, NM 88240

DISTRICT II  
P.O. Drawer DD, Artesia, NM 88210

DISTRICT III  
1000 Rio Brazos Rd., Aztec, NM 87410

API NO. (assigned by OCD on New Wells)  
300252556500

5. Indicate Type of Lease  
STATE ☐ FEE ☒

6. State Oil & Gas Lease No.

APPLICATION FOR PERMIT TO DRILL, DEEPEN, OR PLUG BACK

1a. Type of Work:

DRILL ☐ RE-ENTER ☐ DEEPEN ☐ PLUG BACK ☒

b. Type of Well:

OIL WELL ☒ GAS WELL ☐ OTHER ☐

SINGLE ZONE ☐ MULTIPLE ZONE ☐

7. Lease Name or Unit Agreement Name

Houston

2. Name of Operator

Conoco, Inc.

8. Well No.

1

3. Address of Operator

10 Desta Dr. Ste 100W, Midland, TX 79705-4500

9. Pool name or Wildcat

North Shoe Bar Strawn

4. Well Location  
Unit Letter D : 510 Feet From The North Line and 660 Feet From The West Line

Section 18 Township 16-S Range 36-E NMPM Lea County

10. Proposed Depth

11,437'

11. Formation

Strawn

12. Rotary or C.T.

Rotary

13. Elevations (Show whether DF, RT, GR, etc.)  
GL 3954'

14. Kind & Status Plug. Bond

15. Drilling Contractor

16. Approx. Date Work will start

17.

PROPOSED CASING AND CEMENT PROGRAM

SIZE OF HOLE	SIZE OF CASING	WEIGHT PER FOOT	SETTING DEPTH	SACKS OF CEMENT	EST. TOP
17½"	13 3/8"	48#	355'	400 sxs	Surface
12½"	9 5/8"	36#	4165'	1300 sxs	640'
8 3/4"	5½"	20#	11,519'	1000 sxs	8214'

It is proposed to recomplete the Houston No. 1 to the Strawn formation by the following procedures:

1. RIH with 4-5/8" bit and 5-½" casing scraper to PBTD @ 11,437'
2. Spot 10 bbls 20% NEFE HCl acid from 11,420'-11,364'.
3. Perforate the Strawn intervals (11,364'-11,378', 11,400'-11,406', 11,416'-11,420') with 4 JSPF for a total of 108 shots.
4. Acidize perforated intervals with 2900 gallons of 20% NEFE HCl.
5. Set packer @ 11,200' and return to production.

IN ABOVE SPACE DESCRIBE PROPOSED PROGRAM: IF PROPOSAL IS TO DEEPEN OR PLUG BACK, GIVE DATA ON PRESENT PRODUCTIVE ZONE AND PROPOSED NEW PRODUCTIVE ZONE. GIVE BLOWOUT PREVENTER PROGRAM, IF ANY.

I hereby certify that the information above is true and complete to the best of my knowledge and belief.

SIGNATURE Jerry W. Hoover TITLE Sr. Conservation Coordinator DATE 9/30/91

TYPE OR PRINT NAME Jerry W. Hoover

TELEPHONE NO. (915) 686-65

(This space for State Use)

APPROVED BY \_\_\_\_\_ TITLE \_\_\_\_\_ DATE \_\_\_\_\_

CONDITIONS OF APPROVAL, IF ANY:



Submit to Appropriate  
District Office  
State Lease - 4 copies  
Fee Lease - 3 copies

State of New Mexico  
Energy, Minerals and Natural Resources Department

Form C-102  
Revised 1-1-89

OIL CONSERVATION DIVISION

P.O. Box 2088  
Santa Fe, New Mexico 87504-2088

DISTRICT I  
P.O. Box 1980, Hobbs, NM 88240

DISTRICT II  
P.O. Drawer DD, Artesia, NM 88210

DISTRICT III  
1000 Rio Brazos Rd., Aztec, NM 87410

WELL LOCATION AND ACREAGE DEDICATION PLAT

All Distances must be from the outer boundaries of the section

Operator Conoco, Inc.			Lease Houston		Well No. 1
Unit Letter D	Section 18	Township 16S	Range 36E	County Lea	
Actual Footage Location of Well: 510 feet from the North line and 660 feet from the West line					
Ground level Elev. 3954'	Producing Formation Strawn		Pool North Shoe Bar Strawn		Dedicated Acreage: 160 Acres

- Outline the acreage dedicated to the subject well by colored pencil or hatchure marks on the plat below.
- If more than one lease is dedicated to the well, outline each and identify the ownership thereof (both as to working interest and royalty).
- If more than one lease of different ownership is dedicated to the well, have the interest of all owners been consolidated by communitization, unitization, force-pooling, etc.?  
☐ Yes ☐ No If answer is "yes" type of consolidation \_\_\_\_\_  
If answer is "no" list the owners and tract descriptions which have actually been consolidated. (Use reverse side of this form if necessary). \_\_\_\_\_  
No allowable will be assigned to the well until all interests have been consolidated (by communitization, unitization, forced-pooling, or otherwise) or until a non-standard unit, eliminating such interest, has been approved by the Division.

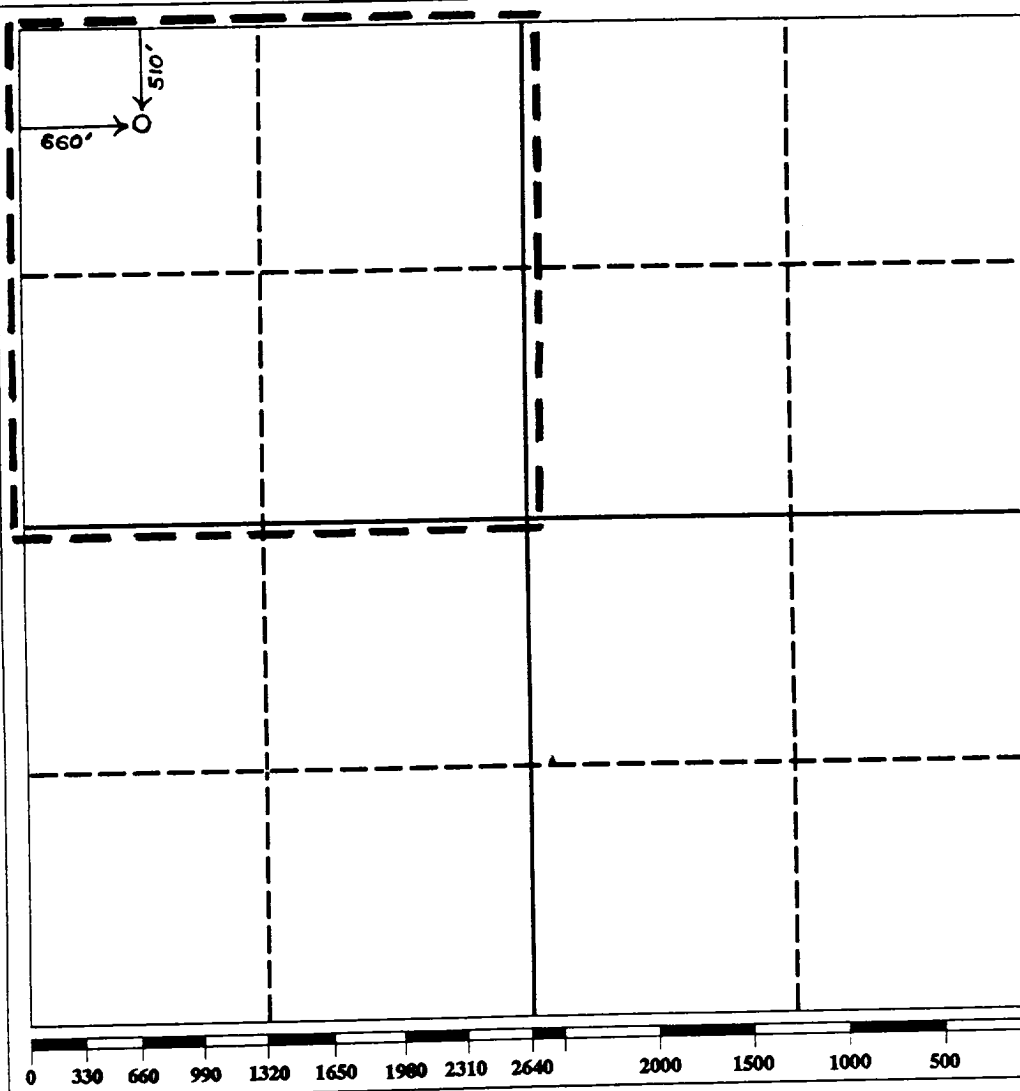

OPERATOR CERTIFICATION

I hereby certify that the information contained herein is true and complete to the best of my knowledge and belief.

Signature  
*Jerry W. Hoover*  
Printed Name  
Jerry W. Hoover  
Position  
Sr. Conservation Coord.  
Company  
Conoco, Inc.  
Date  
9/25/91

SURVEYOR CERTIFICATION

I hereby certify that the well location shown on this plat was plotted from field notes of actual surveys made by me or under my supervision, and that the same is true and correct to the best of my knowledge and belief.

Date Surveyed  
Signature & Seal of Professional Surveyor  
Certificate No.

