

NEW MEXICO OIL CONSERVATION COMMISSION
WELL LOCATION AND ACREAGE DEDICATION PLAT

Revised
8-1-75
Supercedes 1-1-75
Effective 1-1-75

All distances must be from the outer boundaries of the Section

W. A. Moncrief, Jr.			Lease Phillips State		Well No. 1-Y
Tract Letter 1	Section 8	Township 16S	Range 34E	County Lea	
Actual Postage Location of Well: 1675 feet from the south line and 625 feet from the east line					
Ground Level Elev. 4129	Producing Formation Morrow		Pool Hume Morrow Gas		Dedicated Acreage 320

1. Outline the acreage dedicated to the subject well by colored pencil or hatchure marks on the plat below.
2. If more than one lease is dedicated to the well, outline each and identify the ownership thereof (both as to working interest and royalty).
3. If more than one lease of different ownership is dedicated to the well, have the interests of all owners been consolidated by communitization, unitization, force-pooling, etc?

☐ Yes ☐ No If answer is "yes," type of consolidation _____

If answer is "no," list the owners and tract descriptions which have actually been consolidated. (Use reverse side of this form if necessary.) _____

No allowable will be assigned to the well until all interests have been consolidated (by communitization, unitization, forced-pooling, or otherwise) or until a non-standard unit, eliminating such interests, has been approved by the Commission.

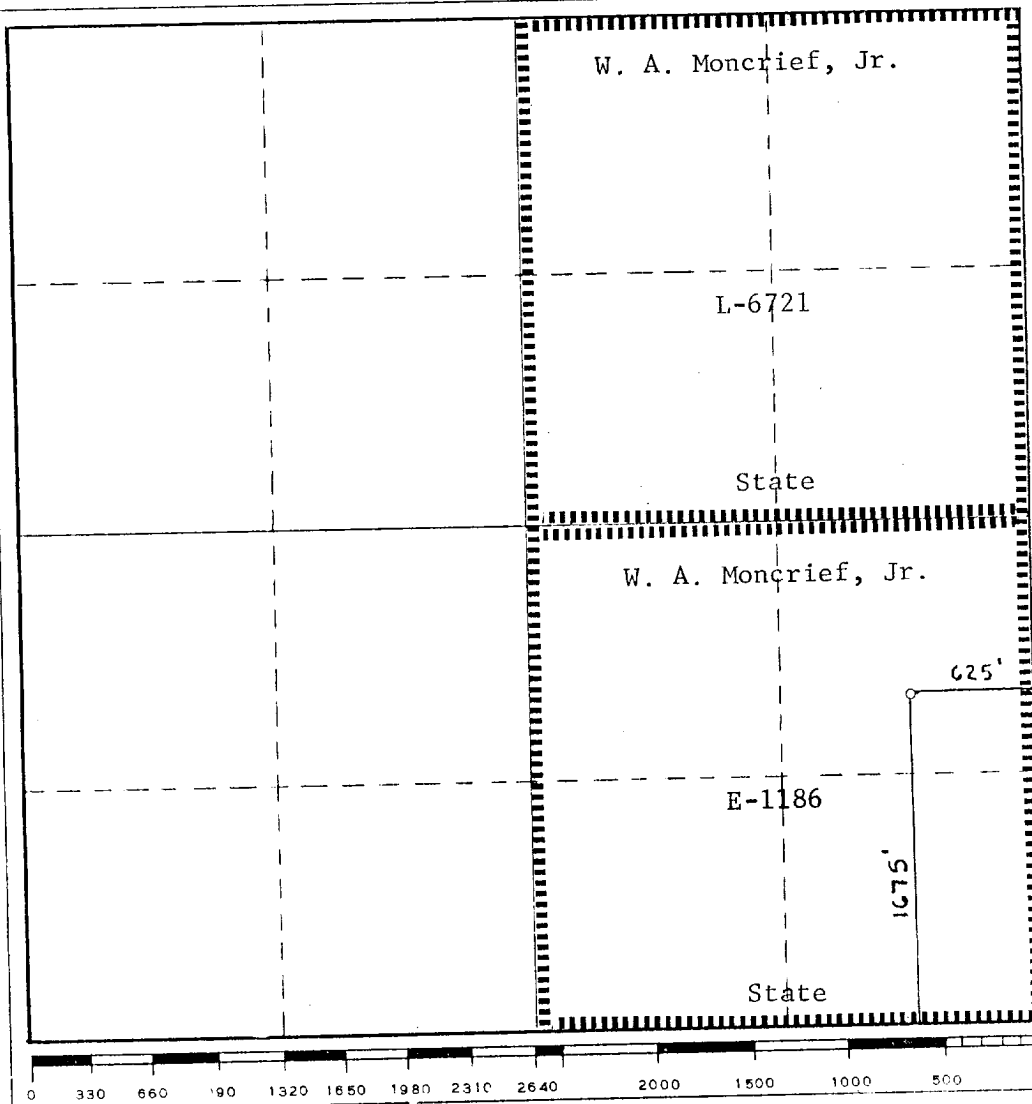

CERTIFICATION

I hereby certify that the information contained herein is true and complete to the best of my knowledge and belief.

Dewey E. Thornton
Name

Dewey E. Thornton

Position
Exploration Manager

Company
W. A. Moncrief, Jr.

Date
July 26, 1978

I hereby certify that the well location shown on this plat was plotted from field notes of actual surveys made by me or under my supervision, and that the same is true and correct to the best of my knowledge and belief.

Date Surveyed
1-31-78

Registered Professional Engineer
and/or Land Surveyor

Certificate No.

RECEIVED

JUL 28 1978

OIL CONSERVATION COMM.
HOBBS, N. M.

COUNTY **LEA** FIELD **Kennnitz** STATE **NM**
 OPR **MONCRIEF, W.A., JR.** API **30-025-25830**
 NO **1-Y LEASE Phillips State** MAP
Sec 8, T16S, R34E CO-ORD
1675 FSL, 625 FEL of Sec **3-3-27 NM**
10 mi NW/Buckeye Re SPD **8-1-79** Re **8-17-79**
 CMP

CSG	WELL CLASS: INIT DX FIN DO LSE CODE			
	FORMATION	DATUM	FORMATION	DATUM
	13 3/8-391-420 sx			
	8 5/8-4500-1700 sx			
	5 1/2-14,107-1075 sx			
	2 7/8-10,711			
	ID 14,130 (DVNN)		PBD 10,885	

IP (Cisco) Perfs 10,763-775 F 231 BOPD. Pot based on 24 hr
 test thru 14/64 chk. GOR 1537; gty (NR); CP Pkr; TP 6000

CONTR OPR SERV 4129 GL sub-s

3-15-82 F.R.C. 3-20-82 OWWO
 PD 10,885 WO (Cisco)
 (Orig. cmp 3-6-79 thru (Morrow)
 Perfs 12,580-718, OTD 14,130, OPB 12,800)
 TD 14,130; PBD 10,885; Complete
 CIBP @ 12,475
 Perf (Atoka) 12,371-376
 Acid (12,371-376) 500 gals
 Swbd dry w/NS (12,371-376)
 CIBP @ 10,885
 Perf (Cisco) 10,763-775
 Acid (10,763-775) 5000 gals
 3-20-82 COMPLETION ISSUED

3-3-27 NM
 IC 30-025-70252-82

COUNTY LEA FIELD Kemnitz

OPR MONCRIEF, W.A., JR.

NO 1-Y LEASE Phillips State

Sec 8, T16S, R34E

1675 FSL, 625 FEL of Sec

10 mi NW/Buckeye

Re SPD 3-15-82 Re CMP 3-18-82

Copyrighted Reproduction Prohibited

STATE NM

APR 30-025-25 330

MAP

COORD

4-3-18 NM

CSC

13 3/8-391-420 SX

8 5/8-4500-1700 SX

5 1/2-14,107-1075 SX

WELL CLASS: INIT DX FIN DO LSE CODE

FORMATION	DATUM	FORMATION	DATUM
ID 14,130 (DVNN)		PHD 10,885	

IP (Cisco) Perfs 10,728-775 P 10 BOPD. Pot based on 24 Hr test.

GOR TSTM; gty (NR)

CONTR

OPRSTEV

4129 GL

Sub-S

F.R.C. 4-17-82 OWWO

PD 10,885 WO (Cisco)

(Orig. cmp 3-6-79 thru (Morrow) Perfs 12,560-748,

OTD 14,130, OPB 12,800; OWWO & Re-cmp 8-17-79

thru (Cisco) Perfs 10,763-775, OTD 14,130, OPB

10,885)

4-12-82

TD 14,130; PBD 10,885; Complete

Perf (Cisco) 10,728-740, 10,751-757

Acid(10,728-775) 8000 gals

4-17-82

COMPLETION ISSUED

4-3-18 NM

IC 30-025-70373-82