

NEW MEXICO OIL CONSERVATION COMMISSION
WELL LOCATION AND ACREAGE DEDICATION PLAT

Form No. 1
Supersedes C-128
Effective 1-1-65

All distances must be from the outer boundaries of the Section

Operator HNG Oil Co.		Lease Shoe BAR Ranch Unit 34 Shubar Unit 34		Acres 1
Section N	Section 34	Township 16 South	Range 35 East	County Lea
Approximate Location of Well:				
990	feet from the South	line and	1980	feet from the West
Spot Elevation 3971.3	Producing Formation		Pool	Estimated Acreage

- Outline the acreage dedicated to the subject well by colored pencil or hatchure marks on the plat below.
- If more than one lease is dedicated to the well, outline each and identify the ownership thereof (both as to working interest and royalty).
- If more than one lease of different ownership is dedicated to the well, have the interests of all owners been consolidated by communitization, unitization, force-pooling, etc?

☐ Yes ☐ No If answer is "yes," type of consolidation _____

If answer is "no," list the owners and tract descriptions which have actually been consolidated. (Use reverse side of this form if necessary.) _____

No allowable will be assigned to the well until all interests have been consolidated (by communitization, unitization, forced-pooling, or otherwise) or until a non-standard unit, eliminating such interests, has been approved by the Commission.

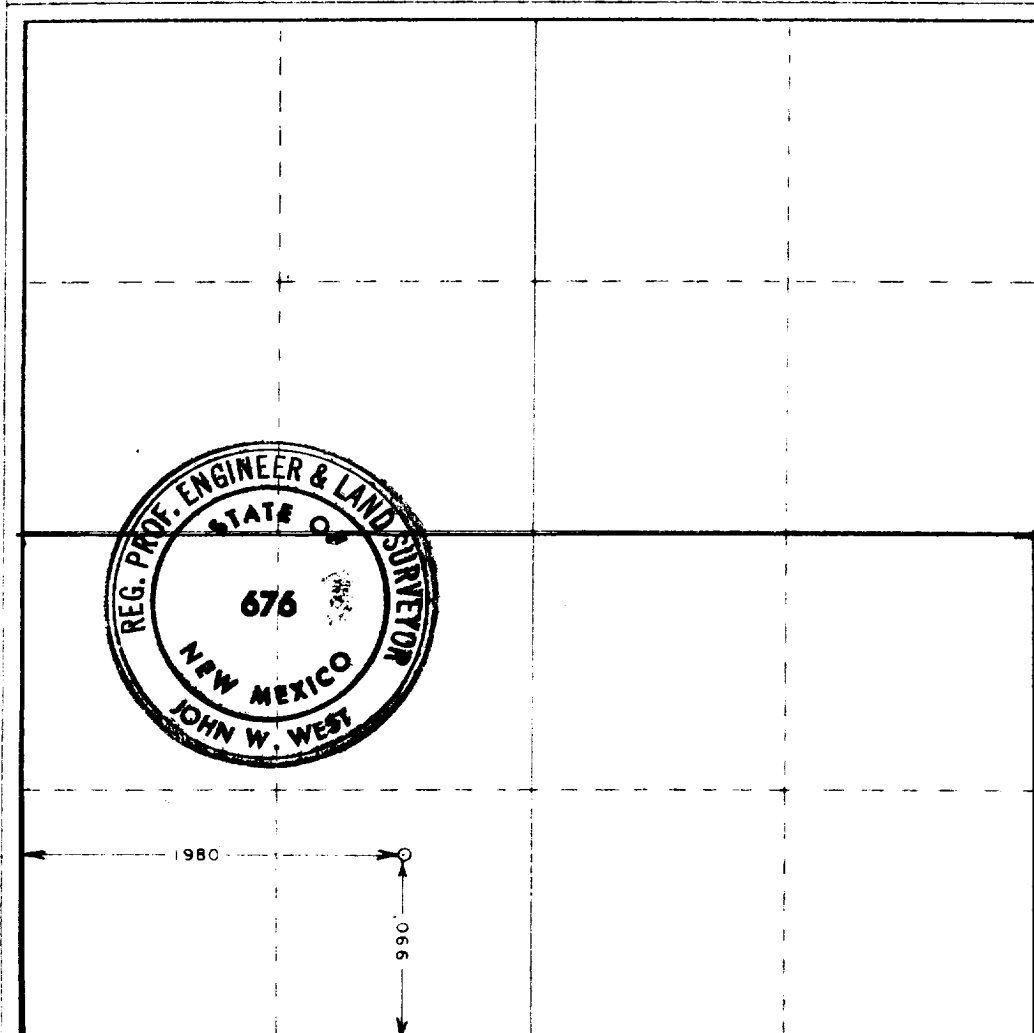

CERTIFICATION

I hereby certify that the information contained herein is true and complete to the best of my knowledge and belief

Betty Gildon
Name
Regulatory Clerk
Position
HNG Oil Company
Company
July 5, 1978
Date

I hereby certify that the well location shown on this plat was plotted from field notes of actual surveys made by me or under my supervision, and that the same is true and correct to the best of my knowledge and belief

Date Surveyed

June 21, 1978

Registered Engineer and Land Surveyor and/or Land Surveyor

John W. West
Signature

Certificate No. **John W. West 676**
Ronald J. Eidson 3239

