

NEW MEXICO OIL CONSERVATION COMMISSION
WELL LOCATION AND ACREAGE DEDICATION PLAT

Form O-102
Supersedes O-128
Effective 1-1-65

All distances must be from the outer boundaries of the Section

Owner Harvey Yates Corp.			Lease Burton			Well No. 1		
Section J	Section 28	Range 16 South	Range 37 East	County Lea				
Locate the Location of Well: 1980 feet from the South line and 1980 feet from the East line								
Surface Elev. 3786.3		Producing Formation Strawn		Pool UNDESIGNATED		Dedicated Acreage 320 80 Acres		

- 1 Outline the acreage dedicated to the subject well by colored pencil or hatchure marks on the plat below.
- 2 If more than one lease is dedicated to the well, outline each and identify the ownership thereof (both as to working interest and royalty).
- 3 If more than one lease of different ownership is dedicated to the well, have the interests of all owners been consolidated by communitization, unitization, force-pooling, etc?

☐ Yes ☐ No If answer is "yes," type of consolidation _____

If answer is "no," list the owners and tract descriptions which have actually been consolidated. (Use reverse side of this form if necessary.) _____

No allowable will be assigned to the well until all interests have been consolidated (by communitization, unitization, forced-pooling, or otherwise) or until a non-standard unit, eliminating such interests, has been approved by the Commission.

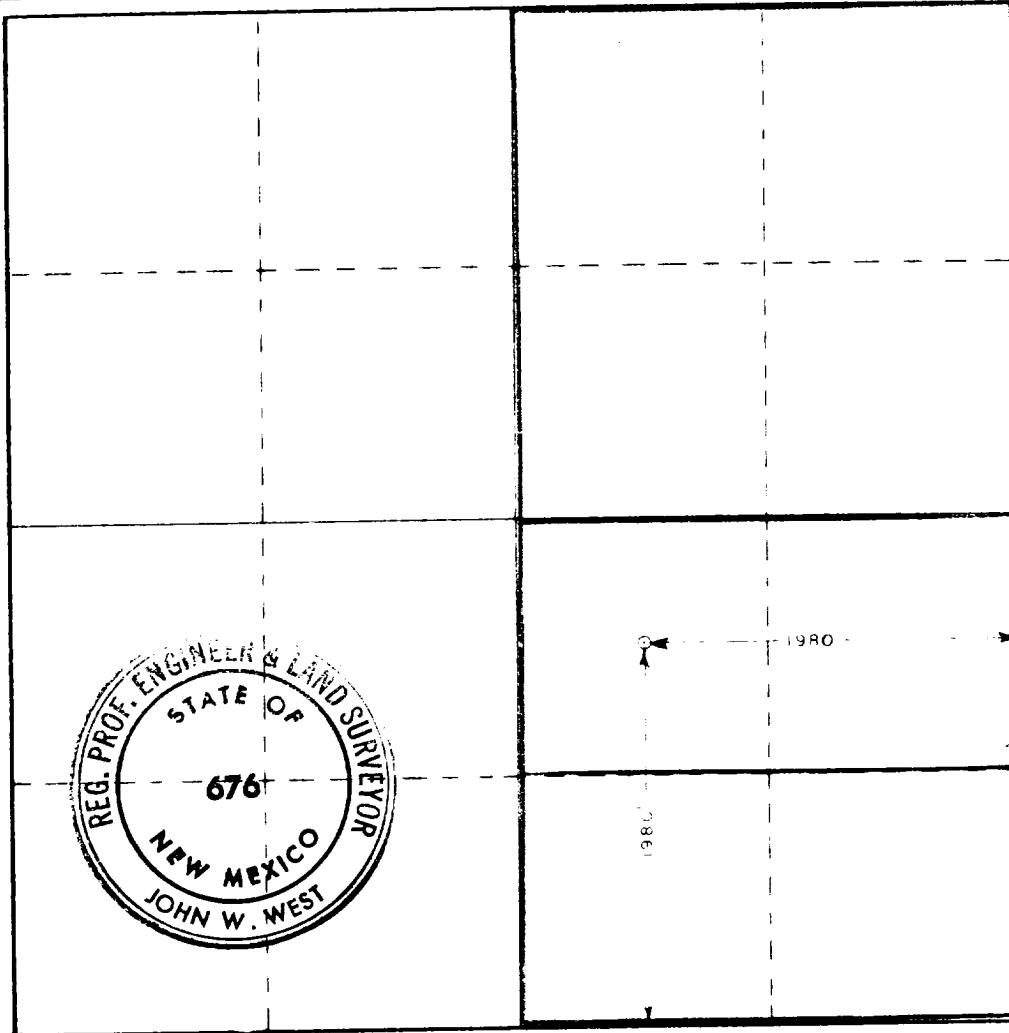

CERTIFICATION

I hereby certify that the information contained herein is true and complete to the best of my knowledge and belief

Harvey Yates
Signature

Vice President

Company
Harvey E. Yates Company

Date
February 9, 1979

I hereby certify that the well location shown on this plat was plotted from field notes of actual surveys made by me or under my supervision, and that the same is true and correct to the best of my knowledge and belief

Date Surveyed
February 6, 1979

Registered Professional Engineer and Professional Surveyor

John W. West
Signature

Certificate No. John W. West 676
Ronald J. Eidson 3239