

NO. OF COPIES RECEIVED		
DISTRIBUTION		
SANTA FE		
FILE		
U.S.G.S.		
LAND OFFICE		
OPERATOR		

NEW MEXICO OIL CONSERVATION COMMISSION

Form C-101
Revised 1-1-65

5A. Indicate Type of Lease
STATE ☒ FEE ☐

5. State Oil & Gas Lease No.
K-6875

APPLICATION FOR PERMIT TO DRILL, DEEPEN, OR PLUG BACK

1a. Type of Work DRILL <input checked="" type="checkbox"/> DEEPEN <input type="checkbox"/> PLUG BACK <input type="checkbox"/>		7. Unit Agreement Name N.E. Kemnitz
b. Type of Well OIL WELL <input type="checkbox"/> GAS WELL <input checked="" type="checkbox"/> OTHER <input type="checkbox"/> SINGLE ZONE <input type="checkbox"/> MULTIPLE ZONE <input type="checkbox"/>		8. Farm or Lease Name N.E. Kemnitz
c. Name of Operator Elk Oil Company		9. Well No. 4
d. Address of Operator P. O. Box 310, Roswell, New Mexico 88201		10. Field and Pool, or Wildcat Kemnitz Morrow
e. Location of Well UNIT LETTER <u>C</u> LOCATED <u>660</u> FEET FROM THE <u>North</u> LINE AND <u>1980</u> FEET FROM THE <u>West</u> LINE OF SEC. <u>15</u> TWP. <u>16S</u> RGE. <u>34E</u> NMPM		12. County Lea
19. Proposed Depth 13,500		19A. Formation Morrow
20. Rotary or C.T. Rotary		
11. Elevations (Show whether DF, RT, etc.) 4102 GRD	21A. Kind & Status Plug. Bond Blanket	21B. Drilling Contractor Hondo
22. Approx. Date Work will start 5/3/79		

PROPOSED CASING AND CEMENT PROGRAM

SIZE OF HOLE	SIZE OF CASING	WEIGHT PER FOOT	SETTING DEPTH	SACKS OF CEMENT	EST. TOP
17½	12 3/4	34	375	400	circ.
12¼	8 5/8	32/24	4,500	1,800	circ.
7 7/8	5 1/2	17	13,500	1,000	9,500

BLOWOUT PREVENTION PROGRAM

Size	Series	Make	Number
12"	900S	Cameron QRC	1
10"	900S	Cameron QRC	2
10"	900S	Hydriil	
3"	1500S	Choke Manifold	1

IN ABOVE SPACE DESCRIBE PROPOSED PROGRAM: IF PROPOSAL IS TO DEEPEN OR PLUG BACK, GIVE DATA ON PRESENT PRODUCTIVE ZONE AND PROPOSED NEW PRODUCTIVE ZONE. GIVE BLOWOUT PREVENTER PROGRAM, IF ANY.

I hereby certify that the information above is true and complete to the best of my knowledge and belief.

Signed Joseph J. Kelly Title President Date 4/30/79

(This space for State Use)

APPROVED BY [Signature] TITLE SUPERVISOR DISTRICT 1 DATE MAY 2 1979

CONDITIONS OF APPROVAL, IF ANY:

RECEIVED

MAY - 1979

CHL COMMUNICATIONS
FBI

**NEW MEXICO OIL CONSERVATION COMMISSION
WELL LOCATION AND ACREAGE DEDICATION PLAT**

Form C-102
Supersedes C-128
Effective 1-1-65

All distances must be from the outer boundaries of the Section.

Operator ELK OIL COMPANY			Lease NE Kemnitz		Well No. 4
Unit Letter C	Section 15	Township 16 South	Range 34 East	County Lea	
Actual Footage Location of Well: <div style="display: flex; justify-content: space-between;"> 660 feet from the North line and 1980 feet from the West line </div>					
Ground Level Elev. 4102.3	Producing Formation Morrow	Pool Kemnitz Morrow		Dedicated Acreage: 320 Acres	

1. Outline the acreage dedicated to the subject well by colored pencil or hatchure marks on the plat below.
2. If more than one lease is dedicated to the well, outline each and identify the ownership thereof (both as to working interest and royalty).
3. If more than one lease of different ownership is dedicated to the well, have the interests of all owners been consolidated by communitization, unitization, force-pooling, etc?

☐ Yes ☐ No If answer is "yes," type of consolidation _____

If answer is "no," list the owners and tract descriptions which have actually been consolidated. (Use reverse side of this form if necessary.) _____

No allowable will be assigned to the well until all interests have been consolidated (by communitization, unitization, forced-pooling, or otherwise) or until a non-standard unit, eliminating such interests, has been approved by the Commission.

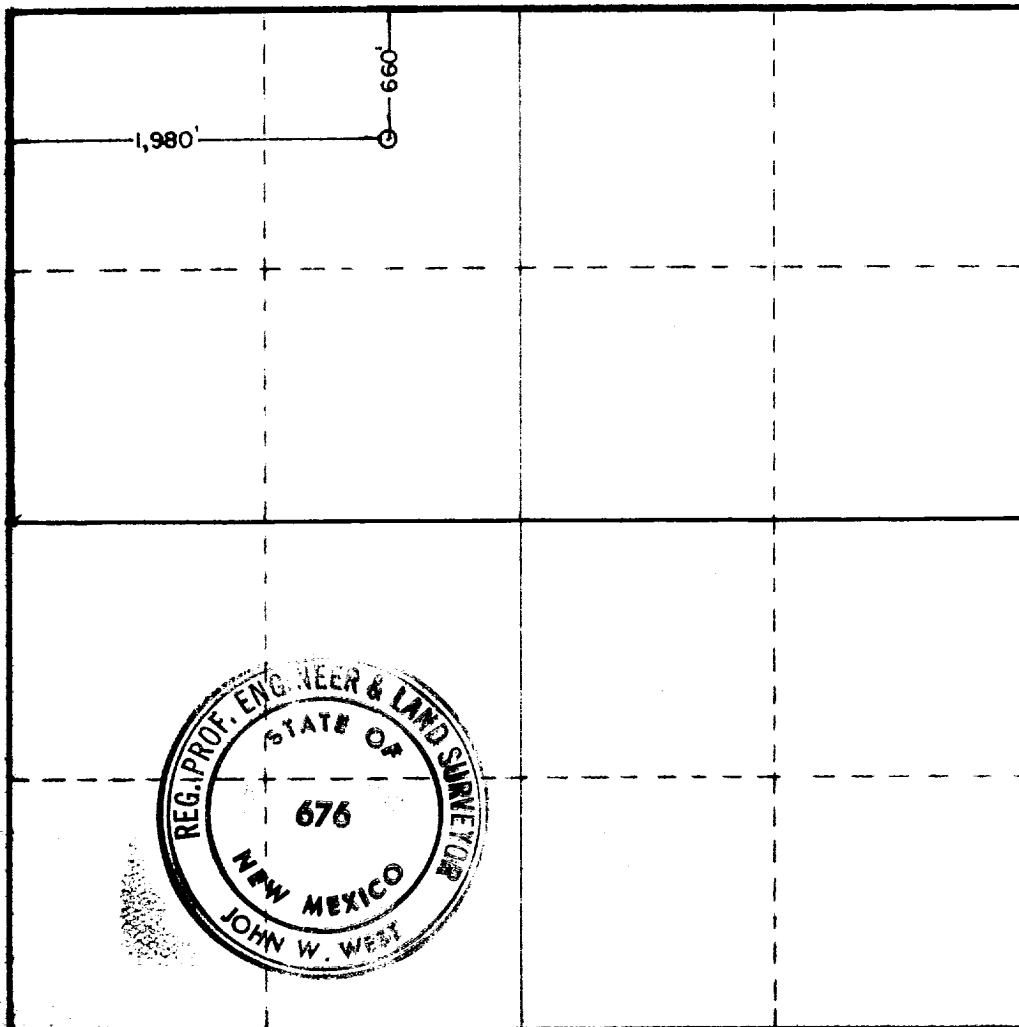

CERTIFICATION

I hereby certify that the information contained herein is true and complete to the best of my knowledge and belief.

[Signature]
Name

Joseph J. Kelly

Position
President

Company
Elk Oil Company

Date
4/30/79

I hereby certify that the well location shown on this plat was plotted from field notes of actual surveys made by me or under my supervision, and that the same is true and correct to the best of my knowledge and belief.

Date Surveyed
April 26, 1979

Registered Professional Engineer and/or Land Surveyor

[Signature]

Certificate No. **John W. West 676**

Ronald J. Eidson 3239

0 200 400 600 800 1000 1200 1400 1600 1800 2000 2200 2400

RECEIVED

MAY - 11 1979

OL 000

11/11/79

ELB