

STATE OF NEW MEXICO  
ENERGY AND MINERALS DEPARTMENT

OIL CONSERVATION DIVISION

P. O. BOX 2088

SANTA FE, NEW MEXICO 87501

Form C-103  
Revised 10-1-78

NO. OF COPIES RECEIVED	
DISTRIBUTION	
SANTA FE	
FILE	
U.S.O.S.	
LAND OFFICE	
OPERATOR	

5a. Indicate Type of Lease	
State <input type="checkbox"/>	Fee <input checked="" type="checkbox"/>
5. State Oil & Gas Lease No.	

SUNDRY NOTICES AND REPORTS ON WELLS  
(DO NOT USE THIS FORM FOR PROPOSALS TO DRILL OR TO DEEPEN OR PLUG BACK TO A DIFFERENT RESERVOIR.  
USE "APPLICATION FOR PERMIT -" (FORM C-101) FOR SUCH PROPOSALS.)

1. <input type="checkbox"/> OIL WELL <input checked="" type="checkbox"/> GAS WELL <input type="checkbox"/> OTHER-		7. Unit Agreement Name
2. Name of Operator <b>U. S. Operating, Inc.</b>		8. Farm or Lease Name <b>Leavelle</b>
3. Address of Operator <b>c/o Oil Reports &amp; Gas Services, Inc., Box 763, Hobbs, NM 88240</b>		9. Well No. <b>1</b>
4. Location of well UNIT LETTER <b>B</b> <b>660</b> FEET FROM THE <b>North</b> LINE AND <b>1980</b> FEET FROM <b>East</b> THE LINE, SECTION <b>23</b> TOWNSHIP <b>16 S</b> RANGE <b>35 E</b> NMPM.		10. Field and Pool, or Wildcat <b>Undes Townsend Morrow</b>
15. Elevation (Show whether DF, RT, GR, etc.) <b>3968 GR</b>		12. County <b>Lea</b>

16. Check Appropriate Box To Indicate Nature of Notice, Report or Other Data  
NOTICE OF INTENTION TO: SUBSEQUENT REPORT OF:

PERFORM REMEDIAL WORK <input type="checkbox"/>	PLUG AND ABANDON <input type="checkbox"/>	REMEDIAL WORK <input type="checkbox"/>	ALTERING CASING <input type="checkbox"/>
TEMPORARILY ABANDON <input type="checkbox"/>	CHANGE PLANS <input type="checkbox"/>	COMMENCE DRILLING OPNS. <input type="checkbox"/>	PLUG AND ABANDONMENT <input type="checkbox"/>
PULL OR ALTER CASING <input type="checkbox"/>	OTHER <input checked="" type="checkbox"/> <b>Change Operator Name</b>	CASING TEST AND CEMENT JOBS <input type="checkbox"/>	

17. Describe Proposed or Completed Operations (Clearly state all pertinent details, and give pertinent dates, including estimated date of starting any proposed work) SEE RULE 1103.

**Filed to change operator name from Rhonda Operating Company to U. S. Operating, Inc.**

18. I hereby certify that the information above is true and complete to the best of my knowledge and belief.

SIGNED *Rhonda Hall* TITLE Agent DATE June 9, 1980

APPROVED BY *Jerry Sexton* TITLE Dist. L. Supv. DATE JUN 9 1980  
CONDITIONS OF APPROVAL, IF ANY:

STATE OF NEW MEXICO  
ENERGY AND MINERALS DEPARTMENT

OIL CONSERVATION DIVISION

P. O. BOX 2088

SANTA FE, NEW MEXICO 87501

Form C-101  
Revised 10-1-78

NO. OF COPIES RECEIVED	
DISTRIBUTION	
SANTA FE	
FILE	
U.S.G.S.	
LAND OFFICE	
OPERATOR	

APPLICATION FOR PERMIT TO DRILL, DEEPEN, OR PLUG BACK

Type of Work

DRILL ☒

DEEPEN ☐

PLUG BACK ☐

Type of Well

OIL WELL ☐

GAS WELL ☒

OTHER

SINGLE ZONE ☒

MULTIPLE ZONE ☐

Name of Operator

Rhonda Operating Company

Address of Operator

511 North Main; Midland, Texas 79701

Location of Well

UNIT LETTER B

LOCATED 660

FEET FROM THE North

1980

FEET FROM THE East

LINE OF SEC. # 23

TWP. T6S

RGE. 35E

RANGE

17. County

Lea

10. Field and Pool, or Wildcat

UNDESIGNATED

Signature: *James H. Brown*  
(NO)

17. County

Lea

14. Proposed Depth

12500

15A. Formation

Morrow

16. Rotary or C.T.

Rotary

18. Conditions (Drill, etc.)

3968 ground

21A. Kind & Status Flag. Bond

21B. Drilling Contractor

Forster Rig # 5

22. Approx. Date Work will start

June 4, 1980

PROPOSED CASING AND CEMENT PROGRAM

SIZE OF HOLE	SIZE OF CASING	WEIGHT PER FOOT	SETTING DEPTH	SACKS OF CEMENT	EST. TOP
17 1/2	13 3/8	48	400	425	Surface
11	8 5/8	24 & 32	4200	900	Surface
7 7/8	5 1/2	17	12500	600	9500'

1. Blowout preventer program on 11" hole will consist of dual 10"-5000 psi working pressure double BOP (1 Pipe Ram and 1 Blind Ram.) Installation will be when 13 3/8 casing has been set.
2. Blowout preventer program on 7-7/8" hole will consist of Dual 10"-5,000 psi working pressure double BOP (1 Pipe Ram and 1 Blind Ram) with rotating head. This equipment will be installed after 8-5/8 casing is set and completed.

ABOVE SPACE DESCRIBE PROPOSED PROGRAM; IF PROPOSAL IS TO DEEPEN OR PLUG BACK, GIVE DATA ON PRESENT PRODUCTIVE ZONE AND PROPOSED NEW PRODUCTION ZONE. GIVE BLOWOUT PREVENTER PROGRAM, IF ANY.

I hereby certify that the information above is true and complete to the best of my knowledge and belief.

*Adam Pransky*

Title Agent

Date June 6, 1980

(This space for State Use)

SUPERVISOR DISTRICT I

APPROVED BY *Jerry L. L...* TITLE

DATE JUN 6 1980

CONDITIONS OF APPROVAL, IF ANY:

NE EXICO OIL CONSERVATION COMMISSION  
WELL LOCATION AND ACREAGE DEDICATION PLAT

Form C-102  
Supersedes C-128  
Effective 1-1-65

All distances must be from the outer boundaries of the Section.

Operator <b>Rhonda Operating Company</b> <del>U.S. XXX COMPANIES</del>		Lease <b>Leavelle</b>		Well No. <b>1</b>
Unit Letter <b>B</b>	Section <b>23</b>	Township <b>16-S</b>	Range <b>35-E</b>	County <b>Lea</b>
Actual Footage Location of Well: <b>660'</b> feet from the <b>North</b> line and <b>1980'</b> feet from the <b>East</b> line				
Ground Level Elev. <b>3968'</b>	Producing Formation <b>Morrow</b>	Pool <b>UNDESIGNATED</b>	Dedicated Acreage: <del>160</del> <b>320</b> Acres	

1. Outline the acreage dedicated to the subject well by colored pencil or hachure marks on the plat below.
2. If more than one lease is dedicated to the well, outline each and identify the ownership thereof (both as to working interest and royalty).
3. If more than one lease of different ownership is dedicated to the well, have the interests of all owners been consolidated by communitization, unitization, force-pooling, etc?

☒ Yes ☐ No If answer is "yes," type of consolidation UNITIZATION

If answer is "no," list the owners and tract descriptions which have actually been consolidated. (Use reverse side of this form if necessary.)

No allowable will be assigned to the well until all interests have been consolidated (by communitization, unitization, forced-pooling, or otherwise) or until a non-standard unit, eliminating such interests, has been approved by the Commission.

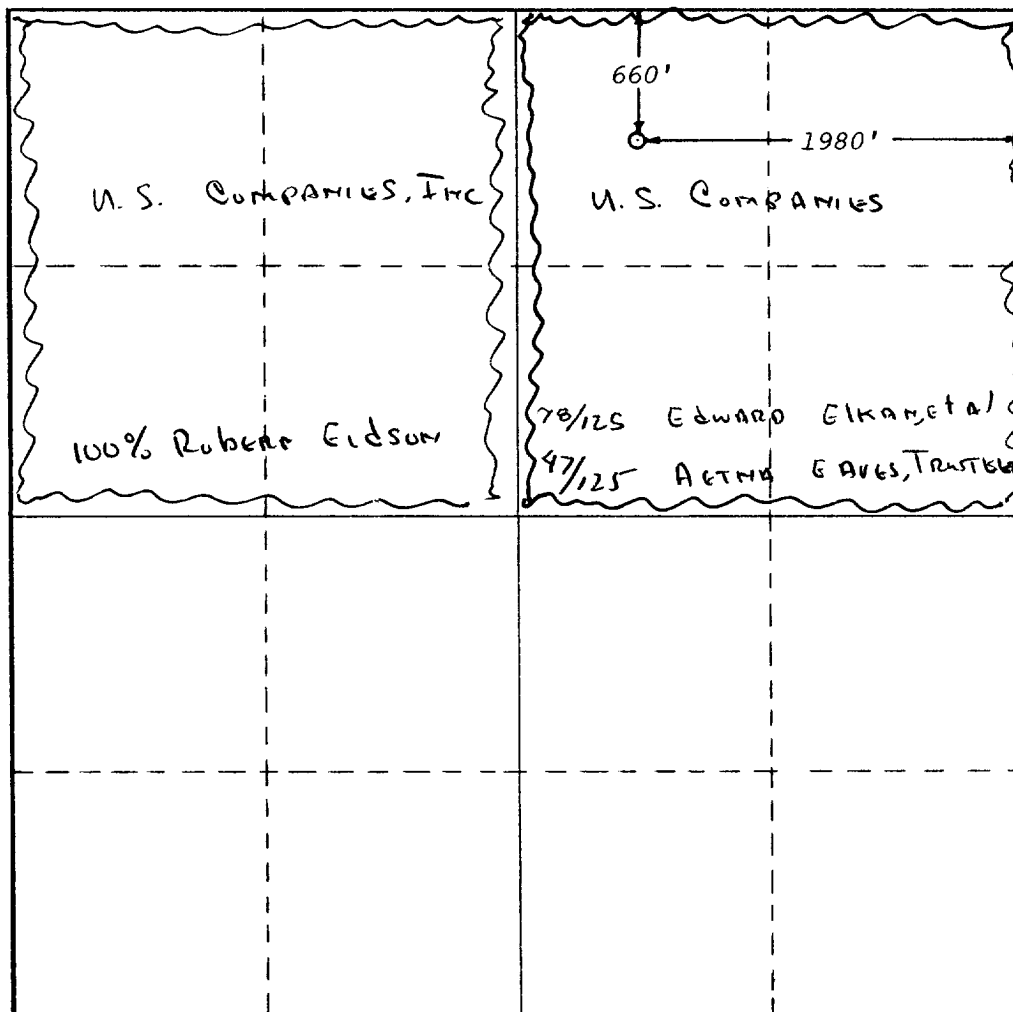

CERTIFICATION

I hereby certify that the information contained herein is true and complete to the best of my knowledge and belief.

*Adam Praisnar, Jr.*

Name

Adam Praisnar, Jr.

Position

Agent

Company

Rhonda Operating Company

Date

June 6, 1980

I hereby certify that the well location shown on this plat was plotted from field notes of actual surveys made by me or under my supervision and that the same is true and correct to the best of my knowledge and belief.

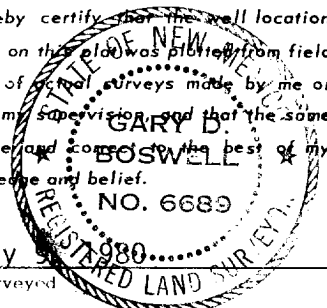

May 5, 1980

Date Surveyed

Gary D. Boswell

Registered Professional Engineer and/or Land Surveyor

*Gary D. Boswell*

Certificate No.

6689

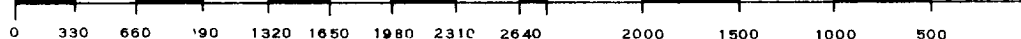

173

RECEIVED

JUN 6 1980

OIL CONSERVATION DIV.