

NO. OF COPIES RECEIVED	
DISTRIBUTION	
SANTA FE	
FILE	
U.S.G.S.	
LAND OFFICE	
OPERATOR	

NEW MEXICO OIL CONSERVATION COMMISSION

30-025-27022

Form C-101  
Revised 1-1-65

5A. Indicate Type of Lease  
STATE ☒ FEE ☐

5. State Oil & Gas Lease No.  
L-5008

APPLICATION FOR PERMIT TO DRILL, DEEPEN, OR PLUG BACK

1a. Type of Work DRILL <input checked="" type="checkbox"/> DEEPEN <input type="checkbox"/> PLUG BACK <input type="checkbox"/>		7. Unit Agreement Name ---
b. Type of Well OIL WELL <input checked="" type="checkbox"/> GAS WELL <input type="checkbox"/> OTHER <input type="checkbox"/> SINGLE ZONE <input checked="" type="checkbox"/> MULTIPLE ZONE <input type="checkbox"/>		8. Farm or Lease Name State
2. Name of Operator Miranda Energy		9. Well No. 1
3. Address of Operator 105 W. Wall Suite 501 Midland, Texas 79701		10. Field Name UNDESIGNATED Mesa Queen
4. Location of Well UNIT LETTER <u>A</u> LOCATED <u>990</u> FEET FROM THE <u>North</u> LINE AND <u>330</u> FEET FROM THE <u>East</u> LINE OF SEC. <u>19</u> TWP. <u>16 S</u> RGE. <u>32 E</u> NMPM		12. County Lea
19. Proposed Depth 3500'		19A. Formation Queen
20. Rotary or C.T. Rotary		
21. Elevations (show whether DE, RT, etc.) GL 4361'	21A. Kind & Status Plug. Bond 1 well plugging	21B. Drilling Contractor Collier and Collier
22. Approx. Date Work will start September 4, 1980		

23.

PROPOSED CASING AND CEMENT PROGRAM

SIZE OF HOLE	SIZE OF CASING	WEIGHT PER FOOT	SETTING DEPTH	SACKS OF CEMENT	EST. TOP
11"	8 5/8"		350'	200	surface
7"	4 1/2"		3500'	400	1500'

DRILL TO 350' SET 8 5/8" - INSTALL BOP.  
DRILL TO 3500' SET 4 1/2"

**\*\*Cement on the production casing must be brought from the top of the salt or anhydrite to the surface casing. This can be done by either circulating the casing with cement, or a DV tool at the top of the salt.**

APPROVAL VALID  
FOR 90 DAYS UNLESS  
DRILLING COMMENCED,

THE COMMISSION MUST BE NOTIFIED  
24 HOURS PRIOR TO COMMENCING WORK

EXPIRES 12/2/80

IN ABOVE SPACE DESCRIBE PROPOSED PROGRAM: IF PROPOSAL IS TO DEEPEN OR PLUG BACK, GIVE DATA ON PRESENT PRODUCTIVE ZONE AND PROPOSED NEW PRODUCTIVE ZONE. GIVE BLOWOUT PREVENTER PROGRAM, IF ANY.

I hereby certify that the information above is true and complete to the best of my knowledge and belief.

Signed Randy Rude Title General Partner Date August 25, 1980

(This space for State Use)

APPROVED BY John W. Runyan TITLE Geologist DATE SEP 2 1980

CONDITIONS OF APPROVAL, IF ANY:

**\*\*SEE ABOVE**



RECEIVED

**AUG 27 1980**

OIL CONSERVATION DIV.

RECEIVED

**SEP 2 1980**

OIL CONSERVATION DIV.



**N MEXICO OIL CONSERVATION COMMISS**  
**WELL LOCATION AND ACREAGE DEDICATION PLAT**

Form C-102  
 Supersedes C-128  
 Effective 1-1-65

All distances must be from the outer boundaries of the Section.

Operator <b>Miranda Energy</b>			Lease		State		Well No. <b>1</b>
Unit Letter <b>A</b>	Section <b>19</b>	Township <b>16 South</b>	Range <b>32 East</b>	County <b>Lea</b>			
Actual Footage Location of Well: <b>990</b> feet from the <b>North</b> line and <b>330</b> feet from the <b>East</b> line							
Ground Level Elev. <b>4361.0</b>	Producing Formation <b>QUEEN</b>		Pool <b>MEJA (QUEEN)</b>		Dedicated Acreage: <b>40</b> Acres		

1. Outline the acreage dedicated to the subject well by colored pencil or hatchure marks on the plat below.
2. If more than one lease is dedicated to the well, outline each and identify the ownership thereof (both as to working interest and royalty).
3. If more than one lease of different ownership is dedicated to the well, have the interests of all owners been consolidated by communitization, unitization, force-pooling, etc?

☐ Yes    ☐ No    If answer is "yes," type of consolidation \_\_\_\_\_

If answer is "no," list the owners and tract descriptions which have actually been consolidated. (Use reverse side of this form if necessary.) \_\_\_\_\_

No allowable will be assigned to the well until all interests have been consolidated (by communitization, unitization, forced-pooling, or otherwise) or until a non-standard unit, eliminating such interests, has been approved by the Commission.

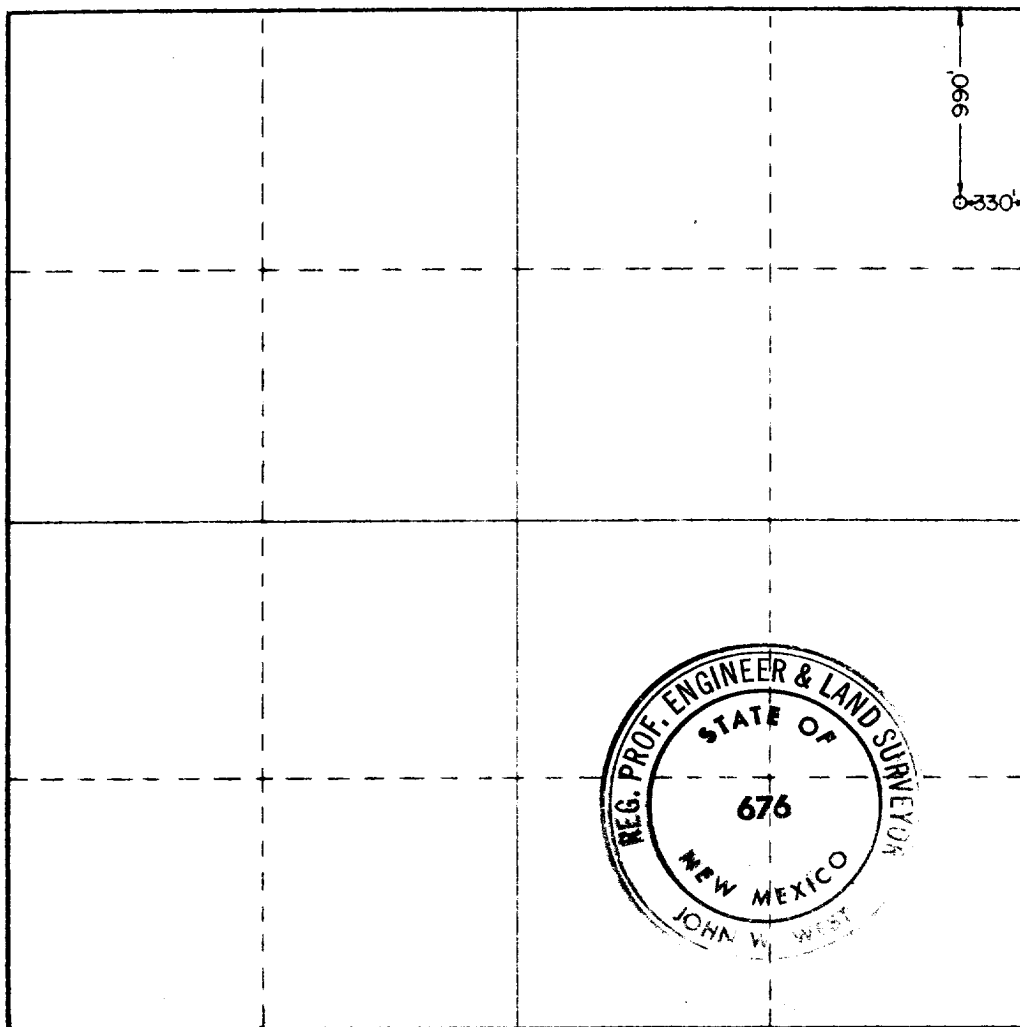

**CERTIFICATION**

I hereby certify that the information contained herein is true and complete to the best of my knowledge and belief.

*Randy Prude*  
 Name

*Managing Partner*  
 Position

*MIRANDA ENERGY*  
 Company

*8-29-80*  
 Date

I hereby certify that the well location shown on this plat was plotted from field notes of actual surveys made by me or under my supervision, and that the same is true and correct to the best of my knowledge and belief.

Date Surveyed  
**August 16, 1980**

Registered Professional Engineer and/or Land Surveyor

*John W. West*  
 Certificate No. **JOHN W. WEST 676**  
**PATRICK A. ROMERO 6463**  
**Ronald J. Eideen 3239**

0 330 660 990 1320 1650 1980 2310 2640 2970 3300 3630 3960 4290 4620 4950 5280 5610 5940 6270 6600



RECEIVED

AUG 27 1980

OIL CONSERVATION DIV.

RECEIVED

SEP 2 1980

OIL CONSERVATION DIV.

1671