

NO. OF COPIES RECEIVED	
DISTRIBUTION	
SANTA FE	
FILE	
U.S.G.S.	
LAND OFFICE	
OPERATOR	

# NEW MEXICO OIL CONSERVATION COMMISSION

Form C-101  
Revised 1-1-65

API No. 30-625-27087

5A. Indicate Type of Lease	
STATE <input checked="" type="checkbox"/>	FEE <input type="checkbox"/>
5. State Oil & Gas Lease No.	
B-3610	
7. Unit Agreement Name	
-----	
8. Farm or Lease Name	
Mexco-A	
9. Well No.	
5	
10. Field and Pool, or Wildcat	
Maljamar Gb/SA	
12. County	
Lea	
19. Proposed Depth	19A. Formation
4550'	Grayburg/SA
20. Rotary or C.T.	
Rotary	
21. Elevations (Show whether DE, RT, etc.)	21A. Kind & Status Plug, Bend
4265.5 GR (Unprepared)	blanket
21B. Drilling Contractor	22. Approx. Date Work will start
Advise later	Upon approval

1a. Type of Work	
DRILL <input checked="" type="checkbox"/> DEEPEN <input type="checkbox"/> PLUG BACK <input type="checkbox"/>	
b. Type of Well	
OIL WELL <input checked="" type="checkbox"/>	GAS WELL <input type="checkbox"/>
2. Name of Operator	
Phillips Petroleum Company	
3. Address of Operator	
Room 401, 4001 Penbrook Street, Odessa, Texas 79762	
4. Location of Well	
UNIT LETTER F	LOCATED 1980
FEET FROM THE North LINE	
AND 1980	FEET FROM THE West
TWP. 17-S RGE. 32-E NMPM	
19. Proposed Depth	
4550'	
19A. Formation	
Grayburg/SA	
20. Rotary or C.T.	
Rotary	
21. Elevations (Show whether DE, RT, etc.)	21A. Kind & Status Plug, Bend
4265.5 GR (Unprepared)	blanket
21B. Drilling Contractor	22. Approx. Date Work will start
Advise later	Upon approval

## PROPOSED CASING AND CEMENT PROGRAM

SIZE OF HOLE	SIZE OF CASING	WEIGHT PER FOOT	SETTING DEPTH	SACKS OF CEMENT	EST. TOP
12-1/4"	8-5/8"	24# K-55	400'	300 sxs Cl"C" w/2% CaCl, 1/4/s.	(Flocele circ to surface)
7-7/8"	4-1/2"	11.6# N-80	4550'	Suff volume TLW w/10% DD.	(10#/sx salt, followed w/500 sxs Cl"C" --circ to surface.

Use mud additives as required for control.

BOP Series: 900, 3000# WP (Figure 7 Schematic attached)

APPROVAL VALID  
FOR 90 DAYS UNLESS  
DRILLING COMMENCED,

EXPIRES 1/14/81

IN ABOVE SPACE DESCRIBE PROPOSED PROGRAM: IF PROPOSAL IS TO DEEPEN OR PLUG BACK, GIVE DATA ON PRESENT PRODUCTIVE ZONE AND PROPOSED NEW PRODUCTIVE ZONE. GIVE BLOWOUT PREVENTER PROGRAM, IF ANY.

I hereby certify that the information above is true and complete to the best of my knowledge and belief.

Signature W. J. Mueller Title Senior Engineering Specialist Date October 10, 1980

This space for State Use

APPROVED BY Jesús A. Concha TITLE Commissioner DATE 10/14/80

CONDITIONS OF APPROVAL, IF ANY:

NEW MEXICO OIL CONSERVATION COMMISSION  
WE' LOCATION AND ACREAGE DEDICATION PLAT

Form C-102  
Supersedes C-128  
Effective 1-1-65

All distances must be from the outer boundaries of the Section

Operator <b>Phillips Petroleum Co.</b>		Lease <b>Mexco - A</b>		Well No. <b>5</b>
Post Letter <b>F</b>	Section <b>2</b>	Township <b>17 south</b>	Range <b>32 east</b>	County <b>Lea</b>

Actual Footage Location of Well:				
<b>1980</b>	feet from the	<b>north</b>	line and	<b>1980</b>
feet from the				feet from the
				<b>west</b>
Ground Level Elev. <b>4265.5</b>	Producing Formation <b>Grayburg/San Andres</b>		Pool <b>Maljamar Grayburg/San Andres</b>	Dedicated Acreage: <b>40</b> Acres

1. Outline the acreage dedicated to the subject well by colored pencil or hatchure marks on the plat below.
2. If more than one lease is dedicated to the well, outline each and identify the ownership thereof (both as to working interest and royalty).
3. If more than one lease of different ownership is dedicated to the well, have the interests of all owners been consolidated by communitization, unitization, force-pooling, etc?

☐ Yes ☐ No If answer is "yes," type of consolidation \_\_\_\_\_

If answer is "no," list the owners and tract descriptions which have actually been consolidated. (Use reverse side of this form if necessary.) \_\_\_\_\_

No allowable will be assigned to the well until all interests have been consolidated (by communitization, unitization, forced-pooling, or otherwise) or until a non-standard unit, eliminating such interests, has been approved by the Commission.

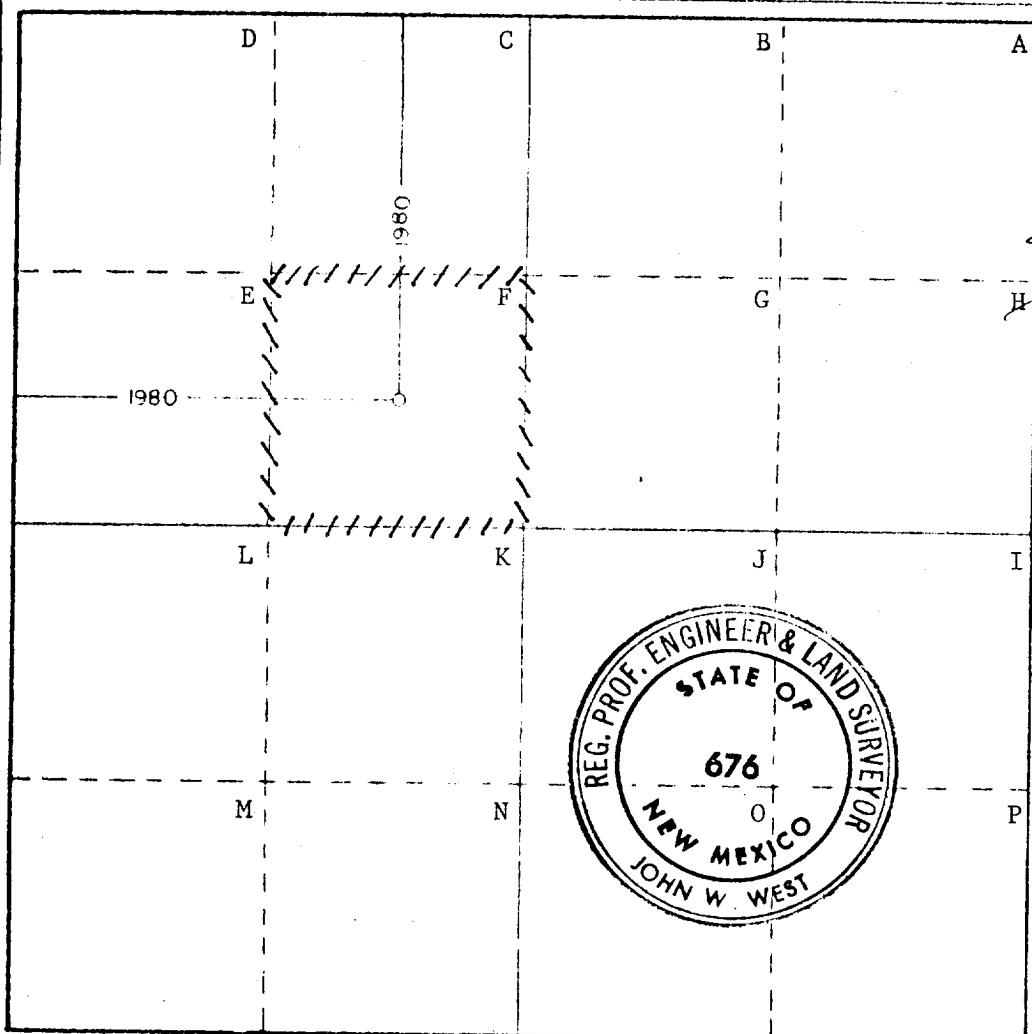

CERTIFICATION

I hereby certify that the information contained herein is true and complete to the best of my knowledge and belief.

*[Signature]*

W. J. Mueller

Position  
**Senior Engineering Specialist**

Company  
**Phillips Petroleum Company**

Date  
**October 7, 1980**

I hereby certify that the well location shown on this plat was plotted from field notes of actual surveys made by me or under my supervision, and that the same is true and correct to the best of my knowledge and belief.

Date Surveyed  
**9-8-80**

Registered Professional Engineer and/or Land Surveyor

*[Signature]*

Certificate No. **JOHN W. WEST 676**  
**PATRICK A. ROMERO 6883**  
**Ronald J. Eidson 3239**

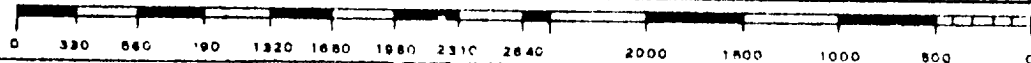

# DOUBLE PREVENTER OPTION

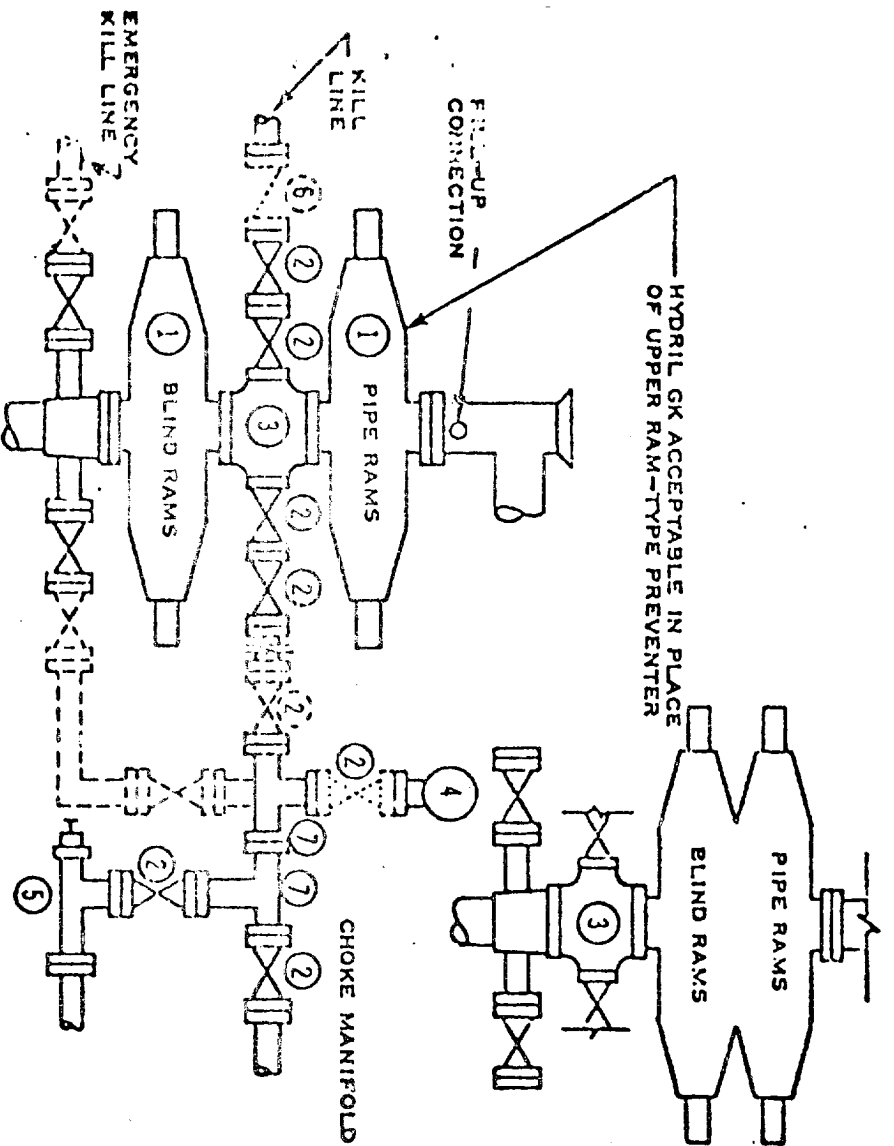

- ① SERIES 900 RAM-TYPE BOP
- ② 2" SERIES 900 VALVE
- ③ SERIES 900 DRILLING SPOOL
- ④ 2" MUD PRESSURE GAUGE
- ⑤ 2" SERIES 900 CHOKE
- ⑥ 2" SERIES 900 CHECK VALVE
- ⑦ 2" SERIES 900 STEEL TEE

## NOTES:

1. 3000 PSI WP CLAMP HUBS MAY BE SUBSTITUTED FOR FLANGES
2. VALVES MAY BE EITHER HAND OR POWER OPERATED BUT, IF POWER OPERATED, THE VALVES FLANGED TO THE BOP RUN MUST BE CAPABLE OF BEING OPENED AND CLOSED MANUALLY OR CLOSE ON POWER FAILURE AND BE CAPABLE OF BEING OPENED MANUALLY

..... OPTIONAL EQUIPMENT

PHILLIPS PETROLEUM COMPANY

3000 PSI WORKING PRESSURE  
BLOWOUT PREVENTER HOOK-UP  
(SERIES 900 FLANGES OR BETTER)

OCT 14 1980

OIL CONSERVATION DIV.

173