

STATE OF NEW MEXICO
ENERGY AND MINERALS DEPARTMENT

OIL CONSERVATION DIVISION

P. O. BOX 2088
SANTA FE, NEW MEXICO 87501

Form C-101
Revised 10-1-78

NO. OF COPIES RECEIVED	
DISTRIBUTION	
SANTA FE	
FILE	
U.S.G.S.	
LAND OFFICE	
OPERATOR	

5A. Indicate Type of Lease
STATE ☒ FEE ☐

5. State Oil & Gas Lease No.
F-6666

APPLICATION FOR PERMIT TO DRILL, DEEPEN, OR PLUG BACK

1a. Type of Work
b. Type of Well
OIL WELL ☒ GAS WELL ☐ OTHER ☐
SINGLE ZONE ☒ MULTIPLE ZONE ☐

2. Name of Operator
Hexagon Oil and Gas Inc.

3. Address of Operator
1800 W. T. Waggoner Building, 810 Houston St., Fort Worth, Texas 76102

4. Location of Well
UNIT LETTER I LOCATED 1980 FEET FROM THE South LINE
AND 660 FEET FROM THE East LINE OF SEC. 28 TWP. 16 S RGT. 33 E NMPM

7. Unit Agreement Name

8. Name of Lease Name
Hexagon NM "28" State

9. Well No.
1

10. Field and Pool, or Wildcat
~~Maljamar Morrow~~
Kemnitz-Lower Wolfcamp

12. County
Lea

19. Proposed Depth
DTD 13,848'
PBTD 13,000'

19A. Formation
Kemnitz-Lower Wolfcamp

20. Rotary or C.T.
Workover Rig

21. Elevations (Show whether DF, RI, etc.)
4207.4 GL

21A. Kind & Status Plug. Bond
Blanket

21B. Drilling Contractor
Clarke Well Service

22. Approx. Date Work will start
11/20/89

23.

PROPOSED CASING AND CEMENT PROGRAM

SIZE OF HOLE	SIZE OF CASING	WEIGHT PER FOOT	SETTING DEPTH	SACKS OF CEMENT	EST. TOP
17-1/2"	13-3/8"	48# H-40	335	450 sxs. "C"	Circ.
12-1/4"	8-5/8"	24# & 28#	4,499	500 sxs. "H"	
7-7/8"	4-1/2"	11.6# N-80 & 13.5# N-80	13,848	2450 sxs. "H"	9,845'

Propose to recomplate in Kemnitz-Lower Wolfcamp zone from 10,758' to 10,831'.

- ② 1. Set CIBP @13,000' w/2 sxs. cement on top. *add Oloka 13038-055*
- ① 2. Set CIBP @13,300' w/2 sxs. cement on top. *add Morrow 13509-536*
3. Set 2-3/8" 4.6# N-80 tbg. w/Guiberson UNI-VI packer @10,700'.
4. Perforate Kemnitz-Lower Wolfcamp from 10,758' to 10,831' w/30 holes.
5. Acidize w/1000 gals. 15% NEFE acid.
6. Swab test and put on production.

IN ABOVE SPACE DESCRIBE PROPOSED PROGRAM; IF PROPOSAL IS TO DEEPEN OR PLUS BACK, GIVE DATA ON PRESENT PRODUCTIVE ZONE AND PROPOSED NEW PRODUCTIVE ZONE. GIVE BLOWOUT PREVENTER PROGRAM, IF ANY.

I hereby certify that the information above is true and complete to the best of my knowledge and belief.

Signed Harold E. Burke Title President Date November 17, 1989

(This space for State Use)

Orig. Signed by
Paul Kautz
Geologist

APPROVED BY _____ TITLE _____ DATE _____

CONDITIONS OF APPROVAL, IF ANY:

NOV 20 1989

RECEIVED

NOV 20 1964

2024

7 14

NEW MEXICO OIL CONSERVATION COMMISSION
WELL LOCATION AND ACREAGE DEDICATION PLAT

Form C-102
Supersedes C-120
Effective 1-4-85

All distances must be from the outer boundaries of the Section

Operator Hexagon Oil & Gas, Inc..		Lease Hexagon N.M. 28		State 1	
Unit Letter I	Section 28	Township 16South	Range 33East	County Lea	
Actual Footage Location of Well: 1980 feet from the South line and 660 feet from the East line					
Ground Level Elev. 4207.4'	Producing Formation Wolfcamp		Pool Kennedy Lower Wolfcamp	Dedicated Acreage: 80 Acres	

1. Outline the acreage dedicated to the subject well by colored pencil or hachure marks on the plat below.
2. If more than one lease is dedicated to the well, outline each and identify the ownership thereof (both as to working interest and royalty).
3. If more than one lease of different ownership is dedicated to the well, have the interests of all owners been consolidated by communitization, unitization, force-pooling, etc?

☐ Yes ☐ No If answer is "yes" type of consolidation _____

If answer is "no," list the owners and tract descriptions which have actually been consolidated. (Use reverse side of this form if necessary.) _____

No allowable will be assigned to the well until all interests have been consolidated (by communitization, unitization, forced-pooling, or otherwise) or until a non-standard unit, eliminating such interests, has been approved by the Commission.

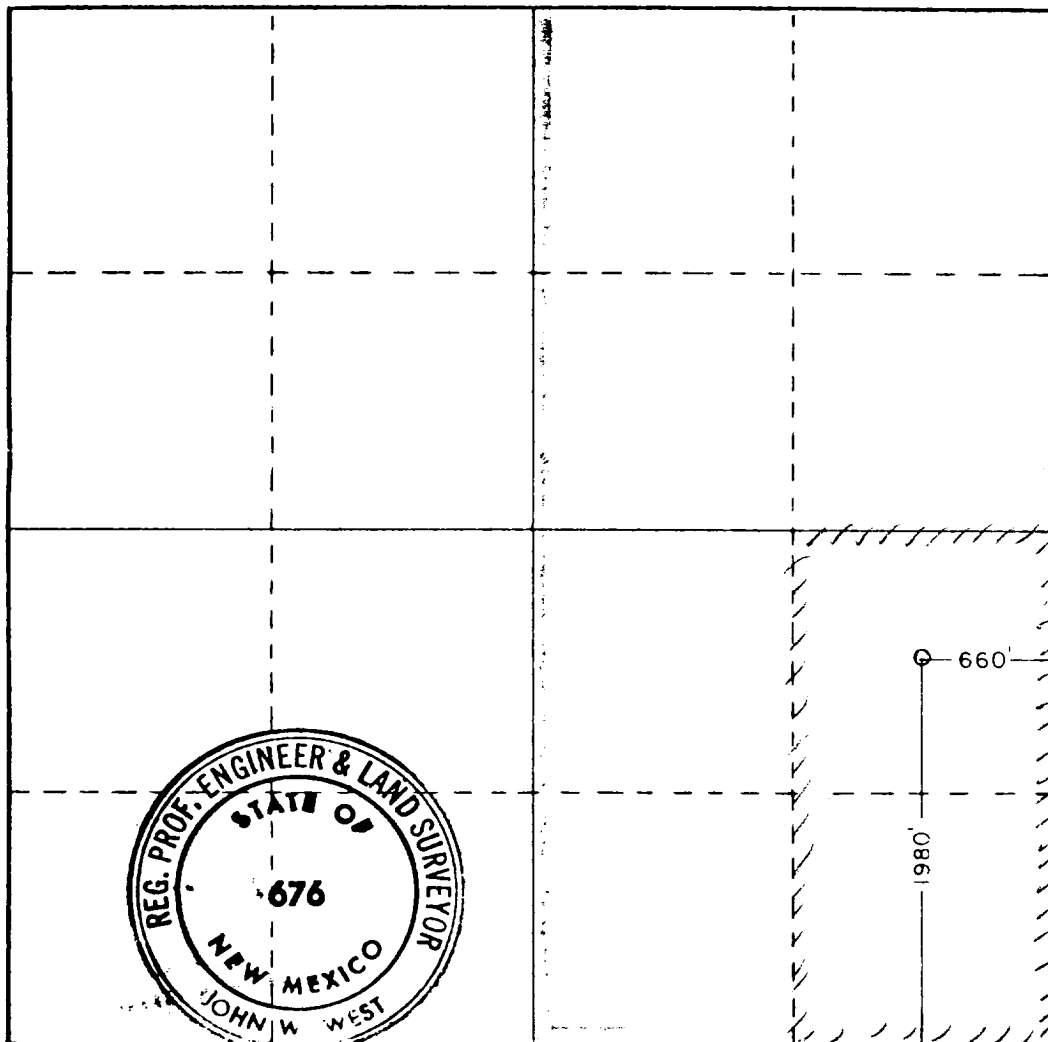

CERTIFICATION

I hereby certify that the information contained herein is true and complete to the best of my knowledge and belief.

John G. Dush
Name

Position
VICE PRESIDENT

Company
HEXAGON OIL & GAS INC.

Date
11/20/89

I hereby certify that the well location shown on this plat was plotted from field notes of actual surveys made by me or under my supervision, and that the same is true and correct to the best of my knowledge and belief.

Date Surveyed
Mar. 11, 1981

Registered Professional Engineer and/or Land Surveyor

John W. West

Certificate No. **JOHN W. WEST 676**
PATRICK A. ROMERO 6868
Ronald J. Eldson 3239

RECEIVED

NOV 20 1989

OCD
HOBBS OFFICE