

Submit to Appropriate
District Office
State Lease - 6 copies
Fee Lease - 5 copies

State of New Mexico
Energy, Minerals and Natural Resources Department

Form C-101
Revised 1-1-89

DISTRICT I
P.O. Box 1980, Hobbs, NM 88240

DISTRICT II
P.O. Drawer DD, Artesia, NM 88210

DISTRICT III
1000 Rio Brazos Rd., Aztec, NM 87410

OIL CONSERVATION DIVISION

P.O. Box 2088
Santa Fe, New Mexico 87504-2088

API NO. (assigned by OCD on New Wells)

30-025-22577

5. Indicate Type of Lease
STATE ☒ FEE ☐

6. State Oil & Gas Lease No.

APPLICATION FOR PERMIT TO DRILL, DEEPEN, OR PLUG BACK

1a. Type of Work: DRILL <input type="checkbox"/> RE-ENTER <input type="checkbox"/> DEEPEN <input type="checkbox"/> PLUG BACK <input checked="" type="checkbox"/>	7. Lease Name or Unit Agreement Name State NM "11"
b. Type of Well: OIL WELL <input checked="" type="checkbox"/> GAS WELL <input type="checkbox"/> OTHER <input type="checkbox"/> SINGLE ZONE <input checked="" type="checkbox"/> MULTIPLE ZONE <input type="checkbox"/>	

2. Name of Operator
Santa Fe Energy Operating Partners, L.P.

8. Well No.
2

3. Address of Operator
500 W. Illinois, Suite 500, Midland, TX 79701

9. Pool name or Wildcat
Tulsk Wolfcamp

4. Well Location
Unit Letter E : 1980 Feet From The North Line and 660 Feet From The West Line
Section 11 Township 15S Range 32E NMPM Lea County

10. Proposed Depth
PBTB 11,965'

11. Formation
Wolfcamp

12. Rotary or C.T.
N/A

13. Elevations (Show whether DF, RT, GR, etc.)
4282' GR

14. Kind & Status Plug. Bond
Blanket/Current

15. Drilling Contractor
N/A

16. Approx. Date Work will start
6-26-89

17. PROPOSED CASING AND CEMENT PROGRAM.

SIZE OF HOLE	SIZE OF CASING	WEIGHT PER FOOT	SETTING DEPTH	SACKS OF CEMENT	EST. TOP

RUPU. ND tree and NU BOP. Load tubing with 2% KCl water. Pull packer and perforating assembly. RU wireline. Run gauge ring and junk basket. Set 10,000# CIBP @ 12,000'. Dump bail 35' cement on top of CIBP. Load hole with 2% KCl water. Perforate the Wolfcamp interval with 4 JSPF 9941-66', 9996' (total 104 holes). Acidize with 3000 gals 20% NEFe acid and 104 - 1.1 S.G. ball sealers. Pump acid in 5 equal stages with 26 ball drops between stages. Swab test and place on production.

IN ABOVE SPACE DESCRIBE PROPOSED PROGRAM: IF PROPOSAL IS TO DEEPEN OR PLUG BACK, GIVE DATA ON PRESENT PRODUCTIVE ZONE AND PROPOSED NEW PRODUCTIVE ZONE. GIVE BLOWOUT PREVENTER PROGRAM, IF ANY.

I hereby certify that the information above is true and complete to the best of my knowledge and belief.

SIGNATURE Terry McCullough TITLE Sr. Production Clerk DATE 6-7-89

TYPE OR PRINT NAME Terry McCullough TELEPHONE NO. 687-3551

(This space for State Use)

ORIGINAL SIGNED BY JERRY SEXTON
DISTRICT I SUPERVISOR

APPROVED BY _____ TITLE _____ DATE _____

CONDITIONS OF APPROVAL, IF ANY:

JUN 14 1989

Permit Expires 6 Months From Approval
Date Unless Drilling Underway.

Wickham

NEW MEXICO OIL CONSERVATION COMMISSION
WELL LOCATION AND ACREAGE DEDICATION PLAT

Form C-122
Supersedes C-128
Effective 1-1-65

All distances must be from the outer boundaries of the Section.

Operator SANTE FE ENERGY CO.			Lease STATE N.M. 11		Well No. 2
Unit Letter E	Section 11	Township 15 SOUTH	Range 32 EAST	County LEA	
Actual Footage Location of Well: 1980 feet from the NORTH line and 660 feet from the WEST line					
Ground Level Elev. 4281.9	Producing Formation Wolfcamp	Pool Tulk (Wolfcamp)		Dedicated Acreage: 40 Acres	

1. Outline the acreage dedicated to the subject well by colored pencil or hachure marks on the plat below.
2. If more than one lease is dedicated to the well, outline each and identify the ownership thereof (both as to working interest and royalty).
3. If more than one lease of different ownership is dedicated to the well, have the interests of all owners been consolidated by communitization, unitization, force-pooling, etc?

☐ Yes ☐ No If answer is "yes," type of consolidation _____

If answer is "no," list the owners and tract descriptions which have actually been consolidated. (Use reverse side of this form if necessary.) _____

No allowable will be assigned to the well until all interests have been consolidated (by communitization, unitization, forced-pooling, or otherwise) or until a non-standard unit, eliminating such interests, has been approved by the Commission.

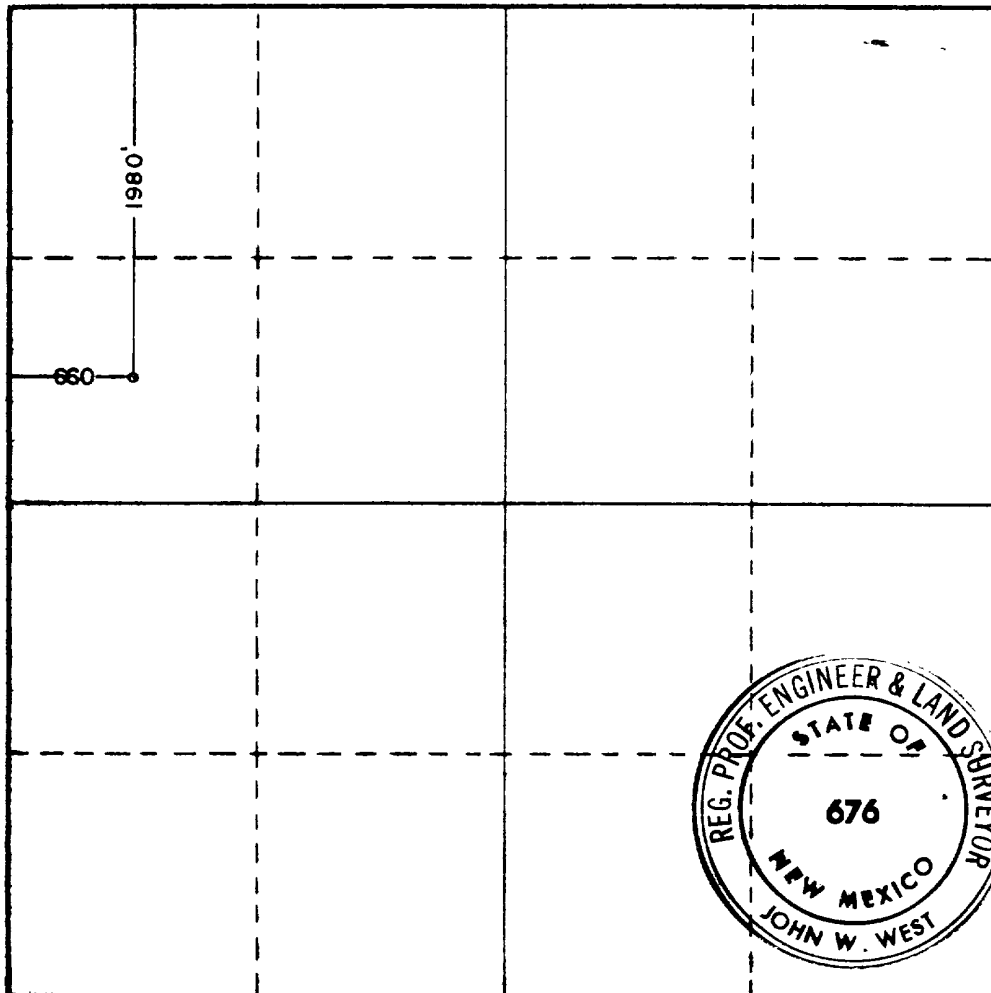

CERTIFICATION

I hereby certify that the information contained herein is true and complete to the best of my knowledge and belief.

Name
Michael R. Buntor
Position
Drilling Engineer
Company
Santa Fe Energy Co.
Date
June 5, 1989

I hereby certify that the well location shown on this plat was plotted from field notes of actual surveys made by me or under my supervision, and that the same is true and correct to the best of my knowledge and belief.

Date Surveyed
9-3-81
Registered Professional Engineer and/or Land Surveyor
John W. West
Certificate No. **JOHN W. WEST 676**
PATRICK A. ROMERO 6685
Ronald J. Egan 3239