

30-025-27577

| | |
|------------------------|--|
| NO. OF COPIES RECEIVED | |
| DISTRIBUTION | |
| ALBUQUERQUE | |
| FILE | |
| J.S.G.S. | |
| LAND OFFICE | |
| OPERATOR | |

NEW MEXICO OIL CONSERVATION COMMISSION

Form C-101
Revised 1-1-65

| |
|--|
| 5A. Indicate Type of Lease STATE <input checked="" type="checkbox"/> FEE <input type="checkbox"/> |
| 5. State Oil & Gas Lease No. LG3657 |
| 7. Unit Agreement Name |
| 8. Farm or Lease Name Diane State |
| 9. Well No. 1-Y |
| 10. Field and Pool, or Wildcat Caudill Permo Penn |
| 12. County Lea |
| 19. Proposed Depth 11000 |
| 19A. Formation Wolfcamp |
| 20. Rotary or C.T. Rotary |
| 21A. Kind & Status Plug. Bond Statewide |
| 21B. Drilling Contractor MGF Drilling Co. |
| 22. Approx. Date Work will start Sept. 10, 1981 |

APPLICATION FOR PERMIT TO DRILL, DEEPEN, OR PLUG BACK

| |
|---|
| Type of Work |
| Type of Well DRILL <input checked="" type="checkbox"/> DEEPEN <input type="checkbox"/> PLUG BACK <input type="checkbox"/> OIL WELL <input checked="" type="checkbox"/> GAS WELL <input type="checkbox"/> OTHER <input type="checkbox"/> SINGLE ZONE <input type="checkbox"/> MULTIPLE ZONE <input type="checkbox"/> |
| Name of Operator Argee Oil Company |
| Address of Operator 810 C & K Petroleum Bldg., Midland, Texas 79701 |
| Location of Well UNIT LETTER <u>I</u> LOCATED <u>700</u> FEET FROM THE <u>East</u> LINE <u>1980</u> FEET FROM THE <u>South</u> LINE OF SEC. <u>16</u> TWP. <u>15-S</u> RGE. <u>36-E</u> NMPM |
| Elevations (Show whether DF, RT, etc.) 3902 Ground |
| 21A. Kind & Status Plug. Bond Statewide |
| 21B. Drilling Contractor MGF Drilling Co. |
| 22. Approx. Date Work will start Sept. 10, 1981 |

PROPOSED CASING AND CEMENT PROGRAM

| SIZE OF HOLE | SIZE OF CASING | WEIGHT PER FOOT | SETTING DEPTH | SACKS OF CEMENT | EST. TOP |
|--------------|----------------|-----------------|---------------|-----------------|----------|
| 17 1/2 | 13 3/8 | 48 | 350 | 200 | Surface |
| 12 1/4 | 8 5/8 | 24 & 32 | 4750 | 200 | 4000 |
| 7 7/8 | 4 1/2 | 11.6 & 13.5 | 11000 | 200 | 10000 |

Drill 17 1/2" hole to 350'. Run and cement 13 3/8" casing at 350' and circulate cement. WOC. NUBOP 12" - 3000 psi WP. Test casing and BOP to 600 psi. Drill a 12 1/4" hole to 4750'. Run 8 5/8" casing to 4750' and cement with 200 sacks cement. WOC 18 hours - NUBOP 10"-3000 psi WP. Drill 7 7/8" hole with water to 10500'. Mud up at 10500' to maintain water loss to less than 12 cc, viscosity 34-36, and weight at \pm 9#/gal. Possible DST in Wolfcamp. If production is indicated, 4 1/2" production casing will be run to total depth of 11000 feet.

***Cement on the intermediate casing must be brought from the top of the salt or anhydrite to the surface casing by either circulating with cement or a DV tool at the top of the salt.

LOVE SPACE DESCRIBE PROPOSED PROGRAM: IF PROPOSAL IS TO DEEPEN OR PLUG BACK, GIVE DATA ON PRESENT PRODUCTIVE ZONE AND PROPOSED NEW PRODUCTION. GIVE BLOWOUT PREVENTER PROGRAM, IF ANY.

by certify that the information above is true and complete to the best of my knowledge and belief.

Jerry Sexton Title Engineer Date 9-15-81
(This space for State Use)
Orig. Signed by
OVERED BY Jerry Sexton TITLE Engineer DATE 9-15-81
ITIONS OF APPROVAL: Jerry Sexton

NEW MEXICO OIL CONSERVATION COMMISSION
WELL LOCATION AND ACREAGE DEDICATION PLAT

4

Form C-102
Supersedes C-128
Effective 1-1-65

All distances must be from the outer boundaries of the Section.

| | | | | |
|---|---------------------------------|----------------------------|--------------------------------|-----------------|
| Operator Argee Oil Company | | Lease Diane State | | Well No. 1-Y |
| Unit Letter I | Section 16 | Township 15 South | Range 36 East | County Lea |
| Actual Footage Location of Well: 1980 feet from the South line and 700 feet from the East line | | | | |
| Ground Level Elev. 3902 | Producing Formation Wolfcamp | Pool Caudill Permo Penn | Dedicated Acreage: 40 Acres | |

1. Outline the acreage dedicated to the subject well by colored pencil or hatchure marks on the plat below.
2. If more than one lease is dedicated to the well, outline each and identify the ownership thereof (both as to working interest and royalty).
3. If more than one lease of different ownership is dedicated to the well, have the interests of all owners been consolidated by communitization, unitization, force-pooling, etc?

☐ Yes ☐ No If answer is "yes," type of consolidation _____

If answer is "no," list the owners and tract descriptions which have actually been consolidated. (Use reverse side of this form if necessary.) _____

No allowable will be assigned to the well until all interests have been consolidated (by communitization, unitization, forced-pooling, or otherwise) or until a non-standard unit, eliminating such interests, has been approved by the Commission.

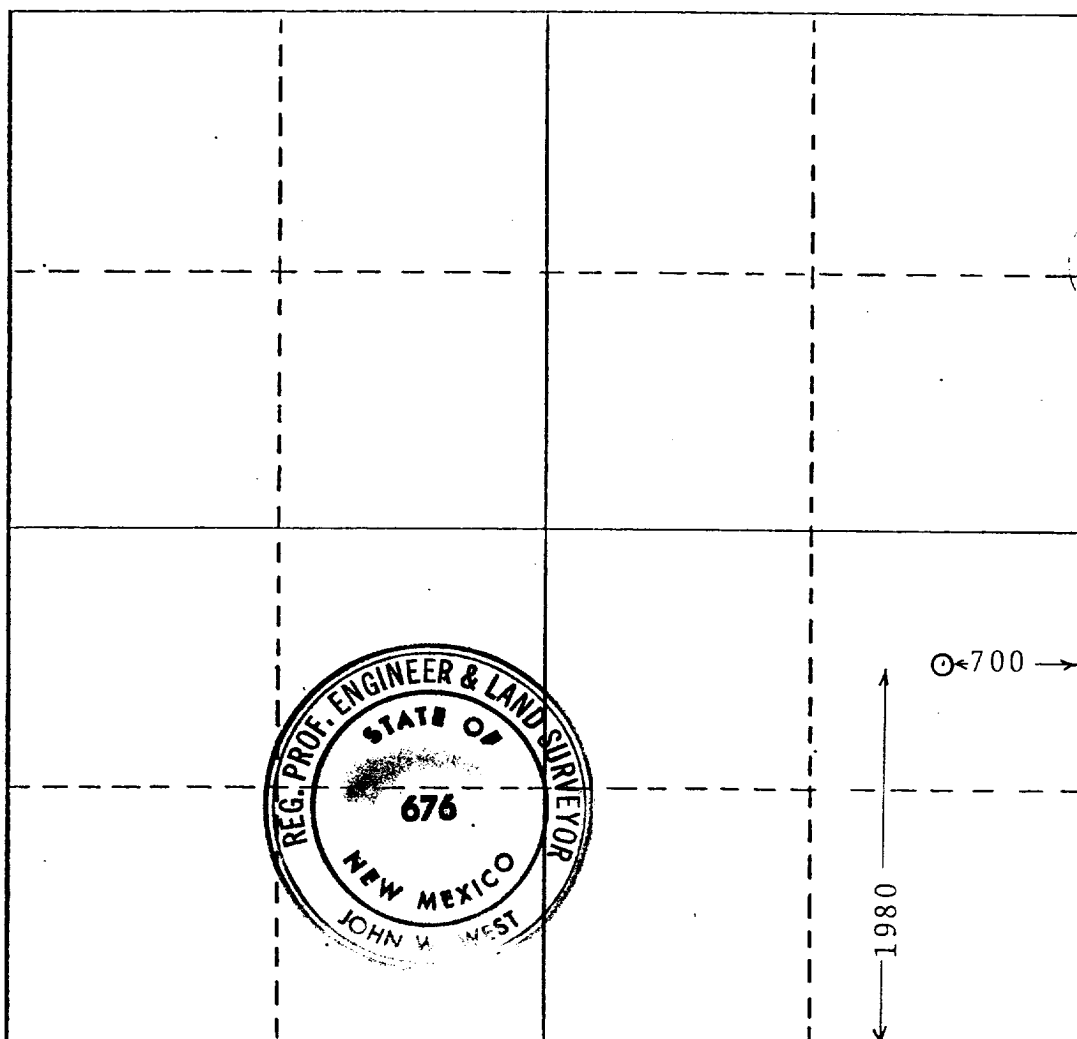

CERTIFICATION

I hereby certify that the information contained herein is true and complete to the best of my knowledge and belief.

Name _____
Position
Agent
Company
Argee Oil Company
Date
Sept. 15, 1981

I hereby certify that the well location shown on this plat was plotted from field notes of actual surveys made by me or under my supervision, and that the same is true and correct to the best of my knowledge and belief.

Date Surveyed
10-2-81
Registered Professional Engineer and/or Land Surveyor
John A. West
Certificate No.
676

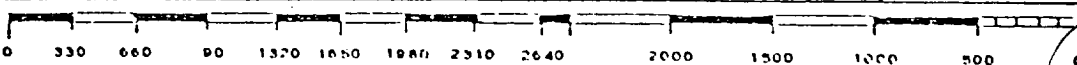

SEP 28 1981

RECEIVED
OCT 5 1981

OIL CONSERVATION DIV.

473