

NEW MEXICO OIL CONSERVATION COMMISSION
WELL LOCATION AND ACREAGE DEDICATION PLAT

Form C-102
Supersedes C-128
Effective 1-1-65

All distances must be from the outer boundaries of the Section.

Operator BELCO PETROLEUM COMPANY			Lease Caudill State		Well No. 2
Unit Letter	Section 26	Township 15-S	Range 36-E	County Lea	
Actual Footage Location of Well:					
660' feet from the North line and		1980' feet from the East line			
Ground Level Elev. 3869'	Producing Formation Strawn lime	Pool Dean Field	Dedicated Acreage: 40 80 Acres		

1. Outline the acreage dedicated to the subject well by colored pencil or hachure marks on the plat below.
2. If more than one lease is dedicated to the well, outline each and identify the ownership thereof (both as to working interest and royalty).
3. If more than one lease of different ownership is dedicated to the well, have the interests of all owners been consolidated by communitization, unitization, force-pooling, etc?

☐ Yes ☐ No If answer is "yes," type of consolidation _____

If answer is "no," list the owners and tract descriptions which have actually been consolidated. (Use reverse side of this form if necessary.) _____

No allowable will be assigned to the well until all interests have been consolidated (by communitization, unitization, forced-pooling, or otherwise) or until a non-standard unit, eliminating such interests, has been approved by the Commission.

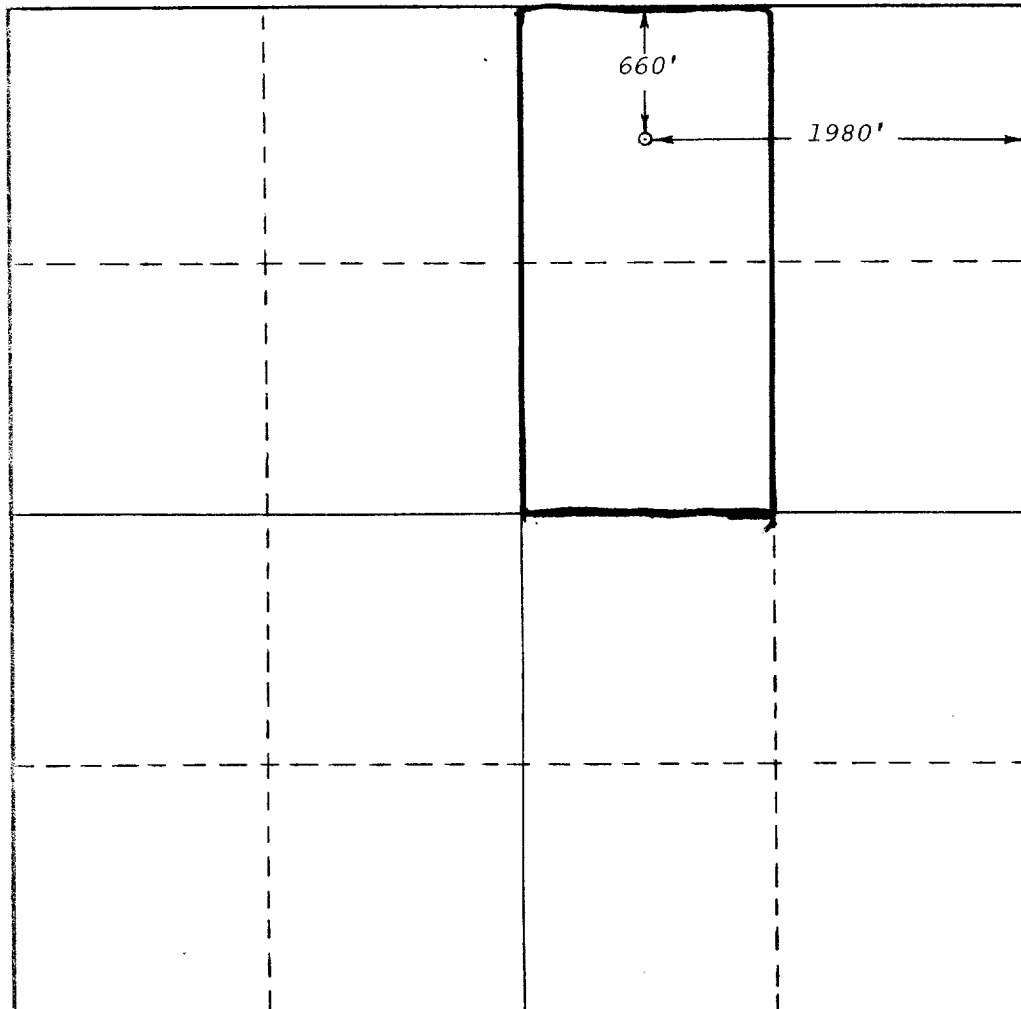

CERTIFICATION

I hereby certify that the information contained herein is true and complete to the best of my knowledge and belief.

M.E. Moore

Name

M.E. Moore

Position

District Manager

Company

Belco Pet. Corp.

Date

11-2-81

I hereby certify that the well location shown on this plat was plotted from field notes of actual surveys made by me or under my supervision, and that the same is true and correct to the best of my knowledge and belief.

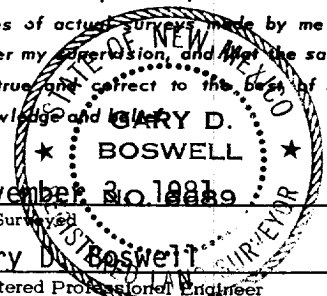

Date Surveyed

Gary D. Boswell

Registered Professional Engineer and/or Land Surveyor

Gary D. Boswell

Certificate No.

6689

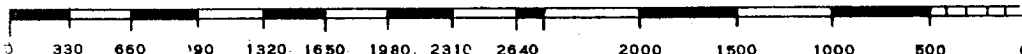

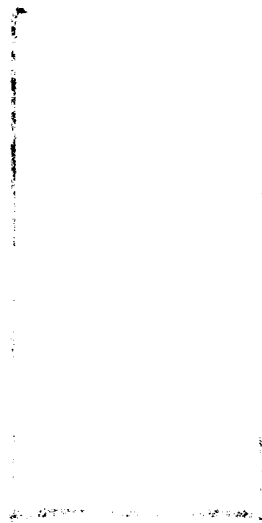

RECEIVED

NOV 24 1981

CONSERVATION DIV

RECEIVED

NOV 10 1981

CONSERVATION DIV

ELF