

STATE OF NEW MEXICO
ENERGY AND MINERALS DEPARTMENT

OIL CONSERVATION DIVISION
P. O. BOX 2088
SANTA FE, NEW MEXICO 87501

30-025-27736

Form C-101
Revised 10-1-78

NO. OF COPIES RECEIVED	
DISTRIBUTION	
SANTA FE	
FILE	
U.S.G.S.	
LAND OFFICE	
OPERATOR	

5A. Indicate Type of Lease
STATE ☐ FEE ☒
5. State Oil & Gas Lease No.

APPLICATION FOR PERMIT TO DRILL, DEEPEN, OR PLUG BACK

1a. Type of Work b. Type of Well OIL WELL <input checked="" type="checkbox"/> GAS WELL <input type="checkbox"/> OTHER <input type="checkbox"/> SINGLE ZONE <input checked="" type="checkbox"/> MULTIPLE ZONE <input type="checkbox"/>		2. Name of Operator Kennedy & Mitchell, Inc.		3. Address of Operator P. O. Box 27D Denver, CO 80227		4. Location of Well UNIT LETTER <u>e</u> LOCATED <u>330</u> FEET FROM THE <u>North</u> LINE AND <u>2310</u> FEET FROM THE <u>West</u> LINE OF SEC. <u>35</u> TWP. <u>16S</u> RGE. <u>35E</u>		7. Unit Agreement Name		8. Form or Lease Name Tilley 758		9. Well No. 758 #1		10. Field and Pool, or Wildcat Shoebar	
11. County Lea								12. Proposed Depth 12,800		13. Formation Devonian		14. Rotary or C.O. Rotary			
15. Elevation (Show whether D.R., etc.) 3980' GL				16. Kind & Status Plug. Bond		17. Drilling Contractor Warton		18. Approx. Date Work will start 3/20/82							

PROPOSED CASING AND CEMENT PROGRAM

SIZE OF HOLE	SIZE OF CASING	WEIGHT PER FOOT	SETTING DEPTH	SACKS OF CEMENT	EST. TOP
17 1/4"	13-3/8"	48	350'	500	Circulate
12 1/4"	8-5/8"	24 & 28	4,400'	3,000	350'
7-7/8"	5-1/2"	17#	12,800	200	10,520'

***Cement on the intermediate casing must be brought from the top of the salt or anhydrite to the surface casing by either circulating with cement, or a DV tool at the top of the salt.

APPROVAL VALID FOR 180 DAYS
PERMIT EXPIRES 9/1/82
UNLESS DRILLING UNDERWAY

IN ABOVE SPACE DESCRIBE PROPOSED PROGRAM; IF PROPOSAL IS TO DEEPEN OR PLUG BACK, GIVE DATA ON PRESENT PRODUCTIVE ZONE AND PROPOSED NEW PRODUCTIVE ZONE. GIVE BLOWOUT PREVENTER PROGRAM, IF ANY.

I hereby certify that the information above is true and complete to the best of my knowledge and belief.

Signed Robert A. Baker Title Production Engineer Date 2/2/82

(This space for State Use)
ORIGINAL SIGNED BY

APPROVED BY JERRY SEXTON TITLE DISTRICT 1 SUPERVISOR DATE MAR 1 1982

CONDITIONS OF APPROVAL, IF ANY: *****See Above**

MEXICO OIL CONSERVATION COMMISS I
WELL LOCATION AND ACREAGE DEDICATION PLAT

Form C-102
Supersedes C-128
Effective 1-1-65

All distances must be from the outer boundaries of the Section.

Operator KENNEDY AND MITCHELL, INC.		Lease TILLEY 758		Well No. 1 758
Unit Letter C	Section 35	Township 16 SOUTH	Range 35 EAST	County LEA
Actual Footage Location of Well: 330 feet from the NORTH line and 2310 feet from the WEST line				
Ground Level Elev. 3964.0	Producing Formation Devonian		Pool Shoebar	Dedicated Acreage: 40 Acres

1. Outline the acreage dedicated to the subject well by colored pencil or hachure marks on the plat below.
2. If more than one lease is dedicated to the well, outline each and identify the ownership thereof (both as to working interest and royalty).
3. If more than one lease of different ownership is dedicated to the well, have the interests of all owners been consolidated by communitization, unitization, force-pooling, etc?

☐ Yes ☐ No If answer is "yes," type of consolidation _____

If answer is "no," list the owners and tract descriptions which have actually been consolidated. (Use reverse side of this form if necessary.) _____

No allowable will be assigned to the well until all interests have been consolidated (by communitization, unitization, forced-pooling, or otherwise) or until a non-standard unit, eliminating such interests, has been approved by the Commission.

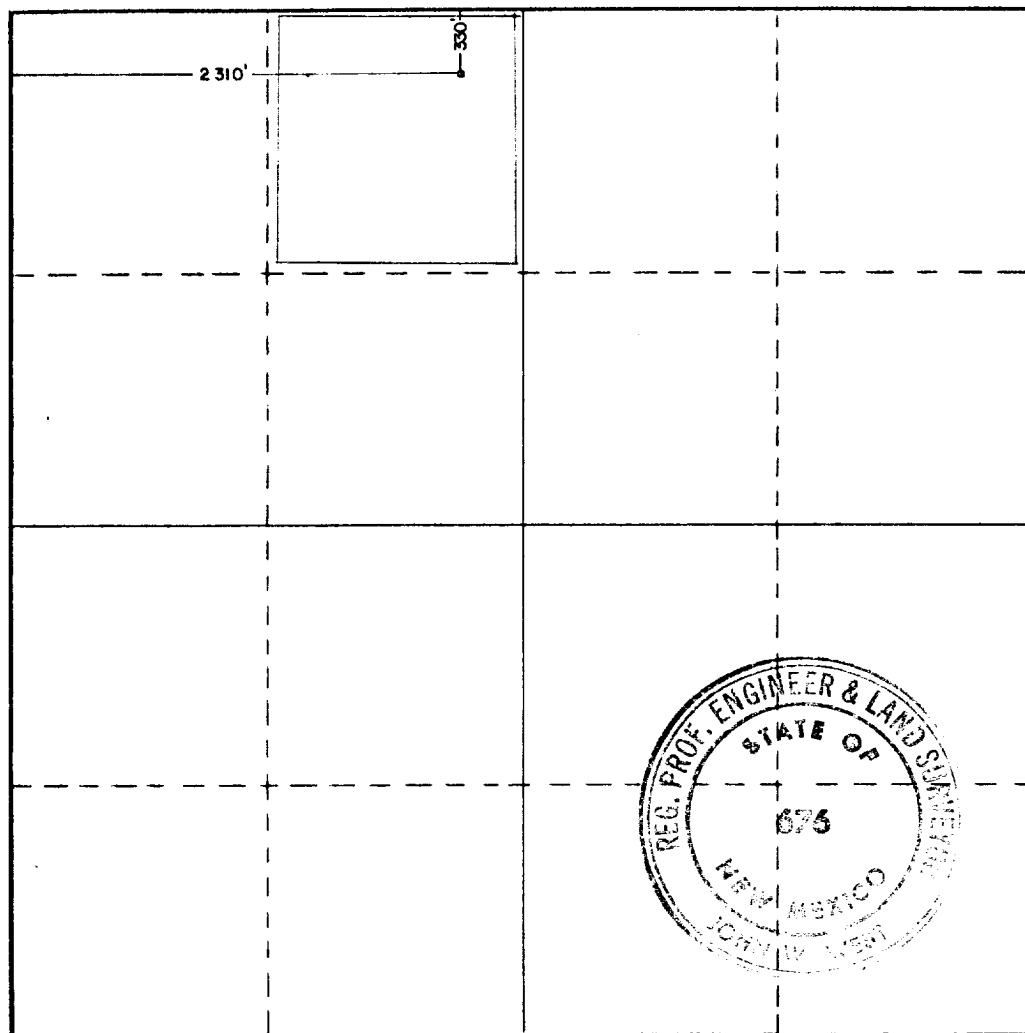

CERTIFICATION

I hereby certify that the information contained herein is true and complete to the best of my knowledge and belief.

Name **Robert A. Baker**
Position **Engr**
Company **Kennedy & Mitchell, Inc**
Date **2-18-82**

I hereby certify that the well location shown on this plat was plotted from field notes of actual surveys made by me or under my supervision, and that the same is true and correct to the best of my knowledge and belief.

Date Surveyed **1-29-82**
Registered Professional Engineer and/or Land Surveyor
John W. West

Certificate No. **JOHN W. WEST 676**
PATRICK A. ROMERO 6863
Ronald J. Eldson 3239

0 330 660 990 1320 1650 1980 2310 2640 2000 1800 1000 500 0

RECEIVED

173

FEB

1972

HQ1

112

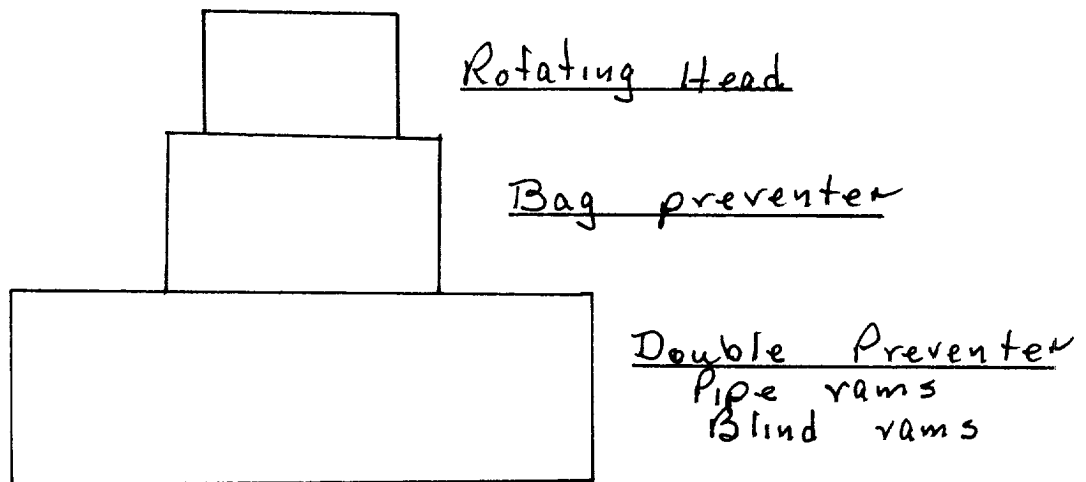

Blewout Preventer Stack

Warten Rig #4

Kennedy & Mitchell Inc

Tirley Well #758

Lea County, New Mexico