

OIL CONSERVATION DIVISION
P. O. BOX 2088
SANTA FE, NEW MEXICO 87501Form C-101
Revised 10-1-78

NO. OF COPIES RECEIVED	
DISTRIBUTION	
SANTA FE	
FILE	
U.S.G.S.	
LAND OFFICE	
OPERATOR	

5A. Indicate Type of Lease STATE <input type="checkbox"/> FEE <input checked="" type="checkbox"/>
5. State Oil & Gas Lease No.
7. Unit Agreement Name
8. Farm or Lease Name Dickinson Cattle Co. 33
9. Well No. 3
10. Field and Pool, or Wildcat East Denton UNDESIGNATED
12. County LEA

APPLICATION FOR PERMIT TO DRILL, DEEPEN, OR PLUG BACK

1a. Type of Work b. Type of Well OIL WELL <input checked="" type="checkbox"/> GAS WELL <input type="checkbox"/> OTHER <input type="checkbox"/> DEEPEN <input type="checkbox"/> PLUG BACK <input type="checkbox"/> SINGLE ZONE <input type="checkbox"/> MULTIPLE ZONE <input type="checkbox"/>	2. Name of Operator Reading & Bates Petroleum Company	3. Address of Operator 810 North Dixie Blvd. Room 202 Odessa, Texas 79761	4. Location of Well UNIT LETTER "O" LOCATED 660 FEET FROM THE South LINE AND 1980 FEET FROM THE East LINE OF SEC. 33 TWP. 14-S RGE. 38-E NMPM	19. Proposed Depth 9800'	19A. Formation Wolfcamp	20. Rotary or C.T. Rotary	21. Elevations (Show whether DF, RT, etc.) 3760' GR	21A. Kind & Status Plug. Bond	21B. Drilling Contractor	22. Approx. Date Work will start 6-20-82
---	--	--	---	-----------------------------	----------------------------	------------------------------	--	-------------------------------	--------------------------	---

23.

PROPOSED CASING AND CEMENT PROGRAM

SIZE OF HOLE	SIZE OF CASING	WEIGHT PER FOOT	SETTING DEPTH	SACKS OF CEMENT	EST. TOP
17 1/2	13 3/8	54.50	450'	550	Surface (circ)
12 1/2	8 5/8	32#	4900'	1350	Surface (circ)
7 7/8	5 1/2	17#	9800'	225	8300'

Bond # 40S-35633 76 BCA

APPROVAL VALID FOR 180 DAYS
PERMIT EXPIRES 12/25/82
UNLESS DRILLING UNDERWAY

IN ABOVE SPACE DESCRIBE PROPOSED PROGRAM: IF PROPOSAL IS TO DEEPEN OR PLUG BACK, GIVE DATA ON PRESENT PRODUCTIVE ZONE AND PROPOSED NEW PRODUCTIVE ZONE. GIVE BLOWOUT PREVENTER PROGRAM, IF ANY.

I hereby certify that the information above is true and complete to the best of my knowledge and belief.

Signed Don J. Kipgen Title Production Superintendent Date 6-9-82

(This space for State Use)

ORIGINAL SIGNED BY

APPROVED BY JERRY SEXTON TITLE DISTRICT SUPERVISOR DATE JUN 25 1982

CONDITIONS OF APPROVAL

RECEIVED

JUN 17 1982

O.C.D.
HOBBS OFFICE

**NEW MEXICO OIL CONSERVATION COMMISSION
WELL LOCATION AND ACREAGE DEDICATION PLAT**

Form C-102
Supersedes C-128
Effective 1-1-65

All distances must be from the outer boundaries of the Section.

Operator READING AND BATES PETROLEUM CO.			Lease Dickinson Cattle Co. 33		Well No. 3
Unit Letter 0	Section 33	Township 14-S	Range 38-E	County Lea	

Actual Footage Location of Well:

660 feet from the South line and 1980 feet from the East line	
Ground Level Elev. 3760'	Producing Formation Wolfcamp
Pool East Denton	Dedicated Acreage: 40 Acres

1. Outline the acreage dedicated to the subject well by colored pencil or hachure marks on the plat below.
2. If more than one lease is dedicated to the well, outline each and identify the ownership thereof (both as to working interest and royalty).
3. If more than one lease of different ownership is dedicated to the well, have the interests of all owners been consolidated by communitization, unitization, force-pooling, etc?

☐ Yes ☒ No If answer is "yes," type of consolidation _____

If answer is "no," list the owners and tract descriptions which have actually been consolidated. (Use reverse side of this form if necessary.) _____

No allowable will be assigned to the well until all interests have been consolidated (by communitization, unitization, forced-pooling, or otherwise) or until a non-standard unit, eliminating such interests, has been approved by the Commission.

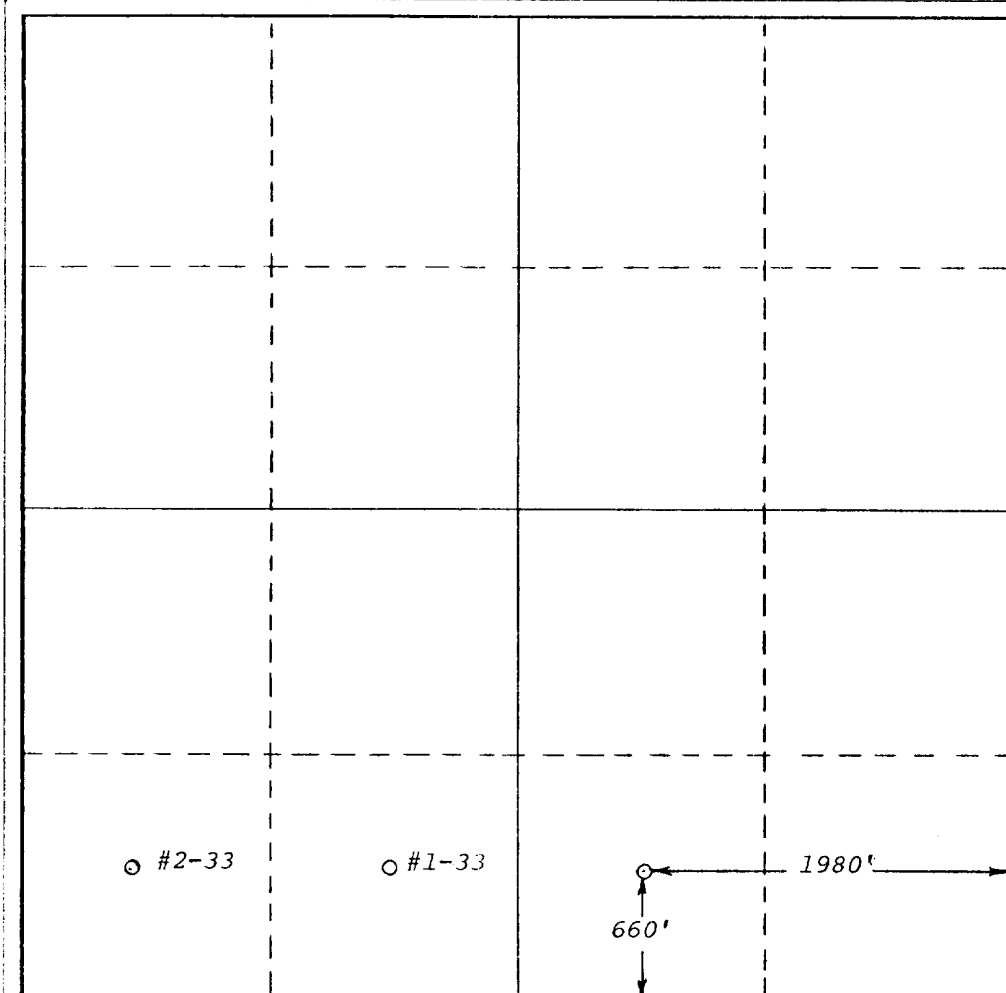

CERTIFICATION

I hereby certify that the information contained herein is true and complete to the best of my knowledge and belief.

Donald J. Kipgen
Name
Donald J. Kipgen

Production Superintendent
Position
Reading & Bates Petro. Co

Company

6-4-82

Date

I hereby certify that the well location shown on this plat was plotted from field notes of actual surveys made by me or under my supervision, and that the same is true and correct to the best of my knowledge and belief.

GARY D. BOSWELL
NO. 6689

May 1982

Date Survey
Gary D. Boswell

Registered Professional Engineer
and/or Land Surveyor

Gary D. Boswell
Certificate No.

6689

RECEIVED

JUN 2 1982

HONOLULU OFFICE

HONOLULU OFFICE

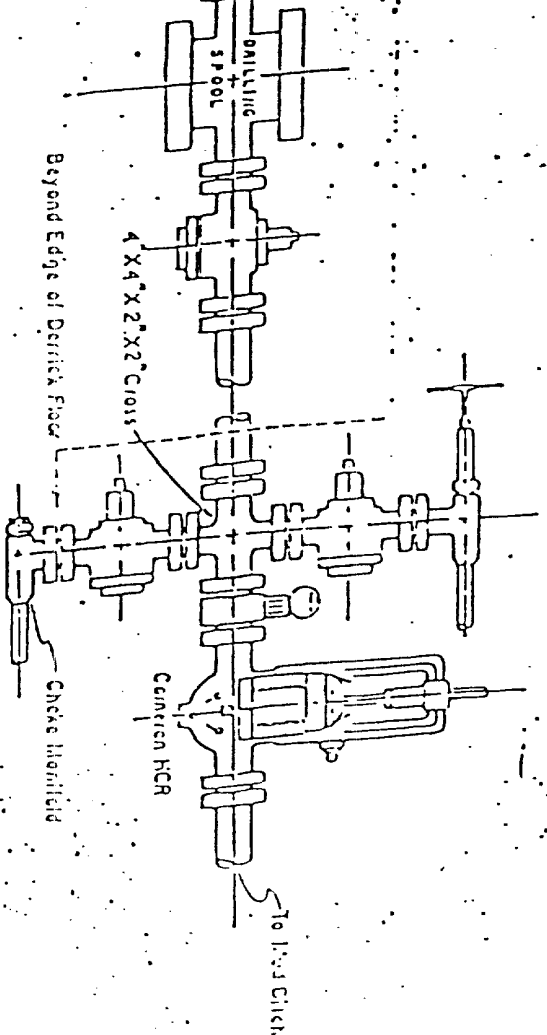
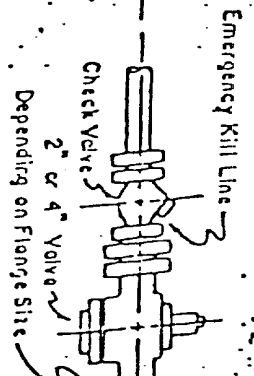
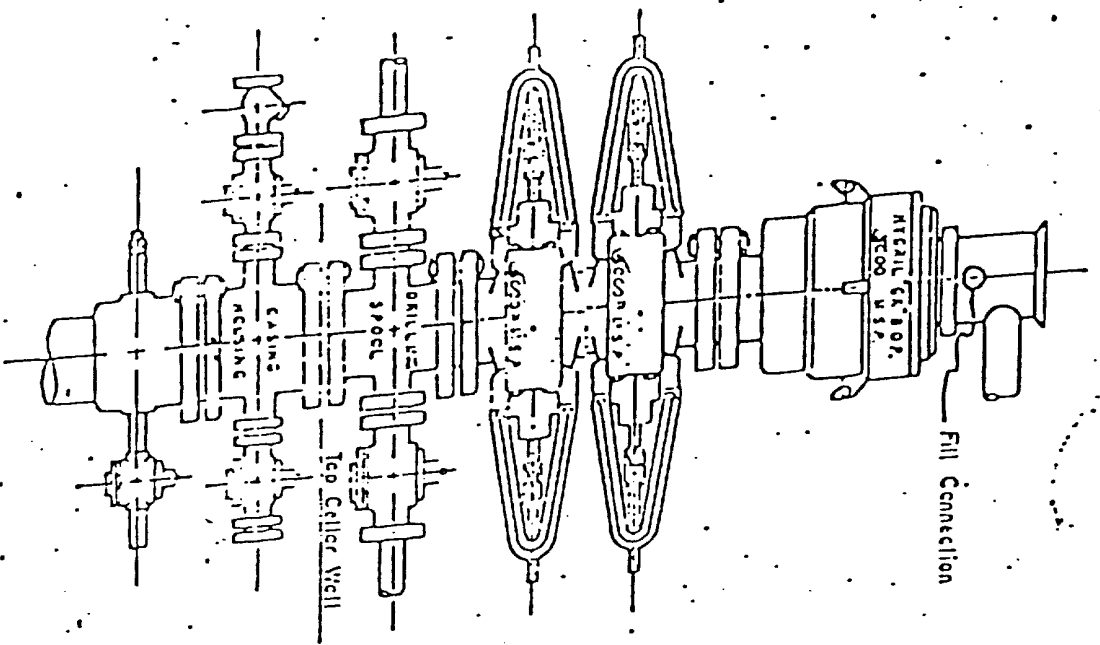

3000 PSI WORKING PRESSURE
 BLOWOUT PREVENTER HOOK-UP

Series 1500 Flanges, or Better

173

RECEIVED
JUN 17 1982
F.C.D.
HOLE OFFICE