

REVISED

30-025-27779

NO. OF COPIES RECEIVED	
DISTRIBUTION	
SANTA FE	
FILE	
U.S.G.S.	
LAND OFFICE	
OPERATOR	

NEW MEXICO OIL CONSERVATION COMMISSION

Form C-101
Revised 1-1-65

5A. Indicate Type of Lease	
STATE <input checked="" type="checkbox"/>	FEE <input type="checkbox"/>
5. State Oil & Gas Lease No.	
5-15973	

APPLICATION FOR PERMIT TO DRILL, DEEPEN, OR PLUG BACK

1a. Type of Work		7. Unit Agreement Name	
b. Type of Well DRILL <input checked="" type="checkbox"/> DEEPEN <input type="checkbox"/> PLUG BACK <input type="checkbox"/>		8. Farm or Lease Name	
OIL WELL <input checked="" type="checkbox"/> GAS WELL <input type="checkbox"/> OTHER <input type="checkbox"/> SINGLE ZONE <input checked="" type="checkbox"/> MULTIPLE ZONE <input type="checkbox"/>		Lea "ZO" State	
2. Name of Operator		9. Well No.	
Gulf Oil Corporation		1	
3. Address of Operator		10. Field and Pool, or Wildcat	
P. O. Box 670, Hobbs, NM 88240		Maljamar	
4. Location of Well		12. County	
UNIT LETTER N LOCATED 330 FEET FROM THE South LINE		Lea	
AND 2310 FEET FROM THE West LINE OF SEC. 35 TWP. 16S RGE. 32E NMI'M			
19. Proposed Depth		19A. Formation	
4550'		Grayburg-San Andres Rotary	
21. Elevations (Show whether DE, RT, etc.)		20. Rotary or C.T.	
4264.4' GL		11-1-82	
21A. Kind & Status Plug. Bond		21B. Drilling Contractor	
Blanket		Cactus	
22. Approx. Date Work will start			

PROPOSED CASING AND CEMENT PROGRAM

SIZE OF HOLE	SIZE OF CASING	WEIGHT PER FOOT	SETTING DEPTH	SACKS OF CEMENT	EST. TOP
12 1/4"	8-5/8"	24#	350'	250	circ
7-7/8"	5 1/2"	14#	4550'	750	circ

Drilling Mud: 0' - 400' Fresh water spud mud, 9.0 ppg, 35-40 vis, 9-10 ph
 400' - 4550' Brine water, 10.0-10.2 ppg, 29-30 vis, 9 ph, 20 wl

See Attached BOP Drawing #2

APPROVAL VALID FOR 180 DAYS
 PERMIT EXPIRES 5/16/83
 UNLESS DRILLING UNDERWAY

IN ABOVE SPACE DESCRIBE PROPOSED PROGRAM; IF PROPOSAL IS TO DEEPEN OR PLUG BACK, GIVE DATA ON PRESENT PRODUCTIVE ZONE AND PROPOSED NEW PRODUCTIVE ZONE. GIVE BLOWOUT PREVENTER PROGRAM, IF ANY.

I hereby certify that the information above is true and complete to the best of my knowledge and belief.

Signed L.C. Gidd Title Area Production Manager Date 11-12-82

(This space for State Use)

APPROVED BY Eddie W. Dean TITLE OIL & GAS INSPECTOR DATE NOV 16 1982

CONDITIONS OF APPROVAL, IF ANY:

REVISED
N MEXICO OIL CONSERVATION COMMISS
WELL LOCATION AND ACREAGE DEDICATION PLAT

Form C-102
Supersedes C-128
Effective 1-1-65

All distances must be from the outer boundaries of the Section

Operator Gulf Oil Corporation			Lease 20 State		Well No. 1
Unit Letter N	Section 35	Township 16 S	Range 32 E	County Lea County	

Actual Footage Location of Well:

330 feet from the South line and		2310 feet from the West line	
Ground Level Elev. 4264.4	Producing Formation Grayburg-San Andres	Pool Maljamar	Dedicated Acreage: 40 Acres

1. Outline the acreage dedicated to the subject well by colored pencil or hatchure marks on the plat below.
2. If more than one lease is dedicated to the well, outline each and identify the ownership thereof (both as to working interest and royalty).
3. If more than one lease of different ownership is dedicated to the well, have the interests of all owners been consolidated by communitization, unitization, force-pooling, etc?

☐ Yes ☐ No If answer is "yes!" type of consolidation _____

If answer is "no" list the owners and tract descriptions which have actually been consolidated. (Use reverse side of this form if necessary.) _____

No allowable will be assigned to the well until all interests have been consolidated (by communitization, unitization, forced-pooling, or otherwise) or until a non-standard unit, eliminating such interests, has been approved by the Commission.

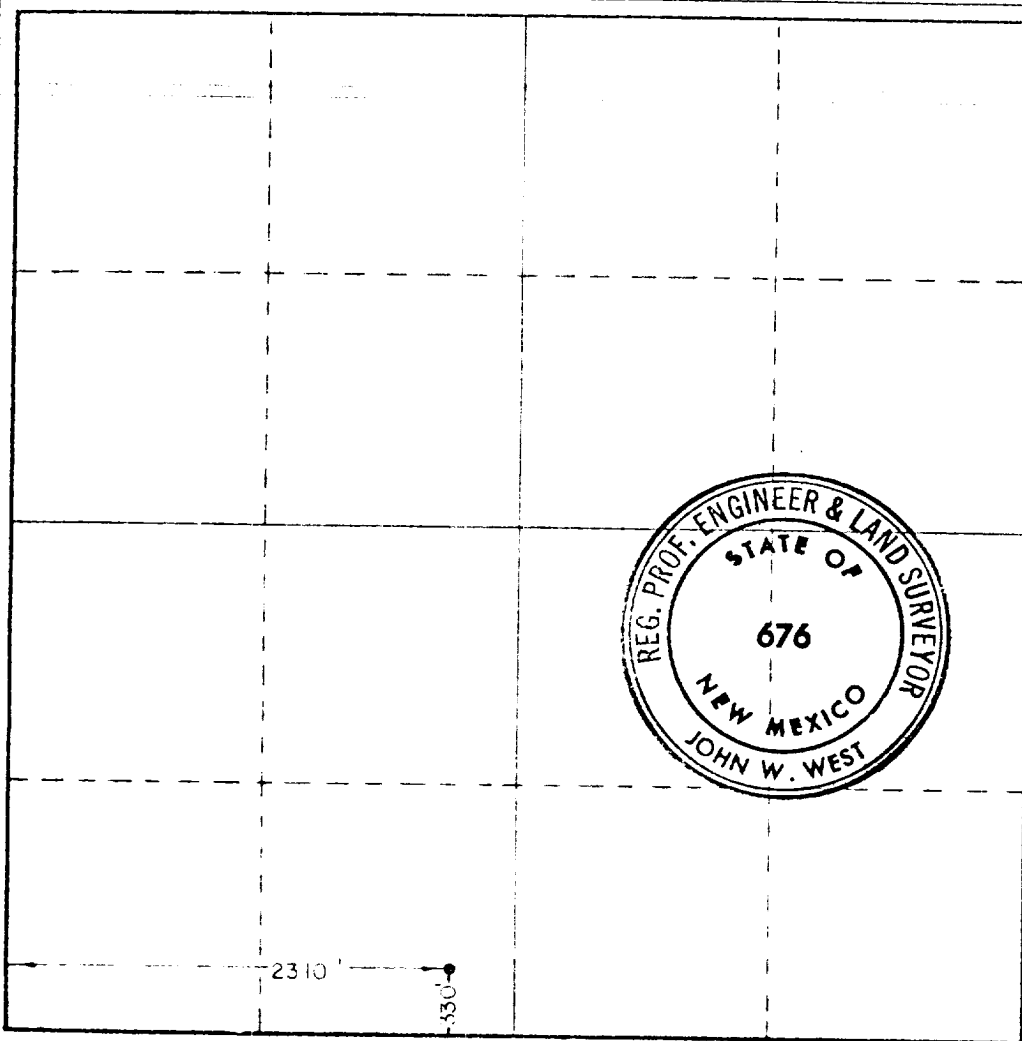

CERTIFICATION

I hereby certify that the information contained herein is true and complete to the best of my knowledge and belief.

R. D. Pitre

Name

R. D. Pitre

Position

Area Engineer

Company

Gulf Oil Corporation

Date

11-9-82

I hereby certify that the well location shown on this plat was plotted from field notes of actual surveys made by me or under my supervision, and that the same is true and correct to the best of my knowledge and belief.

Date Surveyed

11/08/82

Registered Professional Engineer and/or Land Surveyor

John W. West

Certificate No.

676

0 330 660 990 1320 1650 1980 2310 2640 2970 3300 3630 3960 4290 4620 4950 5280 5610 5940 6270 6600 6930 7260 7590 7920 8250 8580 8910 9240 9570 9900

RECEIVED

NOV 15 1982

RECEIVED

NOV 16 1982

NOBIS OFFICE