

N. M. OIL CONS. COMMISSION

P. O. BOX 1980

HOBBS, NEW MEXICO

DEPARTMENT OF THE INTERIOR

GEOLOGICAL SURVEY

SUBMIT IN TRIPLICATE
(Other instructions on
reverse side)Form approved.
Budget Bureau No. 42-R1425.30-025-28112
5. LEASE DESIGNATION AND SERIAL NO.

NM-19857

6. IF INDIAN, ALLOTTEE OR TRIBE NAME

7. UNIT AGREEMENT NAME

8. FARM OR LEASE NAME

FEDERAL 15

9. WELL NO.

1

10. FIELD AND POOL, OR WILDCAT

UNDES. SAUNDERS PERMO U. PENN

11. SEC., T., R., M., OR BLK.
AND SURVEY OR AREA

SEC. 15, T. 15 S., R. 33 E.

12. COUNTY OR PARISH

LEA

13. STATE

NEW MEXICO

APPLICATION FOR PERMIT TO DRILL, DEEPEN, OR PLUG BACK

1a. TYPE OF WORK

DRILL ☒DEEPEN ☐PLUG BACK ☐

b. TYPE OF WELL

OIL
WELL ☒GAS
WELL ☐

OTHER

SINGLE
ZONE ☒MULTIPLE
ZONE ☐

2. NAME OF OPERATOR

TOWNER PETROLEUM COMPANY

3. ADDRESS OF OPERATOR

16701 GREENSPPOINT PARK DRIVE, SUITE 300, HOUSTON, TEXAS 77060

4. LOCATION OF WELL (Report location clearly and in accordance with any State requirements.)*
At surface

1980' FNL AND 1980' FEL OF SECTION 15

At proposed prod. zone

14. DISTANCE IN MILES AND DIRECTION FROM NEAREST TOWN OR POST OFFICE*

16 MILES WEST-NORTHWEST OF LOVINGTON, NEW MEXICO

15. DISTANCE FROM PROPOSED*
LOCATION TO NEAREST
PROPERTY OR LEASE LINE, FT.
(Also to nearest drig. unit line, if any)

660'

16. NO. OF ACRES IN LEASE

320

17. NO. OF ACRES ASSIGNED
TO THIS WELL

40

18. DISTANCE FROM PROPOSED LOCATION*
TO NEAREST WELL, DRILLING, COMPLETED,
OR APPLIED FOR, ON THIS LEASE, FT.

-

19. PROPOSED DEPTH

10,500'

20. ROTARY OR CABLE TOOLS

ROTARY

21. ELEVATIONS (Show whether DF, RT, GR, etc.)

4180'

22. APPROX. DATE WORK WILL START*

UPON APPROVAL

23.

PROPOSED CASING AND CEMENTING PROGRAM

SIZE OF HOLE	SIZE OF CASING	WEIGHT PER FOOT	SETTING DEPTH	QUANTITY OF CEMENT
26"	20"	CONDUCTOR CSG.	40'	TO FILL TO SURFACE
17-1/2"	13-3/8"	48#	400'	SUFFICIENT TO CIRCULATE
12-1/4"	9-5/8"	36# & 40#	4300'	SUFFICIENT TO CIRCULATE
7-7/8"	5-1/2"	17#	10,500'	250 SACKS

AFTER SETTING PRODUCTION CASING, PAY ZONE WILL BE PERFORATED AND
STIMULATED AS NECESSARY.

RECEIVED

DEC 14 1982

OIL & GAS
MINERALS MGMT. SERVICE
ROSWELL, NEW MEXICO

IN ABOVE SPACE DESCRIBE PROPOSED PROGRAM: If proposal is to deepen or plug back, give data on present productive zone and proposed new productive zone. If proposal is to drill or deepen directionally, give pertinent data on subsurface locations and measured and true vertical depths. Give blowout preventer program, if any.

24.

SIGNATURE

Arthur R. Brown

TITLE

Agent for
TOWNER PETROLEUM COMPANY

DATE

DECEMBER 10, 1982

(This space for Federal or State office use)

(Orig. Sgd.) GEORGE H. STEWART

PERMIT NO.

DEC 17 1982

APPROVAL DATE

APPROVED BY

JAMES A. GILHAM
DISTRICT SUPERVISOR

TITLE

DATE

All distances must be from the outer boundaries of the Section.

Operator Towner Petroleum, Co.			Lease Federal 15		Well No. 1
Unit Letter G	Section 15	Township 15-S	Range 33-E	County Lea	
Actual Footage Location of Well: 1980 feet from the N line and 1980 feet from the E line					
Ground Level Elev. 4180'	Producing Formation PENN		Pool UNDES. SAUNDERS PERMO UPPER PENN		Dedicated Acreage: 40 Acres

1. Outline the acreage dedicated to the subject well by colored pencil or hatchure marks on the plat below.
2. If more than one lease is dedicated to the well, outline each and identify the ownership thereof (both as to working interest and royalty).
3. If more than one lease of different ownership is dedicated to the well, have the interests of all owners been consolidated by communitization, unitization, force-pooling, etc?

☐ Yes ☒ No If answer is "yes," type of consolidation _____

If answer is "no," list the owners and tract descriptions which have actually been consolidated. (Use reverse side of this form if necessary.) _____

No allowable will be assigned to the well until all interests have been consolidated (by communitization, unitization, forced-pooling, or otherwise) or until a non-standard unit, eliminating such interests, has been approved by the Division.

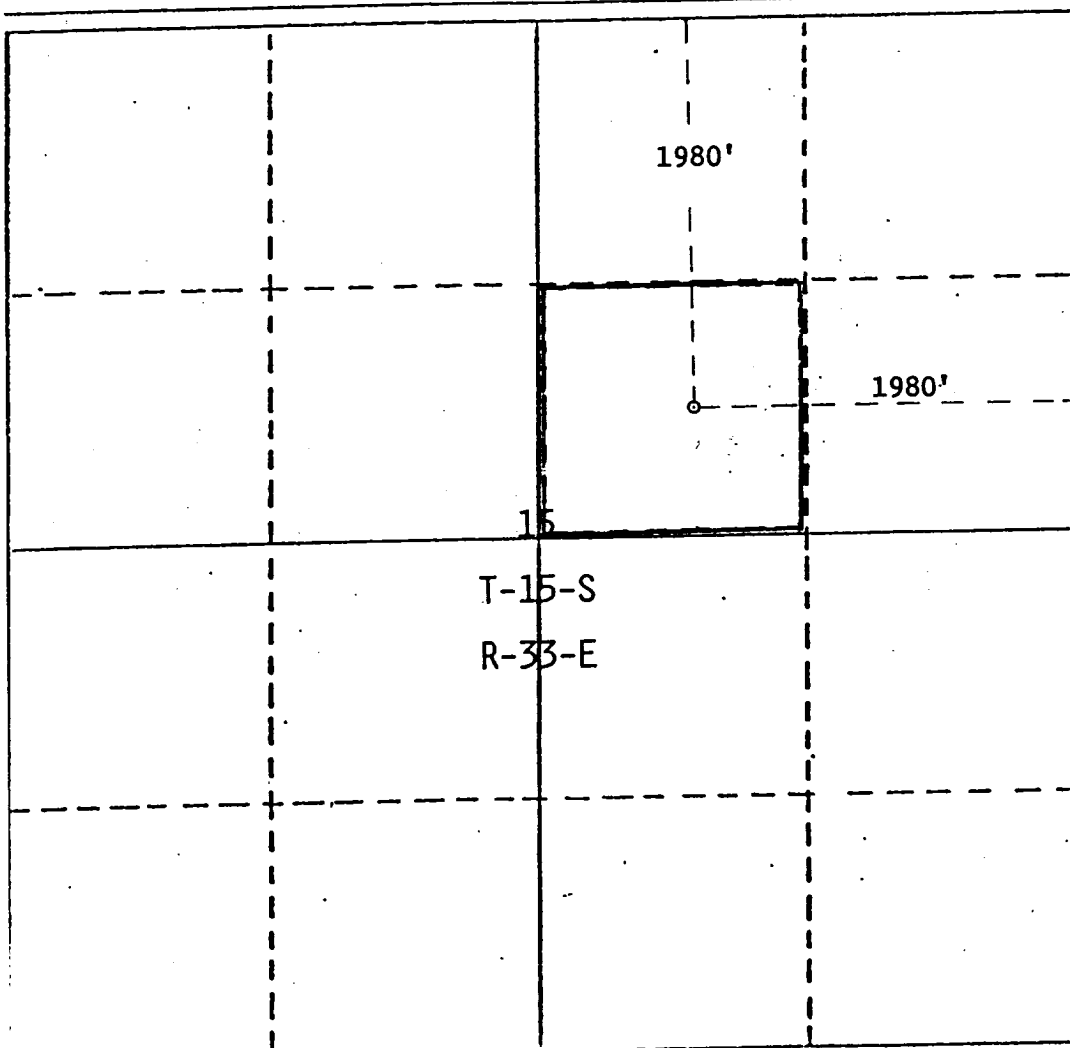

CERTIFICATION

I hereby certify that the information contained herein is true and complete to the best of my knowledge and belief.

Arthur R. Brown
Name _____

PROFESSION _____
Agent for

Company: **NO. 3959**
TOWNER PETROLEUM COMPANY

Date **DECEMBER 8, 1982**

I hereby certify that the well location shown on this plat was plotted from field notes of actual surveys made by me or under my supervision, and that the same is true and correct to the best of my knowledge and belief.

November 22, 1982
Date Surveyed

W.D. Watson, Jr.
Registered Professional Engineer
and/or Land Surveyor

W.D. Watson, Jr.

Certificate No. **3959**

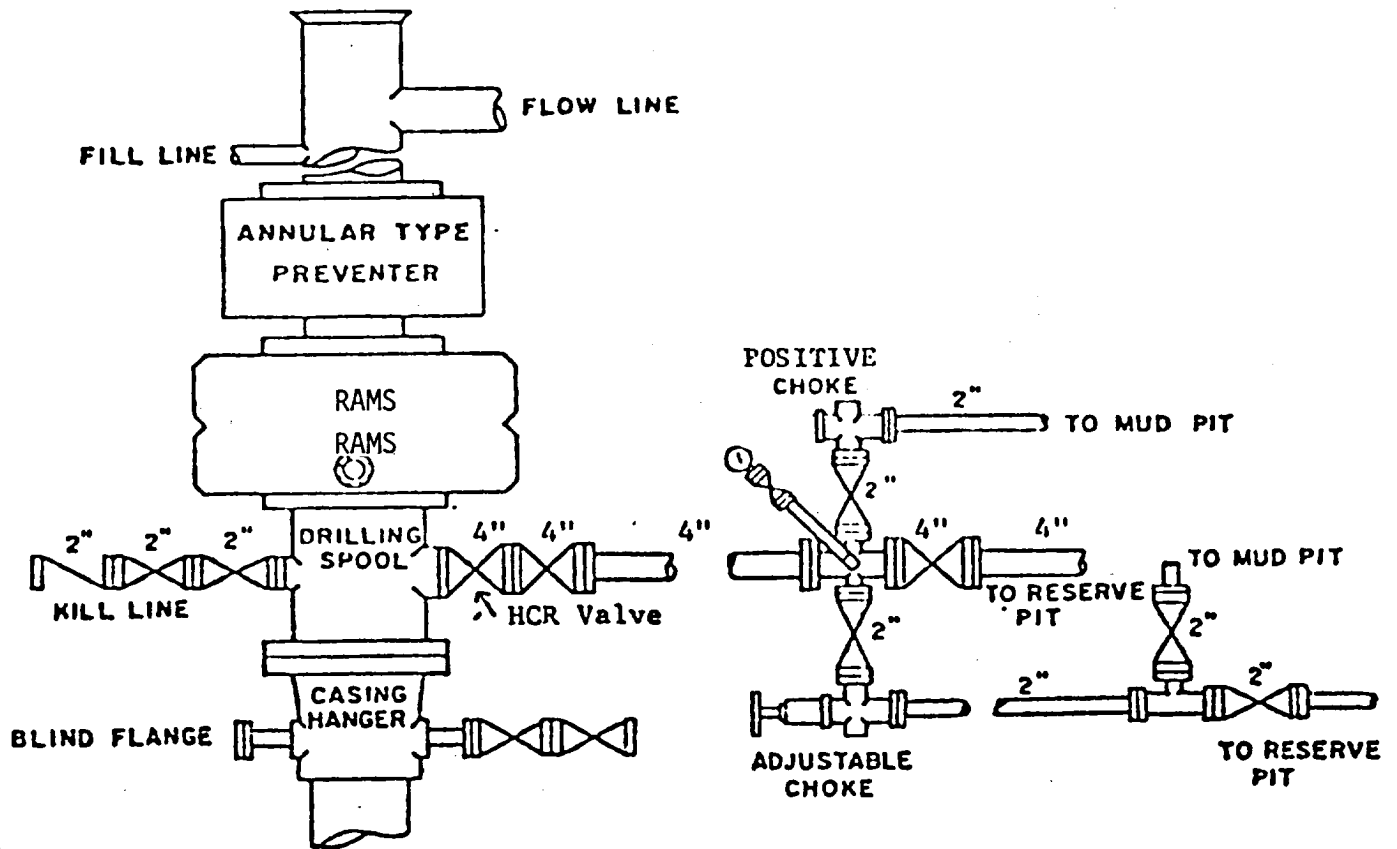

BOP STACK

SERIES 900

BOP ARRANGEMENT