

NO. OF COPIES RECEIVED	
DISTRIBUTION	
SANTA FE	
FILE	
U.S.G.S.	
LAND OFFICE	
OPERATOR	

API No. 30-025-28438

5A. Indicate Type of Lease
STATE ☒ FEE ☐
5. State Oil & Gas Lease No.
B-2229

APPLICATION FOR PERMIT TO DRILL, DEEPEN, OR PLUG BACK

a. Type of Work
DRILL ☒ DEEPEN ☐ PLUG BACK ☐
b. Type of Well
OIL WELL ☒ GAS WELL ☐ OTHER ☐
c. Name of Operator
Phillips Petroleum Company

7. Unit Agreement Name

8. Farm or Lease Name
Phillips "E" State
9. Well No.
34

d. Address of Operator
Room 401, 4001 Penbrook Street, Odessa, Texas 79762

10. Field and Pool, or Wildcat
Maljamar (Gb/SA)

e. Location of Well
UNIT LETTER P LOCATED 760 FEET FROM THE South LINE
AND 720 FEET FROM THE East LINE OF SEC. 9 TWP. 17-S RGE. 33-E N.M.P.M.

12. County
Lea

19. Proposed Depth <u>4,900'</u>	19A. Formation <u>Grayburg/SA</u>	20. Rotary or C.T. <u>Rotary</u>
21A. Kind & Status Plug. Bond <u>Blanket</u>	21B. Drilling Contractor <u>Advise later</u>	22. Approx. Date Work will start <u>Upon approval</u>

23. PROPOSED CASING AND CEMENT PROGRAM

SIZE OF HOLE	SIZE OF CASING	WEIGHT PER FOOT	SETTING DEPTH	SACKS OF CEMENT	EST. TOP
12-1/4"	8-5/8"	24#, K-55 ST&C	350'	350 sx Class C w/2% Cacl. Circ to surface.	
7-7/8"	4-1/2"	11.6# N-80 ST&C	4800'	Caliper volume plus 30% excess w/sufficient volume TLW + 10% DD, 12#/sx salt, 1/4# per sx cellophane, 3#/sx gilsonite. Followed by 250 sx of Class H + 5#/sx salt. Circ to surface.	

Use Mud additives as required for control.

BOP Equip: Figure 7-9 or 7-10 (sketch attached)

IN ABOVE SPACE DESCRIBE PROPOSED PROGRAM: IF PROPOSAL IS TO DEEPEN OR PLUG BACK, GIVE DATA ON PRESENT PRODUCTIVE ZONE AND PROPOSED NEW PRODUCTION ZONE. GIVE BLOWOUT PREVENTER PROGRAM, IF ANY.

I hereby certify that the information above is true and complete to the best of my knowledge and belief.

Signed H. J. Mueller Title Sr. Engineering Specialist Date October 19, 1983

(This space for State Use)

ORIGINAL SIGNED BY JERRY SEXTON
DISTRICT I SUPERVISOR

APPROVED BY _____ TITLE _____

DATE OCT 24 1983

CONDITIONS OF APPROVAL, IF ANY:

APPROVAL VALID FOR 180 DAYS
PERMIT EXPIRES 4/24/84
UNLESS DRILLING UNDERWAY

FIELD PRACTICES AND STANDARDS

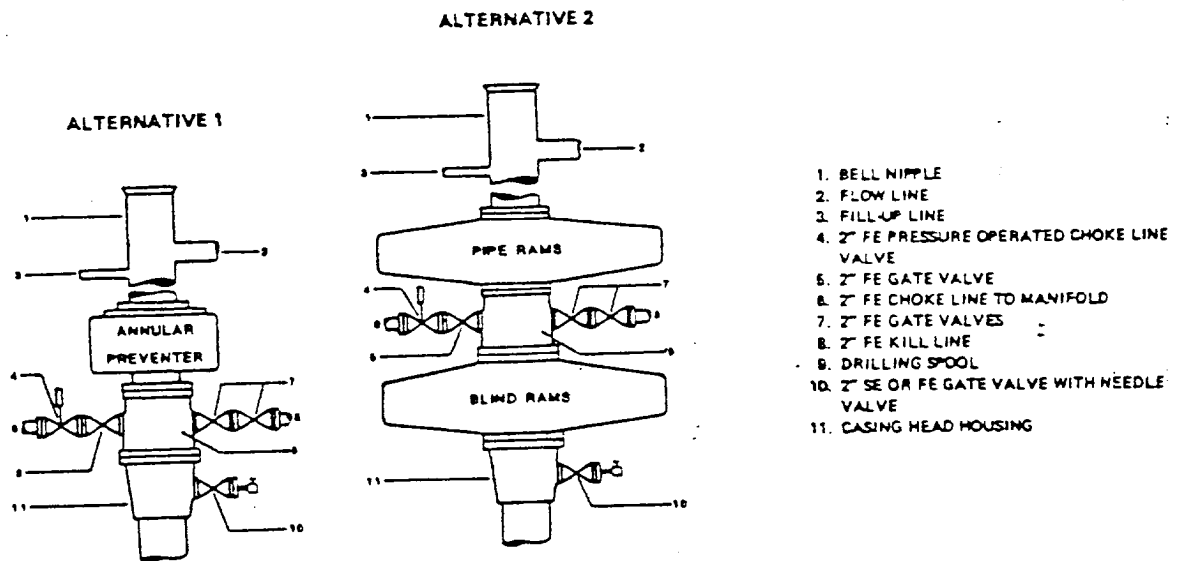

NOTE: THE DRILLING SPOOL MAY BE LOCATED BELOW BOTH SETS OF RAMS IF A DOUBLE PREVENTER IS USED AND IT DOES NOT HAVE SUITABLE OUTLETS BETWEEN RAMS

Figure 7-9. Standard Hydraulic Blowout Preventer Assembly (2 M or 3 M Working Pressure) Alternative 1

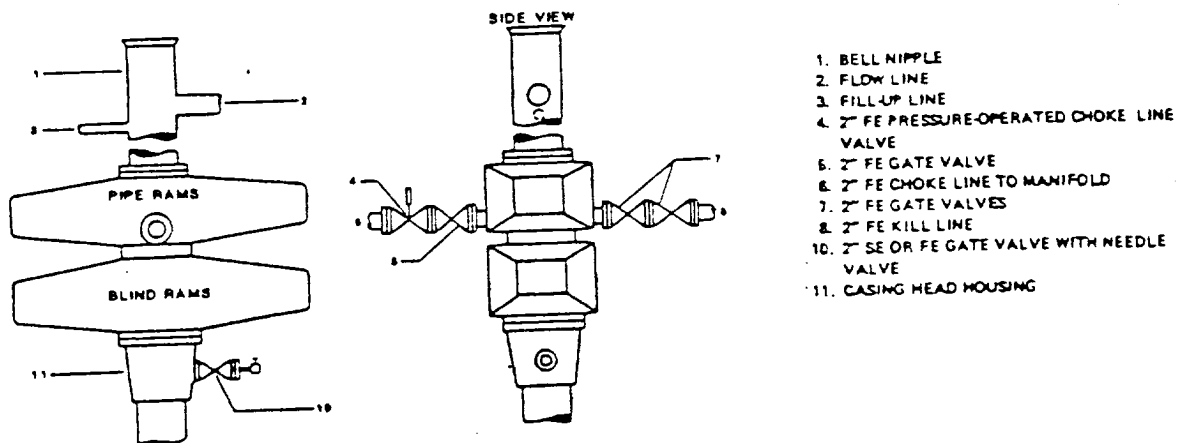

Figure 7-10. Standard Hydraulic Blowout Preventer Assembly (2 M or 3 M Working Pressure) Alternative 3 (without Drilling Spool)

NEW MEXICO OIL CONSERVATION COMMISSION
WELL LOCATION AND ACREAGE DEDICATION PLAT

Form C-102
Supersedes C-128
Effective 1-1-65

All distances must be from the outer boundaries of the Section

Operator PHILLIPS PETROLEUM CO.			Lease PHILLIPS "E" STATE		Well No. 34
Plot Letter P	Section 9	Township 17 SOUTH	Range 33 EAST	County LEA	
Actual Well Location of Well:					
760	feet from the	SOUTH	line and	720	feet from the
					EAST
Shallow Elev. 4179.4	Producing Formation Grayburg/San Andres		Pool Maljamar		Dedicated Acreage 40

- Outline the acreage dedicated to the subject well by colored pencil or hachure marks on the plat below.
- If more than one lease is dedicated to the well, outline each and identify the ownership thereof (both as to working interest and royalty).
- If more than one lease of different ownership is dedicated to the well, have the interests of all owners been consolidated by communitization, unitization, force-pooling, etc?

☐ Yes ☐ No If answer is "yes," type of consolidation _____

If answer is "no," list the owners and tract descriptions which have actually been consolidated. (Use reverse side of this form if necessary.) _____

No allowable will be assigned to the well until all interests have been consolidated (by communitization, unitization, forced-pooling, or otherwise) or until a non-standard unit, eliminating such interests, has been approved by the Commission.

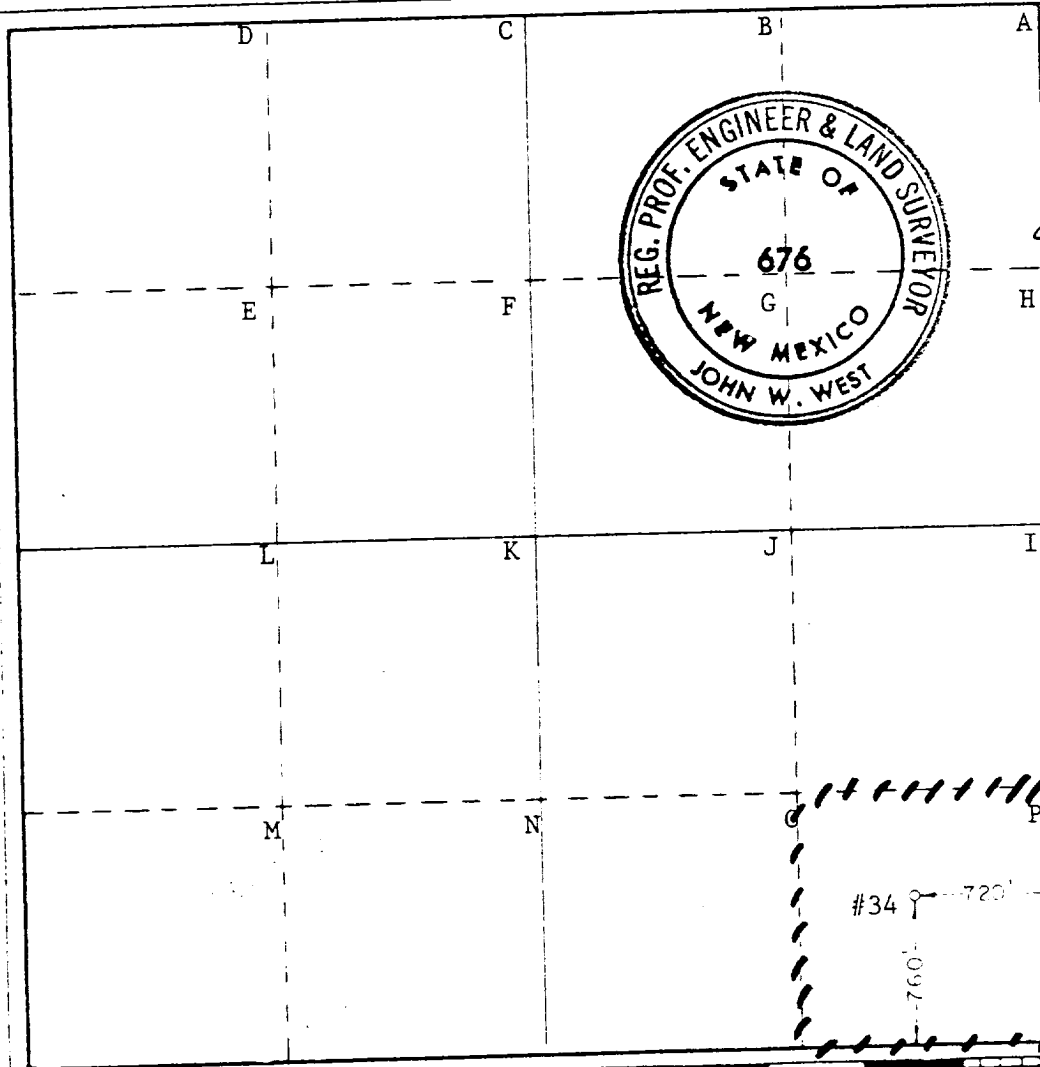

CERTIFICATION

I hereby certify that the information contained herein is true and complete to the best of my knowledge and belief

[Signature]
W. J. Mueller
Senior Engineering Specialist

Position
Phillips Petroleum Company
Date
October 19, 1983

I hereby certify that the well location shown on this plat was plotted from field notes of actual surveys made by me or under my supervision, and that the same is true and correct to the best of my knowledge and belief.

Date Surveyed
OCTOBER 13, 1983

Registered Professional Engineer and Land Surveyor

[Signature]

Certificate No. **JOHN W. WEST** 676
RONALD J. EIDSON 3239

RECEIVED
OCT 21 1983
O.C.D.
HOBBS OFFICE

