

NO. OF COPIES RECEIVED		
DISTRIBUTION		
ANTA FE		
FILE		
U.S.G.S.		
LAND OFFICE		
OPERATOR		

# NEW MEXICO OIL CONSERVATION COMMISSION

Form C-101  
Revised 1-1-65

5A. Indicate Type of Lease  
STATE ☒ FEE ☐

5. State Oil & Gas Lease No.  
**V-603**

## APPLICATION FOR PERMIT TO DRILL, DEEPEN, OR PLUG BACK

1a. Type of Work		7. Unit Agreement Name	
b. Type of Well DRILL <input checked="" type="checkbox"/> DEEPEN <input type="checkbox"/> PLUG BACK <input type="checkbox"/> OIL WELL <input checked="" type="checkbox"/> GAS WELL <input type="checkbox"/> OTHER <input type="checkbox"/> SINGLE ZONE <input type="checkbox"/> MULTIPLE ZONE <input type="checkbox"/>		8. Farm or Lease Name <b>Monsanto 30 State</b>	
2. Name of Operator <b>Tipperary Oil &amp; Gas Corporation</b>		9. Well No. <b>1</b>	
3. Address of Operator <b>P. O. Box 3179, Midland, Texas 79702</b>		10. Field and Pool, or Wildcat <b>Wildcat</b>	
4. Location of Well UNIT LETTER <b>0</b> LOCATED <b>660</b> FEET FROM THE <b>South</b> LINE AND <b>1980</b> FEET FROM THE <b>East</b> LINE OF SEC. <b>30</b> TWP. <b>16 S</b> RGE. <b>37 E</b> NMPM		12. County <b>Lea</b>	
21. Elevations (Show whether DF, RT, etc.) <b>3835' (GL)</b>		19. Proposed Depth <b>11,250'</b>	19A. Formation <b>Atoka</b>
21A. Kind & Status Plug. Bond <b>Blanket</b>	21B. Drilling Contractor <b>Unknown</b>	20. Rotary or C.T. <b>Rotary</b>	
		22. Approx. Date Work will start <b>6-15-84</b>	

## PROPOSED CASING AND CEMENT PROGRAM

SIZE OF HOLE	SIZE OF CASING	WEIGHT PER FOOT	SETTING DEPTH	SACKS OF CEMENT	EST. TOP
17-1/2"	13-3/8"	48#	400'	350	Circ
11"	8-5/8"	24# & 32#	4200'	1100	Circ
7 7/8"	5 1/2"	17#	11,250'	540	8750'

Double Hydraulic 10", 5000# & Hydril 5000# annular preventers with accumulator.  
Closing unit on ground and floor.

Note: Strawn oil is primary objective. Well will be drilled to sufficient depth to test the Atoka.

APPROVAL VALID FOR 180 DAYS  
PERMIT EXPIRES 12/31/84  
UNLESS DRILLING UNDERWAY

IN ABOVE SPACE DESCRIBE PROPOSED PROGRAM: IF PROPOSAL IS TO DEEPEN OR PLUG BACK, GIVE DATA ON PRESENT PRODUCTIVE ZONE AND PROPOSED NEW PRODUCTIVE ZONE. GIVE BLOWOUT PREVENTER PROGRAM, IF ANY.

I hereby certify that the information above is true and complete to the best of my knowledge and belief.

Signed Joe W. Younger Title Production Operations Mgr. Date June 5, 1984

(This space for State Use)

APPROVED BY [Signature] TITLE  DATE JUN 8 1984

CONDITIONS OF APPROVAL, IF ANY:

A Strawn completion will require a revised Form C-102 outlining an 80 acre proration unit.

NEW MEXICO OIL CONSERVATION COMMISSION  
WELL LOCATION AND ACREAGE DEDICATION PLAT

Form C-102  
Supersedes C-128  
Effective 1-1-65

All distances must be from the outer boundaries of the Section.

Operator <b>TIPPERARY OIL &amp; GAS CORPORATION</b>			Lease <b>MONSANTO 30 STATE</b>		Well No. <b>1</b>
Unit Letter <b>0</b>	Section <b>30</b>	Township <b>16 SOUTH</b>	Range <b>37 EAST</b>	County <b>LEA</b>	
Actual Footage Location of Well: <b>660</b> feet from the <b>SOUTH</b> line and <b>1980</b> feet from the <b>EAST</b> line					
Ground Level Elev. <b>3835.0</b>	Producing Formation <b>ATOKA</b>		Pool <b>WILDCAT</b>		Dedicated Acreage: <b>40</b> Acres

1. Outline the acreage dedicated to the subject well by colored pencil or hachure marks on the plat below.
2. If more than one lease is dedicated to the well, outline each and identify the ownership thereof (both as to working interest and royalty). *N/A*
3. If more than one lease of different ownership is dedicated to the well, have the interests of all owners been consolidated by communitization, unitization, force-pooling, etc?

☐ Yes ☐ No If answer is "yes," type of consolidation \_\_\_\_\_

If answer is "no," list the owners and tract descriptions which have actually been consolidated. (Use reverse side of this form if necessary.) \_\_\_\_\_

No allowable will be assigned to the well until all interests have been consolidated (by communitization, unitization, forced-pooling, or otherwise) or until a non-standard unit, eliminating such interests, has been approved by the Commission.

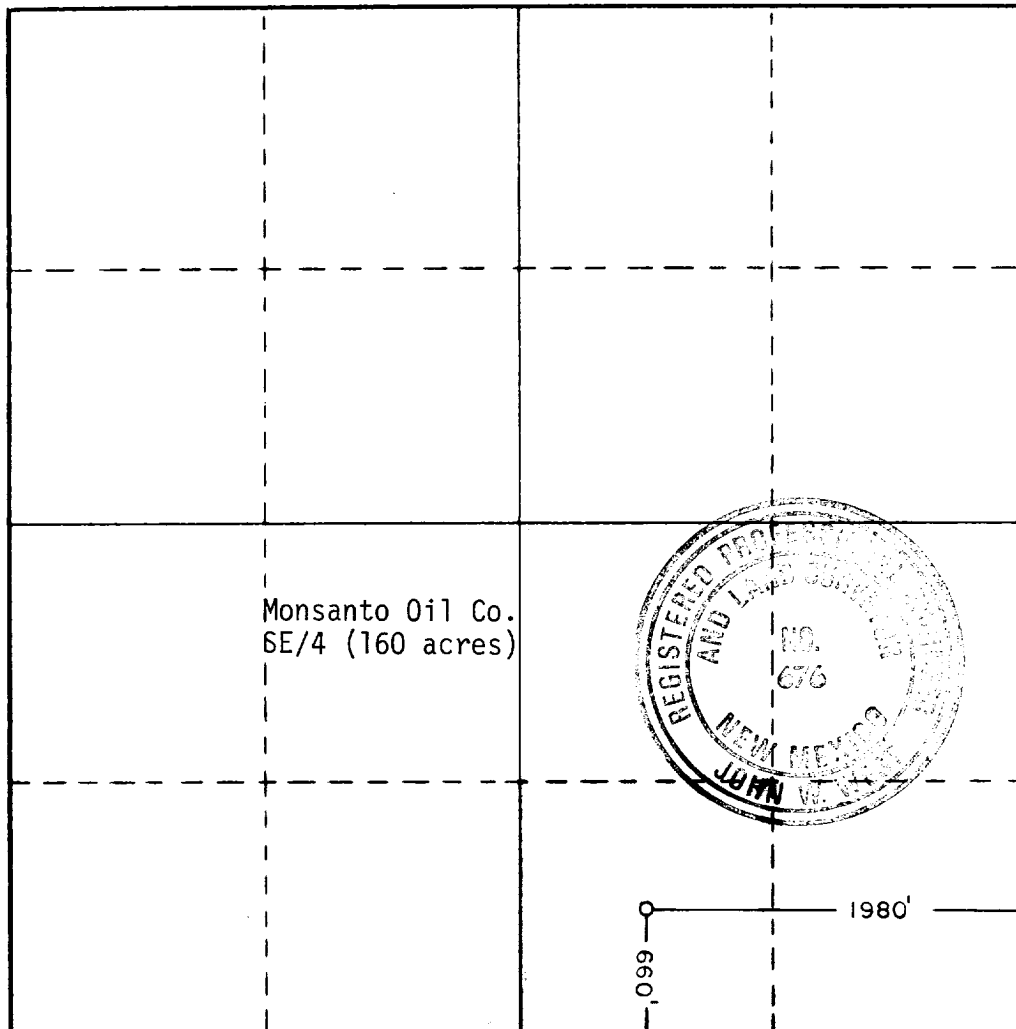

CERTIFICATION

I hereby certify that the information contained herein is true and complete to the best of my knowledge and belief.

*Joe W. Younger*  
Name

Joe W. Younger

Position

Production Operations Mgr.

Company

Tipperary O & G Corporation

Date

June 5, 1984

I hereby certify that the well location shown on this plat was plotted from field notes of actual surveys made by me or under my supervision, and that the same is true and correct to the best of my knowledge and belief.

Date Surveyed

MAY 30, 1984

Registered Professional Engineer and/or Land Surveyor

*John W. West*

Certificate No. JOHN W. WEST, 676

RONALD J. EIDSON, 3239

RECEIVED

JUN 6 1984

O.C.D.  
HOBBS OFFICE

FILE