

30-045-18845

NO. OF COPIES RECEIVED	
DISTRIBUTION	
SANTA FE	
FILE	
U.S.G.S.	
LAND OFFICE	
OPERATOR	

NEW MEXICO OIL CONSERVATION COMMISSION

Form C-101
Revised 1-1-65

5A. Indicate Type of Lease	
STATE <input type="checkbox"/>	FEE <input checked="" type="checkbox"/>

5. State Oil & Gas Lease No.

APPLICATION FOR PERMIT TO DRILL, DEEPEN, OR PLUG BACK

1a. Type of Work		7. Unit Agreement Name	
b. Type of Well OIL WELL <input checked="" type="checkbox"/> GAS WELL <input type="checkbox"/> OTHER <input type="checkbox"/>		8. Farm or Lease Name Lovington Lumpkin "20"	
2. Name of Operator Getty Oil Company		9. Well No. 1-Y	
3. Address of Operator P. O. Drawer DD, Levelland, Texas 79336		10. Field and Pool, or Wildcat NE Lovington Penn	
4. Location of Well UNIT LETTER <u>I</u> LOCATED <u>1980</u> FEET FROM THE <u>South</u> LINE AND <u>660</u> FEET FROM THE <u>East</u> LINE OF SEC. <u>20</u> TWP. <u>16S</u> RGE. <u>37E</u> NMPM		12. County Lea	
19. Proposed Depth 11,600		19A. Formation Strawn	20. Rotary or C.T. Rotary
21. Elevations (Show whether DF, RT, etc.) 3808.1	21A. Kind & Status Plug. Bond Blanket	21B. Drilling Contractor Basin Drilling Co.	22. Approx. Date Work will start September 2, 1984

23. PROPOSED CASING AND CEMENT PROGRAM

SIZE OF HOLE	SIZE OF CASING	WEIGHT PER FOOT	SETTING DEPTH	SACKS OF CEMENT	EST. TOP
17 1/2"	13 3/8"	48#	450'	475	Surface
11"	8 5/8"	24 and 28#	4500'	2100	Surface
7 7/8"	5 1/2"	17 and 20#	11,600'	*	Surface

*Volume to be determined by open hole volume caliper.

APPROVAL VALID FOR 180 DAY
PERMIT EXPIRES 3/14/85
UNLESS DRILLING UNDERWAY

IN ABOVE SPACE DESCRIBE PROPOSED PROGRAM: IF PROPOSAL IS TO DEEPEN OR PLUG BACK, GIVE DATA ON PRESENT PRODUCTIVE ZONE AND PROPOSED NEW PRODUCTIVE ZONE. GIVE BLOWOUT PREVENTER PROGRAM, IF ANY.

I hereby certify that the information above is true and complete to the best of my knowledge and belief.

Signed Dean F. Jarrett Title Operations Engineer Date 8/31/84
(This space for State Use)

ORIGINAL SIGNED BY JERRY SEXTON

APPROVED BY DISTRICT SUPERVISOR TITLE DATE 1984

CONDITIONS OF APPROVAL, IF ANY:

RECEIVED

AUG 31 1984

POB 11-15

**MEXICO OIL CONSERVATION COMMISSION
WELL LOCATION AND ACREAGE DEDICATION PLAT**

Form C-102
Supersedes C-128
Effective 1-1-65

All distances must be from the outer boundaries of the Section

Operator GETTY OIL COMPANY			Lease LOVINGTON LUMPKIN 20		Well No. 1Y
Unit Letter I	Section 20	Township 16 SOUTH	Range 37 EAST	County LEA	
Actual Footage Location of Well: 1980 feet from the SOUTH line and 660 feet from the EAST line					
Ground Level Elev. 3807.1'	Producing Formation STRAWN		Pool LOVINGTON NE PENN		Dedicated Acreage: 80 Acres

1. Outline the acreage dedicated to the subject well by colored pencil or hachure marks on the plat below.
2. If more than one lease is dedicated to the well, outline each and identify the ownership thereof (both as to working interest and royalty).
3. If more than one lease of different ownership is dedicated to the well, have the interests of all owners been consolidated by communitization, unitization, force-pooling, etc?

☐ Yes ☐ No If answer is "yes," type of consolidation _____

If answer is "no," list the owners and tract descriptions which have actually been consolidated. (Use reverse side of this form if necessary.) _____

No allowable will be assigned to the well until all interests have been consolidated (by communitization, unitization, forced-pooling, or otherwise) or until a non-standard unit, eliminating such interests, has been approved by the Commission.

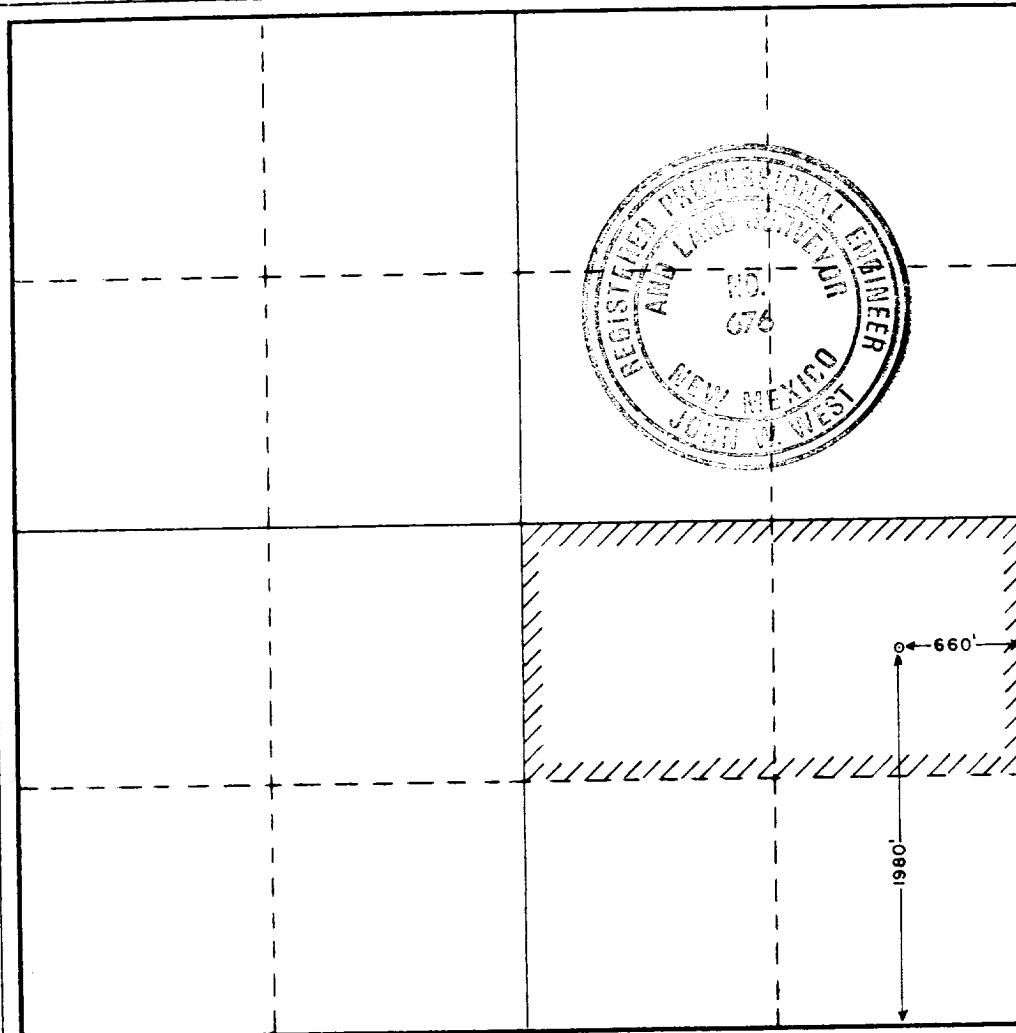

CERTIFICATION

I hereby certify that the information contained herein is true and complete to the best of my knowledge and belief.

Name
JOHN W. WEST
Position
AGENT

Company
GETTY OIL COMPANY

Date
AUGUST 31, 1984

I hereby certify that the well location shown on this plat was plotted from field notes of actual surveys made by me or under my supervision, and that the same is true and correct to the best of my knowledge and belief.

Date Surveyed
AUGUST 31, 1984

Registered Professional Engineer and/or Land Surveyor

Certificate No. **JOHN W. WEST, 676**
RONALD J. EIDSON, 3239

0 330 660 990 1320 1650 1980 2310 2640 2000 1800 1000 800

RECEIVED

SEP 4 1984

U.S. DEPT. OF JUSTICE
FEDERAL BUREAU OF INVESTIGATION

SEP 4 1984
FBI
RECEIVED