

All distances must be from the outer boundaries of the Section.

Operator Yates Petroleum Corporation			Lease Lea VP State			Well No. 1		
Unit Letter C	Section 32	Township 15S	Range 33E	County Lea				
Actual Footage Location of Well: 660 feet from the North line and 1980 feet from the West line								
Ground Level Elev. 4203.5'	Producing Formation Permo Penn		Pool South Sanders Permo Penn			Dedicated Acreage: 40 Acres		

1. Outline the acreage dedicated to the subject well by colored pencil or hatchure marks on the plat below.
2. If more than one lease is dedicated to the well, outline each and identify the ownership thereof (both as to working interest and royalty).
3. If more than one lease of different ownership is dedicated to the well, have the interests of all owners been consolidated by communitization, unitization, force-pooling, etc?

☐ Yes ☐ No If answer is "yes," type of consolidation \_\_\_\_\_

If answer is "no," list the owners and tract descriptions which have actually been consolidated. (Use reverse side of this form if necessary.) \_\_\_\_\_

No allowable will be assigned to the well until all interests have been consolidated (by communitization, unitization, forced-pooling, or otherwise) or until a non-standard unit, eliminating such interests, has been approved by the Division.

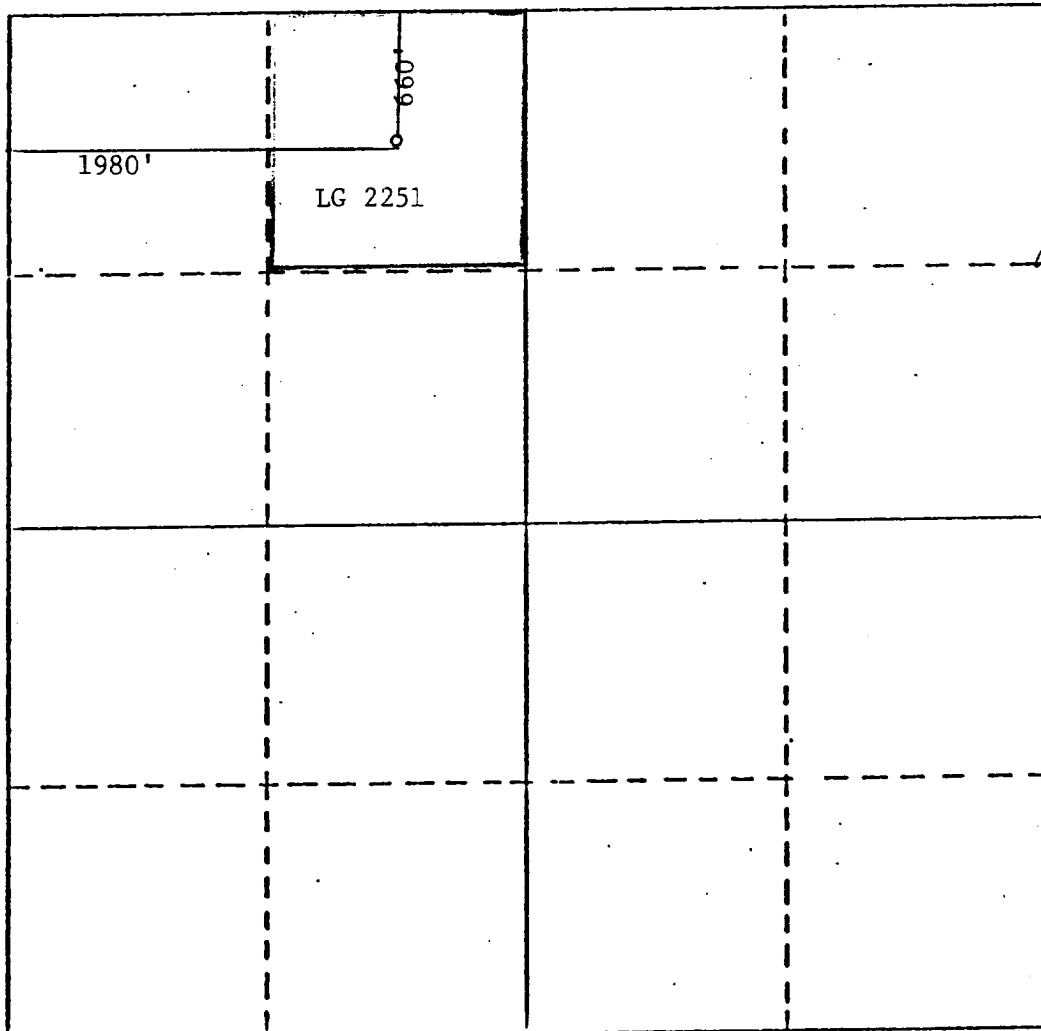

CERTIFICATION

I hereby certify that the information contained herein is true and complete to the best of my knowledge and belief.

Name

Juanita Goodlett

Position

Production Supervisor

Company

Yates Petroleum Corporation

Date

January 23, 1985

I hereby certify that the well location shown on this plat was plotted from field notes of actual surveys made by me or under my supervision, and that the same is true and correct to the best of my knowledge and belief.

Refer to original plat

Date Surveyed dated 9-18-84

Registered Professional Engineer and/or Land Surveyor

Certificate No.