

OIL CONSERVATION DIVISION

STATE OF NEW MEXICO

P. O. BOX 2088

Form C-102
Revised 10-1-78

ENERGY AND MINERALS DEPARTMENT

SANTA FE, NEW MEXICO 87501

All distances must be from the outer boundaries of the Section.

Operator CLEMENTS ENERGY, INC.			Lease NEW NM STATE "8" State		Well No. #1
Unit Letter G	Section 8	Township T-15-S	Range R-34-E	County LEA	
Actual Postage Location of Well:					
1980 feet from the NORTH		line and	1980 feet from the EAST		line
Ground Level Elev. 4117	Producing Formation Terre-Penre	Pool Tres-Papalotes-Penre	Dedicated Acreage: 160 Acres		

1. Outline the acreage dedicated to the subject well by colored pencil or hachure marks on the plat below.
2. If more than one lease is dedicated to the well, outline each and identify the ownership thereof (both as to working interest and royalty).
3. If more than one lease of different ownership is dedicated to the well, have the interests of all owners been consolidated by communization, unitization, force-pooling, etc?

☐ Yes ☐ No If answer is "yes," type of consolidation _____

If answer is "no," list the owners and tract descriptions which have actually been consolidated. (Use reverse side of this form if necessary.) _____

No allowable will be assigned to the well until all interests have been consolidated (by communization, unitization, forced-pooling, or otherwise) or until a non-standard unit, eliminating such interests, has been approved by the Division.

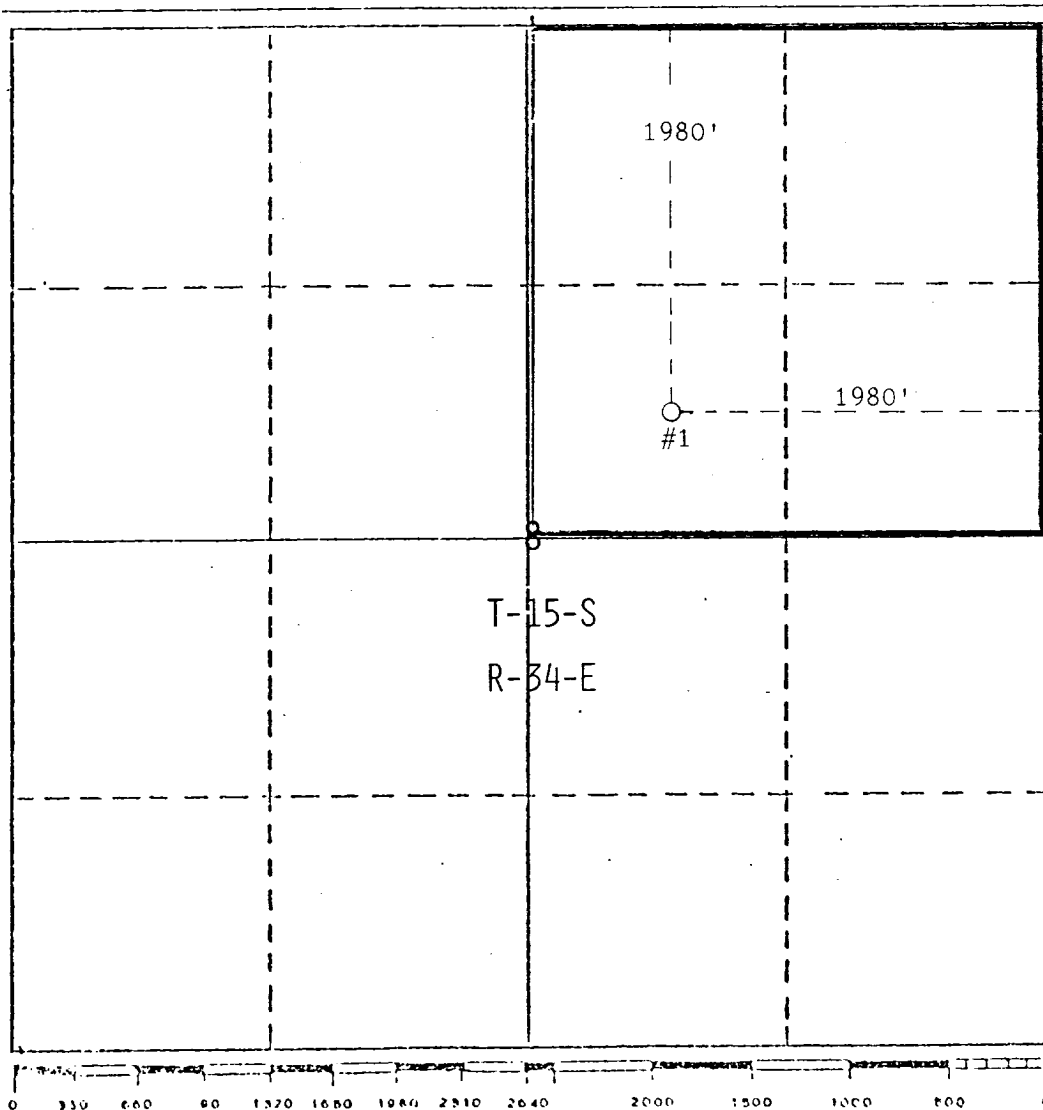

CERTIFICATION

I hereby certify that the information contained herein is true and complete to the best of my knowledge and belief.

Ann. Murray
Name
Agent for Clements Energy
Position

Company
Clements Energy, Inc.
Date
6-11-85

REGISTERED PROFESSIONAL ENGINEER
AND LAND SURVEYOR
I have verified the well location
and this plat was collected from field
notes of 1980-85 made by me or
under my supervision, and that the same
is true and correct to the best of my
knowledge and belief.
D. WATSON

JUNE 11, 1985

Date Surveyed
[Signature]
Registered Professional Engineer
and/or Land Surveyor

3959

Certificate No.

RECEIVED

JUN 11 1985

O.C.D.
HOBBS OFFICE