

-30-025-29380

STATE OF NEW MEXICO
ENERGY AND MINERALS DEPARTMENT

OIL CONSERVATION DIVISION
P. O. BOX 2088
SANTA FE, NEW MEXICO 87501

Form C-101
Revised 10-1-78

NO. OF COPIES RECEIVED	
DISTRIBUTION	
SANTA FE	
FILE	
U.S.G.S.	
LAND OFFICE	
OPERATOR	

5A. Indicate Type of Lease
STATE ☐ FEE ☒

5. State Oil & Gas Lease No.

APPLICATION FOR PERMIT TO DRILL, DEEPEN, OR PLUG BACK

1a. Type of Work b. Type of Well OIL WELL <input checked="" type="checkbox"/> GAS WELL <input type="checkbox"/> OTHER <input type="checkbox"/> DRILL <input checked="" type="checkbox"/> DEEPEN <input type="checkbox"/> PLUG BACK <input type="checkbox"/> SINGLE ZONE <input type="checkbox"/> MULTIPLE ZONE <input type="checkbox"/>		7. Unit Agreement Name
2. Name of Operator Citation Oil & Gas Corp.		8. Farm or Lease Name Alexander
3. Address of Operator 16800 Greenspoint Park Drive, Suite 300 South Atrium, Hou., TX 77060		9. Well No.
4. Location of Well UNIT LETTER <u>L</u> LOCATED <u>1980</u> FEET FROM THE <u>South</u> LINE AND <u>660</u> FEET FROM THE <u>West</u> LINE OF SEC. <u>29</u> TWP. <u>15S</u> RGE. <u>36E</u> NMPM		10. Field and Pool, or Wildcat UNDESIGNATED <u>Revised 10/1/78</u> <u>Lea</u>
21. Elevations (Show whether DF, RT, etc.) 3911.5 G.L.		12. County Lea
21A. Kind & Status Plug. Bond \$50,000 Blanket/Current		19. Proposed Depth 10,900'
21B. Drilling Contractor Willbros Drilling		19A. Formation Townsend/Three Bros.
22. Approx. Date Work will start Sept. 1		20. Rotary or C.T. Rotary

PROPOSED CASING AND CEMENT PROGRAM

SIZE OF HOLE	SIZE OF CASING	WEIGHT PER FOOT	SETTING DEPTH	SACKS OF CEMENT	EST. TOP
17-1/2"	13-3/8"	48# H-40	450'	430 sx	surface
12-1/4"	8-5/8"	36# K-55	4750'	1370 + 200 sx	surface
7-7/8"	5-1/2"	17# N-80	10,800'	426 sx	8800'

1. Drill 17-1/2" hole and set 13-3/8" surface csg. to 450' with good returns
2. Drill 12-1/4" hole and set 8-5/8" intermediate csg. to 4750' with good returns.
3. Log BOP checks in daily drill reports and drill 7-7/8" hole to 10,900'.
4. Run tests if warranted and run 5-1/2" csg. if productive.
5. Run logs, as needed, and perforate and stimulate as needed.

Attached: Location Plat

B.O.P. Information: 11" 5000" W.P. Schaeffer Type E Db1 Rams.

Permit Expires 6 Months From Approval
Date Unless Drilling Underway.

IN ABOVE SPACE DESCRIBE PROPOSED PROGRAM: IF PROPOSAL IS TO DEEPEN OR PLUG BACK, GIVE DATA ON PRESENT PRODUCTIVE ZONE AND PROPOSED NEW PRODUCTIVE ZONE. GIVE BLOWOUT PREVENTER PROGRAM, IF ANY.

I hereby certify that the information above is true and complete to the best of my knowledge and belief.

Signed Gerale Jaurio Title Prod. Coordinator Date 8/22/85

(This space for State Use)

ORIGINAL SIGNED BY JERRY SEXTON

APPROVED BY DISTRICT 1 SUPERVISOR TITLE DATE AUG 26 1985

CONDITIONS OF APPROVAL, IF ANY:

RECEIVED

AUG 23 1985

O. C. C.
HOBBS OFFICE

OIL CONSERVATION DIVISION

STATE OF NEW MEXICO
ENERGY AND MINERALS DEPARTMENTP. O. BOX 2088
SANTA FE, NEW MEXICO 87501Form C-102
Revised 10-1-78

All distances must be from the outer boundaries of the Section.

Operator Citation Oil & Gas Corporation		Lease Alexander		Well No. 1	
Unit Letter L	Section 29	Township 15S	Range 36E	County Lea	
Actual Footage Location of Well:					
1980 feet from the South line and		660 feet from the West line			
Ground Level Elev. 3911.5 Gr.	Producing Formation Three Brothers/Townsend	Pool UNDESIGNATED		Dedicated Acreage: 40 Acres	

1. Outline the acreage dedicated to the subject well by colored pencil or hachure marks on the plat below.
2. If more than one lease is dedicated to the well, outline each and identify the ownership thereof (both as to working interest and royalty).
N/A
3. If more than one lease of different ownership is dedicated to the well, have the interests of all owners been consolidated by communitization, unitization, force-pooling, etc?
N/A

☐ Yes ☐ No If answer is "yes," type of consolidation _____

If answer is "no," list the owners and tract descriptions which have actually been consolidated. (Use reverse side of this form if necessary.) _____

No allowable will be assigned to the well until all interests have been consolidated (by communitization, unitization, forced-pooling, or otherwise) or until a non-standard unit, eliminating such interests, has been approved by the Division.

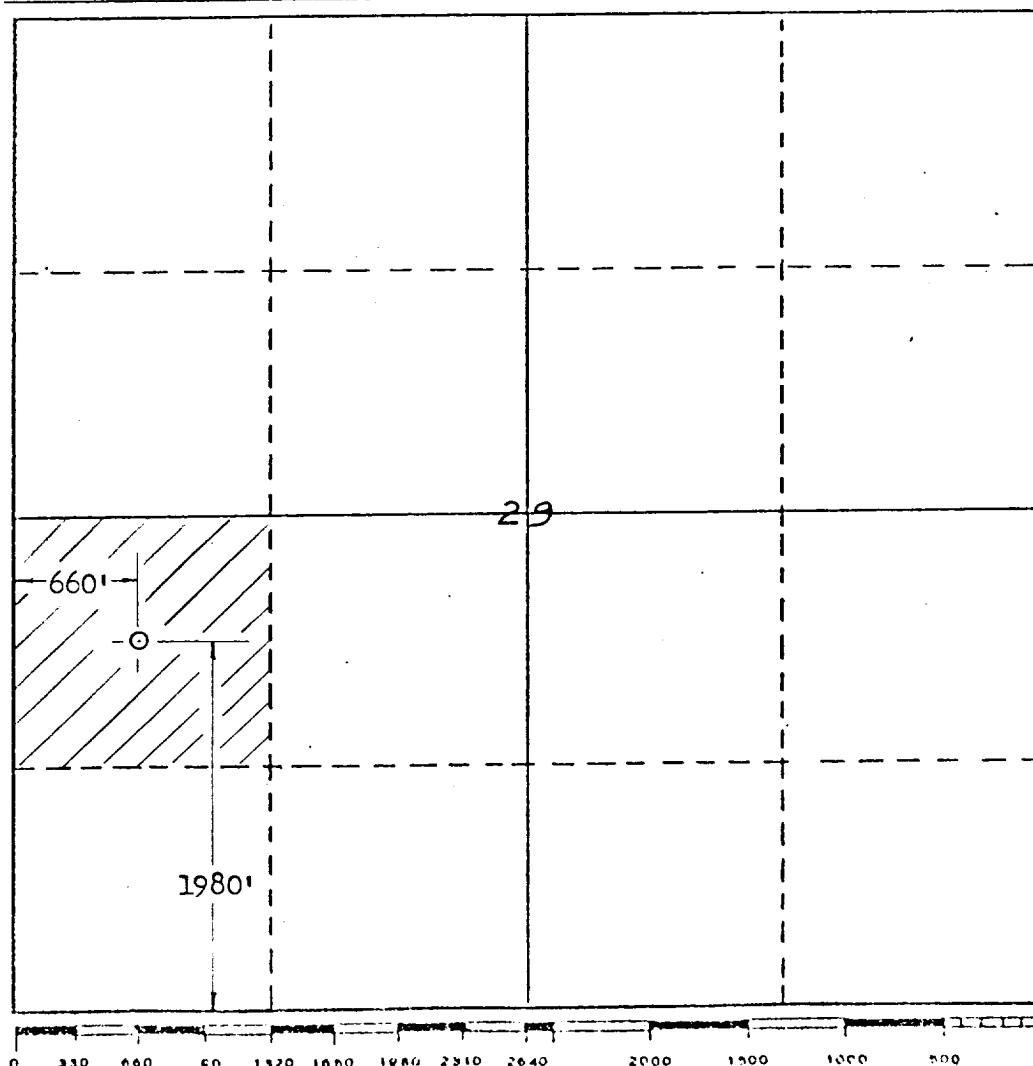

CERTIFICATION

I hereby certify that the information contained herein is true and complete to the best of my knowledge and belief.

Carole Favro
Name
Carole Favro
Position
Production Coordinator
Company
Citation Oil & Gas Corp.

Date
August 22, 1985

ROY A. RUSH
NEW MEXICO
8894
I hereby certify that the well location shown on this plat was plotted from field notes of actual surveys made by me or under my supervision, and that the same is true and correct to the best of my knowledge and belief.
PROFESSOR OF LAND SURVEYING

Date Surveyed
Roy A. Rush
Registered Professional Engineer
and/or Land Surveyor

Certificate No. _____

RECEIVED

AUG 23 1985

U.S. DEPT. OF JUSTICE
HOBBS OFFICE