

STATE OF NEW MEXICO  
ENERGY AND MINERALS DEPARTMENT

OIL CONSERVATION DIVISION

P. O. BOX 2088

SANTA FE, NEW MEXICO 87501

Form C-101  
Revised 10-1-78

NO. OF COPIES RECEIVED	
DISTRIBUTION	
SANTA FE	
FILE	
U.S.G.S.	
LAND OFFICE	
OPERATOR	

5A. Indicate Type of Lease  
STATE ☒ FEDERAL ☐

5. State Oil & Gas Lease No.  
V-1026

APPLICATION FOR PERMIT TO DRILL, DEEPEN, OR PLUG BACK

1a. Type of Work b. Type of Well OIL WELL <input checked="" type="checkbox"/> GAS WELL <input type="checkbox"/> OTHER <input type="checkbox"/> SINGLE ZONE <input type="checkbox"/> MULTIPLE ZONE <input type="checkbox"/>		2. Name of Operator Yates Petroleum Corporation		7. Unit Agreement Name	
3. Address of Operator 207 South Fourth Street - Artesia, NM 88210		8. Farm or Lease Name Silverball "ADT" State		9. Well No. 1	
4. Location of Well UNIT LETTER K LOCATED 1980 FEET FROM THE South LINE AND 2310 FEET FROM THE West LINE OF SEC. 30 TWP. 14S RGE. 37E NMPM		10. Field and Pool, or Wildcat Wildcat		12. County Lea	
19. Proposed Depth 11200'		19A. Formation Permo Penn		20. Rotary or C.T. Rotary	
21. Elevations (show whether DEPT, etc.) 3877.6' GR		21A. Kind & Status Plug. Bond Blanket		22. Approx. Date Work will start ASAP	

PROPOSED CASING AND CEMENT PROGRAM

SIZE OF HOLE	SIZE OF CASING	WEIGHT PER FOOT	SETTING DEPTH	SACKS OF CEMENT	EST. TOP
17-1/2"	13-3/8"	54.5# K-55	Approx. 450'	400 sacks	Circulate
12-1/4"	8-5/8"	32# J-55	4800'	1800 sacks	Circulate
7-7/8"	5-1/2"	17# N-80 & S-95	TD	450 sacks	

We propose to drill and test the Permo Penn and intermediate formations. Approximately 450' of surface casing will be set and cement circulated to shut off gravel and cavings. Approx. 4800' of intermediate casing will be set with cement circulated. If commercial, production casing will be run and cemented with adequate cover, perforated and stimulated as needed for production.

MUD PROGRAM: FW Gel/LCM from surface to 450', fresh water to 4800', SW Gel/Starch to TD

BOP PROGRAM: BOP's will be installed at the offset and tested daily.

Permit Expires 6 Months From Approval  
Date Unless Drilling Underway.

IN ABOVE SPACE DESCRIBE PROPOSED PROGRAM; IF PROPOSAL IS TO DEEPEN OR PLUG BACK, GIVE DATA ON PRESENT PRODUCTIVE ZONE AND PROPOSED NEW PRODUCTIVE ZONE. GIVE BLOWOUT PREVENTER PROGRAM, IF ANY.

I hereby certify that the information above is true and complete to the best of my knowledge and belief.

Signed Clifton R. May Title Regulatory Agent Date Jan. 21, 1986

(This space for State Use)

Eddie W. Seay

APPROVED BY Oil & Gas Inspector TITLE Oil & Gas Inspector DATE JAN 27 1986

CONDITIONS OF APPROVAL, IF ANY:

RECEIVED

JAN 24 1986

O.C.D.  
HOBBS OFFICE

All distances must be from the outer boundaries of the Section.

Operator <b>Yates Petroleum Corporation</b>			Lease <b>Silver Ball "ADT" State #1</b>		Well No.
Unit Letter <b>"K"</b>	Section <b>30</b>	Township <b>14S.</b>	Range <b>37E.</b>	County <b>Lea</b>	
Actual Footage Location of Well: <b>1980</b> feet from the <b>South</b> line and <b>2310</b> feet from the <b>West</b> line					
Ground Level Elev. <b>3877.6</b>	Producing Formation <b>PERMO PENN</b>		Pool <b>WILDCAT</b>	Dedicated Acreage: <b>40</b> Acres	

1. Outline the acreage dedicated to the subject well by colored pencil or hatchure marks on the plat below.
2. If more than one lease is dedicated to the well, outline each and identify the ownership thereof (both as to working interest and royalty).
3. If more than one lease of different ownership is dedicated to the well, have the interests of all owners been consolidated by communitization, unitization, force-pooling, etc?

☐ Yes ☐ No If answer is "yes," type of consolidation \_\_\_\_\_

If answer is "no," list the owners and tract descriptions which have actually been consolidated. (Use reverse side of this form if necessary.) \_\_\_\_\_

No allowable will be assigned to the well until all interests have been consolidated (by communitization, unitization, forced-pooling, or otherwise) or until a non-standard unit, eliminating such interests, has been approved by the Division.

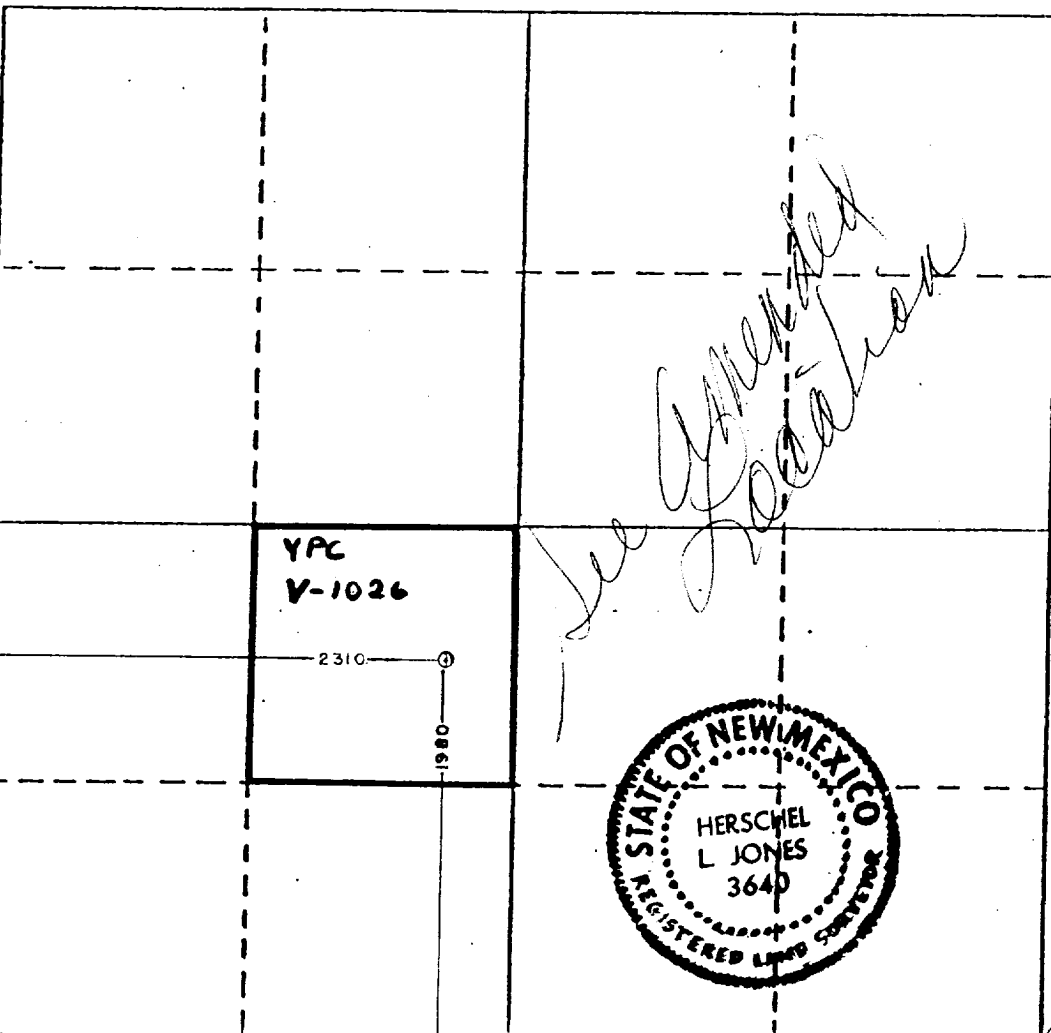

#### CERTIFICATION

I hereby certify that the information contained herein is true and complete to the best of my knowledge and belief.

**Clifton R. May**  
Name

Clifton R. May

Position

Regulatory Agent

Company

Yates Petroleum Corporation

Date

January 21, 1986

I hereby certify that the well location shown on this plat was plotted from field notes of actual surveys made by me or under my supervision, and that the same is true and correct to the best of my knowledge and belief.

Date Surveyed

Jan. 13, 1985

Registered Professional Engineer and/or Land Surveyor

Certificate No.

3640

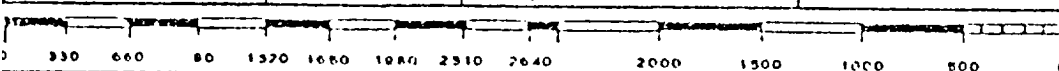

RECEIVED

JAN 24 1986

C.C.D.  
HOBBY OFFICE

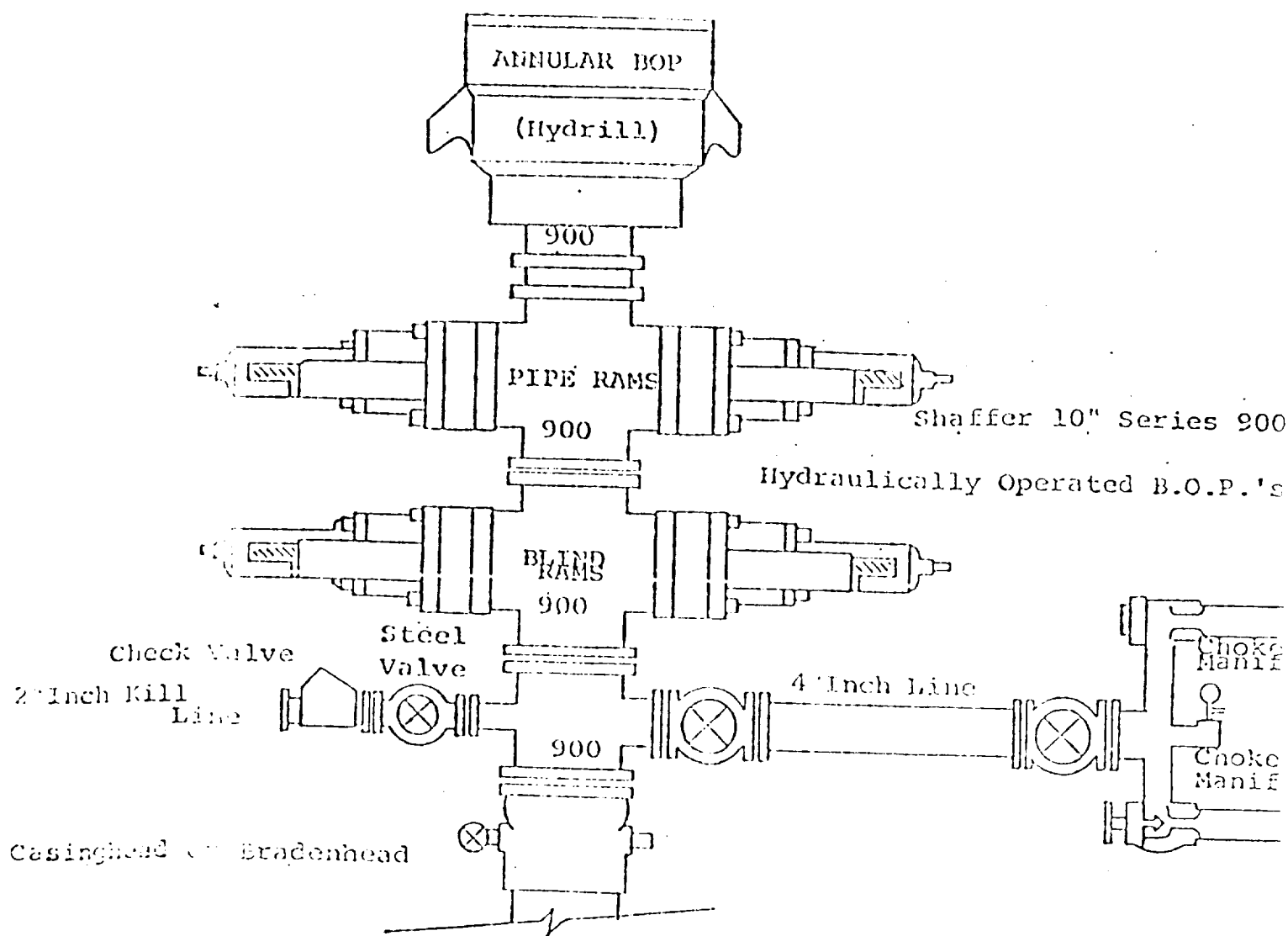

THE FOLLOWING CONSTITUTE MINIMUM BLOWOUT PREVENTER REQUIREMENTS

1. All preventers to be hydraulically operated with secondary manual control installed prior to drilling out from under casing.
2. Choke outlet to be a minimum of 4" diameter.
3. Kill line to be of all steel construction of 2" minimum diameter.
4. All connections from operating manifolds to preventers to be all steel, hole or tube a minimum of one inch in diameter.
5. The available closing pressure shall be at least 15% in excess of that required with sufficient volume to operate the B.O.P.'s.
6. All connections to and from preventer to have a pressure rating equivalent to that of the B.O.P.'s.
7. Inside blowout preventer to be available on rig floor.
8. Operating controls located a safe distance from the rig floor.
9. Hole must be kept filled on trips below intermediate casing.
10. D. P. float must be installed and used below zone of first gas intrusion.

78-52-8 7m  
but 8-24-86  
78-52-8 7m

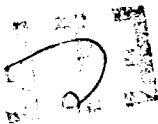

RECEIVED

JAN 24 1986

O.C.B.  
HOBBS OFFICE