

NO. OF COPIES RECEIVED	
DISTRIBUTION	
SANTA FE	
FILE	
U.S.G.S.	
LAND OFFICE	
OPERATOR	

NEW MEXICO OIL CONSERVATION COMMISSION

30-025-29667

Form C-101
Revised 1-4-65

5A. Indicate Type of Lease	
STATE <input checked="" type="checkbox"/>	FEE <input type="checkbox"/>
5. State Oil & Gas Lease No. E-2929	
7. Unit Agreement Name	
8. Farm or Lease Name New Mexico AP State	
9. Well No. 2	
10. Field and Pool, or Wildcat Undeig. Dean Permo-Pennsylvanian	
12. County Lea	
19. Proposed Depth 11,800'	19A. Formation Strawn
20. Rotary or C.T. Rotary	
21. Elevations (Show whether DF, RT, etc.) 3843' GR	21A. Kind & Status Plug. Bond Blanket
21B. Drilling Contractor Unknown	
22. Approx. Date Work will start 4-20-86	

APPLICATION FOR PERMIT TO DRILL, DEEPEN, OR PLUG BACK

1a. Type of Work	
b. Type of Well DRILL <input checked="" type="checkbox"/> DEEPEN <input type="checkbox"/> PLUG BACK <input type="checkbox"/> OIL WELL <input checked="" type="checkbox"/> GAS WELL <input type="checkbox"/> OTHER <input type="checkbox"/> SINGLE ZONE <input checked="" type="checkbox"/> MULTIPLE ZONE <input type="checkbox"/>	
2. Name of Operator Exxon Corporation Attn: Melba Knipling	
3. Address of Operator P. O. Box 4600, Midland, TX 79702	
4. Location of Well UNIT LETTER F LOCATED 2064 FEET FROM THE North LINE 1915 West 36 15S 36E AND FEET FROM THE LINE OF SEC. TWP. RGE. NMPM	
23.	

PROPOSED CASING AND CEMENT PROGRAM

SIZE OF HOLE	SIZE OF CASING	WEIGHT PER FOOT	SETTING DEPTH	SACKS OF CEMENT	EST. TOP
17 1/2	13 3/8	54.5	400	400	Surface
11 or 12 1/4	8 5/8	24, 32	4400	1200	Surface
7 7/8	5 1/2	15.5, 17, 20	11800	900	4400

Mud Program

0 - 400 Spud-FW
400 - 4400 SBW (10.0 ppg)
4400-11400 FW (8.4-8.8 ppg)
11400-11800 FWM (8.8 - 9.3 ppg)

BOP Program

13 3/8" casing SA-Diverter
8 5/8" casing RRA-3000 psi

Cement

400 sx 'c' w/2% CaCl₂ WOC 8 hrs. -
Surface Casing
950 sx 'c' w/10% gel
250 sx 'c' Neat WOC 8 hrs. -
Intermediate Casing

Diagrammatic sketch and specifications of BOP are attached.

IN ABOVE SPACE DESCRIBE PROPOSED PROGRAM: IF PROPOSAL IS TO DEEPEN OR PLUG BACK, GIVE DATA ON PRESENT PRODUCTIVE ZONE AND PROPOSED NEW PRODUCTIVE ZONE. GIVE BLOWOUT PREVENTER PROGRAM, IF ANY.

I hereby certify that the information above is true and complete to the best of my knowledge and belief.

Signed Melba Knipling Title Section Head Date 4-2-86

(This space for State Use)

ORIGINAL SIGNED BY JERRY SEXTON

APPROVED BY DISTRICT 1 SUPERVISOR

CONDITIONS OF APPROVAL, IF ANY:

TITLE

DATE

APR 4 - 1986

Permit Expires 6 Months From Approval
Date Unless Drilling Underway.

Exxon Lse. No. _____ NEW MEXICO OIL CONSERVATION COMMISSION
 State Lse. No. _____ WELL LOCATION AND ACREAGE DEDICATION PLAT
 Federal Lse. No. _____

Form C-102
 Supersedes C-128
 Effective 1-1-65

All distances must be from the outer boundaries of the Section.

Operator Exxon Corporation			Lease N.M. "AP" STATE		Well No. 2
Unit Letter F	Section 36	Township 15S	Range 36E	County LEA	
Actual Footage Location of Well: 2064 feet from the NORTH line and 1915 feet from the WEST line					
Ground Level Elev. 3843	Producing Formation STRAWN	Pool UNDESIG. DEAN PERMO- PENNSYLVANIAN	Dedicated Acreage: 80 Acres		

1. Outline the acreage dedicated to the subject well by colored pencil or hachure marks on the plat below.
2. If more than one lease is dedicated to the well, outline each and identify the ownership thereof (both as to working interest and royalty).
3. If more than one lease of different ownership is dedicated to the well, have the interests of all owners been consolidated by communitization, unitization, force-pooling, etc?
☐ Yes ☐ No If answer is "yes," type of consolidation _____

If answer is "no," list the owners and tract descriptions which have actually been consolidated. (Use reverse side of this form if necessary.) _____
 No allowable will be assigned to the well until all interests have been consolidated (by communitization, unitization, forced-pooling, or otherwise) or until a non-standard unit, eliminating such interests, has been approved by the Commission.

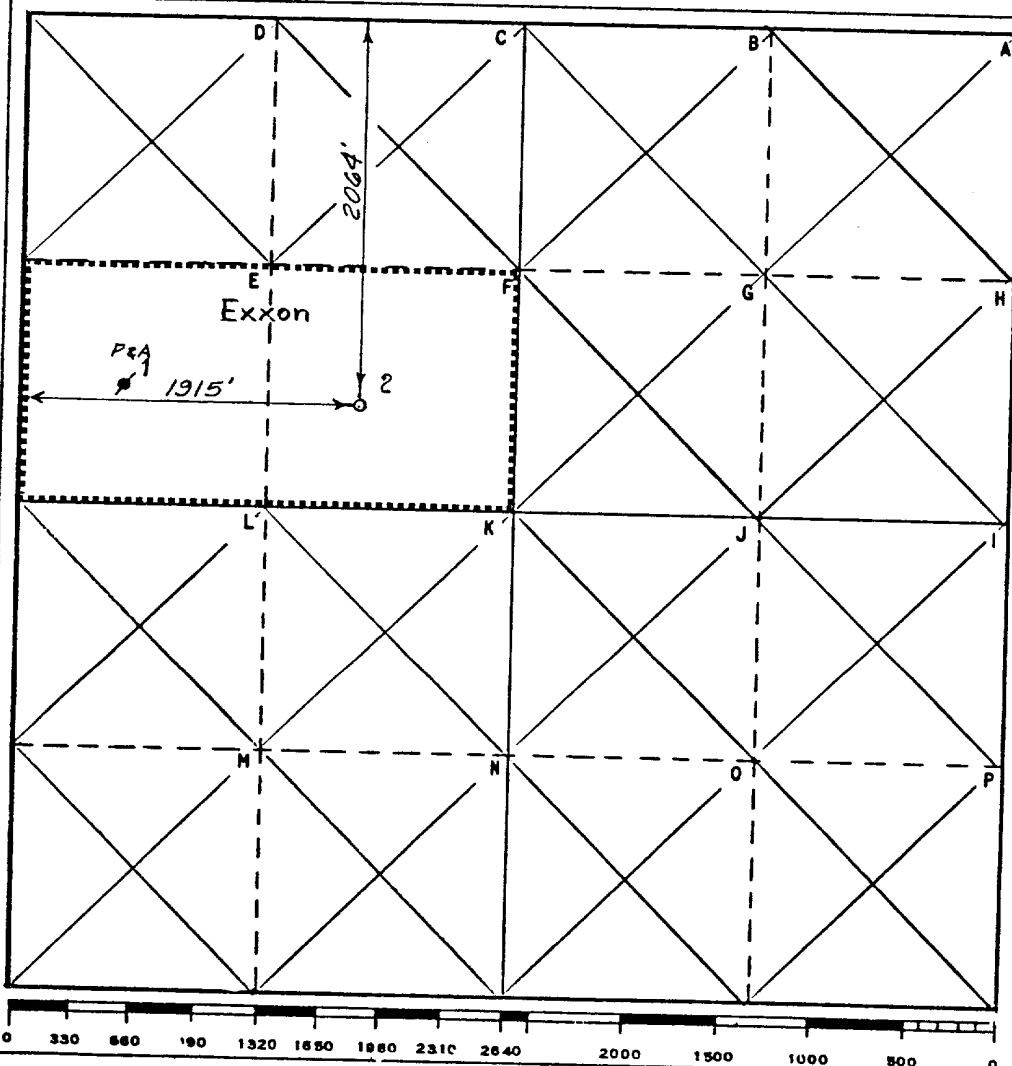

CERTIFICATION

I hereby certify that the information contained herein is true and complete to the best of my knowledge and belief.

Name
Bruce R. Pennell
 Position
UNIT HEAD

Company Exxon Corporation
 Box 1600 Midland, Texas

Date
4-2-86

I hereby certify that the well location shown on this plat was plotted from field notes of actual surveys made by me or under my supervision, and that the same is true and correct to the best of my knowledge and belief.
 BRUCE R. PENNELL
 REGISTERED PROFESSIONAL LAND SURVEYOR
 NEW MEXICO
 9062

Date Surveyed
3-13-86

Registered Professional Engineer and/or Land Surveyor

Bruce R. Pennell
 Certificate No.
#9062

5.6 Miles NE of LOVINGTON

New Mexico

C.E. See File No. 111-A-9262

TYPE SA DIVERTER

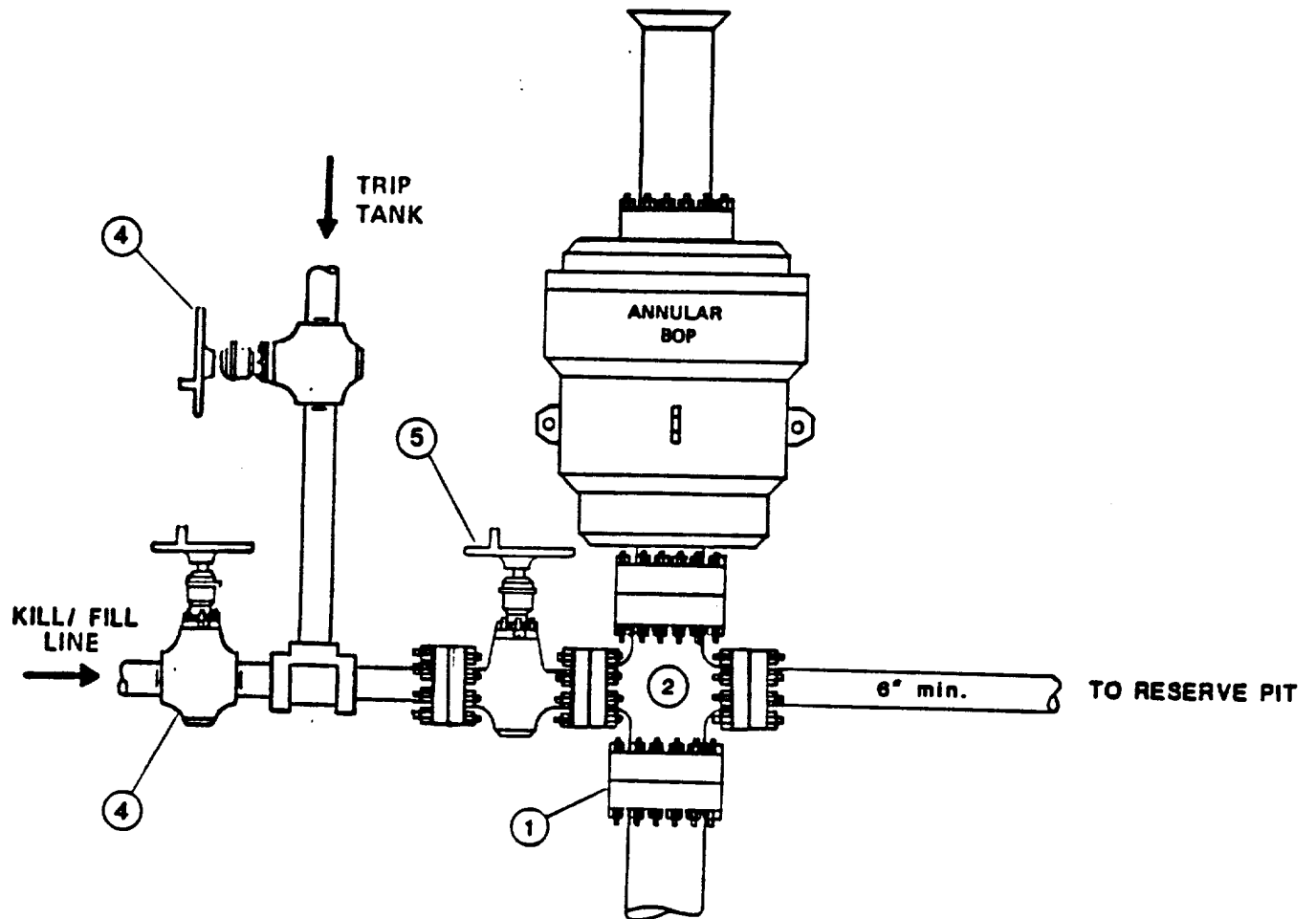

COMPONENT SPECIFICATIONS

Type SA Diverter

1. Wellhead or BOP Companion flange - screwed or welded to casing.
2. Flanged Drilling Spool.
3. Diverter line minimum size 6" internal diameter, steel pipe. Diverter lines must be securely anchored. Only flanged or welded connections can be used for pipe joint connections and 45° or 90° ells must not be installed on the end of diverter lines to direct flow downward.
4. Flanged or screwed gate or plug valve -- 2" minimum nominal diameter and 2000 psi minimum working pressure.
5. Full opening flanged gate or plug valve -- 2" minimum -- 2000 psi minimum working pressure.

TYPE RRA BOP STACK

THREE PREVENTERS

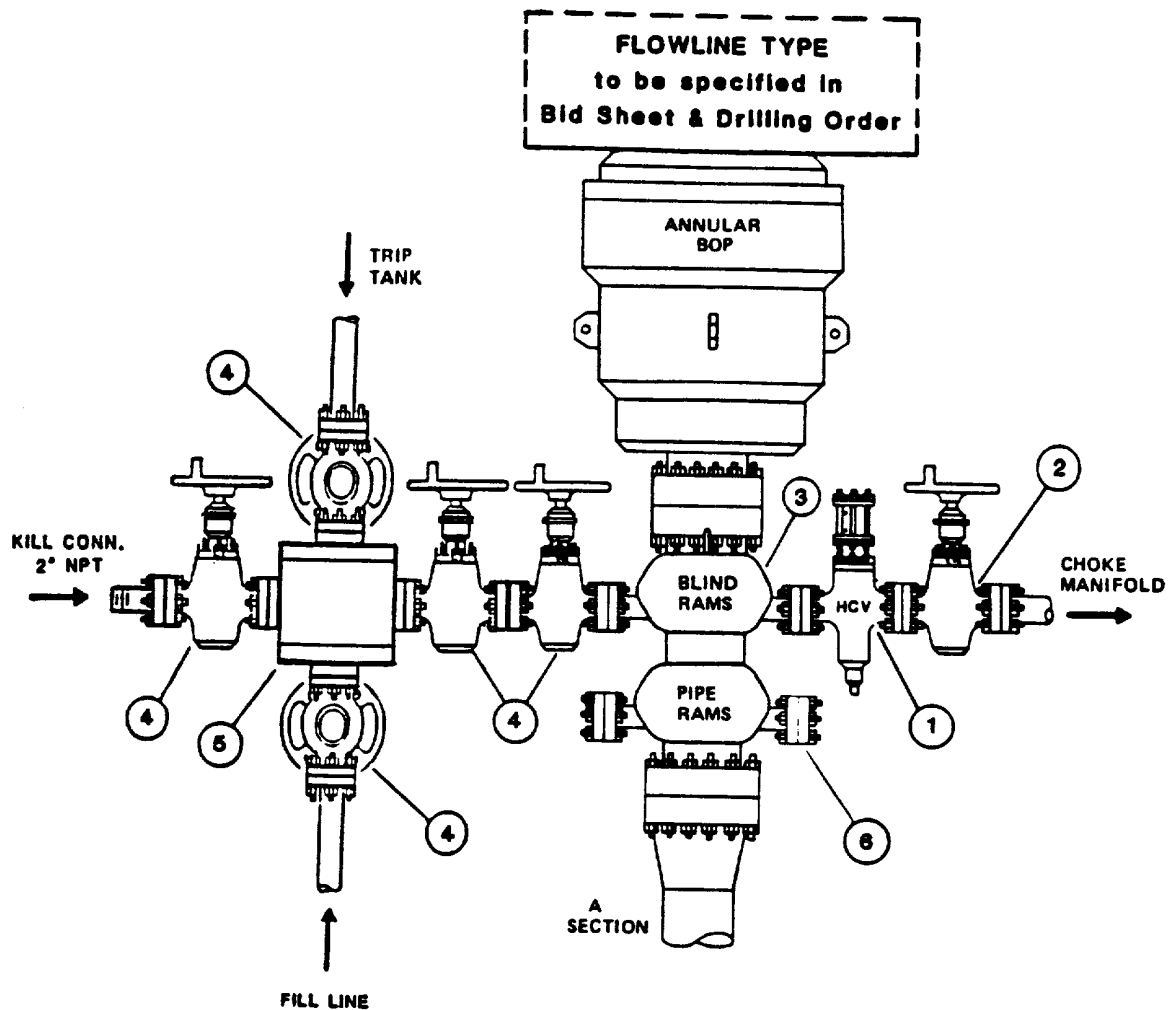

COMPONENT SPECIFICATIONS

Type RRA BOP Stack

1. Flanged hydraulically controlled gate valve -- 3" minimum nominal diameter -- same working pressure as BOP stack.
2. Flanged plug gate valve -- 3" minimum nominal diameter -- same working pressure as BOP stack.
3. BOP outlets must be 2" minimum nominal diameter for kill line and 3" minimum diameter for choke line.
4. Flanged plug or gate valve -- 2" minimum nominal diameter -- same working pressure as BOP stack.
5. Flanged cross or two (2) flanged tees.
6. Any BOP side outlet flange, located below the bottom ram, must be equipped with a blind flange.

NOTE: Each BOP stack must have separate side outlet connections for kill and choke lines, unless specific approval for a single side-outlet is obtained from the Exxon Division Drilling Manager prior to rig-up. Such approval will not be granted unless the equipment arrangement conforms to the specifications shown on pages 14 and 15 of this Section.