

NO. OF COPIES RECEIVED	
DISTRIBUTION	
SANTA FE	
FILE	
U.S.G.S.	
LAND OFFICE	
OPERATOR	

5A. Indicate Type of Lease
STATE ☒ FEE ☐

5. State Oil & Gas Lease No.
LG-4717

APPLICATION FOR PERMIT TO DRILL, DEEPEN, OR PLUG BACK

1a. Type of Work DRILL <input checked="" type="checkbox"/> DEEPEN <input type="checkbox"/> PLUG BACK <input type="checkbox"/>		7. Unit Agreement Name
b. Type of Well OIL WELL <input checked="" type="checkbox"/> GAS WELL <input type="checkbox"/> OTHER <input type="checkbox"/>		8. Firm or Lease Name Chevron State
2. Name of Operator Hondo Drilling Company		9. Well No. 1
3. Address of Operator P. O. Drawer 2316, Midland, Texas 79702-2516		10. Field and Pool, or Wildcat S.E. Anderson Ranch
4. Location of Well UNIT LETTER E LOCATED 1,980 FEET FROM THE North LINE AND 660 FEET FROM THE West LINE OF SEC. 8 TWP. 16-S RGE. 33-E NMPM		12. County Lea
19. Proposed Depth 11,500'		19A. Formation Cisco
20. Rotary or C.T. Rotary		
21. Elevations (Show whether D.F., R.T., etc.) G.L. 4,259.4'		21A. Kind & Status Plug. Bond #A-E-71331-18
21B. Drilling Contractor Hondo Drilling Company		22. Approx. Date Work will start October 1, 1986

PROPOSED CASING AND CEMENT PROGRAM

SIZE OF HOLE	SIZE OF CASING	WEIGHT PER FOOT	SETTING DEPTH	SACKS OF CEMENT	EST. TOP
17 1/2"	13 3/8"	48 lb.	450'	400	Circ. Cement
11"	8 5/8"	32 lb.	4,500'	1,700	Circ. Cement
7 7/8"	Test Cisco Canyon formation or 11,500'				

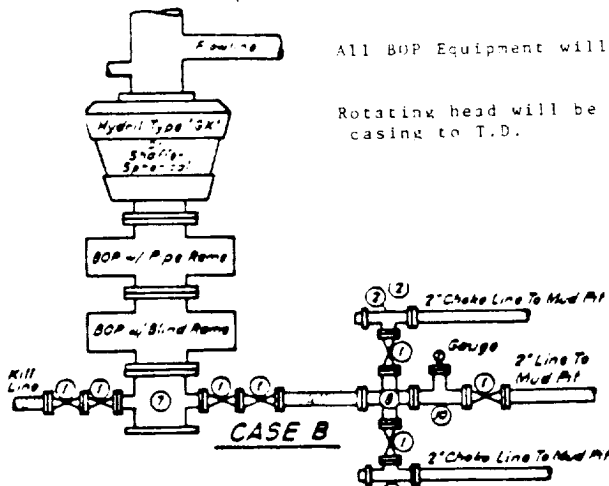

All BOP Equipment will be 11", 5000"

Rotating head will be used from intermediate casing to T.D.

IN ABOVE SPACE DESCRIBE PROPOSED PROGRAM: IF PROPOSAL IS TO DEEPEN OR PLUG BACK, GIVE DATA ON PRESENT PRODUCTIVE ZONE AND PROPOSED NEW PRODUCTIVE ZONE. GIVE BLOWOUT PREVENTER PROGRAM, IF ANY.

I hereby certify that the information above is true and complete to the best of my knowledge and belief.

Signed [Signature] Title President Date September 24, 1986

(This space for State Use)

ORIGINAL SIGNED BY JERRY SEXTON

APPROVED BY DISTRICT SUPERVISOR TITLE DATE SEP 26 1986

CONDITIONS OF APPROVAL, IF ANY:

Permit Expires 6 Months From Approval
Date Unless Drilling Underway.

[Faint, illegible markings]

N MEXICO OIL CONSERVATION COMMISS.
WELL LOCATION AND ACREAGE DEDICATION PLAT

Form C-102
 Supersedes C-128
 Effective 1-1-65

All distances must be from the outer boundaries of the Section

Operator Hondo Drilling Company			Lease Chevron State		Well No. 1
Tract Letter F	Section 8	Township 16 South	Range 33 East	County Lea	
Actual Factage Location of Well:					
1980 feet from the North line and		660 feet from the West line			
Ground Level Elev. 4254.1'	Producing Formation Cisco Canyon	Pool North S. E. Anderson Ranch		Dedicated Acreage: 80.40 Acres	

1. Outline the acreage dedicated to the subject well by colored pencil or hachure marks on the plat below.
2. If more than one lease is dedicated to the well, outline each and identify the ownership thereof (both as to working interest and royalty).
3. If more than one lease of different ownership is dedicated to the well, have the interests of all owners been consolidated by communitization, unitization, force-pooling, etc?

☐ Yes ☐ No If answer is "yes," type of consolidation _____

If answer is "no," list the owners and tract descriptions which have actually been consolidated. (Use reverse side of this form if necessary.) _____

No allowable will be assigned to the well until all interests have been consolidated (by communitization, unitization, forced-pooling, or otherwise) or until a non-standard unit, eliminating such interests, has been approved by the Commission.

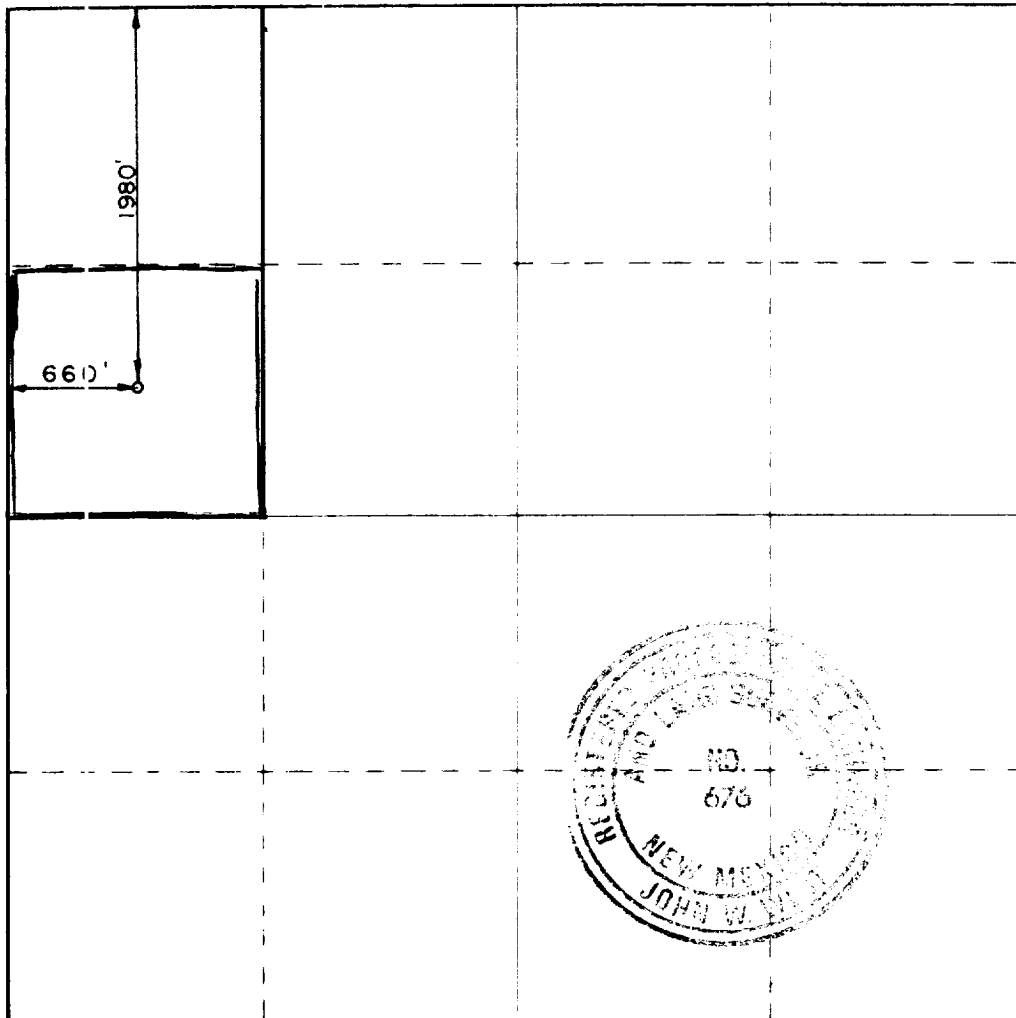

CERTIFICATION

I hereby certify that the information contained herein is true and complete to the best of my knowledge and belief.

N. W. Outlaw

Name
N. W. Outlaw

Position
President

Company
Hondo Drilling Co.

Date
September 24, 1986

I hereby certify that the well location shown on this plat was plotted from field notes of actual surveys made by me or under my supervision, and that the same is true and correct to the best of my knowledge and belief.

Date Surveyed
9-12-86

Registered Professional Engineer and Land Surveyor

John W. West

Certificate No. **JOHN W. WEST, 676**
RONALD J. EIDSON, 3239

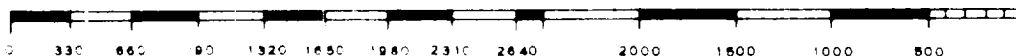

RECEIVED
SEP 25 1986
O.C.D.
HOBBS OFFICE



12-11-86
LGD

12-15-86