

UNITED STATES
DEPARTMENT OF THE INTERIOR
GEOLOGICAL SURVEY

APPLICATION FOR PERMIT TO DRILL, DEEPEN, OR PLUG BACK

1a. TYPE OF WORK DRILL <input checked="" type="checkbox"/> DEEPEN <input type="checkbox"/> PLUG BACK <input type="checkbox"/>		5. LEASE DESIGNATION AND SERIAL NO. LC-058697(A)	
b. TYPE OF WELL OIL WELL <input checked="" type="checkbox"/> GAS WELL <input type="checkbox"/> OTHER <input type="checkbox"/> SINGLE ZONE <input checked="" type="checkbox"/> MULTIPLE ZONE <input type="checkbox"/>		6. IF INDIAN, ALLOTTEE OR TRIBE NAME	
2. NAME OF OPERATOR CONOCO INC.		7. UNIT AGREEMENT NAME MCA	
3. ADDRESS OF OPERATOR P. O. Box 460, Hobbs, N.M. 88240		8. FARM OR LEASE NAME MCA Unit	
4. LOCATION OF WELL (Report location clearly and in accordance with any State requirements.) At surface Unit 0 75' FSL & 1495' FEL At proposed prod. zone Same		9. WELL NO. 367	
14. DISTANCE IN MILES AND DIRECTION FROM NEAREST TOWN OR POST OFFICE*		10. FIELD AND POOL, OR WILDCAT Maljamar 6/SA	
15. DISTANCE FROM PROPOSED* LOCATION TO NEAREST PROPERTY OR LEASE LINE, FT. (Also to nearest drlg. unit line, if any)		11. SEC., T., R., M., OR BLK. AND SURVEY OR AREA Sec. 23-175-32E	
16. NO. OF ACRES IN LEASE		12. COUNTY OR PARISH	
17. NO. OF ACRES ASSIGNED TO THIS WELL		13. STATE Lea NM	
18. DISTANCE FROM PROPOSED LOCATION* TO NEAREST WELL, DRILLING, COMPLETED, OR APPLIED FOR, ON THIS LEASE, FT.		20. ROTARY OR CABLE TOOLS Rotary	
21. ELEVATIONS (Show whether DF, RT, GR, etc.) 4005' GL		22. APPROX/ DATE WORK WILL START* February 15, 1987	

PROPOSED CASING AND CEMENTING PROGRAM

SIZE OF HOLE	SIZE OF CASING	WEIGHT PER FOOT	SETTING DEPTH	QUANTITY OF CEMENT
17 1/2"	13 3/8"	54.5 #	400'	350 SXS Class "C" Circ.
11"	8 5/8"	32.0 #	2350'	1305 SXS Class "C" & class "C" light Circ.
7 7/8"	5 1/2"	17.0 #	4350'	735 SXS Class "C" & CO2 Resistant cm+ Circ.

It is proposed to drill a straight hole to 4350' and complete as a Grayburg/San Andres oil well. Attached is a location and acreage dedication plat, a proposed Well Plan Outline and a Surface Use Plan. An application for Non-standard location has been filed with the NMCO in Santa Fe.

IN ABOVE SPACE DESCRIBE PROPOSED PROGRAM: If proposal is to deepen or plug back, give data on present productive zone and proposed new productive zone. If proposal is to drill or deepen directionally, give pertinent data on subsurface locations and measured and true vertical depths. Give blowout preventer program, if any.

24. SIGNED [Signature] TITLE Administrative Supervisor DATE 1-19-87
(This space for Federal or State office use)

PERMIT NO. [Signature] APPROVAL DATE [Signature]
APPROVED BY [Signature] TITLE [Signature] DATE 2.3.87
CONDITIONS OF APPROVAL, IF ANY:

Subject to
Like Approval
by State

*See Instructions On Reverse Side

BLM-Carlsbad (6) ARCO (2) Cities (1) PLCC (1) File

NEW MEXICO OIL CONSERVATION COMMISSION
WELL LOCATION AND ACREAGE DEDICATION PLAT

Form C-102
Supersedes C-128
Effective 1-1-65

All distances must be from the outer boundaries of the Section

Operator CONOCO, INC.		Lease MCA UNIT		Well No. 367	
Tract Letter 0	Section 23	Township 17-S	Range 32-E	County LEA	
Actual Footage Location of Well: 75 feet from the SOUTH line and 1495 feet from the EAST line					
Ground Level Elev. 4005.3	Producing Formation Grayburg / San Andres		Pool Malamar Grayburg / San Andres	Dedicated Acreage: 20 Acres	

- Outline the acreage dedicated to the subject well by colored pencil or hatchure marks on the plat below.
- If more than one lease is dedicated to the well, outline each and identify the ownership thereof (both as to working interest and royalty).
- If more than one lease of different ownership is dedicated to the well, have the interests of all owners been consolidated by communitization, unitization, force-pooling, etc?

☒ Yes ☐ No If answer is "yes," type of consolidation unitization

If answer is "no," list the owners and tract descriptions which have actually been consolidated. (Use reverse side of this form if necessary.)

No allowable will be assigned to the well until all interests have been consolidated (by communitization, unitization, forced-pooling, or otherwise) or until a non-standard unit, eliminating such interests, has been approved by the Commission.

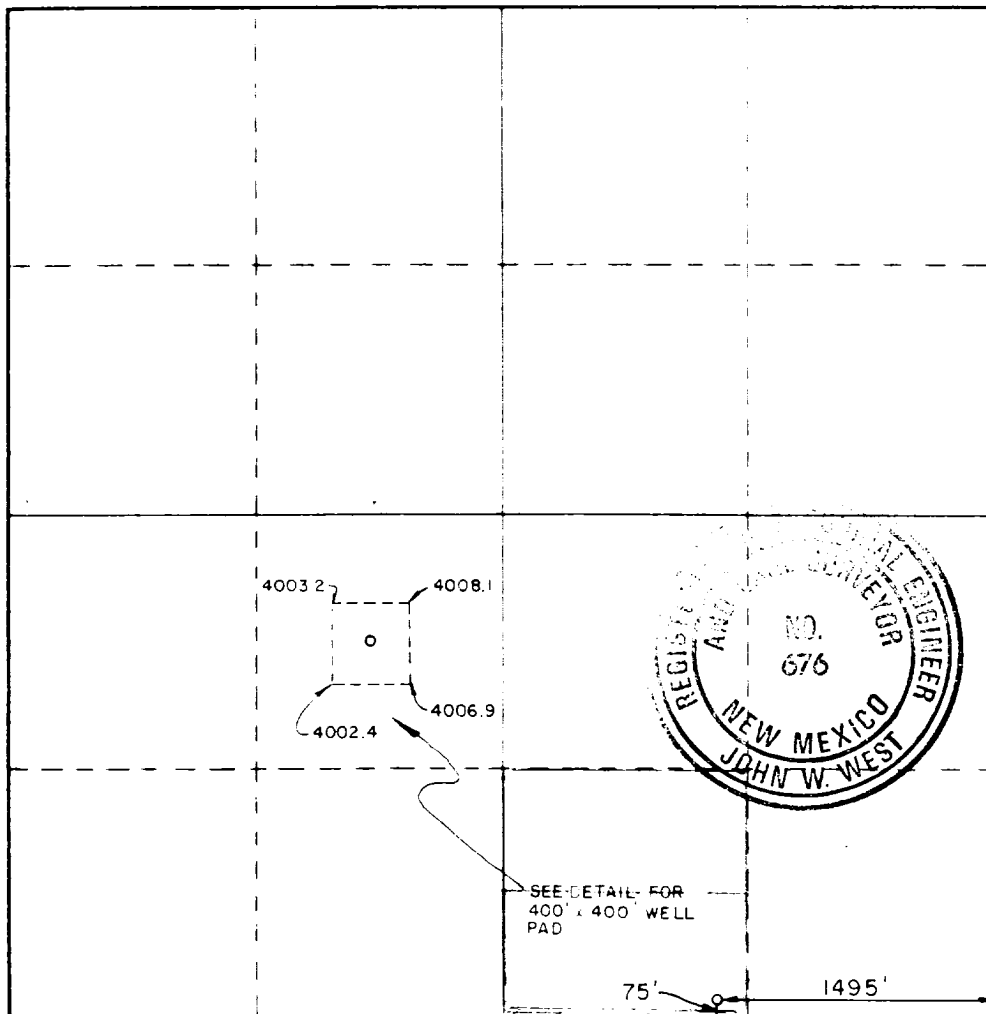

CERTIFICATION

I hereby certify that the information contained herein is true and complete to the best of my knowledge and belief.

Name Carl Bull
Position Administrative Supervisor
Company CONOCO, Inc.
Date 1-19-87

I hereby certify that the well location shown on this plat was plotted from field notes of actual surveys made by me or under my supervision, and that the same is true and correct to the best of my knowledge and belief.

Date Surveyed
NOVEMBER 28, 1986
Registered Professional Engineer
and/or Land Surveyor

John W. West
Certificate No. JOHN W. WEST, 676
RONALD J. EIDSON, 3239

CONOCO INC.

Blow-out Preventer Specifications

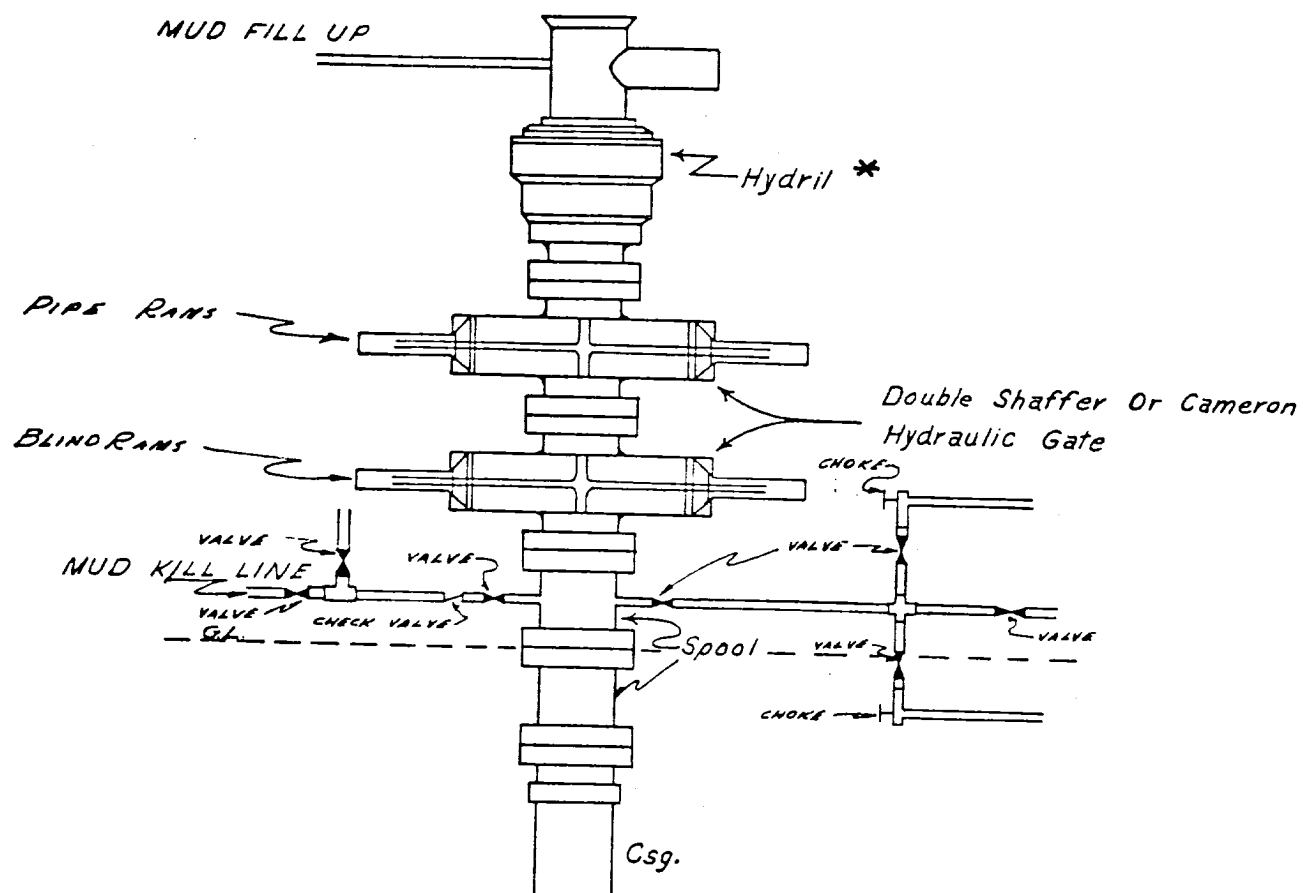

NOTE:

Manual and Hydraulic controls with closing unit no less than 75' from well head.
Remote controls on rig floor.

*

DUE TO SUBSTRUCTURE CLEARANCE, HYDRIL
MAY OR MAY NOT BE USED.

RECEIVED
FEB 4 1987
OCD
HOBBS OFFICE

COMMUNICATIONS
SECTION
FEB 4 1987

FEB 17
FED