

WRS COMPLETION REPORTCOMPLETIONS
PI# 30-T-0007 09/21/87 SEC 23 TWP 16S RGE 38E
30-025-29869-0000 PAGE 1NMEX LEA * 750FNL 750FEL SEC NE NE
STATE COUNTY FOOTAGE SPOT
MARATHON OIL WD WDD
OPERATOR WELL CLASS INIT FIN
1 RODDY V E
WELL NO. LEASE NAME UNNAMED
3718KB 3697GR
OPER ELEV API 30-025-29869-0000LEASE TYPE/NO. PERMIT OR WELL I.D. NO. OIL
03/13/1987 06/09/1987 ROTARY STATUS
SPUD DATE COMP. DATE TYPE TOOL
13500 SIL-DEV WILLBROS DRLG 14
PROJ. DEPTH PROJ. FORM CONTRACTOR
DTD 13300 PB 13222 FM/TD DEVONIAN
DRILLERS T.D. LOG T.D. PLUG BACK TD OLD T.D. FORM T.D.**LOCATION DESCRIPTION**

5 MI N KNOWLES, NM

WELL IDENTIFICATION/CHANGESWELL NAME CHGD FROM RODDY
FLD CHGD FROM WILDCAT**CASING/LINER DATA**CSG 13 3/8 @ 298 W/ 375 SACKS
CSG 9 5/8 @ 5007 W/ 2050 SACKS
CSG 5 1/2 @ 13280 W/ 1925 SACKS**TUBING DATA**

TBG 2 7/8 AT 12986

INITIAL POTENTIALIPF 223BOPD 50.0MCFD 24/64CK 24HRS
DEVONIAN PERF W/ 105/IT 13072-13100
GTY 48.8 GOR 224

TYPE	FORMATION	LTH	TOP DEPTH/SUB	BSE DEPTH/SUB
LOG	SN ANDRS		5015 -1297	
LOG	GLORIETA		6319 -2601	
LOG	PADDOCK		6534 -2816	
LOG	TUBB		7716 -3998	

CONTINUED IC# 300257005887

Copyrighted 1987
Petroleum
Information Corporation**PI** a company of
The Dun & Bradstreet CorporationPI-WRS-GET
Form No 187

COMPLETIONS
PI# 30-T-0007 09/21/87 SEC 23 TWP 16S RGE 38E
30-025-29869-0000 PAGE 2

MARATHON OIL
1

RODDY V E

WD WDD

TYPE	FORMATION	LTH	TOP	DEPTH/SUB	BSE	DEPTH/SUB
LOG	ABO		8346	-4628		
LOG	WOLFCAMP		9517	-5799		
LOG	ATOKA		11326	-7608		
LOG	DEVONIAN		13058	-9340		

CORES

CORE 1 13077-13177 REC100.00FT DEVONIAN CONV
* 100.0TSL,DOLO

PRODUCTION TEST DATA

PTF 225BOPD
DEVONIAN PERF JET W/ 105/IT 13072-13100 24/64CK 24HRS
PERF 13072-13100
FTP 20-50
NATURAL

PTF 105BOPD
DEVONIAN PERF 16/64CK 24HRS
TP 66 13072-13100

LOGS AND SURVEYS /INTERVAL, TYPE/

LOGS 6700-13222	GR	6700-13222	CBL	6700-13222	CCL
LOGS	DLL		MSFL		CNL
LOGS	FMF				

DRILLING PROGRESS DETAILS

	MARATHON OIL
	BOX 552
	MIDLAND, TX 79702
	915-682-1626
03/03	LOC/1987/
03/19	DRLG 3425
03/23	DRLG 5008
03/26	DRLG 5300
03/30	DRLG 8083
04/02	DRLG 8625
04/06	DRLG 10120
04/09	DRLG 10329

CONTINUED

COMPLETIONS SEC 23 TWP 16S RGE 38E
PI# 30-T-0007 09/21/87 30-025-29869-0000 PAGE 3

MARATHON OIL
1

RODDY V E

WD WDD

DRILLING PROGRESS DETAILS

04/13 DRLG 11181
04/16 DRLG 11313
04/20 DRLG 11784
04/23 DRLG 11784
04/27 DRLG 12241
04/30 DRLG 12263
05/03 DRLG 12796
05/07 DRLG 12847
05/14 13300 TD, CIRC
05/21 13300 TD, PREP PERF
05/22 13300 TD, PREP PERF
05/28 13300 TD, PB 13222, COMPLETING
06/03 13300 TD, PB 13222, PREP TEST
06/11 13300 TD, PB 13222, TSTG
06/18 13300 TD, PB 13222, TSTG
07/27 13300 TD, PB 13222, WOPT
TD REACHED 05/14/87 RIG REL 05/16/87
09/15 13300 TD, PB 13222
COMP 6/9/87, IPF 223 BO, 50 MCFGPD THRU
24/64 CK, GOR 224, GTY 48.8
PROD ZONE - DEVONIAN 13072-13100
ONE CORE, NO DSTS RPTD
09/15 DEVONIAN DISCOVERY-DEEPER POOL

**NEW MEXICO OIL CONSERVATION COMMISSION
WELL LOCATION AND ACREAGE DEDICATION PLAT**

Form O-128
Supersedes C-128
Effective 1-1-85

All distances must be from the outer boundaries of the Section

Operator Marathon Oil Company			Lease V.E. Roddy		Well No. #1
Unit Letter A	Section 23	Township 16 South	Range 38 East	County Lea	
Actual Footage Location of Well: 750 feet from the East line and 750 feet from the North line					
Ground Level Elev. 3697.0	Producing Formation Devonian		Pool North Knowles	Dedicated Acreage: 80 Acres	

1. Outline the acreage dedicated to the subject well by colored pencil or hatchure marks on the plat below.
2. If more than one lease is dedicated to the well, outline each and identify the ownership thereof (both as to working interest and royalty).
3. If more than one lease of different ownership is dedicated to the well, have the interests of all owners been consolidated by communitization, unitization, force-pooling, etc?

☐ Yes ☐ No If answer is "yes," type of consolidation _____

If answer is "no," list the owners and tract descriptions which have actually been consolidated. (Use reverse side of this form if necessary.) _____

No allowable will be assigned to the well until all interests have been consolidated (by communitization, unitization, forced-pooling, or otherwise) or until a non-standard unit, eliminating such interests, has been approved by the Commission.

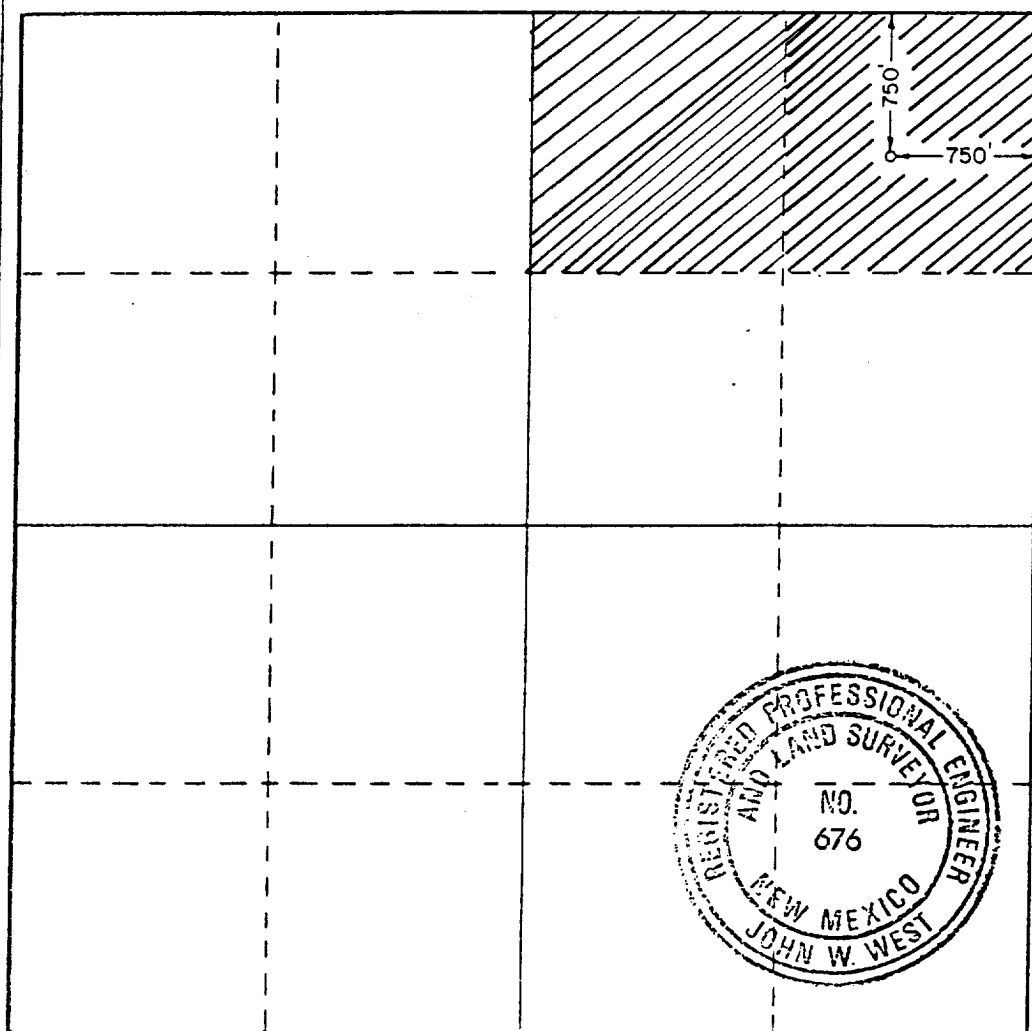

CERTIFICATION

I hereby certify that the information contained herein is true and complete to the best of my knowledge and belief.

Allen S. Wilson

Name

Allen S. Wilson

Position

Operations Engineer

Company

Marathon Oil Company

Date

September 9, 1987

I hereby certify that the well location shown on this plat was plotted from field notes of actual surveys made by me or under my supervision, and that the same is true and correct to the best of my knowledge and belief.

Date Surveyed

February 20, 1987

Registered Professional Engineer and/or Land Surveyor

John W. West

Certificate No **JOHN W. WEST,**

676

RONALD J. EIDSON,

3239

RECEIVED
SEP 16 1961
OCD
HOBBS OFFICE

Mid-Continent Region
Production United States



P.O. Box 552
Midland, Texas 79702
Telephone 915/682-1626

June 10, 1987

State of New Mexico
Oil Conservation Division, District I
P. O. Box 1980
Hobbs, New Mexico 88240

Attention: J. T. Sexton

Subject Reference: Well Completion Report, Form C-105
Marathon Oil Company
V. E. Roddy Well No. 1
Unit A, Section 23, T-16-S, R-38-E
Lea County, New Mexico

Dear Sir:

Attached is the well completion report, Form C-105, and attachments for Marathon Oil Company's V. E. Roddy Well No. 1 located in Unit A, Section 23, T-16-S, R-38-E, Lea County, New Mexico. The deviation survey has been filed previously with a request for allowable. It is respectfully requested that this information be kept confidential for a period of 90 days. If any additional information is required, please contact either W. D. Holmes or myself at 915/682-1626. Thank you for your assistance.

Sincerely,

MARATHON OIL COMPANY

A handwritten signature in cursive script that reads 'Eric M. Pringle'.

Eric M. Pringle
Engineer

EMP;tjm/i

XC: File

RECEIVED
JUN 12 1987
OCD
HOBBS OFFICE