

Submit to Appropriate
District Office
State Lease - 6 copies
Fee Lease - 5 copies

State of New Mexico
Energy, Minerals and Natural Resources Department

Form C-101
Revised 1-1-89

OIL CONSERVATION DIVISION

P.O. Box 2088
Santa Fe, New Mexico 87504-2088

DISTRICT I
P.O. Box 1980, Hobbs, NM 88240

DISTRICT II
P.O. Drawer DD, Artesia, NM 88210

DISTRICT III
1000 Rio Brazos Rd., Aztec, NM 87410

API NO. (assigned by OCD on New Wells)
30-025-29968-0000

5. Indicate Type of Lease
STATE ☐ FEE ☒

6. State Oil & Gas Lease No.

APPLICATION FOR PERMIT TO DRILL, DEEPEN, OR PLUG BACK

1a. Type of Work:

DRILL ☐ RE-ENTER ☒ DEEPEN ☐ PLUG BACK ☐
b. Type of Well:
OIL WELL ☒ GAS WELL ☐ OTHER ☐
SINGLE ZONE ☒ MULTIPLE ZONE ☐

7. Lease Name or Unit Agreement Name

Dickinson Trust ~~No~~

2. Name of Operator

Bettis Boyle & Stovall

8. Well No.

1

3. Address of Operator

500 West Texas, Ste 830, Midland, Texas 79701

9. Pool name or Wildcat
Wildcat

4. Well Location

Unit Letter J : 1980 Feet From The South Line and 2310 Feet From The East Line

Section 12 Township 15-S Range 37E NMPM Lea County

10. Proposed Depth

13,000 10,100'

11. Formation

Penn Lm.

12. Rotary or C.T.

Rotary

13. Elevations (Show whether DF, RT, GR, etc.)

3781' GL

14. Kind & Status Plug. Bond

Blanket-Current

15. Drilling Contractor

Not Known

16. Approx. Date Work will start

2/2/93

PROPOSED CASING AND CEMENT PROGRAM

SIZE OF HOLE	SIZE OF CASING	WEIGHT PER FOOT	SETTING DEPTH	SACKS OF CEMENT	EST. TOP
See Attachments	- Surface, Intermediate and P/A plugs				
7.875"	5.50"	17.0-20.0	Appx. 10,100	250	9000' KB

-This well was originally drilled by North American Royalties, Inc. to a total depth of 13,000' KB; P/A 9/16/87.
-Operator plans to re-enter the well, clean out down to 10,138' KB, set a new cement plug back to appx. 10,050' KB and DST the Penn Lime interval from appx. 9,900' KB to PBD. If productive, 5.50" casing will be set and cemented back to appx. 9,000' KB. The Penn Lime will be perforated, acidized and tested.

-A lined surface pit will be constructed to receive cuttings, cement washing, etc. from the required operations. A tank will be used to contain test and workover fluids. These will be hauled to a disposal facility approved by the NMOCD. Minor oil spills (less than one barrel) will be mixed with solid and spread over the in-service pad area. The pit will be de-watered within 15 days and back filled ASAP. Fencing will be used to prevent cattle from drinking the fluid.

-The tank battery will be built on the pad area; fired vessels will be placed at least one hundred feet from the well and tanks,

IN ABOVE SPACE DESCRIBE PROPOSED PROGRAM: IF PROPOSAL IS TO DEEPEN OR PLUG BACK, GIVE DATA ON PRESENT PRODUCTIVE ZONE AND PROPOSED NEW PRODUCTIVE ZONE. GIVE BLOWOUT PREVENTER PROGRAM, IF ANY.

I hereby certify that the information above is true and complete to the best of my knowledge and belief.

SIGNATURE James F. O'Brian TITLE Consulting Engineer

DATE 1/22/93

TYPE OR PRINT NAME James F. O'Brian

TELEPHONE NO. (915) 685-4128

(This space for State Use)

ORIGINAL SIGNED BY JERRY SEXTON

DISTRICT I SUPERVISOR

APPROVED BY

TITLE

DATE

CONDITIONS OF APPROVAL, IF ANY:

FEB 02 1993

Permit Expires 6 Months From Approval
Date Unless Drilling Underway

Submit to Appropriate
District Office
State Lease - 4 copies
Fee Lease - 3 copies

State of New Mexico
Energy, Minerals and Natural Resources Department

Form C-102
Revised 1-1-89

OIL CONSERVATION DIVISION

P.O. Box 2088

Santa Fe, New Mexico 87504-2088

DISTRICT I
P.O. Box 1980, Hobbs, NM 88240

DISTRICT II
P.O. Drawer DD, Artesia, NM 88210

DISTRICT III
1000 Rio Brazos Rd., Aztec, NM 87410

WELL LOCATION AND ACREAGE DEDICATION PLAT

All Distances must be from the outer boundaries of the section

Operator Bettis, Boyle & Stovall			Lease Dickinson Trust		Well No. 1
Unit Letter J	Section 12	Township 15 South	Range 37 East	County Lea	

Actual Footage Location of Well:

1980' feet from the south line and 2310 feet from the east line

Ground level Elev. 3781.3	Producing Formation Devonian Penn	Pool Denton-Devonian Penn	Dedicated Acreage: 80 40 Acres
------------------------------	---	---	-----------------------------------

- Outline the acreage dedicated to the subject well by colored pencil or hatchure marks on the plat below.
- If more than one lease is dedicated to the well, outline each and identify the ownership thereof (both as to working interest and royalty).
- If more than one lease of different ownership is dedicated to the well, have the interest of all owners been consolidated by communitization, unitization, force-pooling, etc.?
☐ Yes ☐ No If answer is "yes" type of consolidation _____
If answer is "no" list the owners and tract descriptions which have actually been consolidated. (Use reverse side of this form if necessary). _____
No allowable will be assigned to the well until all interests have been consolidated (by communitization, unitization, forced-pooling, or otherwise) or until a non-standard unit, eliminating such interest, has been approved by the Division.

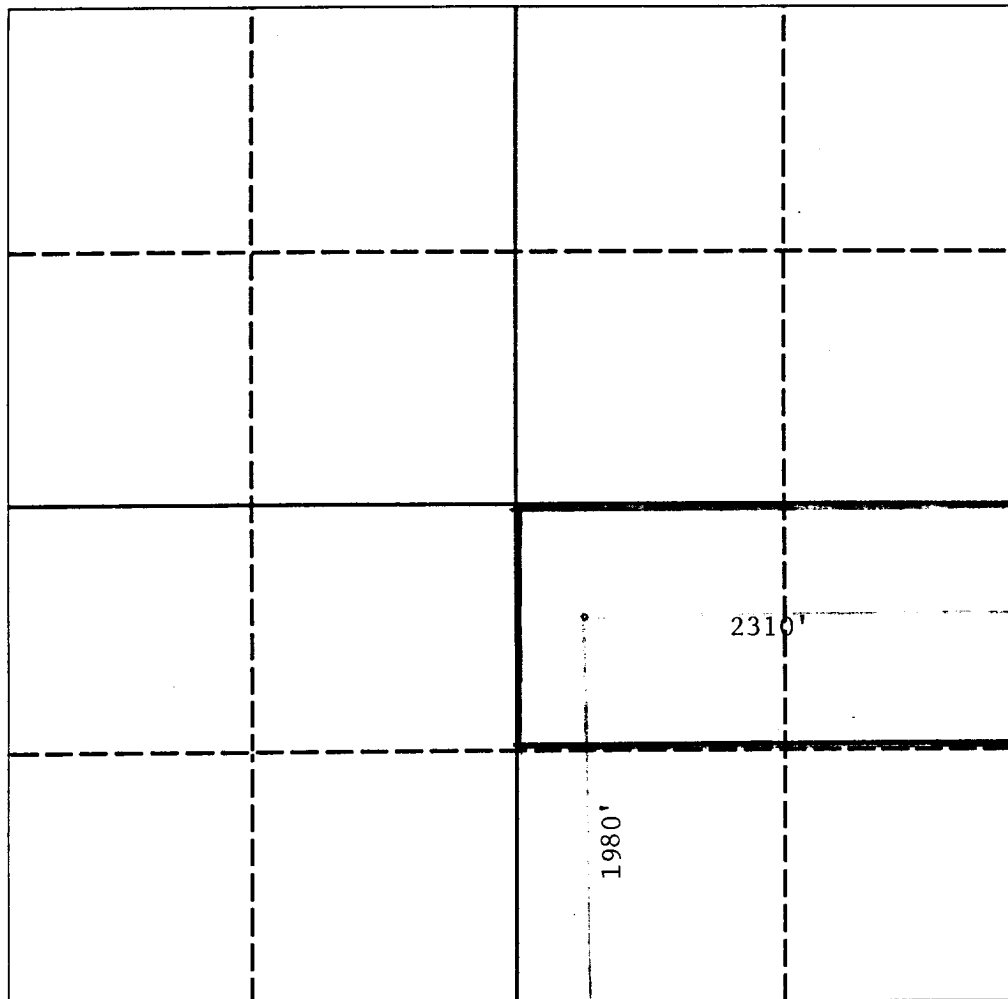

OPERATOR CERTIFICATION

I hereby certify that the information contained herein is true and complete to the best of my knowledge and belief.

Signature
HARRY M. BETTIS, JR.

Printed Name

AGENT

Position

BETTIS BOYLE & STOVALL

Company

1/28/93

Date

SURVEYOR CERTIFICATION

I hereby certify that the well location shown on this plat was plotted from field notes of actual surveys made by me or under my supervision, and that the same is true and correct to the best of my knowledge and belief.

Date Surveyed
Original surveyed June 16, 1988
by John West Engineering

Signature & Seal of
Professional Surveyor

Certificate No.

4 DRILLING COMPANY

Wg #1

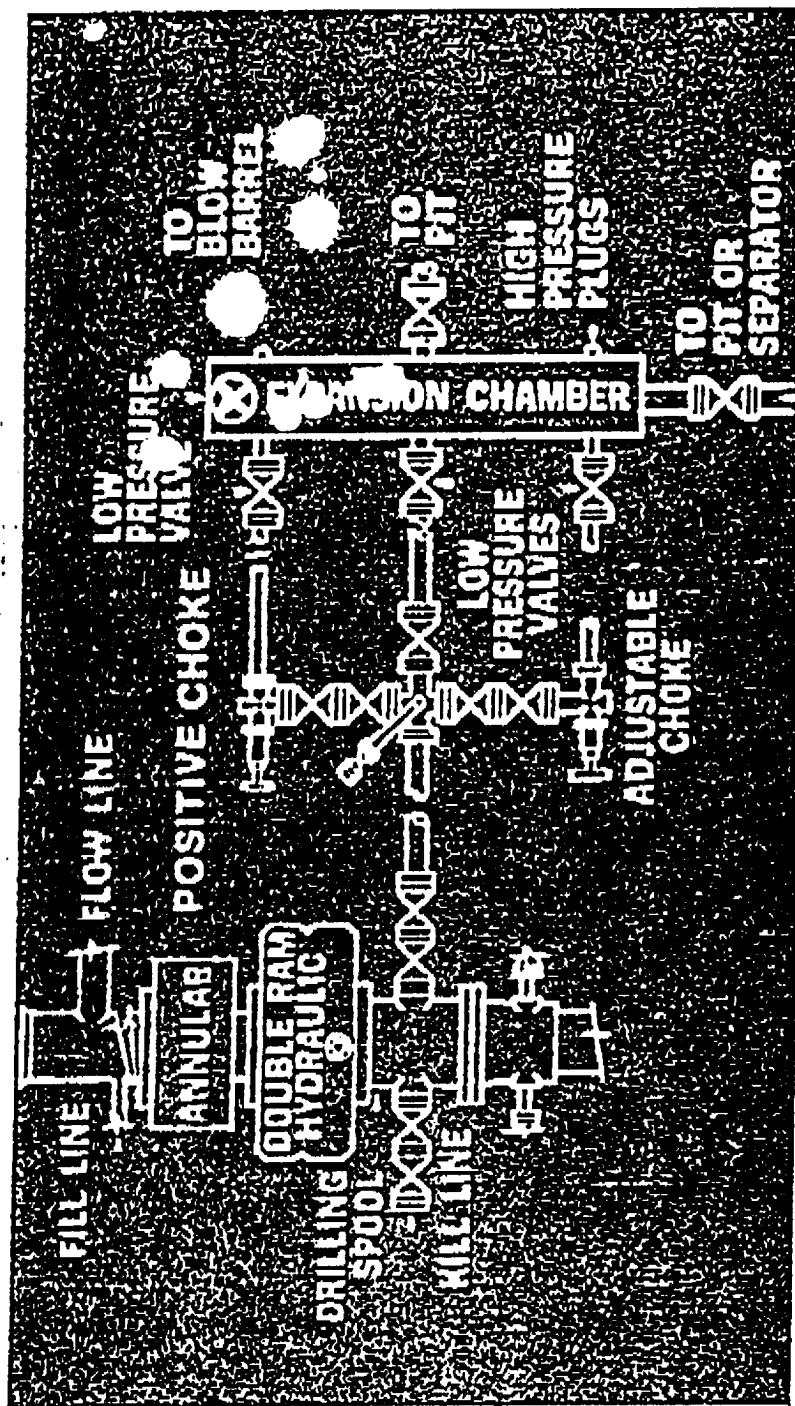

3000 psig

Handwritten signature or mark at the bottom right corner.

RECEIVED

JAN 25 1993

THE HONORABLE OFFICE