

STATE OF NEW MEXICO
ENERGY AND MINERALS DEPARTMENT

L CONSERVATION DIVISION
P. O. BOX 2088
SANTA FE, NEW MEXICO 87501

30-025-29977
Form C-101
Revised 10-1-78

NO. OF COPIES RECEIVED	
DISTRIBUTION	
SANTA FE	
FILE	
U.S.G.S.	
LAND OFFICE	
OPERATOR	

5A. Indicate Type of Lease	
STATE <input checked="" type="checkbox"/>	FED <input type="checkbox"/>
5. State Oil & Gas Lease No.	
V-1671	

APPLICATION FOR PERMIT TO DRILL, DEEPEN, OR PLUG BACK

1a. Type of Work				7. Unit Agreement Name	
b. Type of Well OIL WELL <input checked="" type="checkbox"/> GAS WELL <input type="checkbox"/> OTHER <input type="checkbox"/> DRILL <input checked="" type="checkbox"/> DEEPEN <input type="checkbox"/> PLUG BACK <input type="checkbox"/> SINGLE ZONE <input type="checkbox"/> MULTIPLE ZONE <input type="checkbox"/>				8. Farm or Lease Name	
2. Name of Operator				9. Well No.	
Yates Petroleum Corporation				1	
3. Address of Operator				10. Field and Pool, or Wildcat	
105 South Fourth Street, Artesia, New Mexico 88210				2nd designated Sanmal - Queen	
4. Location of Well				12. County	
UNIT LETTER <u>D</u> LOCATED <u>990</u> FEET FROM THE <u>North</u> LINE				Lea	
AND <u>330</u> FEET FROM THE <u>West</u> LINE OF SEC. <u>12</u> TWP. <u>17S</u> RGE. <u>33E</u> NMPM					
19. Proposed Depth		19A. Formation		20. Rotary or C.T.	
4000'		Queen		Rotary	
21. Elevations (show whether DF, KI, etc.)		21A. Kind & Status Plug. Bond		22. Approx. Date Work will start	
4152.3' GR		Blanket		ASAP	

23.

PROPOSED CASING AND CEMENT PROGRAM

SIZE OF HOLE	SIZE OF CASING	WEIGHT PER FOOT	SETTING DEPTH	SACKS OF CEMENT	EST. TOP
12-1/4"	8-5/8"	24# J-55	Approx. 1550'	1000 sacks	Circulate
7-7/8"	5-1/2"	14# J-55	TD	300 sacks	Adequate cover

We propose to drill and test the Queen formation and intermediate zones. Approximately 1550' of surface casing will be set with cement circulated to surface to shut off gravel and cavings. If productive, 5-1/2" casing will be run and cemented with adequate cover, perforated and stimulated as needed for production.

MUD PROGRAM: Native mud to 1550', brine water to TD.

BOP PROGRAM: BOP's will be installed at the offset and tested daily.

IN ABOVE SPACE DESCRIBE PROPOSED PROGRAM: IF PROPOSAL IS TO DEEPEN OR PLUG BACK, GIVE DATA ON PRESENT PRODUCTIVE ZONE AND PROPOSED NEW PRODUCTIVE ZONE. GIVE BLOWOUT PREVENTER PROGRAM, IF ANY.

I hereby certify that the information above is true and complete to the best of my knowledge and belief.

Signed Cliff R. May Title Regulatory Agent Date July 9, 1987

(This space for State Use)

Eddie W. Seay

APPROVED BY Oil & Gas Inspector TITLE DATE JUL 10 1987

CONDITIONS OF APPROVAL, IF ANY:

Permit Expires 6 Months From Approval
Date Unless Drilling Underway.

**NEW MEXICO OIL CONSERVATION COMMISSION
WELL LOCATION AND ACREAGE DEDICATION PLAT**

Form C-102
Supersedes C-128
Effective 1-4-85

All distances must be from the order boundaries of the Section.

Operator YATES PETROLEUM CORPORATION			Lease BILLY "AES" STATE		Well No. 1
Unit Letter "D"	Section 12	Township 17 South	Range 33 East	County Lea	
Actual Footage Location of Well: 990 feet from the North line and 330 feet from the West line					
Ground Level Elev. 4152.3	Producing Formation QUEEN		Pool SANMAL QUEEN		Dedicated Acreage 40 Acres

1. Outline the acreage dedicated to the subject well by colored pencil or hatchure marks on the plat below.
2. If more than one lease is dedicated to the well, outline each and identify the ownership thereof (both as to working interest and royalty).
3. If more than one lease of different ownership is dedicated to the well, have the interests of all owners been consolidated by communitization, unitization, force-pooling, etc?

☐ Yes ☐ No If answer is "yes;" type of consolidation _____

If answer is "no," list the owners and tract descriptions which have actually been consolidated. (Use reverse side of this form if necessary.) _____

No allowable will be assigned to the well until all interests have been consolidated (by communitization, unitization, forced-pooling, or otherwise) or until a non-standard unit, eliminating such interests, has been approved by the Commission.

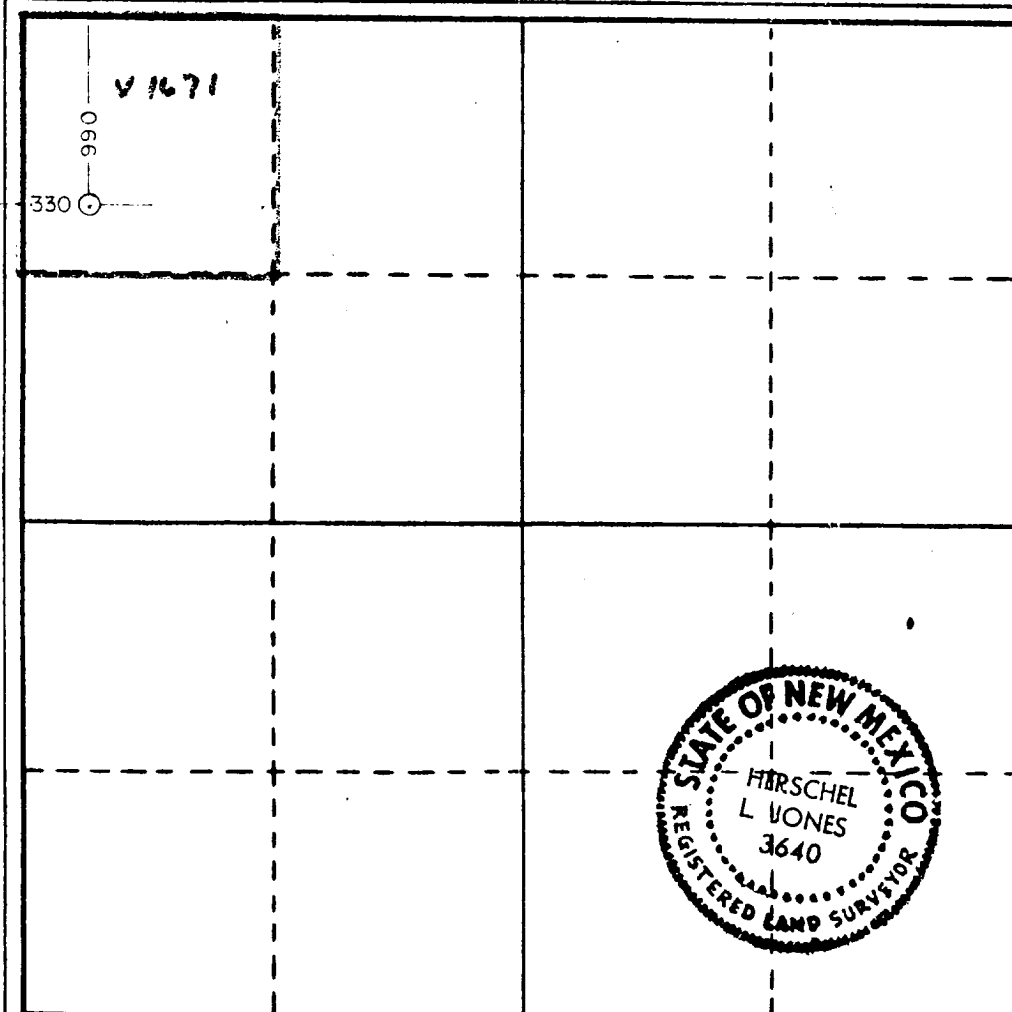

CERTIFICATION

I hereby certify that the information contained herein is true and complete to the best of my knowledge and belief.

Clifton R. May

Name
Clifton R. May

Position
Regulatory Agent

Company
Yates Petroleum Corporation

Date
July 9, 1987

I hereby certify that the well location shown on this plat was plotted from field notes of actual surveys made by me or under my supervision, and that the same is true and correct to the best of my knowledge and belief.

Date Surveyed
July 8, 1987

Registered Professional Engineer and/or Land Surveyor

Herschel L Vones
Certificate No. 3640

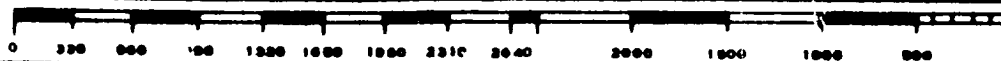
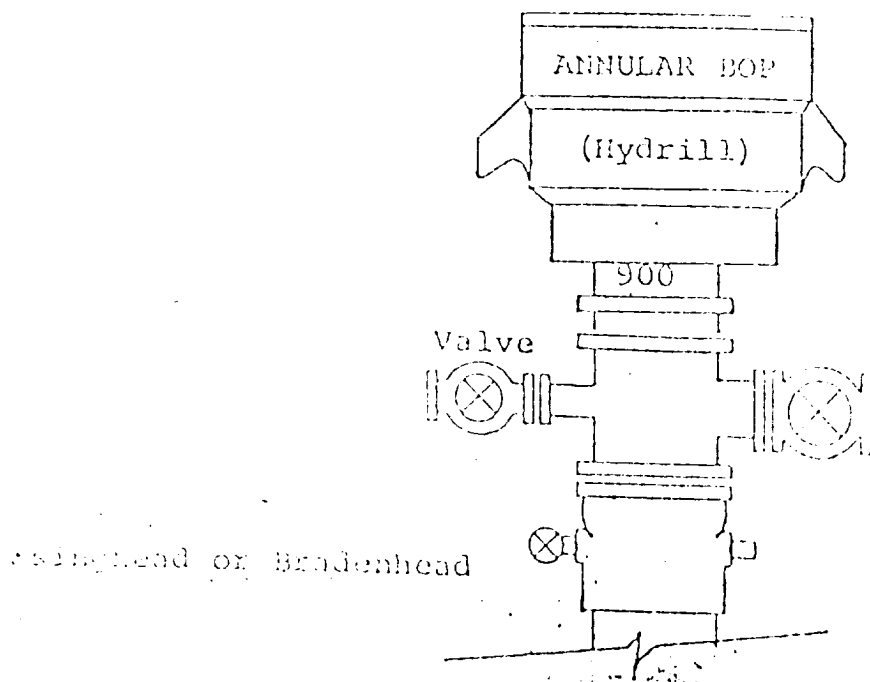

EXHIBIT B

BOP DIAGRAM

RATED 3000[#]



RECEIVED
JUL 10 1987
OCD
HOBBS OFFICE

173