

STATE OF NEW MEXICO
ENERGY AND MINERALS DEPARTMENT

LAND CONSERVATION DIVISION
P. O. BOX 2088
SANTA FE, NEW MEXICO 87501

50-025-30175
Form C-101
Revised 10-1-78

NO. OF COPIES RECEIVED	
DISTRIBUTION	
SAN TA FE	
FILE	
U.S.G.S.	
LAND OFFICE	
OPERATOR	

5A. Indicate Type of Lease	
STATE <input checked="" type="checkbox"/>	FEE <input type="checkbox"/>
5. State Oil & Gas Lease No.	
LC-3345	

APPLICATION FOR PERMIT TO DRILL, DEEPEN, OR PLUG BACK

1a. Type of Work DRILL <input checked="" type="checkbox"/> DEEPEN <input type="checkbox"/> PLUG BACK <input type="checkbox"/>				7. Unit Agreement Name	
b. Type of Well OIL WELL <input checked="" type="checkbox"/> GAS WELL <input type="checkbox"/> OTHER <input type="checkbox"/> SINGLE ZONE <input type="checkbox"/> MULTIPLE ZONE <input type="checkbox"/>				8. Farm or Lease Name Hoover ADR State	
2. Name of Operator Yates Petroleum Corporation				9. Well No. 5	
3. Address of Operator 105 South Fourth Street - Artesia, NM 88210				10. Field and Pool, or Wildcat Sanmal - Queen	
4. Location of Well UNIT LETTER <u>L</u> LOCATED <u>1500</u> FEET FROM THE <u>South</u> LINE AND <u>990</u> FEET FROM THE <u>West</u> LINE OF SEC. <u>1</u> TWP. <u>17S</u> RGE. <u>33E</u> NMPM				12. County Lea	
19. Proposed Depth 3900'		19A. Formation Queen		20. Rotary or C.T. Rotary	
21. Elevations (Show whether DF, RT, etc.) 4150.3' GR		21A. Kind & Status Plug. Bond Blanket		21B. Drilling Contractor Undesignated	
				22. Approx. Date Work will start ASAP	

23.

PROPOSED CASING AND CEMENT PROGRAM

SIZE OF HOLE	SIZE OF CASING	WEIGHT PER FOOT	SETTING DEPTH	SACKS OF CEMENT	EST. TOP
12-1/4"	8-5/8"	24# J-55	Approx. 1550'	1000 sacks	Circulate
7-7/8"	5-1/2"	14# J-55	TD	300 sacks	Adequate cover

We propose to drill and test the Queen formation and intermediate zones. Approximately 1550' of surface casing will be set with cement circulated to surface to shut off gravel and cavings. If productive, 5-1/2" casing will be run and cemented with adequate cover, perforated and stimulated as needed for production.

MUD PROGRAM: Native mud to 1550', brine water to TD

BOP PROGRAM: BOP's will be installed at the offset and tested daily

IN ABOVE SPACE DESCRIBE PROPOSED PROGRAM: IF PROPOSAL IS TO DEEPEN OR PLUG BACK, GIVE DATA ON PRESENT PRODUCTIVE ZONE AND PROPOSED NEW PRODUCTIVE ZONE. GIVE BLOWOUT PREVENTER PROGRAM, IF ANY.

I hereby certify that the information above is true and complete to the best of my knowledge and belief.

Signed Cy Cowan Title Regulatory Agent Date December 3, 1987

(This space for State Use)
ORIGINAL SIGNED BY JERRY SEXTON
DISTRICT 1 SUPERVISOR

APPROVED BY _____ TITLE _____ DATE DEC 31 1987

CONDITIONS OF APPROVAL, IF ANY:

Permit Expires 6 Months From Approval
Date Unless Drilling Underway.

MSL 2454

RECEIVED

DEC 4 1987

ODD
NOTES & FILE

**NEW MEXICO OIL CONSERVATION COMMISSION
WELL LOCATION AND ACREAGE DEDICATION PLAT**

Form C-102
Supersedes C-128
Effective 1-4-85

All distances must be from the outer boundaries of the Section.

Operator YATES PETROLEUM CORPORATION			Lease HOOVER ADR STATE		Well No. 5
Unit Letter L	Section 1	Township 17S	Range 33E	County LEA	
Actual Footage Location of Well: <div style="display: flex; justify-content: space-between;"> 1500 feet from the South line and 990 feet from the West line </div>					
Ground Level Elev. 4150.3'	Producing Formation		Dedicated Acreage: Acres		

1. Outline the acreage dedicated to the subject well by colored pencil or hatchure marks on the plat below.
2. If more than one lease is dedicated to the well, outline each and identify the ownership thereof (both as to working interest and royalty).
3. If more than one lease of different ownership is dedicated to the well, have the interests of all owners been consolidated by communitization, unitization, force-pooling, etc?

☐ Yes ☐ No If answer is "yes," type of consolidation _____

If answer is "no," list the owners and tract descriptions which have actually been consolidated. (Use reverse side of this form if necessary.) _____

No allowable will be assigned to the well until all interests have been consolidated (by communitization, unitization, forced-pooling, or otherwise) or until a non-standard unit, eliminating such interests, has been approved by the Commission.

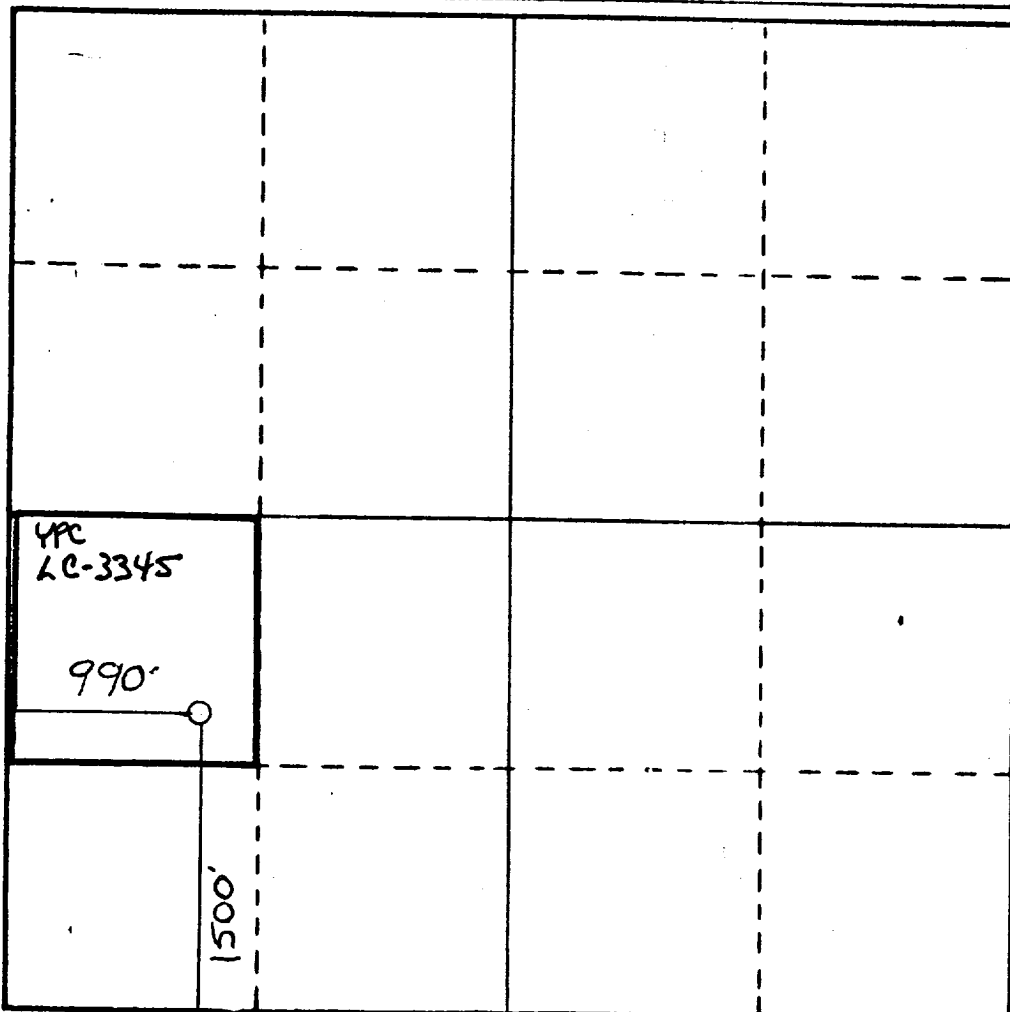

CERTIFICATION

I hereby certify that the information contained herein is true and complete to the best of my knowledge and belief.

Cy Cowan

Name

Cy Cowan

Position

Regulatory Agent

Company

Yates Petroleum Corporation

Date

December 3, 1987

I hereby certify that the well location shown on this plat was plotted from field notes of actual surveys made by me or under my supervision, and that the same is true and correct to the best of my knowledge and belief.

December 3, 1987

Date Signed

REGISTERED PROFESSIONAL SURVEYOR
and/or LAND SURVEYOR
3640

[Signature]
Certificate No. 3640



RECEIVED

DEC 4 1997

100
HARRIS COUNTY

EXHIBIT B
BDP DIAGRAM
RATED 3000[#]

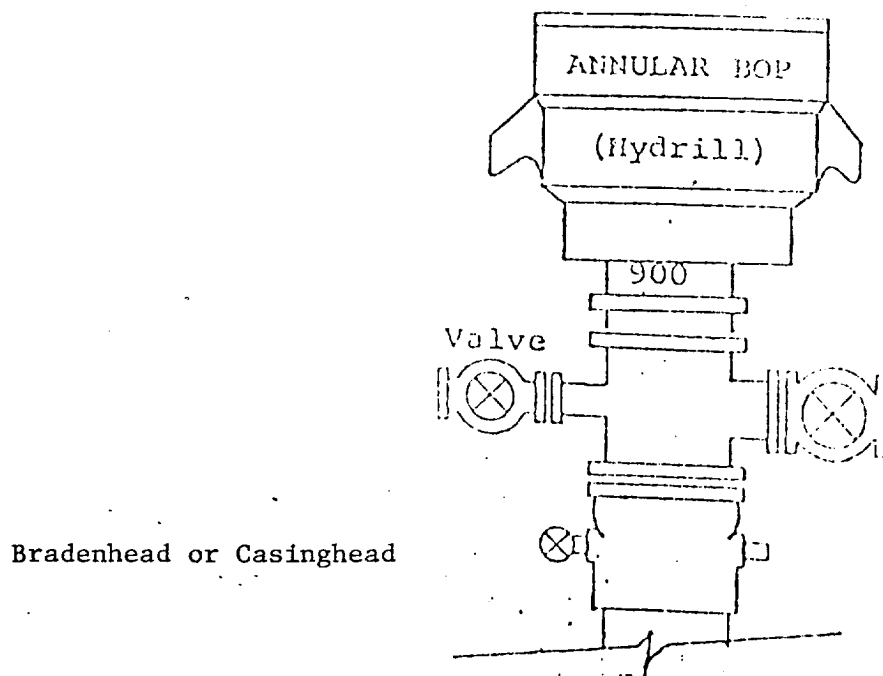

Rec'd 3/23/88

ETI

RECEIVED

DEC 4 1997

REC'D 12/4/97