

MEXICO OIL CONSERVATION COMMISSION
WELL LOCATION AND ACREAGE DEDICATION PLAT

Form C-102
 Supersedes C-128
 Effective 1-1-65

All distances must be from the outer boundaries of the Section.

Operator Santa Fe Energy Resources, Inc.			Lease Humble Hume 5 State		Well No. 1
Unit Letter W	Section 5	Township 16-South	Range 34-East	County Lea	
Actual Footage Location of Well: <div style="display: flex; justify-content: space-between;"> 660 feet from the South line and 1980 feet from the East line </div>					
Ground Level Elev. 4137.8'	Producing Formation San Andres	Pool Wildcat (San Andres)	Dedicated Acreage: 40 Acres		

1. Outline the acreage dedicated to the subject well by colored pencil or hatchure marks on the plat below.
2. If more than one lease is dedicated to the well, outline each and identify the ownership thereof (both as to working interest and royalty).
3. If more than one lease of different ownership is dedicated to the well, have the interests of all owners been consolidated by communitization, unitization, force-pooling, etc?

☐ Yes ☐ No If answer is "yes," type of consolidation _____

If answer is "no," list the owners and tract descriptions which have actually been consolidated. (Use reverse side of this form if necessary.) _____

No allowable will be assigned to the well until all interests have been consolidated (by communitization, unitization, forced-pooling, or otherwise) or until a non-standard unit, eliminating such interests, has been approved by the Commission.

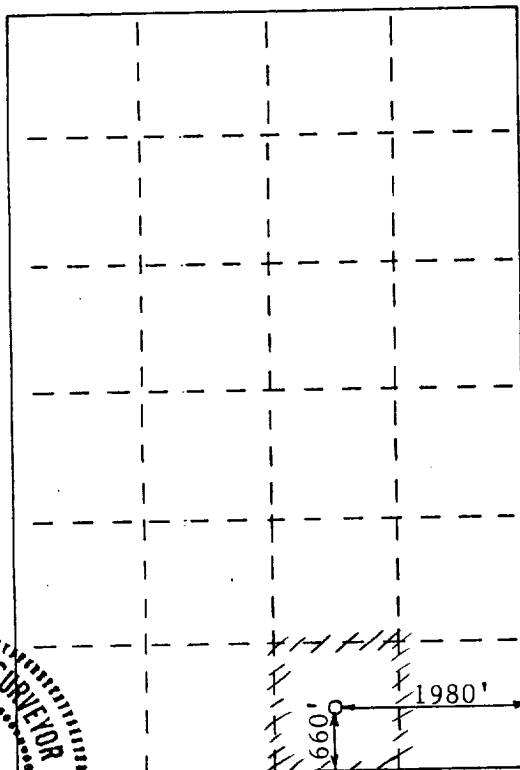

Scale 1"=2000'

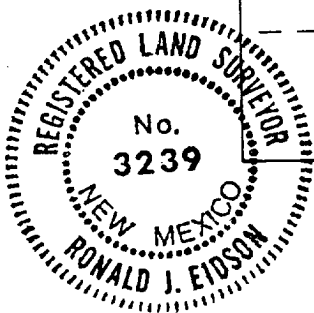

CERTIFICATION

I hereby certify that the information contained herein is true and complete to the best of my knowledge and belief.

Name
Terry McCullough

Position
Sr. Production Clerk

Company
Santa Fe Energy Resources, Inc

Date
April 3, 1998

I hereby certify that the well location shown on this plat was plotted from field notes of actual surveys made by me or under my supervision, and that the same is true and correct to the best of my knowledge and belief.

Date Surveyed
January 5, 1988

Registered Professional Engineer and/or Land Surveyor

Ronald J. Eidson

Certificate No. **JOHN W. WEST 676**
Ronald J. Eidson 3239

**NEW MEXICO OIL CONSERVATION COMMISSION
WELL LOCATION AND ACREAGE DEDICATION PLAT**

Form C-102
Supersedes C-128
Effective 1-1-65

All distances must be from the outer boundaries of the Section.

Operator Santa Fe Energy Operating Partners, LP			Lease Humble Hume 5 State		Well No. 1
Unit Letter W	Section 5	Township 16-South	Range 34-East	County Lea	
Actual Footage Location of Well: 660 feet from the South line and 1980 feet from the East line					
Ground Level Elev. 4137.8'	Producing Formation Wolfcamp		Pool North Hume Wolfcamp		Dedicated Acreage: 160 Acres

1. Outline the acreage dedicated to the subject well by colored pencil or hachure marks on the plat below.
2. If more than one lease is dedicated to the well, outline each and identify the ownership thereof (both as to working interest and royalty).
3. If more than one lease of different ownership is dedicated to the well, have the interests of all owners been consolidated by communitization, unitization, force-pooling, etc?

☒ Yes ☐ No If answer is "yes," type of consolidation Communitization

If answer is "no," list the owners and tract descriptions which have actually been consolidated. (Use reverse side of this form if necessary.) _____

No allowable will be assigned to the well until all interests have been consolidated (by communitization, unitization, forced-pooling, or otherwise) or until a non-standard unit, eliminating such interests, has been approved by the Commission.

160 ac. sp. eff. 7-1-88 R-8476.1

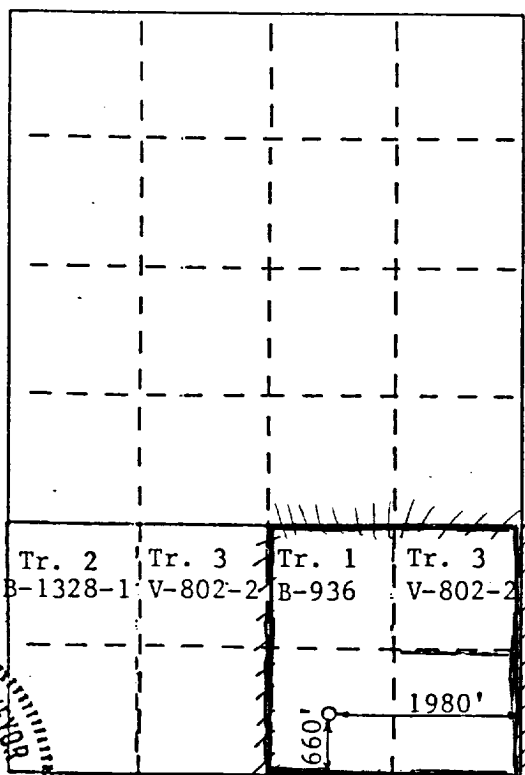

See Back for
Ownership

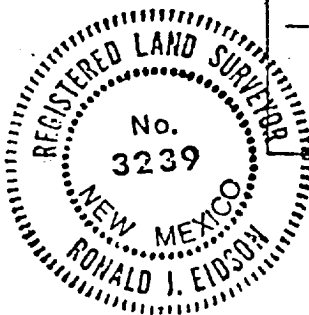

Scale 1"=2000'

CERTIFICATION

I hereby certify that the information contained herein is true and complete to the best of my knowledge and belief.

Thomas E. Gentry
Name

Thomas E. Gentry

Position

District Operations Manager

Company **SANTA FE ENERGY
OPERATING PARTNERS, LP**

Date

6-17-88

I hereby certify that the well location shown on this plat was plotted from field notes of actual surveys made by me or under my supervision, and that the same is true and correct to the best of my knowledge and belief.

Date Surveyed

January 5, 1988

Registered Professional Engineer
and/or Land Surveyor

Ronald J. Eidson

Certificate No. **JOHN W. WEST 876**

Ronald J. Eidson 3239

Ownership:

- Tract 1: State of New Mexico Lease (B-936)
Exxon - 100% Working Interest
State of New Mexico - 12.5% Royalty Interest
- Tract 2: State of New Mexico Lease (B-1328-1)
Texaco Producing, Inc. - 100% Working Interest
State of New Mexico - 12.5% Royalty Interest
- Tract 3: State of New Mexico Lease (V-802-2)
Santa Fe Energy Operating Partners, L.P. - 100% Working Interest
State of New Mexico - 16.667% Royalty Interest

RECORDED

JUN 20 1988

OCD

MOBBS OFFICE

**NEW MEXICO OIL CONSERVATION COMMISSION
WELL LOCATION AND ACREAGE DEDICATION PLAT**

Form C-102
Supersedes C-128
Effective 1-1-65

All distances must be from the outer boundaries of the Section.

Operator Santa Fe Energy Operating Partners, LP			Lease Humble Hume 5 State		Well No. 1
Unit Letter W	Section 5	Township 16-South	Range 34-East	County Lea	
Actual Footage Location of Well: 660 feet from the South line and 1980 feet from the East line					
Ground Level Elev. 4137.8'	Producing Formation Morrow		Pool Hume Morrow		Dedicated Acreage: 80 Acres

1. Outline the acreage dedicated to the subject well by colored pencil or hachure marks on the plat below.
2. If more than one lease is dedicated to the well, outline each and identify the ownership thereof (both as to working interest and royalty).
3. If more than one lease of different ownership is dedicated to the well, have the interests of all owners been consolidated by communitization, unitization, force-pooling, etc?

☒ Yes ☐ No If answer is "yes," type of consolidation Communitization

If answer is "no," list the owners and tract descriptions which have actually been consolidated. (Use reverse side of this form if necessary.) _____

No allowable will be assigned to the well until all interests have been consolidated (by communitization, unitization, forced-pooling, or otherwise) or until a non-standard unit, eliminating such interests, has been approved by the Commission.

Tr. 2 B-1328-1	Tr. 3 V-802-2	Tr. 1 B-936	Tr. 3 V-802-2
-------------------	------------------	----------------	------------------

See Back for
Ownership

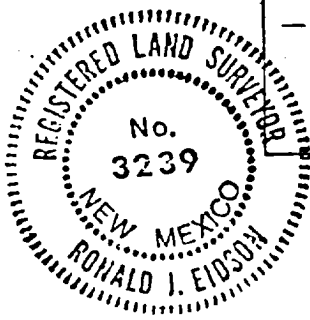

Scale 1"=2000'

CERTIFICATION

I hereby certify that the information contained herein is true and complete to the best of my knowledge and belief.

Thomas E. Gentry
Name

Thomas E. Gentry

Position

District Operations Manager

Company **SANTA FE ENERGY
OPERATING PARTNERS, LP**

Date

4-22-88

I hereby certify that the well location shown on this plat was plotted from field notes of actual surveys made by me or under my supervision, and that the same is true and correct to the best of my knowledge and belief.

Date Surveyed

January 5, 1988

Registered Professional Engineer
and/or Land Surveyor

Ronald J. Eidson

Certificate No. **JOHN W. WEST 67**

Ronald J. Eidson

Ownership:

- Tract 1: State of New Mexico Lease (B-936)
Exxon - 100% Working Interest
State of New Mexico - 12.5% Royalty Interest
- Tract 2: State of New Mexico Lease (B-1328-1)
Texaco Producing, Inc. - 100% Working Interest
State of New Mexico - 12.5% Royalty Interest
- Tract 3: State of New Mexico Lease (V-802-2)
Santa Fe Energy Operating Partners, L.P. - 100% Working Interest
State of New Mexico - 16.667% Royalty Interest

RECEIVED
APR 25 1988
OCD
HOBBS OFFICE

WRS COMPLETION REPORT

COMPLETIONS
PI# 30-T-0008 05/09/88 SEC 5 TWP 16S RGE 34E
30-025-30201-0000 PAGE 1

NMEX LEA * 660FSL 1980FEL SEC
STATE COUNTY FOOTAGE
SANTA FE ENERGY SPOT
OPERATOR 1 D DO
WELL NO. 1 HUMBLE-HUME "5" STATE
WELL CLASS INIT FIN
4150KB 4138GR LEASE NAME
OPER ELEV HUME N

LEASE TYPE/NO. API 30-025-30201-0000
SPUD DATE 01/26/1988 04/18/1988 ROTARY FIELD POOL AREA
COMP. DATE TYPE TOOL OIL
13300 WOLFCAMP WILLBROS DRLG 6 STATUS
PROJ. DEPTH PROJ. FORM CONTRACTOR RIG SUB 11
DTD 13010 PB 12415 FM/TD MSSP
DRILLERS T.D. LOG T.D. PLUG BACK TD OLD T.D. FORM T.D.

LOCATION DESCRIPTION

IRREG SEC
12 MI NE MALJAMAR, NM

WELL IDENTIFICATION/CHANGES

FIELD CHGD FROM HUME
PROJ FM CHGD FROM MORROW

CASING/LINER DATA

CSG 13 3/8 @ 456 W/ 475 SACKS
CSG 8 5/8 @ 4452 W/ 2500 SACKS
CSG 5 1/2 @ 13010 W/ 3200 SACKS

TUBING DATA

TBG 2 3/8 AT 9954

INITIAL POTENTIAL

IPF 544BOPD 370 MCFD
WOLFCAMP PERF W/ 37/IT 10070-10087 24HRS
PERF 10070-10087
TP 493
GTY 42.9 GOR 680
CP PKR
FLWD THRU VAR CHK

CONTINUED IC# 300257001688

Copyrighted 1988
Petroleum
Information Corporation

Petroleum Information

BB a company of
The Dun & Bradstreet Corporation

Pi-WRS-GET
Form No 167

COMPLETIONS SEC 5 TWP 16S RGE 34E
 PI# 30-T-0008 05/09/88 30-025-30201-0000 PAGE 2

SANTA FE ENERGY
 1

HUMBLE-HUME "5" STATE

D DO

TYPE	FORMATION	LTH	TOP DEPTH/SUB	BSE DEPTH/SUB
LOG	SVN RVRS		3506 632	
LOG	SN ANDRS		4452 -314	
LOG	TUBB		9043 -4905	
LOG	WOLFCAMP		9566 -5428	
LOG	STRAWN		11857 -7719	
LOG	ATOKA		12136 -7998	
LOG	MORROW		12486 -8348	
LOG	MSSP		12914 -8776	

SUBSEA MEASUREMENTS FROM GR

PRODUCTION TEST DATA

MORROW PERF W/ 50/IT 12487-12610 GROSS
 PERF 12487-12496 12604-12610
 ACID 12487-12610 1000GALS
 7 1/2%
 BRPG 12487-12610 DEPTH 12450

LOGS AND SURVEYS /INTERVAL, TYPE/

LOGS	DLL	BHCS	DI
LOGS	NEUT		

DRILLING PROGRESS DETAILS

SANTA FE ENERGY
 500 W ILLINOIS
 MIDLAND, TX 79701
 915-687-3551
 01/14 LOC/1988/
 02/02 DRLG 4451
 02/08 DRLG 5969
 02/23 DRLG 10524
 03/01 DRLG 12180
 03/08 13010 TD, CIRC
 03/31 13010 TD, WOCT
 04/21 13010 TD, PB 12415, WOCT
 05/02 TD REACHED 03/08/88 RIG REL 03/09/88
 13010 TD, PB 12415
 COMP 4/18/88, IPF 544 BO, 370 MCFGPD, VAR
 CK, GOR 680, GTY 42.9, CP
 PKR, FTP 493

CONTINUED

COMPLETIONS SEC 5 TWP 16S RGE 34E
PI# 30-T-0008 05/09/88 30-025-30201-0000 PAGE 3

SANTA FE ENERGY HUMBLE-HUME "5" STATE D DO
1

DRILLING PROGRESS DETAILS

PROD ZONE - WOLFCAMP 10070-10087
NO CORES OR DSTS RPTD