

NEW MEXICO OIL CONSERVATION COMMISSION  
WELL LOCATION AND ACREAGE DEDICATION PLAT

Form O-102  
Supersedes O-128  
Effective 10-65

All distances must be from the outer boundaries of the Section

Operator Santo Oil Company			Lease State 15		Well No.
Section Letter P	Section 35	Township 15 South	Range 37 East	County Lea	
Approximate location of well: 600 feet from the south line and 660 feet from the east line					
Ground Level Elev. 3753.9	Producing Formation Lower Strawn	Pool Shipp Strawn	Estimated Acreage ESEL 80		

1. Outline the acreage dedicated to the subject well by colored pencil or hatchure marks on the plat below.
2. If more than one lease is dedicated to the well, outline each and identify the ownership thereof (both as to working interest and royalty).
3. If more than one lease of different ownership is dedicated to the well, have the interests of all owners been consolidated by communitization, unitization, force-pooling, etc?

☐ Yes ☐ No If answer is "yes," type of consolidation \_\_\_\_\_

If answer is "no," list the owners and tract descriptions which have actually been consolidated. (Use reverse side of this form if necessary.) \_\_\_\_\_

No allowable will be assigned to the well until all interests have been consolidated (by communitization, unitization, forced-pooling, or otherwise) or until a non-standard unit, eliminating such interests, has been approved by the Commission.



CERTIFICATION

I hereby certify that the information contained herein is true and complete to the best of my knowledge and belief.

T.C. Rooney

Name

SR. PERMIT SPECIALIST

Position

SANTO PETROLEUM CO

Company

2/29/88

Date

I hereby certify that the well location shown on this plat was plotted from field notes of actual surveys made by me or under my supervision, and that the same is true and correct to the best of my knowledge and belief.

Date Surveyed

February 14, 1988

Registered Professional Engineer and Land Surveyor

*John W. West*

Certificate No. JOHN W. WEST, 676

RONALD J. EIDSON, 3239

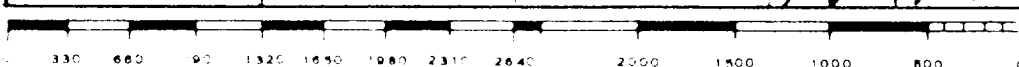
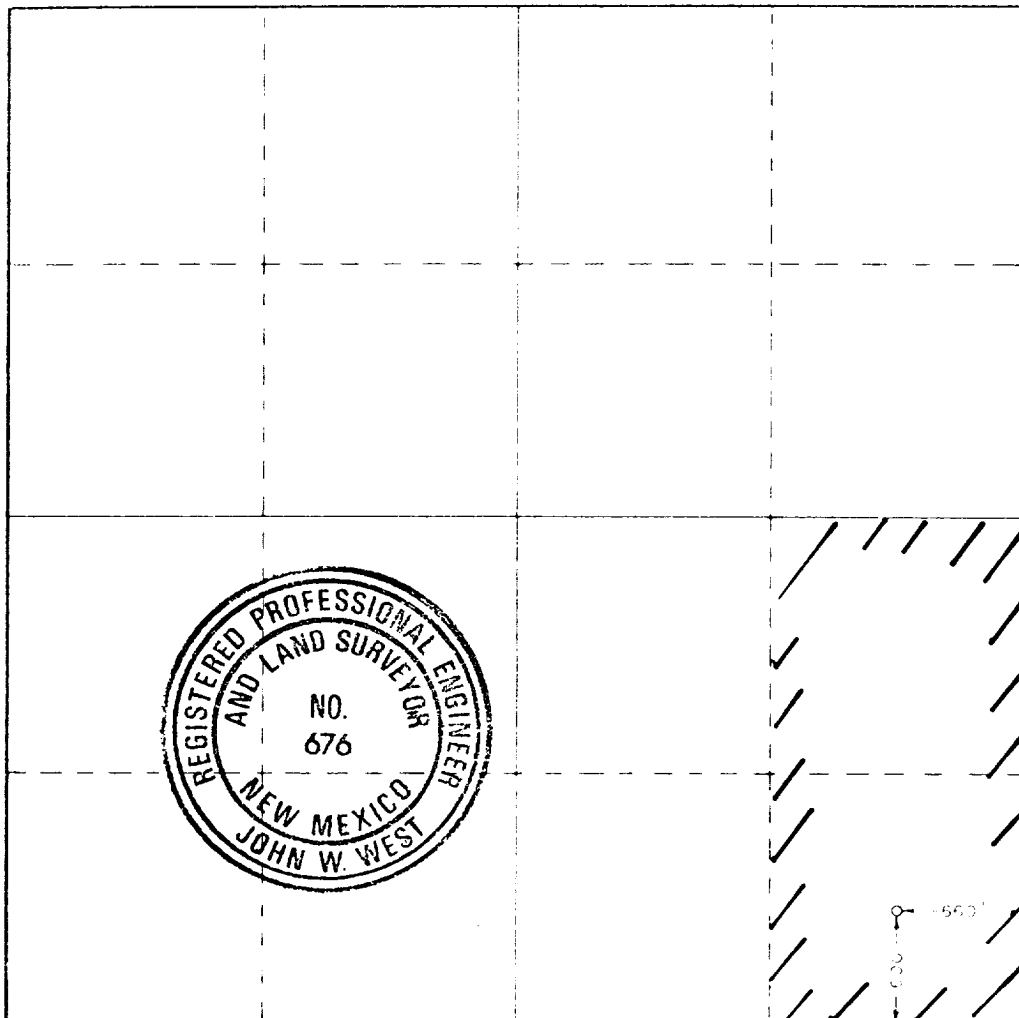

4-29-88  
EET

RECEIVED

MAR 1 - 1988

OCD  
HOBS OFFICE