

**NEW MEXICO OIL CONSERVATION COMMISSION
WELL LOCATION AND ACREAGE DEDICATION PLAT**

Form C-102
Supersedes C-128
Effective 1-1-65

All distances must be from the outer boundaries of the Section.

Operator FORAN OIL COMPANY			Lease Rouse 5 A		Well No. 1-5
Unit Letter K	Section 5	Township 16. SOUTH	Range 36. EAST	County LEA	
Actual Footage Location of Well: <div style="display: flex; justify-content: space-between;"> 3950 feet from the NORTH line and 1550 feet from the WEST line </div>					
Ground Level Elev. 3941.0	Producing Formation <i>Marathon</i>	Pool <i>wildcat</i>	Dedicated Acreage: 320 Acres		

1. Outline the acreage dedicated to the subject well by colored pencil or hachure marks on the plat below.
2. If more than one lease is dedicated to the well, outline each and identify the ownership thereof (both as to working interest and royalty).
3. If more than one lease of different ownership is dedicated to the well, have the interests of all owners been consolidated by communitization, unitization, force-pooling, etc?

NM Oil Conservation Order No. R-8616
Case No. 9289 Effective 3/23/88

☒ Yes ☐ No If answer is "yes," type of consolidation

R-8616A

If answer is "no," list the owners and tract descriptions which have actually been consolidated. (Use reverse side of this form if necessary.) _____

No allowable will be assigned to the well until all interests have been consolidated (by communitization, unitization, forced-pooling, or otherwise) or until a non-standard unit, eliminating such interests, has been approved by the Commission.

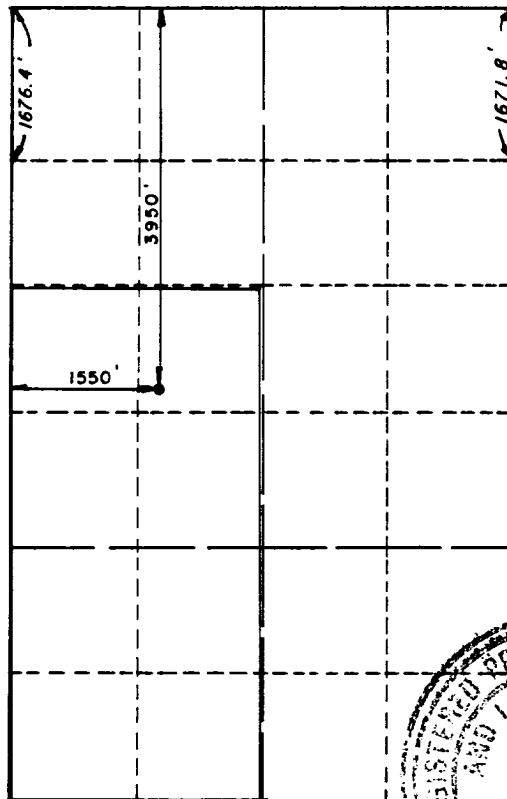

SCALE
1" = 2000'



CERTIFICATION

I hereby certify that the information contained herein is true and complete to the best of my knowledge and belief.

Name *RA Cawston*
 Position **Landman**
 Company **Foran Oil Company**
 Date **April 15, 1988**

I hereby certify that the well location shown on this plat was plotted from field notes of actual surveys made by me or under my supervision, and that the same is true and correct to the best of my knowledge and belief.

Date Surveyed **DECEMBER 4, 1987**

Registered Professional Engineer and/or Land Surveyor

John W. West
 Certificate No. **JOHN W. WEST 676**
Ronald J. Eidson 3239

RECEIVED
APR 18 1988
OCD
HOBBS OFFICE

6/24/88
HOBBS
173