

Pool BAISH WOLFCAMP

Operator Conoco Inc.

Lease Baish "A"

Well No. 14

Unit

D

**S**

22

T

17

R 32

[illegible]

Lease \_\_\_\_\_ Well No. \_\_\_\_\_ Unit \_\_\_\_\_ S \_\_\_\_\_ T \_\_\_\_\_ R \_\_\_\_\_

[illegible]

COMPLETIONS  
PI# 30-T-0015 03/13/89 SEC 22 TWP 17S RGE 32E  
30-025-30363-0001 PAGE 2  
D X DO

CONOCO INC  
14

BAISH "A" FEDERAL

DRILLING PROGRESS DETAILS

505-393-4141  
OWWO: OLD INFO: FORMERLY CONOCO INC #14 BAISH  
"A" FEDERAL. ELEV 4006 GR. SPUD 7/13/88. 13  
3/8 @ 858 W/560 SX, 9 5/8 @ 4510 W/1865 SX, ABO  
7 @ 10000 W/1700 SX. LOG TOPS: TUBB 6833, ABO  
7583, WOLFCAMP. OTD 10000, PB 9970. COMP  
11/3/88. IPP 34 BO, 155 MCFG26 BWP. PROD ZONE:  
WOLFCAMP 9040-9906.  
FIELD: MALJAMAR & BAISH  
PROJ FM: ABO & WOLFCAMP  
LOC/1989/  
10000 TD, PB 9970  
COMP 2/14/89, IPP 3 BO, 10 MCFG, 7 BWP,  
GOR (NR), GTY (NR)  
PROD ZONE - ABO 8932-8934  
COMP 11/3/88, NO NEW POTENTIAL  
PROD ZONE - WOLFCAMP 9040-9906  
(DUAL PRODUCER)  
FIRST REPORT & COMPLETION

# WRS COMPLETION REPORT

COMPLETIONS  
PI# 30-T-0015 03/13/89 SEC 22 TWP 17S RGE 32E  
30-025-30363-0001  
STATE NMEX LEA COUNTY \* 810FNL 500FWL SEC NW NW  
CONOCO INC OPERATOR FOOTAGE PAGE 1  
WELL NO 14  
4006GR OPER ELEV  
BAISH "A" FEDERAL LEASE NAME  
WELL CLASS INIT FIN

SPUD DATE 01/14/1989 02/14/1989 LEASE TYPE/NO MALJAMAR  
9970 ABO COMP DATE WO-UNIT API 30-025-30363-0001  
PROJ DEPTH PROJ FORM NOT RPTD PERMIT OR WELL I.D. NO  
DTD 10000 CONTRACTOR PB 9970 OTD 10000 FM/TD WOLFCAMP  
DRILLERS T.D. LOG T.D. PLUG BACK TD OLD T.D. STATUS 201LWO  
LOCATION DESCRIPTION FORM T.D.

2 1/2 MI S MALJAMAR, NM  
REMEDIAL SIDETRACK HOLE DATA  
ORIGINAL HOLE TD 10000

IPP ABO 3BOPD PERF 10 MCFD 7BW INITIAL POTENTIAL  
IPP 1UO 8932- 8934 24HRS  
WOLFCAMP PERF 1 UG GTY, GOR-NO DETAIL  
W/ 204/IT 9040- 9906 GROSS 24HRS

ABO PERF 8932- 8934 8940- 8944 8932- 8952 GROSS  
ACID 8932- 8952 500GALS 8950- 8952  
SQZD W/ 450S 8940- 8952  
SQZD & DOC

DRILLING PROGRESS DETAILS  
CONOCO INC  
BOX 460  
HOBBS, NM 88240

Copyrighted 1985  
Petroleum  
Information Corporation

CONTINUED IC# 300257007189  
Petroleum Information  
a company of  
The Dun & Bradstreet Corporation

PI WRS-GET  
Form No 187

NEW MEXICO OIL CONSERVATION COMMISSION  
WELL LOCATION AND ACREAGE DEDICATION PLAT

NMOC - Hobbs

Form C-102  
Supersedes C-128  
Effective 1-1-65

All distances must be from the outer boundaries of the Section.

Operator Conoco, Inc.			Lease Baish "A"		Well No. 14
Unit Letter D	Section 22	Township 17 South	Range 32 East	County Lea	
Actual Footage Location of Well: 810 feet from the North line and 500 feet from the West line					
Ground Level Elev. 4006	Producing Formation Abo / Wolfcamp		Pool Maljamar Abo / Baish Wolfcamp	Dedicated Acreage: 80 Acres	

- Outline the acreage dedicated to the subject well by colored pencil or hachure marks on the plat below.
- If more than one lease is dedicated to the well, outline each and identify the ownership thereof (both as to working interest and royalty).
- If more than one lease of different ownership is dedicated to the well, have the interests of all owners been consolidated by communitization, unitization, force-pooling, etc?

☐ Yes ☒ No If answer is "yes," type of consolidation \_\_\_\_\_

If answer is "no," list the owners and tract descriptions which have actually been consolidated. (Use reverse side of this form if necessary.) \_\_\_\_\_

No allowable will be assigned to the well until all interests have been consolidated (by communitization, unitization, forced-pooling, or otherwise) or until a non-standard unit, eliminating such interests, has been approved by the Commission.

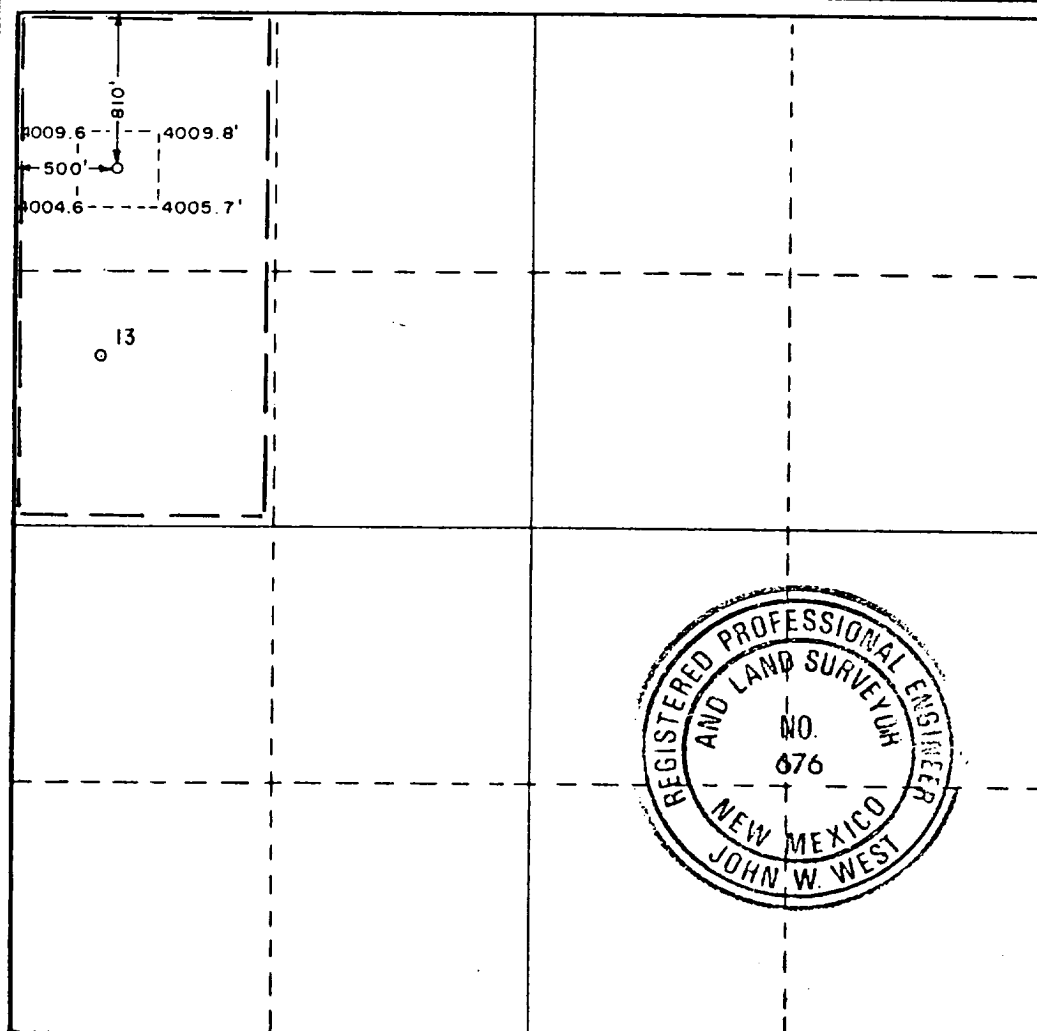

CERTIFICATION

I hereby certify that the information contained herein is true and complete to the best of my knowledge and belief.

Name D.F. Finney  
Position Adm. Supervisor  
Company Conoco Inc.

Date 4/28/88

I hereby certify that the well location shown on this plat was plotted from field notes of actual surveys made by me or under my supervision, and that the same is true and correct to the best of my knowledge and belief.

Date Surveyed March 14, 1988

Registered Professional Engineer and/or Land Surveyor

Certificate No. JOHN W. WEST, 676  
RONALD J. EIDSON, 3239



GARREY CARRUTHERS  
GOVERNOR

STATE OF NEW MEXICO  
ENERGY, MINERALS AND NATURAL RESOURCES DEPARTMENT  
OIL CONSERVATION DIVISION  
HOBBS DISTRICT OFFICE

April 25, 1988

POST OFFICE BOX 1980  
HOBBS, NEW MEXICO 88241-1980  
(505) 393-6161

Conoco Inc.  
P.O. Box 460  
Hobbs, NM 88240

Attn: D.F. Finney

Re: Baish A Well #14-D  
Section 22, T17S, R32E  
Proposed Multiple Completion in  
Maljamar-Abo Pool and Baish-Wolfcamp Pool

Gentlemen:

We have this date received a copy of your application for permit to drill the above-referenced well which has been approved by the BLM.

It is noted both the referenced pools are on 80-acre spacing with first well to be located within 150 feet of the center of the NE or SW quarter/quarter. Your location, 810/N and 500/W, is unorthodox in respect to the 150 feet from center. You did not submit an 80-acre plat so we do not know what acreage you plan to dedicate, but it appears it may be sharing with #13-E (which has the W/2 of NW/4 dedicated). If this is the case, this will be second well on 80-acre proration unit and the qtr/qtr section will not be a factor.

Please submit revised Form C-102, outlining the appropriate dedicated acreage. If this well shares with #13-E, please so indicate.

Also, prior to completion of the well as a dual you must have Form C-107, Application for Multiple Completion, approved.

If you have questions, concerning this matter, please contact Evelyn Downs at 393-6161.

Very truly yours,

OIL CONSERVATION DIVISION

Jerry Sexton  
Supervisor, District I

JS/ed