

30-025-30410

NO. OF COPIES RECEIVED	
DISTRIBUTION	
SANTA FE	
FILE	
U.S.G.S.	
LAND OFFICE	
OPERATOR	

NEW MEXICO OIL CONSERVATION COMMISSION

Form C-101
Revised 1-1-85

5A. Indicate Type of Lease	
STATE <input checked="" type="checkbox"/>	FEE <input type="checkbox"/>
5. State Oil & Gas Lease No. LG-3362	

APPLICATION FOR PERMIT TO DRILL, DEEPEN, OR PLUG BACK

1a. Type of Work DRILL <input checked="" type="checkbox"/> DEEPEN <input type="checkbox"/> PLUG BACK <input type="checkbox"/>		7. Unit Agreement Name
b. Type of Well OIL WELL <input checked="" type="checkbox"/> GAS WELL <input type="checkbox"/> OTHER <input type="checkbox"/> SINGLE ZONE <input type="checkbox"/> MULTIPLE ZONE <input type="checkbox"/>		8. Farm or Lease Name Kriti State 31
2. Name of Operator Mobil Producing TX. & N.M. Inc.		9. Well No. 1
3. Address of Operator c/o Mobil Exploration & Producing U.S. Inc. P. O. Box 633, Midland, Texas 79702		10. Field and Pool or Well Location Undesignated South Shore Upper Penn
4. Location of Well UNIT LETTER M LOCATED 660 FEET FROM THE South LINE AND 660' FEET FROM THE West LINE OF SEC. 31 TWP. 16S RGE. 36E NMPM		12. County Lea
19. Proposed Depth 11,400		19A. Formation Upper Penn
20. Rotary or C.T. Rotary		21. Elevations (Show whether DF, RT, etc.) 3931 feet
21A. Kind & Status Plug. Bond Active Bond		21B. Drilling Contractor Unknown
22. Approx. Date Work will start 7/20/88		

23.

PROPOSED CASING AND CEMENT PROGRAM

SIZE OF HOLE	SIZE OF CASING	WEIGHT PER FOOT	SETTING DEPTH	SACKS OF CEMENT	EST. TOP
17-1/2	13-3/8	48.0#	450	(1) 500	Surface
11	8-5/8	32.0#	5200	(2) 2250	Surface
7-7/8	5-1/2	15.5# & 17.0#	4900-10,900	(3) 1475	4900

CEMENT PROGRAM

- 500 sxs. Class "C" + CaCl₂
- Lead 2000 sxs. H + SIL + SALT
Tail 250 Class "C" + Add
- Lead 1200 sxs. H + SILICA
Tail 275 sxs. Class "H" + LAP

LOGGING PROGRAM

TYPE	INTERVAL
DLL/MSFL/GR/CAL	5200-2000
CNL/LDT/GR/CAL	5200-SURF
BHC SONIC/GR	5200-2000
DIL/SFL/SP/GR	10900-5200
CNL/LDT/GR/CAL	10900-5200
BHC SONIC/GR	10900-5200
SPECTRAL GR	10900-8900

BLOWOUT PREVENTER PROGRAM CASING

SECT	SIZE	DEPTH	BOP SIZE	RATING	MIN. ARE.	CHOKER RATING	TEST
INTR	13 3/8	450	13 5/8	3000	SRR	3000	1000
PROD	9 5/8	5200	11	5000	SRRA	5000	2000

IN ABOVE SPACE DESCRIBE PROPOSED PROGRAM: IF PROPOSAL IS TO DEEPEN OR PLUG BACK, GIVE DATA ON PRESENT PRODUCTIVE ZONE AND PROPOSED NEW PRODUCTIVE ZONE. GIVE BLOWOUT PREVENTER PROGRAM, IF ANY.

I hereby certify that the information above is true and complete to the best of my knowledge and belief.

Signed M. E. Sweeney M. E. Sweeney Title Manager Environmental and Regulatory Date _____

(This space for State Use)

Orig. Signed by
Paul Nautz
Geologist

Mobil Producing Texas & New Mexico Inc.
acting by and through its agent
Mobil Exploration & Producing U.S. Inc.

APPROVED BY _____

TITLE _____

DATE _____

CONDITIONS OF APPROVAL, IF ANY:

Permit Expires 6 Months From Approval
Date Unless Drilling Underway.

STATE OF NEW MEXICO
ENERGY AND MINERALS DEPARTMENT

OIL CONSERVATION DIVISION
P. O. BOX 2088
SANTA FE, NEW MEXICO 87501

Form C-102
Revised 10-1-78

All distances must be from the outer boundaries of the Section.

Operator MOBIL EXPLORATION AND PRODUCING U.S. INC.			Lease KRITI STATE 31		Well No. 1
Unit Letter M	Section 31	Township 16-S	Range 36-E	County LEA	
Actual Footage Location of Well: 660 feet from the SOUTH line and 660 feet from the WEST line					
Ground Level Elev. 3931	Producing Formation Upper Penn	Pool <i>South Shive Low upper Penn</i> Undesignated	Dedicated Acreage: 77.3644 Acres		

1. Outline the acreage dedicated to the subject well by colored pencil or hachure marks on the plat below.
2. If more than one lease is dedicated to the well, outline each and identify the ownership thereof (both as to working interest and royalty).
3. If more than one lease of different ownership is dedicated to the well, have the interests of all owners been consolidated by communitization, unitization, force-pooling, etc?

☐ Yes ☐ No If answer is "yes," type of consolidation _____

If answer is "no," list the owners and tract descriptions which have actually been consolidated. (Use reverse side of this form if necessary.) _____

No allowable will be assigned to the well until all interests have been consolidated (by communitization, unitization, forced-pooling, or otherwise) or until a non-standard unit, eliminating such interests, has been approved by the Division.

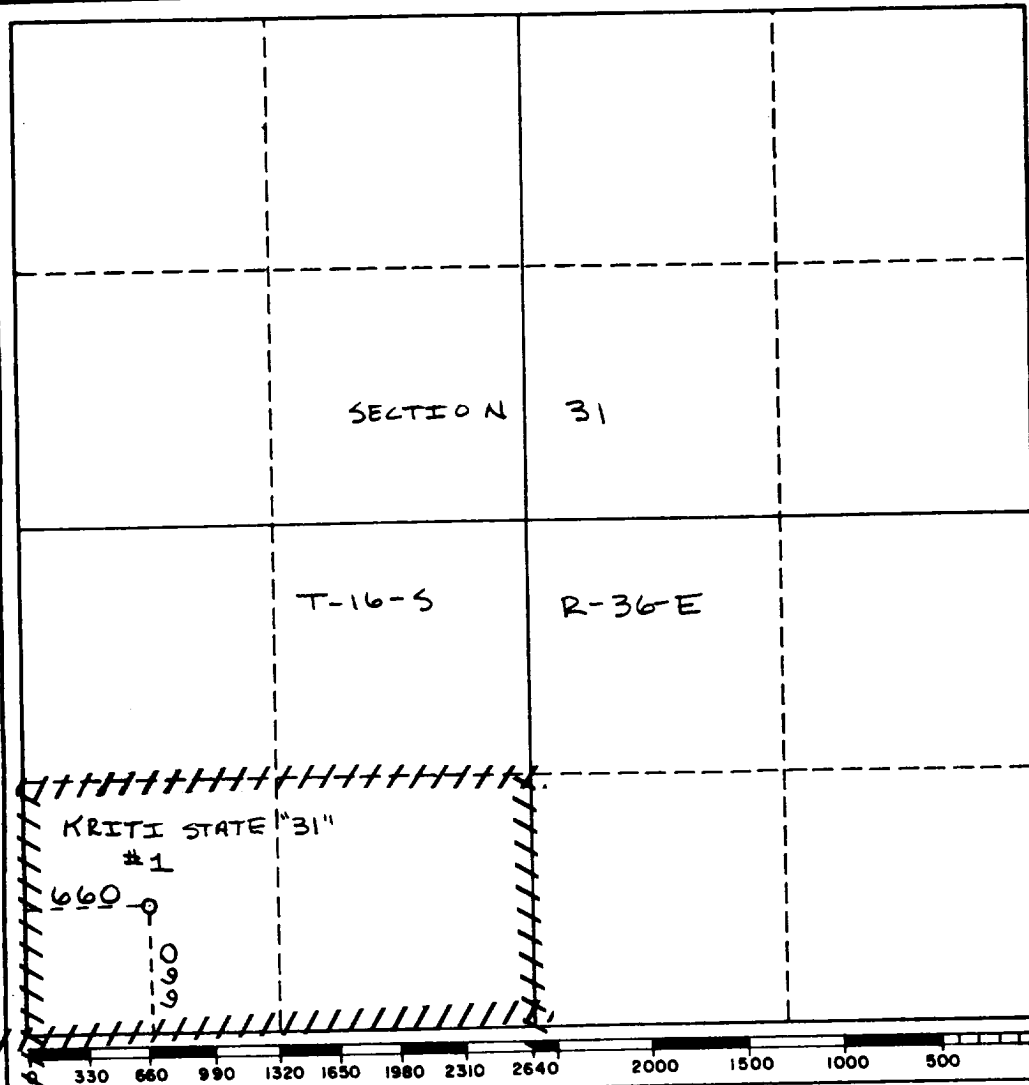

CERTIFICATION

I hereby certify that the information contained herein is true and complete to the best of my knowledge and belief.

M.E. Sweeney
Name M.E. Sweeney
Position Manager Environmental and Regulatory
Company Mobil Producing Texas & New Mexico, Inc.
acting by and through its agent
Mobil Exploration & Producing U.S. Inc.
6/22/88

I hereby certify that the well location shown on this plat was plotted from field notes of actual surveys made by me or under my supervision, and that the same is true and correct to the best of my knowledge.

Date Signed *6/22/88*
Registered Professional Engineer and/or Land Surveyor
Tom [Signature]
Certificate No. 9669

88-2-1182024
EJF

RECEIVED

JUN 14 1988

OFFICE