

30-025-30414

STATE OF NEW MEXICO
ENERGY AND MINERALS DEPARTMENT

OIL CONSERVATION DIVISION
P. O. BOX 2088
SANTA FE, NEW MEXICO 87501

Form C-101
Revised 10-1-78

NO. OF COPIES RECEIVED	
DISTRIBUTION	
SANTA FE	
FILE	
U.S.G.S.	
LAND OFFICE	
OPERATOR	

5A. Indicate Type of Lease
STATE ☒ FEE ☐
5. State Oil & Gas Lease No.
VB - 0155

APPLICATION FOR PERMIT TO DRILL, DEEPEN, OR PLUG BACK

1a. Type of Work b. Type of Well OIL WELL <input checked="" type="checkbox"/> GAS WELL <input type="checkbox"/> OTHER <input type="checkbox"/> 2. Name of Operator Sohio Petroleum Company 3. Address of Operator P. O. Box 4587, Houston, TX 77210 4. Location of Well UNIT LETTER <u>A</u> LOCATED <u>1060</u> FEET FROM THE <u>East</u> LINE AND <u>1300</u> FEET FROM THE <u>North</u> LINE OF SEC. <u>36</u> TWP. <u>16S</u> REC. <u>37E</u> NMPM 12. County Lea		7. Unit Agreement Name 8. Farm or Lease Name State 36 9. Well No. 2 10. Field and Pool, or Wildcat Shipp-Strawn 19. Proposed Depth 12300' 19A. Formation Strawn 20. Rotary or C.T. Rotary 21. Elevations (Show whether DF, KT, etc.) 3748.4 GL 21A. Kind & Status Plug. Bond Blanket 21B. Drilling Contractor To Be Announced 22. Approx. Date Work will start July 1, 1988	
--------------------------------------------------------------------------------------------------------------------------------------------------------------------------------------------------------------------------------------------------------------------------------------------------------------------------------------------------------------------------------------------------------------------------------------------------------------------------------------------------------	--	-----------------------------------------------------------------------------------------------------------------------------------------------------------------------------------------------------------------------------------------------------------------------------------------------------------------------------------------------------------------------------------------------------------------------------------------	--

PROPOSED CASING AND CEMENT PROGRAM

SIZE OF HOLE	SIZE OF CASING	WEIGHT PER FOOT	SETTING DEPTH	SACKS OF CEMENT	EST. TOP
17 1/2"	13-3/8"	48	400'	350'	Surface
11"	8-5/8"	24#	4500'	1450'	Surface
7-7/8"	5 1/2"	17#	12300'	300'	10500'

The proposal is to drill to 400' and set and cement 13-3/8" surface casing as outlined above. A 2-Ram, Annular BOP stack will be nipped up and tested initially and every 30 days thereafter is required. 11" hole will be drilled to 4500' and 8-5/8" casing set across the salt. 7-7/8" hole will be drilled to total depth. The objective is to test the Strawn reservoir (est. top @ 11,627') and stimulate as necessary. One DST is proposed in the Lower Strawn.

Order #R-8663 dated 6/7/88 approves this exception location

0+5: NMOCD
cc: Rooney
File

IN ABOVE SPACE DESCRIBE PROPOSED PROGRAM; IF PROPOSAL IS TO DEEPEN OR PLUG BACK, GIVE DATA ON PRESENT PRODUCTIVE ZONE AND PROPOSED NEW PRODUCTIVE ZONE. GIVE BLOWOUT PREVENTER PROGRAM, IF ANY.

I hereby certify that the information above is true and complete to the best of my knowledge and belief.
Signed T.C. Rooney Title Sr. Permit Agent Date 5-25-88

(This space for State Use)

ORIGINAL SIGNED BY JERRY SEXTON

APPROVED BY DISTRICT I SUPERVISOR TITLE _____ DATE JUL 01 1988

CONDITIONS OF APPROVAL, IF ANY:

Permit Expires 6 Months From Approval
Date Unless Drilling Underway.

100-100000
JUN 21 1963
OF
HOBBS C. 100

**MEXICO OIL CONSERVATION COMMISSION
WELL LOCATION AND ACREAGE DEDICATION PLAT**

Form C-102
Supersedes C-128
Effective 1-1-65

All distances must be from the outer boundaries of the Section.

Operator SOHIO PETROLEUM CO.			Lease STATE 36		Well No. 2
Unit Letter A	Section 36	Township 16 South	Range 37 East	County Lea	
Actual Footage Location of Well: <div style="display: flex; justify-content: space-between;"> 1300 feet from the north line and 1060 feet from the east line </div>					
Ground Level Elev. 3748.4	Producing Formation	Pool		Dedicated Acreage: <div style="text-align: right;">Acres</div>	

1. Outline the acreage dedicated to the subject well by colored pencil or hachure marks on the plat below.
2. If more than one lease is dedicated to the well, outline each and identify the ownership thereof (both as to working interest and royalty).
3. If more than one lease of different ownership is dedicated to the well, have the interests of all owners been consolidated by communitization, unitization, force-pooling, etc?

☐ Yes ☐ No If answer is "yes," type of consolidation _____

If answer is "no," list the owners and tract descriptions which have actually been consolidated. (Use reverse side of this form if necessary.) _____

No allowable will be assigned to the well until all interests have been consolidated (by communitization, unitization, forced-pooling, or otherwise) or until a non-standard unit, eliminating such interests, has been approved by the Commission.

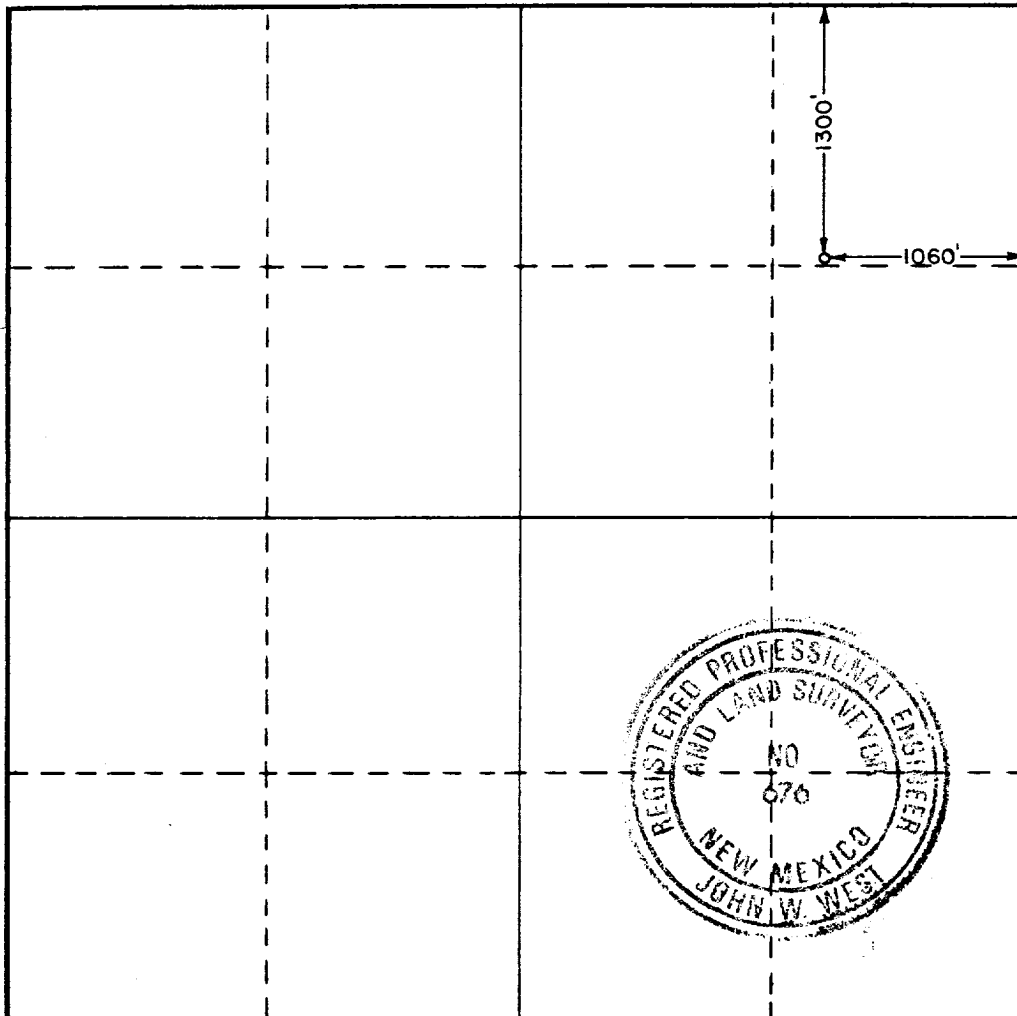

CERTIFICATION

I hereby certify that the information contained herein is true and complete to the best of my knowledge and belief.

Name _____

Position _____

Company _____

Date _____

I hereby certify that the well location shown on this plat was plotted from field notes of actual surveys made by me or under my supervision, and that the same is true and correct to the best of my knowledge and belief.

Date Surveyed

April 23, 1988

Registered Professional Engineer
and/or Land Surveyor

Certificate No. **JOHN W. WEST,**

676

RONALD J. EIDSON,

3239

15W

REC'D 9/30/88
ET

REC'D

JUN 20 1988

FINANCE

WRS COMPLETION REPORTREISSUES SEC 36 TWP 16S RGE 37E
PI# 30-T-0011 02/27/89 30-025-30414-0000 PAGE 1

NMEX LEA * 1300FNL 1060FEL SEC NE NE
STATE COUNTY FOOTAGE SPOT
SOHIO PET D D
OPERATOR WELL CLASS INIT FIN
2 STATE "36"
WELL NO. LEASE NAME
3762DF 3748GR SHIPP
OPER ELEV FIELD/POOL/AREA
API 30-025-30414-0000
LEASE TYPE/NO. PERMIT OR WELL I.D. NO.
08/01/1988 09/04/1988 ROTARY D&A-OG
SPUD DATE COMP. DATE TYPE TOOL STATUS
12300 STRAWN WILLBROS DRLG 6 RIG SUB 14
PROJ. DEPTH PROJ. FORM CONTRACTOR
DTD 11980 FM/TD STRAWN
DRILLERS T.D. LOG T.D. PLUG BACK TO OLD T.D. FORM T.D.

LOCATION DESCRIPTION

10 MI SE LOVINGTON, NM

CASING/LINER DATA

CSG 13 3/8 @ 407 W/ 400 SACKS
CSG 8 5/8 @ 4500 W/ 1400 SACKS
PLUGS @ 11700-11880 W/50 SX, 9700-9880 W/50 SX,
8840-9020 W/50 SX, 6635-6815 W/50 SX, 4450-4550 W/50
SX, 2000-2180 W/50 SX, 0-30 W/10 SX

TYPE	FORMATION	LTH	TOP DEPTH/SUB	BSE DEPTH/SUB
LOG	RUSTLER		2135 1627	
LOG	YATES		3337 425	
LOG	SN ANDRS		5111 -1349	
LOG	GLORIETA		6543 -2781	
LOG	TUBB		8192 -4430	
LOG	DRINKARD		8380 -4618	
LOG	ABO		8770 -5008	
LOG	STRAWN	11653	-7891	

SUBSEA MEASUREMENTS FROM DF

FORMATION TEST DATA

DST 1 11280-11388 CANYON S
REC 500.0 FT OIL 800.0 FT O&GCM
NO OTHER DETAILS

CONTINUED IC# 300257028688

Copyrighted 1989
Petroleum
Information Corporation

Petroleum Information

DB a company of
The Dun & Bradstreet Corporation

PI-WRS-GET
Form No 187

REISSUES
PI# 30-T-0011 02/27/89 SEC 36 TWP 16S RGE 37E
30-025-30414-0000 PAGE 2

SOHIO PET
2 STATE "36" D D

LOGS AND SURVEYS /INTERVAL,TYPE/

LOGS DI CNL BHCS

DRILLING PROGRESS DETAILS

SOHIO PET
BOX 4587
HOUSTON, TX 77210
713-552-8500
06/30 LOC/1988/
07/26 MIRT
08/01 DRLG 267
08/09 DRLG 4782
08/16 DRLG 8385
08/23 DRLG 9658
08/30 DRLG 11388
09/27 11980 TD, HOLDING FOR DATA
11/07 TD REACHED 09/03/88 RIG REL 09/04/88
11980 TD
COMP 9/4/88, D&A
NO CORES, ONE DST RPTD
02/21 REISSUED TO CORRECT TD DATE, SPUD DATE &
ADD LOG TOPS, LOGS RUN
REPLACEMENT FOR CT ISSUED 11/11/88