

NO. OF COPIES RECEIVED	
DISTRIBUTION	
SANTA FE	
FILE	
U.S.G.S.	
LAND OFFICE	
OPERATOR	

5A. Indicate Type of Lease
STATE ☐ FCC ☒
5. State Oil & Gas Lease No.

APPLICATION FOR PERMIT TO DRILL, DEEPEN, OR PLUG BACK

1a. Type of Work DRILL <input checked="" type="checkbox"/> DEEPEN <input type="checkbox"/> PLUG BACK <input type="checkbox"/>		7. Unit Agreement Name
b. Type of Well OIL WELL <input checked="" type="checkbox"/> GAS WELL <input type="checkbox"/> OTHER <input type="checkbox"/> SINGLE ZONE <input type="checkbox"/> MULTIPLE ZONE <input type="checkbox"/>		8. Farm or Lease Name Mary Lou Cox 22
2. Name of Operator Sohio Petroleum Company		9. Well No. 1
3. Address of Operator P.O. Box 4587, Houston, TX 77210		10. Field and Pool, or Wildcat SW Denton Wildcat
4. Location of Well UNIT LETTER <u>H</u> LOCATED <u>1980</u> FEET FROM THE <u>FNL</u> LINE AND <u>660</u> FEET FROM THE <u>FEL</u> LINE OF SEC. <u>22</u> TWP. <u>15S</u> RGE. <u>37E</u> NMEM		12. County Lea
19. Proposed Depth 12200 TVD		19A. Formation Strawn
20. Rotary or C.T. Rotary		
21. Elevations (Show whether DF, RT, etc.) 3789.4 GL	21A. Kind & Status Plug. Bond Blanket	21B. Drilling Contractor To Be Announced
22. Approx. Date Work will start Oct. 1, 1988		

23. PROPOSED CASING AND CEMENT PROGRAM

SIZE OF HOLE	SIZE OF CASING	WEIGHT PER FOOT	SETTING DEPTH	SACKS OF CEMENT	EST. TOP
17 1/2	13 3/8	48	400	350	Surface
11	8 5/8	24	4500	1450	Surface
7 7/8	5 1/2	17	12200	770	9200

The proposal is to drill to 400' and set and cement 13-3/8 surface casing as outlined above. A 2-Ram, Annular BOP stack will be nipped up and tested initially and every 30 days thereafter as required. A 11" hole will be drilled to 4500' and 8-5/8 casing set across the salt. A 7-7/8" hole will be drilled to total depth. The objective is to test the Strawn reservoir (est top at 11750') and stimulate as necessary. One DST is proposed in the Lower Strawn.

O + 4 NM Oil Cons.
cc: Elaine Kubicek
Bruce Smith
Karen Harvey
Lee Lindenmuth
File

See amended location

IN ABOVE SPACE DESCRIBE PROPOSED PROGRAM; IF PROPOSAL IS TO DEEPEN OR PLUG BACK, GIVE DATA ON PRESENT PRODUCTIVE ZONE AND PROPOSED NEW PRODUCTIVE ZONE. GIVE BLOWOUT PREVENTER PROGRAM, IF ANY.

I hereby certify that the information above is true and complete to the best of my knowledge and belief.

Signed Elaine Kubicek Title Technical Assistant Date 9/8/88

(This space for State Use)
Orig. Signed by
Pau. Kautz
Geologist

APPROVED BY _____ TITLE _____ DATE _____

CONDITIONS OF APPROVAL, IF ANY:

Permit Expires 6 Months From Approval
Date Unless Drilling Underway.

N. MEXICO OIL CONSERVATION COMMISS
WELL LOCATION AND ACREAGE DEDICATION PLAT

Form C-102
 Supersedes C-128
 Effective 1-1-65

All distances must be from the outer boundaries of the Section

Operator SOHIO OIL Company			Lease Mary ^{LDH} Kitch Co. "22"		Well No. 1
Unit Letter H	Section 22	Township 15 South	Range 37 East	County Lea	
Actual Footage Location of Well: 1980 feet from the North line and 660 feet from the East line					
Ground Level Elev. 3789.4	Producing Formation Strawn	Pool wildcat	Dedicated Acreage 40 Acres		

1. Outline the acreage dedicated to the subject well by colored pencil or hachure marks on the plat below.
2. If more than one lease is dedicated to the well, outline each and identify the ownership thereof (both as to working interest and royalty).
3. If more than one lease of different ownership is dedicated to the well, have the interests of all owners been consolidated by communitization, unitization, force-pooling, etc?

☐ Yes ☐ No If answer is "yes," type of consolidation _____

If answer is "no," list the owners and tract descriptions which have actually been consolidated. (Use reverse side of this form if necessary.) _____

No allowable will be assigned to the well until all interests have been consolidated (by communitization, unitization, forced-pooling, or otherwise) or until a non-standard unit, eliminating such interests, has been approved by the Commission.

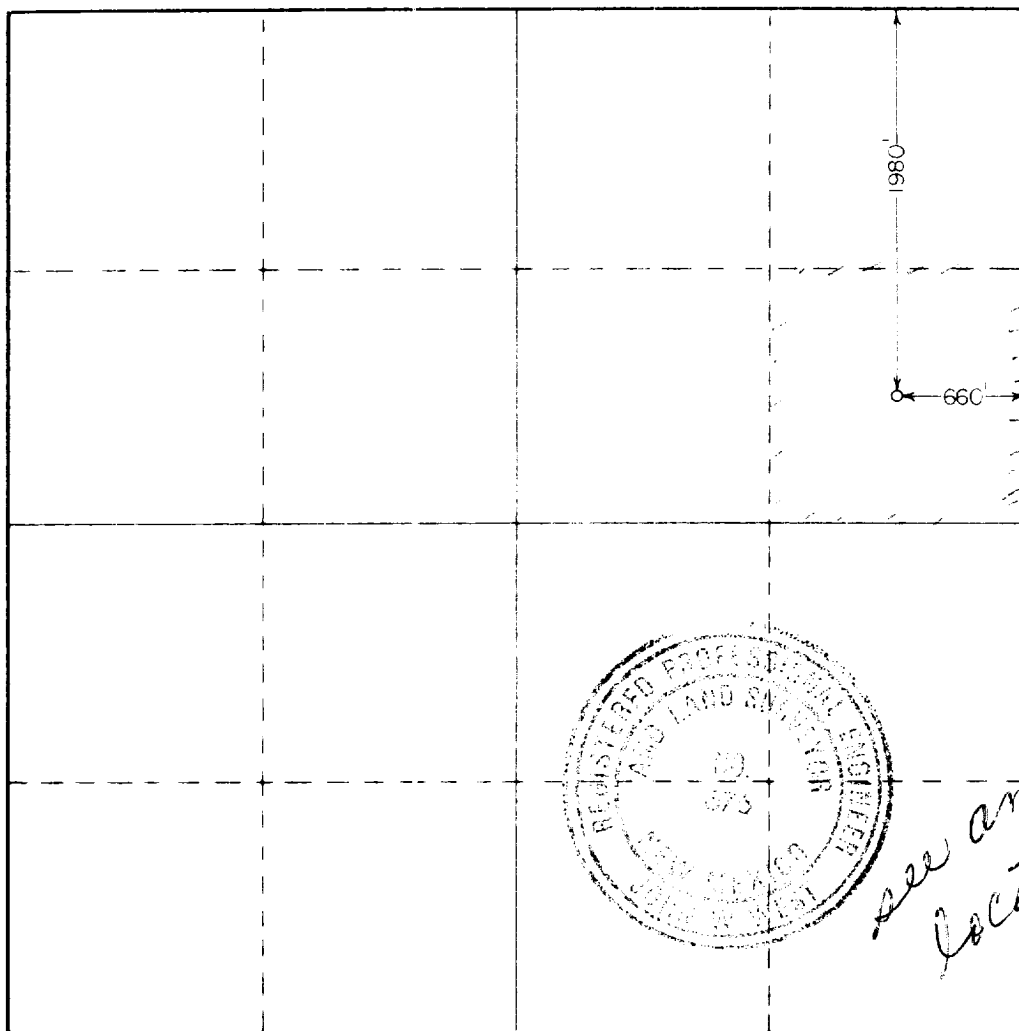

CERTIFICATION

I hereby certify that the information contained herein is true and complete to the best of my knowledge and belief.

Elaine Kubicek
 Name
Tech Asst
 Position
SOHIO Petroleum Co
 Company
 9-9-88
 Date

I hereby certify that the well location shown on this plat was plotted from field notes of actual surveys made by me or under my supervision, and that the same is true and correct to the best of my knowledge and belief.

Surveyed
 August 31, 1988
 Registered Professional Engineer
 and/or Land Surveyor

John W. West
 Certificate No. JOHN W. WEST, 676
 RONALD J. EIDSON, 3239

Rec'd 11-7-88

ELF

RECEIVED

SEP 18 1988

NOBBS OFFICE