

NEW MEXICO OIL CONSERVATION COMMISSION
WELL LOCATION AND ACREAGE DEDICATION PLAT

Form C-102
Supersedes C-128
Effective 1-4-65

All distances must be from the outer boundaries of the Section.

Operator BTA OIL PRODUCERS		Lease 8903 JV-P LOVINGTON		Well No. 1
Unit Letter "G"	Section 17	Township -16-S	Range -37-E	County LEA
Actual Footage Location of Well: 2130 feet from the NORTH line and 1980 feet from the EAST line				
Ground Level Elev. 3826	Producing Formation PENN	Pool LOVINGTON	Dedicated Acreage: 160 Acres	

1. Outline the acreage dedicated to the subject well by colored pencil or hachure marks on the plat below.
2. If more than one lease is dedicated to the well, outline each and identify the ownership thereof (both as to working interest and royalty).
3. If more than one lease of different ownership is dedicated to the well, have the interests of all owners been consolidated by communitization, unitization, force-pooling, etc?

☐ Yes ☐ No If answer is "yes," type of consolidation _____

If answer is "no," list the owners and tract descriptions which have actually been consolidated. (Use reverse side of this form if necessary.) _____

No allowable will be assigned to the well until all interests have been consolidated (by communitization, unitization, forced-pooling, or otherwise) or until a non-standard unit, eliminating such interests, has been approved by the Commission.

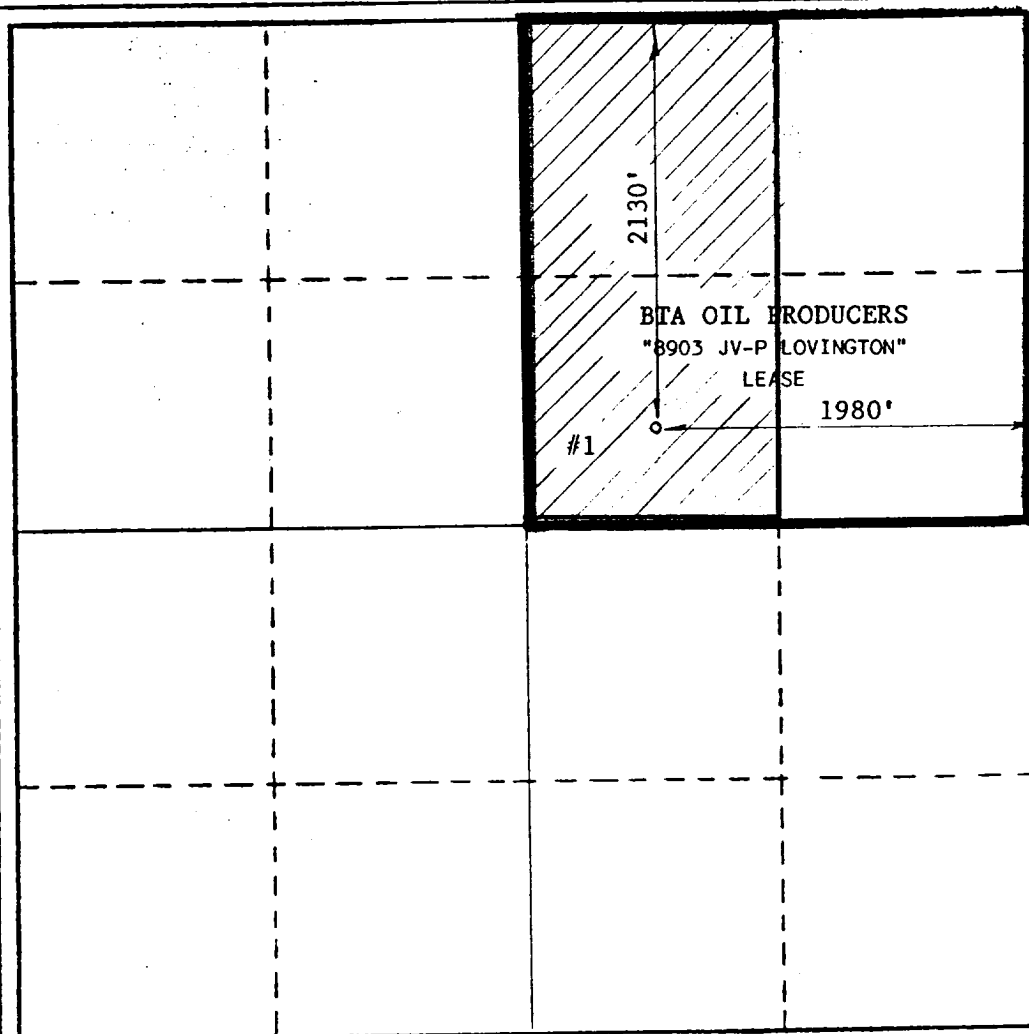

CERTIFICATION

I hereby certify that the information contained herein is true and complete to the best of my knowledge and belief.

Dorothy Houghton
Name

DOROTHY HOUGHTON

Position
Regulatory Administrator

Company
BTA OIL PRODUCERS

Date
December 28, 1989

I hereby certify that the well location shown on this plat was plotted from field notes of actual surveys made by me or under my supervision, and that the same is true and correct to the best of my knowledge and belief.

DECEMBER 28, 1989

Date Surveyed

Registered Professional Engineer
and Land Surveyor

Max A. Schumann, Jr.
MAX A. SCHUMANN, JR.

Certificate No.

1510

0 330 660 990 1320 1650 1980 2310 2640 2000 1500 1000 500 0

RECEIVED

DEC 29 1989

OCD
MOBBS OFFICE

B T A O I L P R O D U C E R S

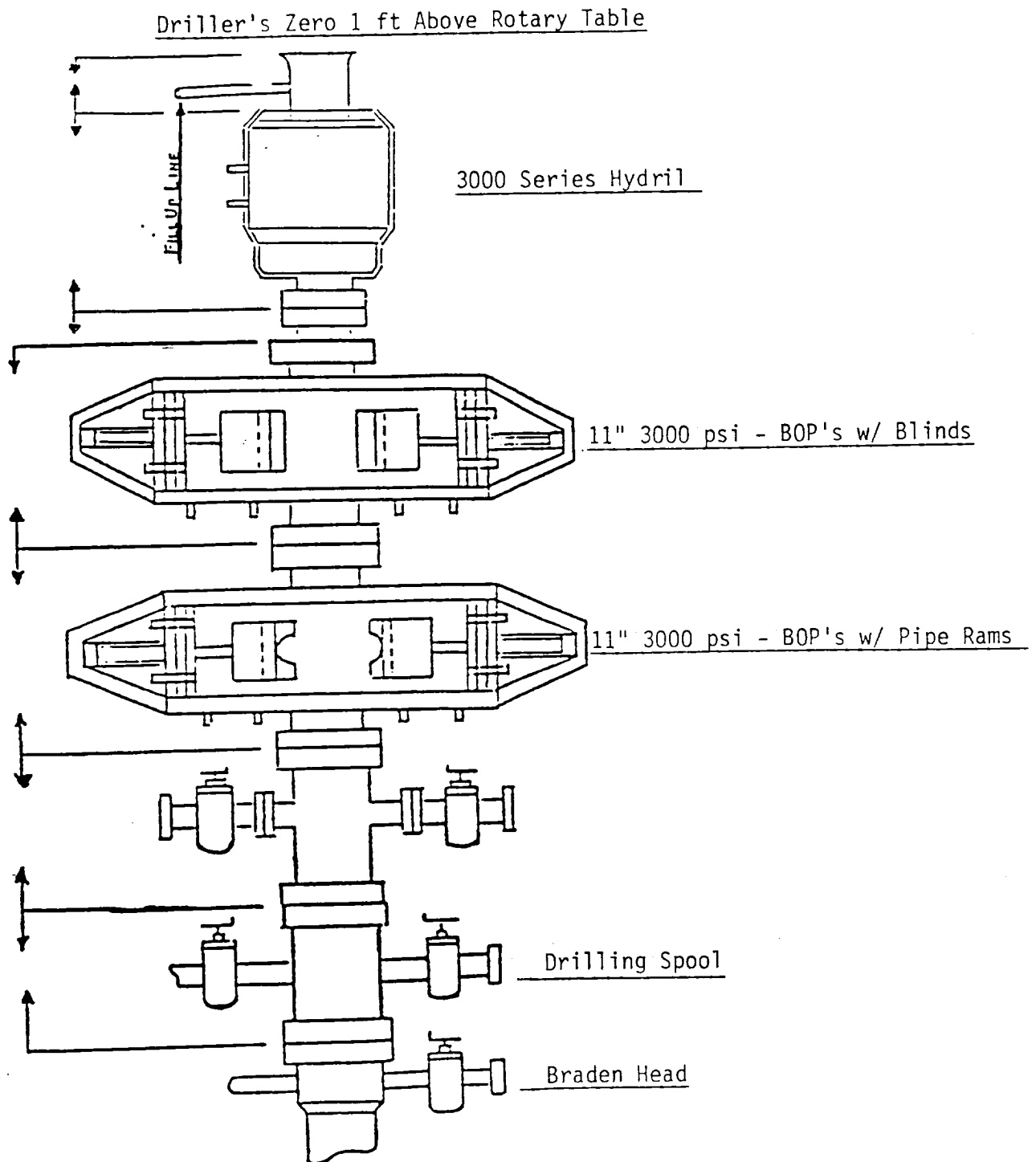

8903 JV-P Lovington #1
Sec. 17, T-16-S, R 37-E
Lea County, N.M.