



STATE OF NEW MEXICO
ENERGY, MINERALS AND NATURAL RESOURCES DEPARTMENT

OIL CONSERVATION DIVISION
HOBBS DISTRICT OFFICE

6-14-91

BRUCE KING
GOVERNOR

POST OFFICE BOX 1980
HOBBS, NEW MEXICO 88241-1980
(505) 393-6161

OIL CONSERVATION DIVISION
P. O. BOX 2088
SANTA FE, NEW MEXICO 87501

NSL-3020

RE: Proposed:

MC _____
DHC _____
NSL X _____
NSP _____
SWD _____
WFX _____
PMX _____

Gentlemen:

I have examined the application for the:

Greenhill Pet. Corp. Lovington Paddock Unit #106-E 36-16-36
Operator Lease & Well No. Unit S-T-R

and my recommendations are as follows:

OK

Yours very truly,

Jerry Sexton
Supervisor, District 1

/ed



GREENHILL PETROLEUM CORPORATION

12777 JONES ROAD, SUITE 375
HOUSTON, TEXAS 77070
TELEPHONE (713) 955-1146
FAX (713) 955-5105

Incorporated in Delaware, U.S.A.

June 6, 1991

Oil Conservation Division
State of New Mexico
Energy, Minerals and Natural Resources Dept.
P.O. Box 2088
Santa Fe, New Mexico 87504-2088

Attn: Mike Stogner

Re: Unorthodox Location and Drilling Permit
Proposed Well No. 106
Lovington Paddock
Lea County, New Mexico

Greenhill Petroleum Corporation respectfully requests the State of New Mexico Oil Conservation Division grant approval of the proposed unorthodox location and the attached permit to drill Well Number 106 in the Lovington Paddock Unit, located in Lea County, New Mexico.

The Lovington Paddock Unit is presently developed and being waterflooded utilizing a 40-acre well density. It is believed that infill development using a 20-acre well density will improve waterflood sweep efficiency and will increase secondary oil recovery. The proposed location for Well No. 106 is located in the interior of the unit and is not competitive with offset wells outside the unit. Information gathered as a result of drilling this infill well will be utilized in evaluating additional infill development potential in the unit and ultimately may be used to evaluate the feasibility of tertiary recovery.

Greenhill Petroleum Corporation wishes to commence drilling operations on the proposed well as soon as possible and would appreciate a response to this request at your earliest convenience.

Respectfully yours,

GREENHILL PETROLEUM CORPORATION

Michael J. Newport
Michael J. Newport
Landman

MJN:JB
Enclosures

100822942
111

RECEIVED

JUN 18 1931

GOV
HOBBS

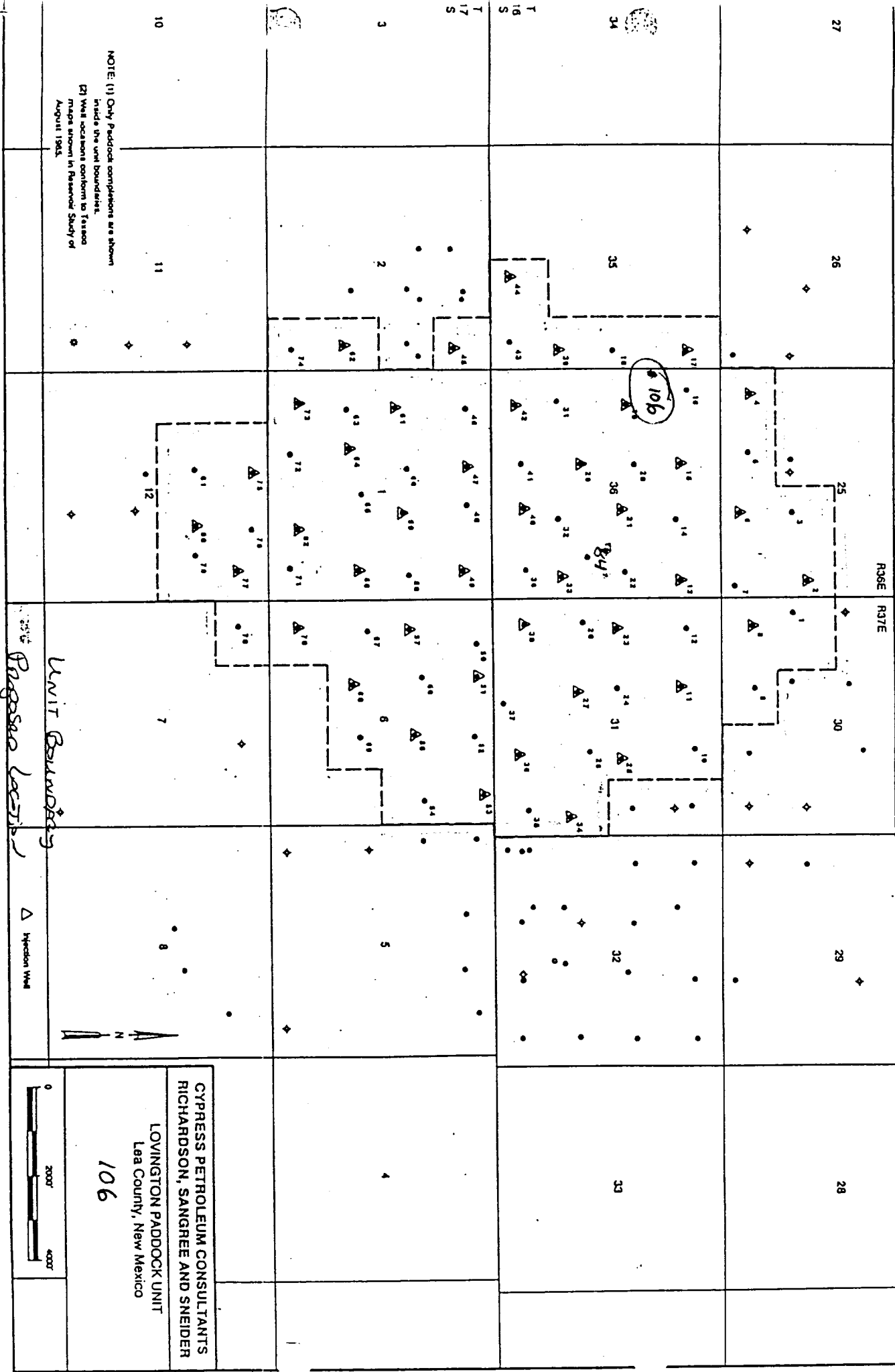

NOTE: (1) Only Padlock completions are shown inside the unit boundaries.
(2) Well locations conform to Texas maps shown in Research Study of August 1963.

Unit Boundary

Injection Well

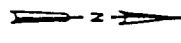

CYPRESS PETROLEUM CONSULTANTS
RICHARDSON, SANGREE AND SNEIDER
LOVINGTON PADDOCK UNIT
Lea County, New Mexico
106



7668282M
113

RECEIVED

JUN 18 1891

OF
HOBBS