

Submit to Appropriate
District Office
State Lease - 4 copies
Fee Lease - 3 copies

State of New Mexico
Energy, Minerals and Natural Resources Department

Form C-102
Revised 1-1-89

OIL CONSERVATION DIVISION

P.O. Box 2088
Santa Fe, New Mexico 87504-2088

DISTRICT I

P.O. Box 1980, Hobbs, NM 88240

DISTRICT II

P.O. Drawer DD, Artesia, NM 88210

DISTRICT III

1000 Rio Brazos Rd., Artec, NM 87410

WELL LOCATION AND ACREAGE DEDICATION PLAT

All Distances must be from the outer boundaries of the section

Operator CHARLES B. GILLESPIE, Jr.			Lease SPEIGHT FEE		Well No. 1
Unit Letter C	Section 1	Township 16 SOUTH	Range 35 EAST	NMPM	County LEA
Actual Footage Location of Well: 660 feet from the NORTH line and 2310 feet from the WEST line					
Ground Level Elev. 3980.7'	Producing Formation Strawn		Pool Undesignated		Dedicated Acreage: 51.08 Acres

1. Outline the acreage dedicated to the subject well by colored pencil or hatchure marks on the plat below.
2. If more than one lease is dedicated to the well, outline each and identify the ownership thereof (both as to working interest and royalty).
3. If more than one lease of different ownership is dedicated to the well, have the interest of all owners been consolidated by communitization, unitization, force-pooling, etc.?
☐ Yes ☐ No If answer is "yes" type of consolidation Force Pooling R9690

If answer is "no" list of owners and tract descriptions which have actually been consolidated. (Use reverse side of this form necessary.)

No allowable will be assigned to the well unit all interests have been consolidated (by communitization, unitization, forced-pooling, otherwise) or until a non-standard unit, eliminating such interest, has been approved by the Division.

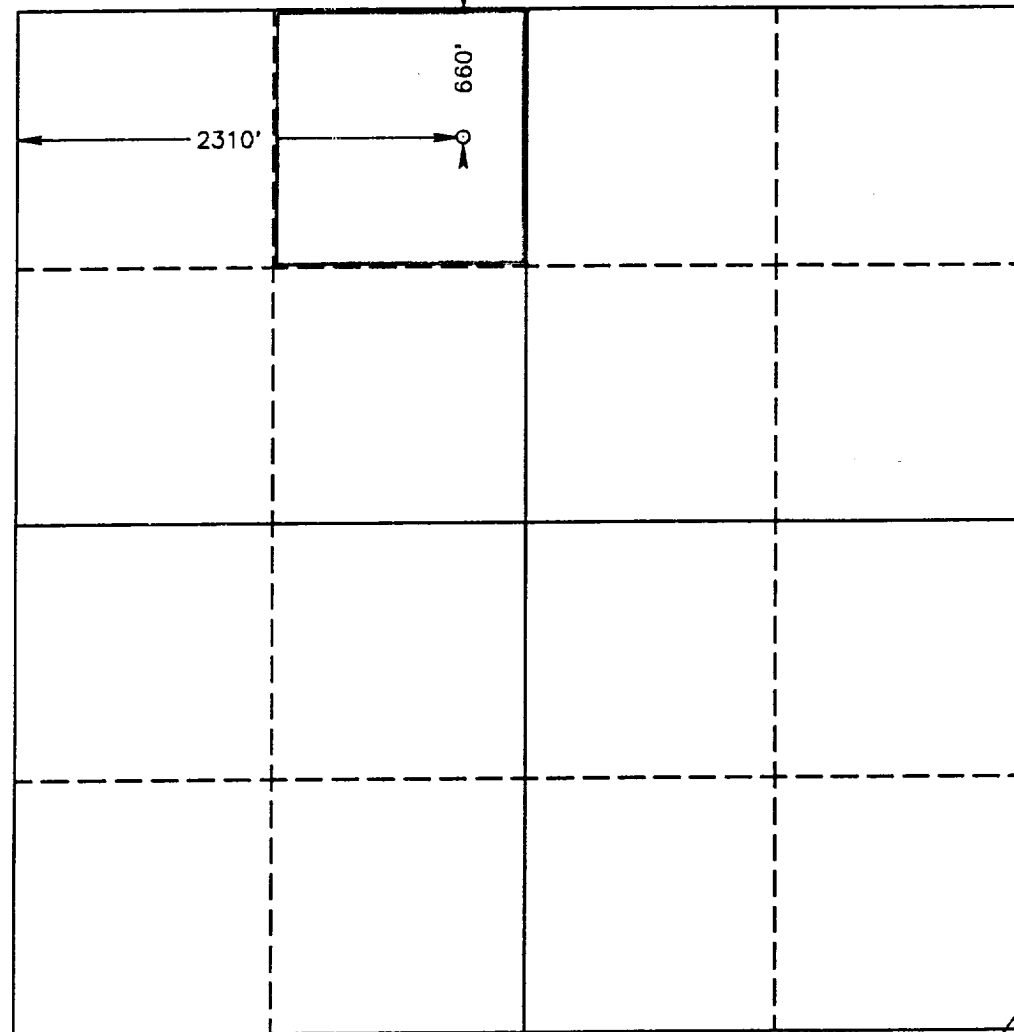

OPERATOR CERTIFICATION

I hereby certify that the information contained herein is true and complete to the best of my knowledge and belief.

Signature
William R. Crow
Printed Name
William R. Crow
Position
Exploration Manager
Company
Charles B. Gillespie, Jr.
Date
July 9, 1992

SURVEYOR CERTIFICATION

I hereby certify that the well location shown on this plat was plotted from field notes of actual surveys made by me or under my supervision, and that the same is true and correct to the best of my knowledge and belief.

Date Surveyed
Signature of Registered Professional Surveyor
Professional Surveyor
NO. 676
NEW MEXICO
Certificate No. 676
RONALD J. EIDSON, 3239
GARY L. JONES, 7977

92-11-0928

back 9-13-92

ET

RECEIVED

JUL 10 1992

OLD HOUSES OFFICE