

Submit to Appropriate
District Office
State Lease - 6 copies
Fee Lease - 5 copies

State of New Mexico
Energy, Minerals and Natural Resources Department

Form C-101
Revised 1-1-89

OIL CONSERVATION DIVISION

P.O. Box 2088
Santa Fe, New Mexico 87504-2088

DISTRICT I
P.O. Box 1980, Hobbs, NM 88240

DISTRICT II
P.O. Drawer DD, Artesia, NM 88210

DISTRICT III
1000 Rio Brazos Rd., Aztec, NM 87410

API NO. (assigned by OCD on New Wells)

30-025-32425

5. Indicate Type of Lease

STATE ☒ FEE ☐

6. State Oil & Gas Lease No.

B-2148

APPLICATION FOR PERMIT TO DRILL, DEEPEN, OR PLUG BACK

1a. Type of Work:

DRILL ☒ RE-ENTER ☐ DEEPEN ☐ PLUG BACK ☐

b. Type of Well:

OIL WELL ☒ GAS WELL ☐ OTHER ☐ SINGLE ZONE ☒ MULTIPLE ZONE ☐

2. Name of Operator

The Wiser Oil Company

3. Address of Operator

207 W. McKay, Carlsbad, NM 88220

7. Lease Name or Unit Agreement Name

Western State

8. Well No.

24

9. Pool name or Wildcat

Maljamar Grayburg San Andres

4. Well Location

Unit Letter M : 66 Feet From The South Line and 1256 Feet From The West Line

Section 17 Township 17S Range 33E NMPM Lea County

10. Proposed Depth

5525'

11. Formation

Grayburg San Andres

12. Rotary or C.T.

Rotary

13. Elevations (Show whether DF, RT, GR, etc.)

4200'

14. Kind & Status Plug Bond

Statewide

15. Drilling Contractor

16. Approx. Date Work will start

February 15, 1994

17. PROPOSED CASING AND CEMENT PROGRAM

| SIZE OF HOLE | SIZE OF CASING | WEIGHT PER FOOT | SETTING DEPTH | SACKS OF CEMENT | EST. TOP |
|--------------|----------------|-----------------|---------------|-----------------|----------------------|
| 12 1/4" | 8 5/8" | 24# | 1350' | 650 | Circulate |
| 7 7/8" | 5 1/2" | 17# | 5525' | 650 | 2300' (base of salt) |

It is proposed to drill the above captioned well to a total depth of 5525' with rotary tools. If commercial production is indicated, the well will be perforated and stimulated as necessary.

Blow Out Prevention: 10" Series 900 Type "E" Shaffer Hydraulic BOP.

OPER. OGRID NO. 022922

PROPERTY NO. 011860

POOL CODE 43320

EFF. DATE 2-22-94

API NO. 30-025-32425

IN ABOVE SPACE DESCRIBE PROPOSED PROGRAM: IF PROPOSAL IS TO DEEPEN OR PLUG BACK, GIVE DATA ON PRESENT PRODUCTIVE ZONE AND PROPOSED NEW PRODUCTIVE ZONE. GIVE BLOWOUT PREVENTER PROGRAM, IF ANY.

I hereby certify that the information above is true and complete to the best of my knowledge and belief.

SIGNATURE

Perry L. Hughes

TITLE Agent

DATE 01/25/94

TYPE OR PRINT NAME

Perry L. Hughes

505
TELEPHONE NO. 885-5433

(This space for State Use)
ORIGINAL SIGNED BY JERRY SEXTON
DISTRICT I SUPERVISOR

FEB 22 1994

APPROVED BY

TITLE

DATE

CONDITIONS OF APPROVAL, IF ANY:

NSL-3350

Permit Expires 6 Months From Approval
Date Unless Drilling Underway.

Submit to Appropriate
District Office
State Lease - 4 copies
Fee Lease - 3 copies

State of New Mexico
Energy, Minerals and Natural Resources Department

Form C-102
Revised 1-1-89

OIL CONSERVATION DIVISION

P.O. Box 2088
Santa Fe, New Mexico 87504-2088

DISTRICT I
P.O. Box 1980, Hobbs, NM 88240

DISTRICT II
P.O. Drawer DD, Artesia, NM 88210

DISTRICT III
1000 Rio Brazos Rd., Aztec, NM 87410

WELL LOCATION AND ACREAGE DEDICATION PLAT

All Distances must be from the outer boundaries of the section

| | | | | | |
|-----------------------------------|---------------|----------------------|------------------------|---------------|----------------|
| Operator The Wiser Oil Company | | | Lease Western State | | Well No. 24 |
| Unit Letter M | Section 17 | Township 17 South | Range 33 East | County Lea | |

Actual Footage Location of Well:

66 feet from the South line and 1256 feet from the West line

| | | | |
|----------------------------|--|--------------------------------------|--------------------------------|
| Ground level Elev. 4200 | Producing Formation Grayburg & San Andres | Pool Maljamar Grayburg San Andres | Dedicated Acreage: 40 Acres |
|----------------------------|--|--------------------------------------|--------------------------------|

- Outline the acreage dedicated to the subject well by colored pencil or hatchure marks on the plat below.
- If more than one lease is dedicated to the well, outline each and identify the ownership thereof (both as to working interest and royalty).
- If more than one lease of different ownership is dedicated to the well, have the interest of all owners been consolidated by communitization, unitization, force-pooling, etc.?
☐ Yes ☐ No If answer is "yes" type of consolidation _____
If answer is "no" list the owners and tract descriptions which have actually been consolidated. (Use reverse side of this form if necessary.)
No allowable will be assigned to the well until all interests have been consolidated (by communitization, unitization, forced-pooling, or otherwise) or until a non-standard unit, eliminating such interest, has been approved by the Division.

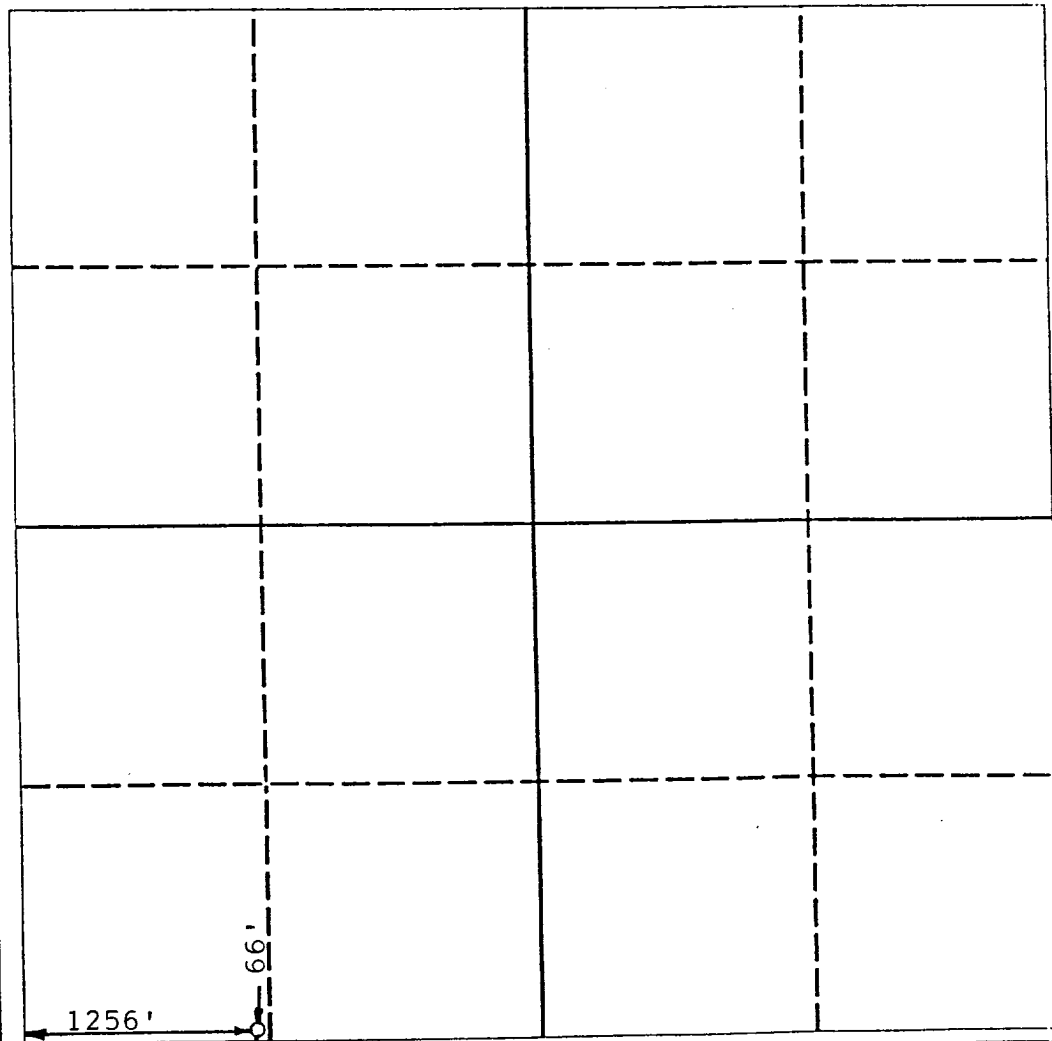

OPERATOR CERTIFICATION

I hereby certify that the information contained herein is true and complete to the best of my knowledge and belief.

Signature

Perry L. Hughes

Printed Name

Perry L. Hughes

Position

Agent

Company

The Wiser Oil Company

Date

January 26, 1994

SURVEYOR CERTIFICATION

I hereby certify that the well location shown on this plat was plotted from field notes of actual surveys made by me or under my supervision, and that the same is true and correct to the best of my knowledge and belief.

Date Surveyed

January 21, 1994

Signature & Seal of
Professional Surveyor

P. R. Patton
P. R. Patton

Certificate No.
8112

RECEIVED JAN 26 1994